

MOON RIDGE

GRAND County of Utah

Effective Date: 7/31/1961

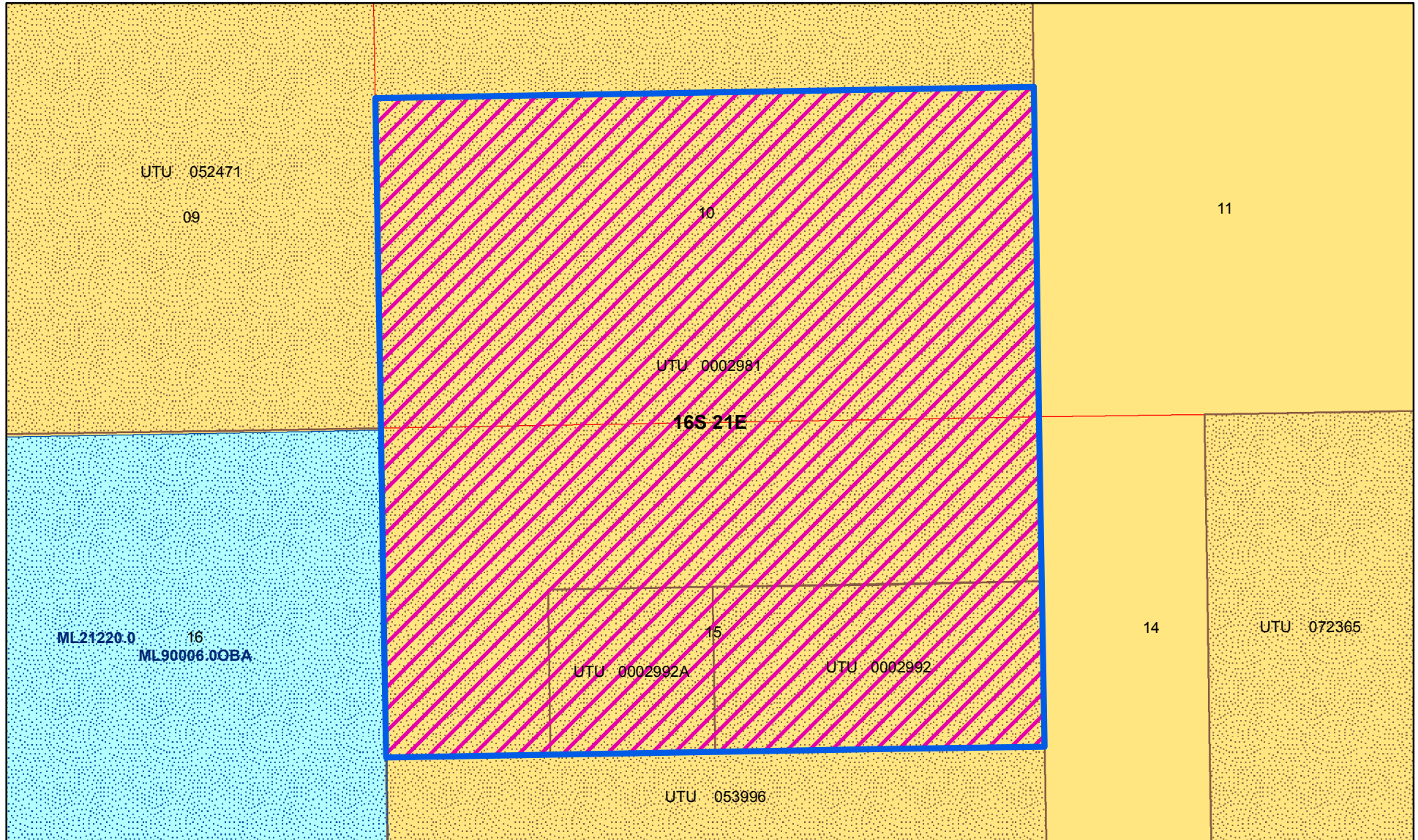

- PA= Formation Name**
- PA= Cedar Mountain PA
UTU 063033A
 - Oil and Gas Unit Agreement

- Oil and Gas Lease Parcels**
- Authorized Oil and Gas Lease Parcels
 - Pending Oil and Gas Lease Parcels
 - SITLA Oil and Gas Lease Parcels

UTU 063033X
Acres: 2320.0

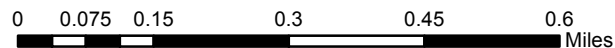

- Bureau of Land Management (BLM)
- US Forest Service (USFS)
- National Park Service (NPS)
- Indian Reservation (IR)
- State
- Private
- Township
- Section

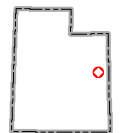

Date: 1/12/2018