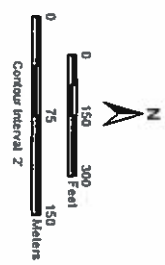
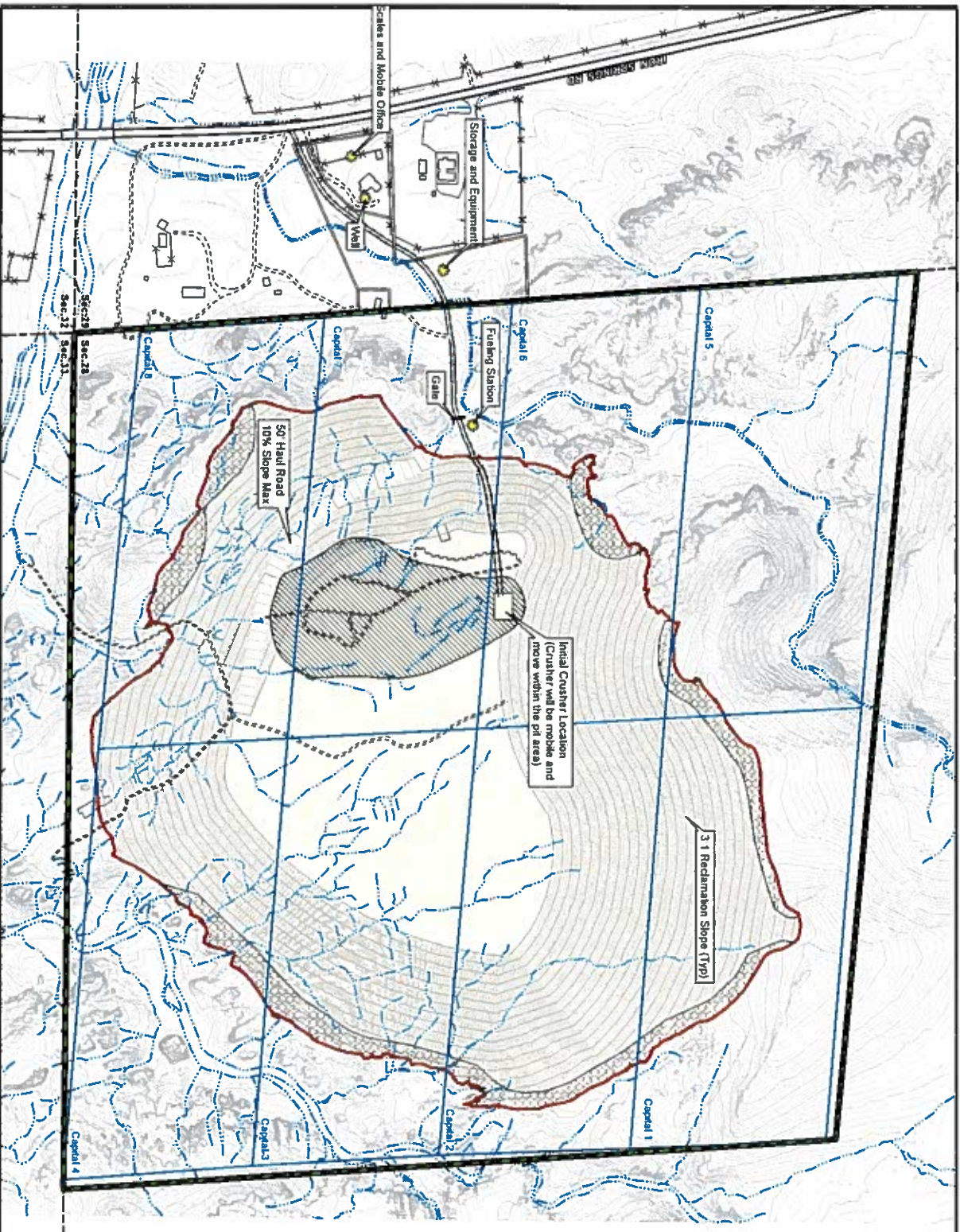

FIGURE 2
1 OF 2

KIRKLAND MINING COMPANY
SECTION CUTS A & B





113N R/W, Portions of Sections 28 & 29,
Yavapai County, Arizona.
Data Source: Kirkland Mining Company, Burch, and BLM

- Legend**
- Kirkland Mine Plan of Operations Area
 - Capital Association Placer Mining Claim
 - Unpatented Lode Claim
 - Kirkland Mining Company Private Parcels
 - Limits of Disturbance
 - Overburden Stockpile Area
 - Initial Impact Area
 - West (Maximum) Setback 50'
 - Fence
 - Entrance Road
 - Dirt Road