

**UNITED STATES
DEPARTMENT OF THE INTERIOR
BUREAU OF LAND MANAGEMENT
Northwest Oregon District Office
1717 Fabry Road, S.E.
Salem, Oregon 97306**

**John Boy Timber Sale
ORN01-TS-2026.0102
Date: January 22, 2026**

TIMBER SALE PROSPECTUS

THIS IS A PROSPECTUS ONLY. ATTACHMENTS MAY NOT INCLUDE ALL EXHIBITS REFERRED TO IN THE CONTRACT. THE COMPLETE CONTRACT, INCLUDING ALL EXHIBITS, IS AVAILABLE FOR INSPECTION AT THE NORTHWEST OREGON DISTRICT OFFICE.

NOTICE IS HEREBY GIVEN that the Bureau of Land Management will offer for sale timber as described herein for oral auction, pursuant to Instructions to Bidders, as stated on Form No. 5440-9. Written and oral bids will be received by the District Manager, or designated representative, in the timber sale room at the District Office, 1717 Fabry Road, S.E., Salem, Oregon. Written bids and deposits will be accepted beginning at 8:30 a.m. and the timber sale oral auction will commence at 9:00 a.m., on Wednesday, February 25, 2026. Before bids are submitted, full information concerning the timber, the conditions of sale and submission of bids, including appraised prices per species, should be obtained from the above District Manager, or designated representative. The right is hereby reserved to waive technical defects in this advertisement and to reject any or all bids. The United States reserves the right to waive any informality in bids received whenever such waiver is in the interest of the United States.

THIS PROSPECTUS does not constitute the decision document for purposes of appeal of a forest management decision. Consistent with 43 CFR Subpart 5003.2(b), the date the BLM posts the forest management decision on the BLM's ePlanning website establishes the effective date of the decision for purposes of an administrative appeal. The decision was posted to the BLM's ePlanning website on 05/05/2025, referring to the Mr. Walton's Opus Timber Management Project, DOI-BLM-ORWA-N010-2020-0013-EA. For the purposes of 43 CFR 5401.0-6 and 5430.0-6, this advertisement is being published on 01/26/2026 and 02/02/2026.

AN ENVIRONMENTAL ASSESSMENT was prepared for this timber sale tract, and a Finding of No Significant Impact has been documented. These documents are available for inspection as background for each timber sale tract at the Northwest Oregon District Office.

A WRITTEN BID on Form 5440-9 at not less than the advertised appraised price on a unit basis per species and the required minimum bid deposit shall be required to participate in oral bidding.

THE SUCCESSFUL BIDDER, as a condition of award, will be required to sign Form 5430-11, a certification that the bid was arrived at by the bidder or offeror independently, and was tendered without collusion with any other bidder or offeror. Also, Form 5450-17, Export Determination must be completed by the successful bidder. To expedite procedure, this form should be completed and submitted with the written bid.

THE VOLUMES LISTED herein are estimates only. The sale volumes listed are based on 16-foot taper breaks which must be taken into consideration if comparisons are made with volume predictions based on other standards. The volumes based on 32-foot taper breaks are shown for comparison purposes. No sale shall be made for less than the advertised appraised price. The Purchaser shall be liable for the total purchase price, without regard to the amount bid per unit, even though the quantity of timber actually cut or removed or designated for taking is more or less than the estimated volume or quantity so listed.

THIS TIMBER SALE has been cruised based upon Eastside Scribner board foot measure. The minimum bid figures shown by species are dollars per thousand board feet (MBF). The minimum bid increment will be \$0.10 per MBF.

A PERFORMANCE BOND in an amount not less than 20 percent of the total purchase price will be required for all contracts of \$2,500 or more. A minimum performance bond of not less than \$500 will be required for all installment contracts less than \$2,500.

QUALIFIED SMALL BUSINESS concerns may apply to SBA for a loan to provide financing for access road construction required under the terms of qualifying timber sale contracts, and necessary contract changes will be made. Approval of loan applications rests with SBA and may be contingent on availability of funds. Applicants for such loans shall notify BLM of their intention to apply for a loan.

PRE-AWARD QUALIFICATIONS. The high bidder may be required to furnish information to determine the ability to perform the obligations of the contract. If the high bidder is determined not qualified, responsible or refuses to respond within fifteen (15) days of a request for information pertaining to qualifications, the contract may be offered and awarded for the amount of the high bid to the highest of the bidders who is qualified, responsible, and willing to accept the contract.

LOG EXPORT AND SUBSTITUTION: All timber sales, including timber from Federal rights-of-ways, shall be subject to the restrictions relating to the export and substitution of unprocessed timber from the United States in accordance with P.L. 94-165 and 43 CFR 5400 and 5420, as amended.

LOG EXPORT AND SUBSTITUTION RESTRICTIONS: Excepting Port-Orford-cedar, all timber offered for sale hereunder is restricted from export from the United States in the form of unprocessed timber and is prohibited from being used as a substitute for exported private timber. The BLM has revised the log export restrictions special provision to reduce the log branding and painting requirements. The new requirements include branding of one end of all logs with a scaling diameter of over 10 inches. All loads of 11 logs or more, regardless of the diameter of the logs, will have a minimum of 10 logs branded on one end. All logs will be branded on loads of 10 logs or less. One end of all branded logs will be marked with yellow paint. At the discretion of the Contracting Officer, the Purchaser may be required to brand and paint all logs. The Purchaser shall bear any increased costs for log branding and painting.

CONTRACT MODIFICATION, SUSPENSION OR TERMINATION: A revised Special Provision has been added to the contract which enables the Contracting Officer to suspend the contract to facilitate protection of certain plant or animal species, and/or to modify or terminate the contract when necessary to: (1) Comply with the Endangered Species Act or to prevent incidental take of northern spotted owls in accordance with management direction in the Record of Decision (ROD) and Resource Management Plan (RMP), or; (2) Comply with a court order, or; (3) Protect species which were identified for protection through survey and manage and/or protection buffer standards and guidelines or management direction established in the ROD and RMP.

ADDITIONAL INFORMATION concerning this timber sale tract is available at the above District Office. A copy of the timber sale contract is also available for inspection at the District Office. The prospectus for this/these sale(s) is also available online at: <https://www.blm.gov/programs/natural-resources/forests-and-woodlands/timber-sales>. The prospectus includes maps and tables that cannot be made Section 508 compliant. For help with its data or information, please contact the Northwest Oregon District Office at 503-375-5646.

TIMBER SALE NOTICE

NORTHWEST OREGON DISTRICT
CASCADE FIELD OFFICE
SALEM DISTRICT MASTER UNIT

SALE DATE: February 25, 2026

CONTRACT NO. ORN01-TS-2026.0102, **JOHN BOY**: LUMP SUM: CLACKAMAS COUNTY, OREGON:
O&C: ORAL AUCTION: **BID DEPOSIT REQUIRED: \$239,500.00.**

All timber designated for cutting on Lots 13, 14, 15 & 16, Section 5; N1/2NW1/4, Lot 1, SE1/4NW1/4, N1/2NW1/4, Section 9; T. 5 S., R. 4 E., Willamette Meridian.

THIS TIMBER SALE HAS BEEN CRUISED BASED UPON EASTSIDE SCRIBNER MEASURE.

Minimum bid figures shown by species are dollars per thousand board feet (MBF). The minimum bid increment will be \$0.10 per MBF.

Approx. No. Merchantable Trees	Est. Vol. MBF 32' Log	Species	Est. Vol. MBF 16' Log	Appraised Price Per MBF	Estimated Volume Times Appraised Price
16,913	5,144	Douglas-fir	6,368	\$325.10	\$2,070,236.80
4,925	1,096	western hemlock	1,359	\$206.30	\$280,361.70
887	69	western red cedar	96	\$461.60	\$44,313.60
22,726	6309	Totals	7,823		\$2,394,912.10

LOG EXPORT AND SUBSTITUTION RESTRICTIONS: All timber offered for sale hereunder is restricted from export from the United States in the form of unprocessed timber and also prohibited from substitution of exported private timber.

CRUISE INFORMATION: The timber volumes estimated using variable plot. A 40 BAF was used for the Regeneration Harvest Area and right-a-way. A 30 BAF was used for Partial Harvest Area. Right- a-way in unit 2 was cruised using 100% method. A form class tables for estimating board feet volume of trees in 16-foot logs. Approximately 76 trees which are considered to be non-merchantable are designated for cutting. Approximately 0% of the total sale volume is salvage material. With respect to merchantable trees of all species; the average tree is 17.3 inches DBHO; the total gross volume is approximately 8,279 MBF; and 94 % recovery is expected.

CUTTING AREA: Five (5) units, totaling approximately 150 acres of Regeneration Harvest Area, approximately 15 acres of Partial Harvest Area and 2 acres of Right-of-way. Acres shown on Exhibit A have been computed using a Global Positioning System receiver.

DURATION OF CONTRACT: Will be 36 months for cutting and removal of timber.

LOCATION: For access to the sale area please refer to the Timber Sale Vicinity Map and Exhibit E.

CONTRACT TERMINATION: Special Provisions have been added to the contract which enables the Contracting Officer to suspend, modify or terminate the contract to protect or to facilitate protection of certain plant or animal species, and to comply with the Endangered Species Act or to protect occupied marbled murrelet sites in accordance with the Standards and Guidelines of the Record of Decision for Amendments to Forest Service and Bureau of Land Management Planning Documents Within the Range of the Northern Spotted Owl. This contract provision limits the liability of the Government to the actual cost incurred by the Purchaser which have not been amortized by the timber removed from the contract area.

ACCESS AND ROAD MAINTENANCE: All roads are Purchaser maintenance and shall include frequent blading and shaping of road surface; ditch, culvert, and catch basin cleaning; removal of minor slides and other debris. Roads shall be left in a condition to withstand adverse weather at the end of the seasonal operations.

To gain access to the timber sale area a 4C17 key will be required. Contact Cameron Minson at (503)-302-1860 to check out the key.

ROAD CONSTRUCTION AND RENOVATION: The purchaser will be required to do all work set forth below. The purchaser shall supply all materials unless otherwise indicated. All earth moving equipment to be washed prior to entry onto BLM lands. All natural surface roads may be rocked at the Purchasers expense.

Road Construction:

Road P1, 520 feet, 16-foot subgrade plus ditch,
Surfacing – dirt.

Road P2, 1160 feet, 16-foot subgrade plus ditch,
Surfacing – dirt.

Road P3, 1350 feet, 16-foot subgrade plus ditch,
Surfacing – dirt. Use 80 c.y. of rock at start of road.

Road P4, 560 feet, 16-foot subgrade plus ditch,
Surfacing – dirt.

Renovation:

Renovation will consist of grading, brushing, clearing ditches, cleaning culvert inlets, and placing spot rock where necessary to get the road ready for haul.

Estimated Quantities:

Clearing and Grubbing	Clearing Acres
P1	0.5
P2	1.1
P3	1.2
P4	<u>0.5</u>
Totals: 3.3	

Culvert and Flume:

3 culverts totaling 110 feet of 18 inch CMP

Aggregate Material:

<u>Quantity</u>	<u>Description</u>
380 cubic yards	1.5” minus crushed rock

Rock Source: Buche Quarry

SPECIAL ATTENTION ITEMS:

- Sec. 43.a-d.- Reserved timber
- Sec. 44.e.- Whole tree or top yarding in cable ground
- Sec. 44.h.- Seasonal restrictions
- Sec. 44.q. - Snag creation

TIMBER SALE CONTRACT RESERVATIONS AND SPECIAL PROVISIONS

Sec. 43. Timber Reserved from Cutting

RESERVED

- a. All timber in the Reserve Area shown on Exhibit A and all orange painted trees which are on or mark the boundaries of the Reserve Area.
- b. All timber marked with orange paint above and below stump height in the Harvest Areas shown on Exhibit A.
- c. All timber inside the area posted as "Leave Island" as shown on Exhibit A.
- d. All existing snags and down logs which do not present a safety hazard as determined by the Authorized Officer. Snags felled for safety reasons shall be retained on site.

Sec. 44. Special Provisions

LOGGING

- a. Before beginning operations on the Contract Area for the first time or after a shutdown of seven (7) or more days, the Purchaser shall notify the Authorized Officer in writing of the date they plan to begin operations. The Purchaser shall also notify the Authorized Officer in writing if they intend to cease operations for any period of seven (7) or more days.
- b. Prior to the commencement of operations, the Purchaser shall obtain from the Authorized Officer written approval of a written operations and logging plan commensurate with the terms and conditions of the contract, which shall include measures needed to ensure protection of the environment and watershed. A pre-work conference between the Purchaser's authorized representative and the Authorized Officer must be held at a location designated by the Authorized Officer before the logging plan will be approved. All logging shall be done in accordance with the plan developed by this provision.
- c. At Harvest Area landings, all logs, including hardwoods, more than eight (8) inches in diameter at the large end and exceeding eight (8) feet in length shall be decked or wind-rowed at the location designated by the Authorized Officer except logs sold and removed from the Contract Area.
- d. In Regeneration Harvest Areas – all yarding shall be done by equipment capable of transporting the leading end of logs clear of the ground and operated entirely on designated skid roads and/or skyline corridors. Before felling and yarding any timber, except road right-of-way timber, the Purchaser shall locate designated skid trails and/or skyline corridors as follows:
 1. Identify the location of designated skid roads and/or skyline corridors in a method approved by the Authorized Officer.

2. Space designated skid roads and/or skyline corridors at a minimum of one-hundred and fifty (150) feet apart unless otherwise agreed to in writing by the Authorized Officer.

3. Limit width of skid roads and/or skyline corridors to twelve (12) feet.

4. Ground-based operations are limited to slopes of thirty-five (35) percent or less. Ground-based operations may be approved on slopes up to fifty (50) percent when using specialized equipment, operating on previously constructed skid trails, or accessing isolated areas over steep pitches.

5. In areas where skyline yarding is necessary across stream channels, full suspension yarding is required within fifty (50) feet each side of the stream channel.

e. In all Harvest Areas- all trees designated for cutting within the cable logging area shall be whole tree yarded or yarded with tops attached, unless otherwise approved by the Authorized Officer.

f. Before cutting and removing any trees necessary to facilitate logging in the Partial Harvest Areas shown on Exhibit A, the Purchaser shall identify the location of skid trails, skyline corridors; tailhold, tieback, guyline, lift, intermediate support, and the clearing limits of landings on the ground in a manner approved by the Authorized Officer at the pre-work conference and documented in the logging plan required in Sec. 44.b. Said Purchaser identification of trees to be cut and removed does not constitute authority to proceed with cutting and removal. In addition, before proceeding the following conditions must be met:

1. All skid trails and/or skyline corridors upon which timber is identified by the Purchaser to be cut and removed in accordance with this special provision must be necessary for the safe and expeditious removal of timber sold under this contract and shall be limited to the minimum width necessary for yarding of logs with a minimum of damage to reserve trees, however, unless otherwise approved in writing by the Authorized Officer, the width of each skid trail and/or skyline corridor shall be limited to twelve (12) feet.

2. The Purchaser may immediately cut and remove additional timber to clear skid trails, skyline corridors; and provide tail hold, tieback, guyline, lift and intermediate support trees; and clear danger trees when the trees have been marked with a non-reserve color of paint above and below stump height by the Authorized officer and thereby approved for cutting and removal by the Authorized Officer. The volume of the timber to be sold will be determined by the Authorized Officer in accordance with Bureau of Land Management prescribed procedures. No timber may be cut or removed under terms of this provision unless sufficient installment payments have been made in accordance with Sec. 3.(b) of the contract or sufficient bonding has been provided in accordance with Sec. 3.(e) of the contract.

3. The Purchaser agrees that sale of this additional timber shall be accomplished by a unilateral modification of the contract executed by the Contracting Officer and that such timber shall be sold at the unit prices shown in Exhibit B of this contract unless: the value of the timber must be reappraised subject to the terms for contract extension set forth in Sec. 9 of the contract; or, the Authorized Officer determines that the trees otherwise reserved in Sec. 43 of the contract or any tree that exceeds forty-four (44) inches diameter at breast height shall be appraised and sold by bilateral modification of the contract at current fair market value in accordance with Sec. 8 of the contract.

4. This authorization for the Purchaser to cut and remove additional timber prior to the execution of a modification may be withdrawn by the Contracting Officer if the Authorized Officer determines that the Purchaser has cut and removed any tree not previously marked and approved for cutting by the Authorized Officer, which under Sec. 10 of the contract constitutes a violation of the contract and under Sec. 13 of the contract may constitute a trespass rendering the Purchaser liable for damages under applicable law.

5. If authorization is withdrawn, the Contracting Officer shall issue a written notice to the Purchaser that the sale of additional timber under this special provision is no longer approved. In this case, the Purchaser shall inform the Authorized Officer at least one (1) working day prior to the need for cutting and removing any additional timber and execute a bilateral modification prior to cutting for such additional approved timber at the unit prices shown in Exhibit B of the contract or in accordance with Sec. 8 or Sec. 9 of the contract as determined by the Authorized Officer in accordance with this provision. The Contracting Officer may issue a written order to the Purchaser to suspend, delay or interrupt any or all contract work for the period of time deemed necessary and appropriate for the Government to safely measure and mark additional timber.

g. Excessive damage to the reserve timber, as determined by the Authorized Officer, will result in suspension of operation until mitigation measures are in place to prevent further damage as directed by the Authorized Officer.

h. No ground-based equipment shall operate on the contract area between October 15 of one calendar year and May 15 of the following calendar year both days inclusive or during other periods of wet weather. This may be shortened or extended as determined by the Authorized Officer.

ROAD CONSTRUCTION, RENOVATION, MAINTENANCE, AND USE

i. The Purchaser shall construct, renovate, and maintain roads in strict accordance with the plans and specifications shown on Exhibit C, which is attached hereto and made a part hereof. All natural surface roads may be rocked at the Purchasers expense with prior approval of the Authorized Officer. Any required construction, renovation, or maintenance of structures and roads shall be completed and accepted, in accordance with Section 18, prior to the removal of any timber, except right-of-way timber over that road. The Purchaser shall not commence work until receipt of written notice to do so from the Authorized Officer.

j. The Purchaser is authorized to use the roads shown as Haul Route – Purchaser Maintenance on Exhibit E for the removal of Government timber sold under the terms of this contract and the hauling of rock as required in Exhibit C and D provided that the Purchaser perform the required maintenance described in Sec. 44.1.

k. In the use of Road No. 5-4E-5.0 (Seg. B), and 5-4E-5.1 (Seg. A) the Purchaser shall comply with the conditions of Access Road Easement RE-S-209 (Serial No. OROR039120), dated March 15, 1963, between the United States of America and Purvine Logging Co. In the use of Road No. 5-4E-5.0 (Seg. D), the Purchaser shall comply with the conditions of Access Road Easement RE-S-359 (Serial No. ORORE0015839), dated September 10, 1964, between the United States of America and Crown Zellerbach Corporation. In the use of Road No. 5-4E-5.0 (Seg. A-C1), 5-4E-5.1 (Seg. A) the Purchaser shall comply with the conditions of Access Road Easement RE-S-360 (Serial No. OROR0015820), dated October 23,

1964, between the United States of America and Purvine Logging Co. In the use of Road No. 5-3E-1.0 (Seg. C-D), the Purchaser shall comply with the conditions of Access Road Easement RE-S-614 (Serial No. OROR012185), dated April 30, 1973, between the United States of America and Publishers Paper Co. In the use of Road No. 5-3E-1.0 (Seg. D-E), the Purchaser shall comply with the conditions of Access Road Easement RE-S-610 (Serial No. OROR012186), dated May 15, 1973, between the United States of America and Crown Zellerbach Corporation.

These conditions include:

- (1) Purchaser shall close all gates after each passage and close and lock all gates when there is no active hauling.
- (2) Purchaser shall maintain, including placing surface rock, the roads in accordance with the specifications in the timber sale contract.

l. The Purchaser shall perform any required road repair and maintenance work on roads identified as Purchaser maintenance, under the terms of Exhibit D, Road Maintenance Specifications, of this contract, which is attached hereto and made a part hereof.

m. The Purchaser agrees that if they elect to use any other private road, which is the subject of a right-of-way agreement with the Government for the removal of Government timber sold under the terms of this contract, Purchaser shall request and agree to the modification of this contract to provide for such use and for allowances for amortization of the Government's share of the capital investment of any such road.

n. With the prior written approval of the Authorized Officer, the Purchaser may arrange for cooperative maintenance with other users of roads of this contract; provided, that such cooperative arrangement shall not relieve the Purchaser of his liability for the maintenance and repair of such roads resulting from wear or damage, in accordance with this contract. The Purchaser shall furnish the Authorized Officer a copy of any cooperative maintenance agreements entered into with other users on these roads.

ENVIRONMENTAL PROTECTION

o. In order to prevent the spread of noxious weeds, the Purchaser shall pressure wash all earth disturbing equipment and logging equipment prior to entry onto BLM lands as directed by the Authorized Officer. Cleaning shall be defined as removal of all dirt, grease, plant parts and material that may carry noxious weed seeds. Equipment shall be inspected by the Authorized Officer at a site approved by the Authorized Officer to verify that the equipment had been reasonably cleaned prior to entry onto BLM lands.

p. In additions to the requirements set forth in Sec. 26 of this contract, the Purchaser shall cover skid trails with logging slash and debris, install water bars or comparable erosion control measures, and block entrances or other created access points on the contract areas shown on Exhibit A as directed by the Authorized Officer. This work shall be completed within fifteen (15) days after completion of log hauling from each landing.

q. The Purchaser shall saw top up to fifty-five (55), high girdle fifty-five (55), and base girdle fifty-six (56) green, reserve conifer trees as selected and directed by the Authorized Officer in Harvest Area and Leave Islands shown on Exhibit A. Tree topping and base girdling shall be completed in accordance with Exhibit I of this contract. All topping and girdling operations shall be completed to the satisfaction of the Authorized Officer within one year after yarding is completed and within thirty (30) days after being notified by the Authorized Officer to commence topping and girdling operations.

FIRE PREVENTION

r. Primarily for purposes of fire prevention and control, the Purchaser shall, prior to the operation of power-driven equipment in construction or logging operations under this contract during the fire season or periods of fire danger, prepare a fire prevention and control plan to the satisfaction of the Authorized Officer. Purchaser shall take such measures for prevention and suppression of fire on the Contract Area and other adjacent Government lands used or traversed by Purchaser in connection with operations as are required by applicable laws and regulations. However, when in the opinion of the Authorized Officer, weather and other conditions affecting fire incidence and control make special precautions necessary to protect the Contract Area and said Government lands, Purchaser shall take such additional or other fire prevention and control measures as may be required by the Authorized Officer. The Purchaser shall comply with Oregon Department of Forestry Industrial Fire Precaution Level (IFPL) I Fire Season requirements. At IFPL II and III, additional fire prevention and control provisions may be added as determined by the Authorized Officer and specified in written instructions to the Purchaser to mitigate dry fuel and weather conditions.

LOGGING RESIDUE REDUCTION

s. In addition to the requirements of Sec. 15 of this contract, and notwithstanding the Purchaser's satisfactory compliance with State laws and regulations regarding offsetting or abating the additional fire hazard created by this operation and the State's willingness to release the Purchaser from liability for such hazard, the Purchaser shall remain responsible to the Government for performance of the following hazard reduction measure(s) required by this contract: Perform logging residue reduction and site preparation work on approximately forty-eight (48) acres within harvest area units. The required work shall consist of any treatment or combination of treatment, as determined by the Authorized Officer and specified in writing by the Contracting Officer. The number of acres of each treatment shall be determined by the Authorized Officer. Prior to commencement of any operation under this Section of the contract, a slash disposal and pre-work conference between the purchaser's representative and the Authorized Officer must be held at a location designated by the Authorized Officer. The number of acres of each treatment shall be determined by the Authorized Officer. All slash disposal shall be done in accordance with the plans developed at this pre-work conference. Slash, as defined for this section, shall mean all material (brush, limbs, tops, unmerchantable stems, and chunks) severed or knocked over because of operations under the terms of this contract.

1. Excavator pile and burn slash within ground-based portions of harvest units from skid trails and along roads as directed by the Authorized Officer. Slash shall be piled by an excavator equipped with a hydraulic thumb. Finished piles shall be tight and free of dirt.

a. Unmerchantable logs greater than six (6) inches on the small end shall be left in place or positioned so that they will not be burned.

b. Slash less than six (6) inches in diameter would be less than one (1) foot in height.

c. Machine piles shall be located as far as possible from retained trees, snags, or unit boundaries to minimize damage.

d. Machine piles shall be kept free of dirt and other non-wood debris and constructed as compactly as possible. There should be an adequate supply of finer fuels located within and under the covered area of the pile to ensure ignition of the larger fuels.

e. A minimum 10-foot by 10-foot cover of four (4) mil (0.004) inch thick polyethylene shall cap each machine pile to maintain a dry ignition point. The cover shall be firmly fixed to each pile to hold it in place. Plastic shall be held in place with woody debris or tied with rope or twine. The plastic must be secured so that it is held in place during strong wind conditions. The Purchaser is required to furnish the covering materials. Covering shall be completed as directed by the Authorized Officer.

f. Cutting Areas shall be piled during the same season that they are logged.

2. Pile and burn landing slash within thirty (30) feet of the edge of each landing, all tops, broken pieces, limbs and debris more than one (1) inch in diameter at the large end and longer than three (3) feet in length shall be piled within fifteen (15) days of completion of hauling logs from that landing. Landing piles shall be kept free of dirt and located adjacent to roads at least twenty (20) feet from any Reserve Tree and/or as directed by the Authorized Officer. Upon completion of landing piling, the Purchaser shall prepare the landing piles for burning by securely covering each landing pile with four (4) mil (0.004) inch thick polyethylene plastic film at least 20 feet wide. Landing piles shall be 75 percent covered with cover extending three-quarters of the way down all sides. The plastic shall be oriented southwest to northeast. Pieces of burnable material shall be placed on top of the plastic to secure it from moving and to prevent it from blowing off during strong wind episodes. The Purchaser is required to furnish the covering materials. The timing of this covering work shall be in accordance with instructions from the Authorized Officer. No landing debris shall be dozed off the landing and covered with dirt. Debris which has been buried and is determined to be the source of holdover fire shall be excavated by the Purchaser, at the Purchaser's expense, with a tractor and/or hydraulic excavator as directed by the Authorized Officer. If the structure of the landing piles will not permit adequate consumption of piled debris by burning, the Purchaser shall re-pile them at the direction of the Authorized Officer.

t. Notwithstanding the provisions of Sec. 15 of this contract, the Government shall assume all obligations for disposal or reduction of fire hazards created by Purchaser's operations on Government lands, except for burning and mop-up assistance as required herein and measures required in Section 44.s. The Purchaser shall, under supervision of the Authorized Officer or designated representative, assist in preparing units for, burning, mop-up, and patrol by furnishing, at the Purchaser's own expense, the services of personnel and equipment on each unit as shown below:

1. For Igniting, Burning, Mop-up of Piles on Units:
 - a. One work leader(s) Firefighter Type 1 (FFT1) qualified according to National Wildfire Coordinating Group (NWCG) Wildland Fire Qualifications System guide, PMS 310-1) to supervise crew and equipment operations, and to serve as Purchaser's representative.
 - b. Five-person crew Firefighter Type 2 (FFT2) qualified according to National Wildfire Coordination Group (NWCG) Wildland Fire Qualifications System guide, PMS 310-1, with sufficient fuel for burning, six (6) drip torches, one (1) power saw, and one (1) backpack pump, one (1) tool for each crew member.
 - c. The crew shall arrive on the project area with radios capable of inter-crew communications and communication with a BLM representative at a ratio of one (1) radio per every five (5) crew members.
 - d. All ignition and mop-up personnel will be directly supervised by a BLM representative.

Aircraft and pilots used for Logging Residue Reduction or the suppression of escaped fires from Logging Residue Reduction operations, shall be acquired from a list of aircraft and pilots approved (i.e., carded for these specific activities) by the Office of Aircraft Services or the U.S. Forest Service. This list is available from BLM District Offices upon request.

All listed personnel shall be physically fit, experienced and fully capable of functioning as required. In addition, all listed personnel shall be qualified according to the National Wildfire Coordinating Group (NWCG) Wildland Fire Qualification System Guide, PMS-310-1 and provide documentation of these qualifications. On the day of ignition all listed personnel shall be fluent in speaking and understanding English, clothing shall consist of long pants and long-sleeved shirts and be of approved aramid fabric (Nomex™ or equivalent), as well as being free of diesel fuel oil. All personnel shall wear lug sole boots with minimum eight (8) inch tall uppers that provide ankle support, approved hard hats and leather gloves. Personnel who do not meet these requirements or do not have proper clothing and personal protective equipment (PPE) will not be allowed to participate. All listed tools and equipment shall be in good usable condition. All power-driven equipment shall be fully fueled and available for immediate use. During periods of use under this subsection, the Purchaser shall provide fuel and maintenance for all such power-driven equipment.

Except as provided hereafter for fire escapement, the Purchaser shall continue the required assistance in mop up on each cutting unit shown on Exhibit A for seventy-two (72) hours, as directed by the Authorized Officer within a five (5) day period commencing at 8:00 a.m. the day following the completion of ignition in that unit, or until released from such service by the Government, whichever occurs first.

In event of a fire escapement, the Purchaser's personnel and equipment shall, under supervision of the Authorized Officer, take action to control and mop up the escaped fire until released from such service by the Government. If it becomes necessary to use furnished personnel and equipment for the suppression of a fire which escapes from the prescribed fire area for a period beyond the remainder of the day in which the fire escapes, then the Government shall, at its option: (1) reimburse the Purchaser for such additional use of personnel and equipment at wage rates shown in the current Administratively Determined Pay Rates for the Western Area and at equipment rates shown in the current Oregon-Washington Interagency Fire Fighting

Equipment Rental Rates schedule until the Purchaser is released from such service by the Government; or (2) release the Purchaser from additional suppression work and assume responsibility for suppressing the escaped fire.

In situations where an escaped fire is controlled and contained by an adequate fire break (i.e., trail, road, stream, rock formation, etc.), the Government may permit the Purchaser to remove personnel for that day; provided that all mop up work on the escaped fire is included with mop up work on the prescribed fire area. In such an event, the Purchaser must sign a statement of agreement to complete mop up work on all escaped fire areas concurrently with mop up work on the prescribed fire area.

In case of injury to personnel or damage to equipment furnished as required by this subsection, liability shall be borne by the Purchaser, unless such injury or damage is caused by Government negligence.

Time is of the essence in complying with this provision. In the event the Purchaser fails to provide the personnel and equipment required herein, the Purchaser shall be responsible for all additional cost incurred by the Government in disposing of slash including but not limited to the wages and other costs of providing federal employees and others as substitute labor force, the cost of providing substitute equipment and appropriate additional overhead expenses. If the Purchaser's failure results in a deferral of burning and new conditions necessitate additional personnel and equipment to accomplish the planned burn, the Purchaser also shall be responsible for such additional costs.

LOG EXPORT RESTRICTIONS

u. Unless otherwise authorized in writing by the Contracting Officer, the Purchaser shall brand clearly and legibly one end of all logs with a scaling diameter (small end inside bark) of over ten (10) inches, prior to the removal of timber from the contract area. All loads of eleven (11) logs or more will have a minimum of ten (10) logs clearly and legibly branded on one end regardless of the diameter of the logs. All logs will be branded on loads of ten (10) logs or less. One end of all branded logs to be processed domestically will be marked with a three (3) square inch spot of highway yellow paint. The purchaser will stop trucks for accountability monitoring at mutually agreed upon locations when notified by the Authorized Officer.

If multiple trailers (mule trains) are used, each bunked load shall be considered an individual load, and these guidelines will apply to each bunked load. If a flatbed stake trailer is used, each bundle will be treated as a separate load.

At the discretion of the Contracting Officer, the Purchaser may be required to brand and paint all logs. Any increased costs for log branding and painting shall be the responsibility of the Purchaser.



UNITED STATES DEPARTMENT OF THE INTERIOR
Bureau of Land Management
Northwest Oregon District

Exhibit A
John Boy
Timber Sale
Page 1 of 1

TIMBER SALE CONTRACT MAP - ORN01-TS-2026.0102

T. 5 S., R. 4 E., Section 5, 9; W.M.

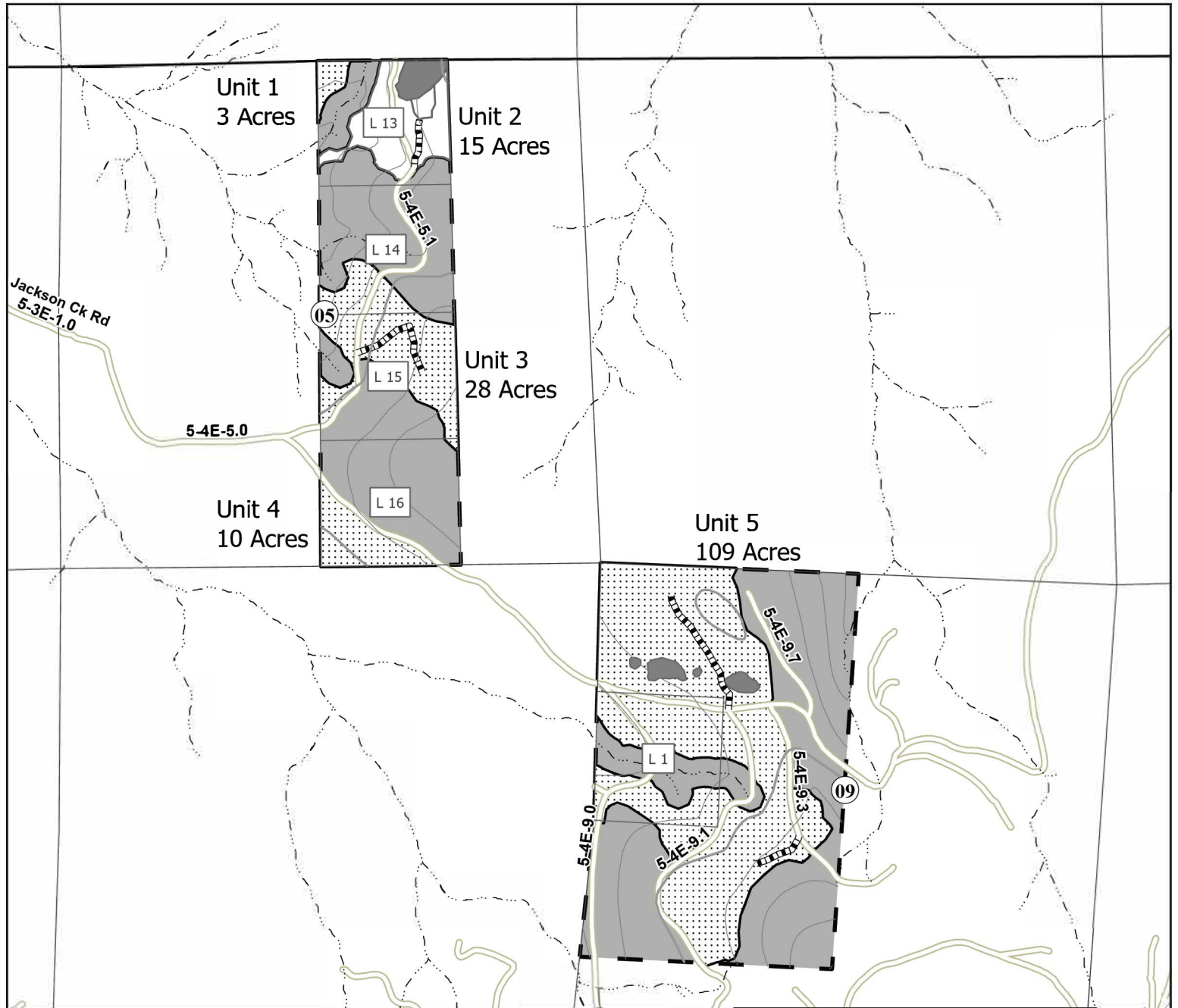

- Stream
- New Road Construction
- Existing Road
- Leave Island
- Partial Harvest Area
- Regeneration Harvest Area
- Reserve Area
- Sale Area
- Contract Area
- Lot

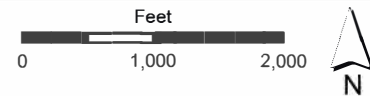

Contours: 100 Ft

Partial Harvest Area	15 Acres
- Leave Island	4 Acres
Regeneration Harvest Area	150 Acres
- Leave Island	3 Acres
Right-of-Way Clearing	2 Acres
Reserve Area	393 Acres

Unit boundaries are painted orange and posted. Acres do not include existing or new roads. Acreage was calculated based on global positioning system traverse procedures including differential correction. No warranty is made by the Bureau of Land Management as to the accuracy, reliability, or completeness of this map or the data displayed for individual use or aggregate use with other data.

Contract Area **567 Acres**

UNITED STATES
DEPARTMENT OF THE INTERIOR
BUREAU OF LAND MANAGEMENT

EXHIBIT B / PRE-SALE

5450-003

Contract No.

ORN01-TS-2026.0102

John Boy

The following estimates and calculations of value of timber sold are made solely as an administrative aid for determining: (1) adjustments made or credits given in accordance with Secs. 6, 9, or 11; (2) when payments are due; and (3) value of timber subject to any special bonding provisions. The value of timber will be determined by multiplying the value per acre as shown below, times the amount of acreage as determined by the Authorized Officer, which has been cut or removed or designated for taking. Except as provided in Sec. 2, Purchaser shall be liable for total purchase price even though quantity of timber actually cut or removed or designated for taking is less than the estimated volume or quantity shown. Cutting areas are shown on **Exhibit A**.

SPECIES	ESTIMATED VOLUME OR QUANTITY (Units Specified)		PRICE PER UNIT	ESTIMATED VOLUME OR QUANTITY X UNIT PRICE
Douglas Fir	6,368.0	MBF	\$325.10	\$2,070,236.80
Western Hemlock	1,359.0	MBF	\$206.30	\$280,361.70
Western Redcedar	96.0	MBF	\$461.60	\$44,313.60
TOTALS	7,823.0	MBF		\$2,394,912.10

The apportionment of the total purchase price is as follows:

Unit 1

Western Redcedar	2.0 MBF	X	\$461.60	=	\$923.20
Douglas Fir	117.0 MBF	X	\$325.10	=	\$38,036.70
Western Hemlock	27.0 MBF	X	\$206.30	=	\$5,570.10
Total	146.0 Mbf				\$44,530.00 ÷ 3.0 acres = \$14,843.33/Acre

Unit 2

Douglas Fir	502.0 MBF	X	\$325.10	=	\$163,200.20
Total	502.0 Mbf				\$163,200.20 ÷ 15.0 acres = \$10,880.01/Acre

Unit 3

Western Redcedar	18.0 MBF	X	\$461.60	=	\$8,308.80
Douglas Fir	1,087.0 MBF	X	\$325.10	=	\$353,383.70
Western Hemlock	253.0 MBF	X	\$206.30	=	\$52,193.90
Total	1358.0 Mbf				\$413,886.40 ÷ 28.0 acres = \$14,781.66/Acre

Unit 4

Western Redcedar	6.0 MBF	X	\$461.60	=	\$2,769.60
Douglas Fir	388.0 MBF	X	\$325.10	=	\$126,138.80
Western Hemlock	91.0 MBF	X	\$206.30	=	\$18,773.30
Total	485.0 Mbf				\$147,681.70 ÷ 10.0 acres = \$14,768.17/Acre

Unit 5

Western Redcedar	70.0 MBF	X	\$461.60	=	\$32,312.00
Douglas Fir	4,191.0 MBF	X	\$325.10	=	\$1,362,494.10
Western Hemlock	988.0 MBF	X	\$206.30	=	\$203,824.40
Total	5249.0 Mbf				\$1,598,630.50 ÷ 109.0 acres = \$14,666.33/Acre

UNITED STATES
DEPARTMENT OF THE INTERIOR
BUREAU OF LAND MANAGEMENT

EXHIBIT B / PRE-SALE

5450-003

Contract No.

ORN01-TS-2026.0102

John Boy

The following estimates and calculations of value of timber sold are made solely as an administrative aid for determining: (1) adjustments made or credits given in accordance with Secs. 6, 9, or 11; (2) when payments are due; and (3) value of timber subject to any special bonding provisions. The value of timber will be determined by multiplying the value per acre as shown below, times the amount of acreage as determined by the Authorized Officer, which has been cut or removed or designated for taking. Except as provided in Sec. 2, Purchaser shall be liable for total purchase price even though quantity of timber actually cut or removed or designated for taking is less than the estimated volume or quantity shown. Cutting areas are shown on **Exhibit A**.

<u>Unit RW</u>					
Douglas Fir	83.0 MBF	X	\$325.10	=	\$26,983.30
Total	83.0 Mbf				\$26,983.30 ÷ 2.0 acres = \$13,491.65/Acre

U.S. DEPT. OF THE INTERIOR
Bureau of Land Management
NORTHWEST OREGON DISTRICT
TIMBER SALE CONTRACT

Road Specifications

TABLE OF CONTENTS

Section	Description
	Road Plan Maps
	Road Plan and Detail Sheet
	Construction Notes
100	General
200	Clearing and Grubbing
300	Excavation and Embankment
400	Pipe Culverts
500	Renovation and Improvement of Existing Roads
600	Watering
1000	Aggregate Base Course - Crushed Rock
1200	Aggregate Surface Course - Crushed Rock
1700	Erosion Control
1800	Soil Stabilization
2100	Roadside Brushing



ROAD PLAN MAP - ORN01-TS-2026.0102
T. 5 S., R. 4 E., Section 5, 9; W.M.

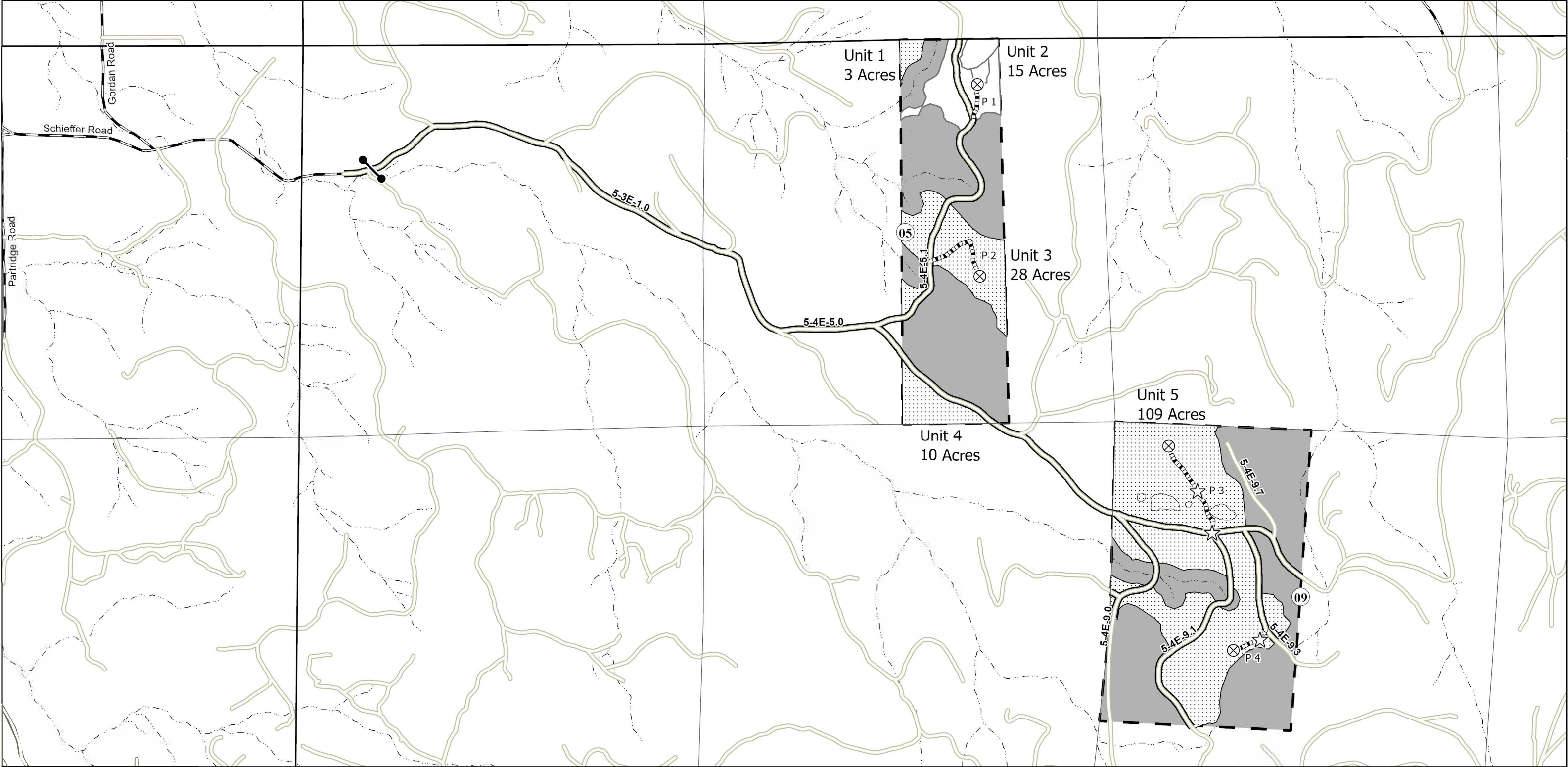

- | | | | |
|---------|-----------------------|---------------------------|---------------|
| Stream | Landing | Haul Route-Renovation | Contract Area |
| Gate | New Road Construction | Partial Harvest Area | Reserve Area |
| Culvert | Existing Road | Regeneration Harvest Area | |
| | County Road | Sale Area | |

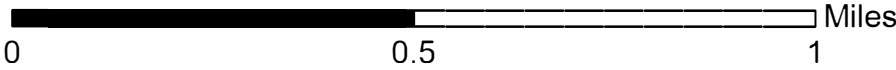

Contours: 100 Ft

No Warranty is made by the Bureau of Land Management as to the accuracy, reliability or completeness of these data for individual use or aggregate use with other data Original data was complied from multiple source data and may not meet U.S. National Mapping Accuracy Standard of the Office of Management and Budget. Date Exported: 12/3/2025

U.S. DEPT. OF THE INTERIOR
Bureau of Land Management
NORTHWEST OREGON DISTRICT OFFICE - SALEM
150: ROAD PLAN AND DETAIL SHEET

EXHIBIT C
JOHN BOY
ORN01-TS-2026.0102
PAGE 3 OF 27

Road Number	Seg.	Road Renovation Length (miles)	New Construct Length (miles)	Typical Section Type	Subgrade Width (ft)	Ditch Width (ft)	Length of Culverts to Install (Linear Feet)	Surfacing (*5)										Remarks
								Base Course: 1000					Surface Course: 1200					
								Min. Width	Comp. Depth	Surface Type (*3)	Grading Size (*3)	Estimated Cubic Yards	Min. Width	Comp. Depth	Surface Type (*3)	Grading Size (*3)	Estimated Cubic Yards	
5-3E-1.0	C-E	1.00		6	16	3				ABC			12'		ASC	C (1.5"-0)		300 c.y. of 1.5" spot rock included for maintenance in exhibit D
5-4E-5.0	A-F	1.68		6	16	3				ABC			12'		ASC	C (1.5"-0)		
5-4E-5.1	A-C	0.93		6	16	3				ABC			12'		ASC	C (1.5"-0)		
5-4E-9.0	A	0.35		6	16	3				ABC			12'		ASC	C (1.5"-0)		
5-4E-9.1	A	0.90		6	16	3				ABC			12'		ASC	C (1.5"-0)		
5-4E-9.3	A (part)	0.30		6	16	3												
P1			0.10	5	16	3												
P2			0.22	3,5	16	3												
P3			0.26	5	16	3	80										80	
P4			0.11	5	16	3	30											
TOTAL		5.16	0.69				110								ASC	C (1.5"-0)	80	

Quantities are estimates only and not pay items.
Purchaser shall provide an additional 300 cy of maintenance rock as noted in exhibit D. Total rock required = 380 l.c.y.

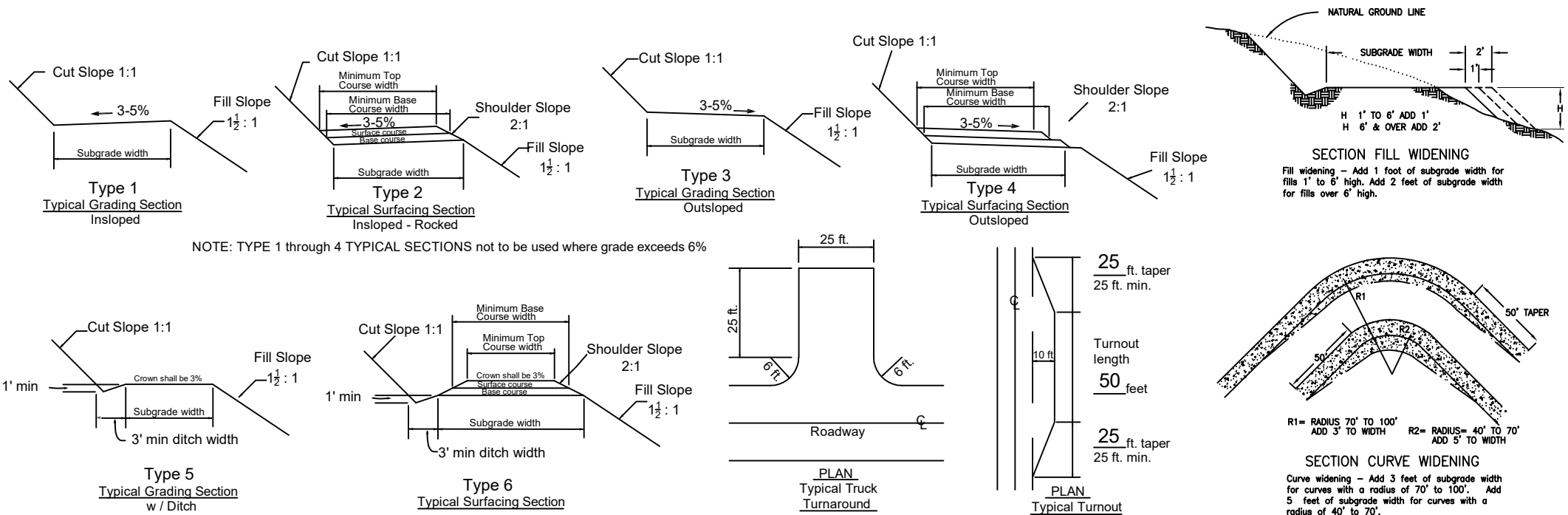

- *NOTES

 - Extra subgrade widths**
Add to each shoulder: 1 foot for fills of 1 to 6 feet. Widen inside or outside shoulder of tight curves as needed for log trucks to maneuver, with tires remaining on roadbed.
 - Backslopes**

Materials	Cut slopes	Fill slopes
Solid rock	1/2:1	Angle of repose
Soft rock and shale	3/4:1	1:1
Common		
Slopes under 55%	1:1	1-1/2:1
Slopes over 55%	1/2:1	1-1/2:1

Note:
Full bench construction is required on side slopes exceeding 50%.
Slope Ratio = Horizontal Distance:Vertical Distance (HD:VD)
 - Surface type**

	Grading
PRR - Pit run rock	C - 1 1/2" minus
GRR - Grid rolled rock	D - 1" minus (surface course)
SRN - Screened rock	E - 3/4" minus (surface course)
JRR - Jaw run rock	
ABC - Aggr. base course	A - 3" minus (base course)
ASC - Aggr. surface course	B - 2" minus (base course)
	C - 3" (base course)
 - Turnouts**
Width shall be 10 feet in addition to the subgrade width, with lengths as shown on this plan, or as directed by the Authorized Officer.
 - Surfacing**
Turnouts, curve widening, and the first 50 feet of all road aprons shall be surfaced, for all road stations requiring surfacing, as listed above, and as directed by the Authorized Officer.
 - Clearing width** 200
See Section
 - As posted and painted for Right-of-Way**, and as required in Section 2100 of this contract.
 - Grading (Renovation)** 500
See Section
 - Drainage** 400
See Section
 - Compaction** 300 and 500
See Sections





Road Renovation - BLM RD # 5-3E-1.0, 5-4E-5.0, 5.1, 9.0, 9.1 and 9.3	
Brush existing roads. Roads 1.0 and 5.0 will need a very light brushing, roads 5.1, 9.0, and 9.1 will require moderate brushing, and the 9.3 road will require heavy brushing and removal of alder stumps.	
Contractor may use a Cat for reconstruction of the 9.3 road.	
Pull the ditches and grade the road surface. Compact surface with water and roller.	
Clean existing culvert inlets and outlets, and dig out catch basins	

SPUR P1	
0+00	Begin new road construction to the right. Connect ditch from Spur P1 to the old pipe in the 5.1 road. Begin 13% grade
3+70	Construct a 30' wide by 70' long landing.
4+40	End of landing, Begin building skidding road 12' wide with 20 to 25% grade.
5+20	End skidding road in the patch cut area, no end landing required. End of Spur P1

SPUR P2	
0+00	Begin new road construction to the right at +14% grade. Fill through the ditch of the 5.1 road during road construction and logging operations. Fill shall be pulled back and the ditchline shall be left free to flow when road is not in use.
5+50	Slack grade to 12%, begin 60' radius switchback
6+80	End switchback, +14% grade ahead
11+00	Begin constructing a 60' x 60' landing
11+60	End of landing, End of Spur P2

SPUR P3	
0+00	Begin new road construction, construct a truck turn around in the junction. Install an 18"x50' metal culvert across the main road. Use 80 c.y. of 1 1/2 in minus rock to backfill the culvert, and to rock the junction. Transition to +13% grade ahead.
6+50	Install 18"x 30' metal pipe.
13+00	Begin constructing a 50' x 50' landing
13+50	End of landing, End of Spur P3

SPUR P4	
0+00	Begin new road construction. Install an 18"x30' metal culvert near the junction.
5+10	Begin constructing a 50' x 50' landing
5+60	End of landing, End of Spur P4

NEW CONSTRUCTION	
MAINTENANCE / RENOVATION	
SECTION LINE	
PROPERTY LINE	
NEW CULVERT	

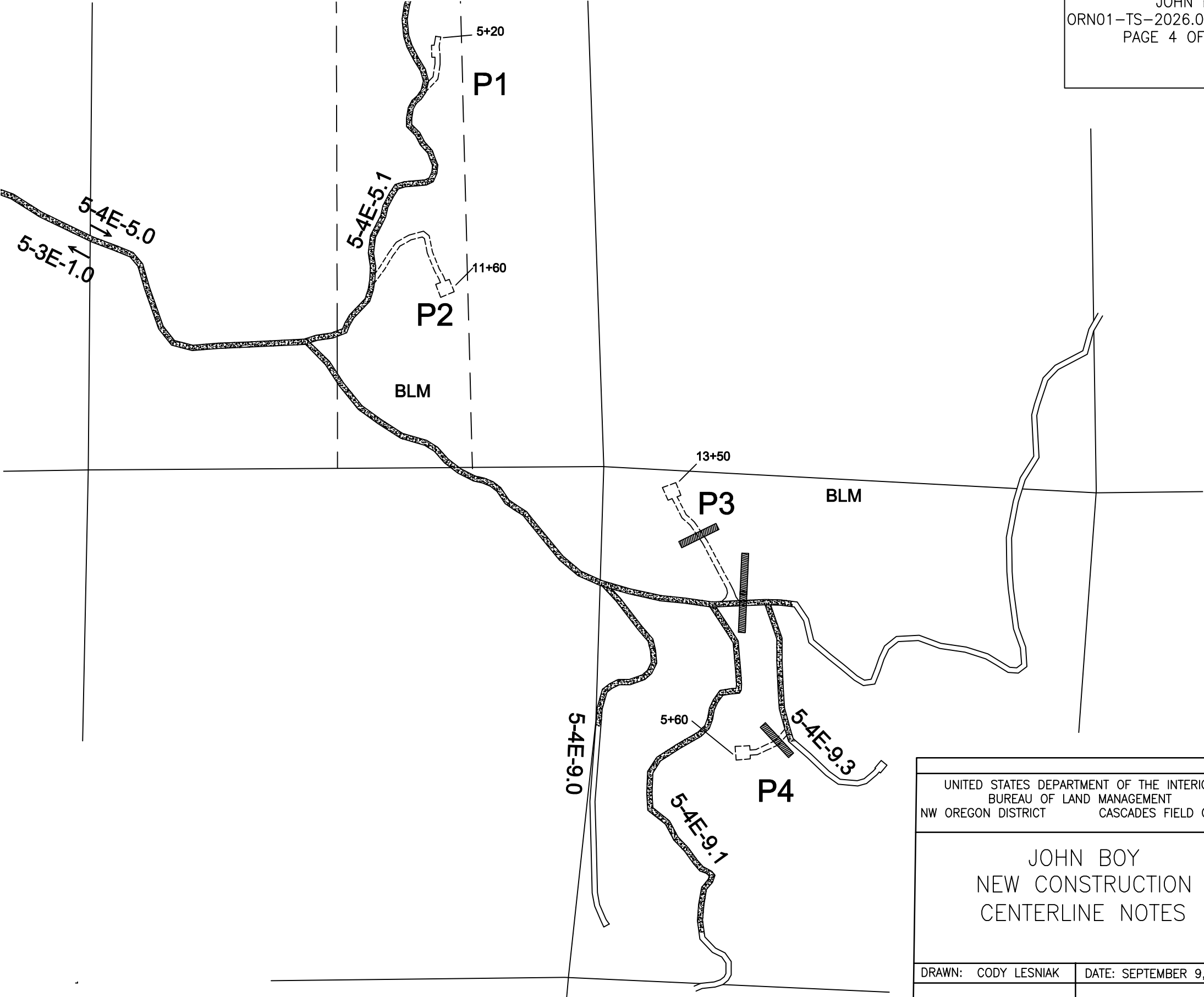
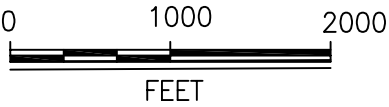

UNITED STATES DEPARTMENT OF THE INTERIOR
BUREAU OF LAND MANAGEMENT
NW OREGON DISTRICT CASCADES FIELD OFFICE

JOHN BOY
NEW CONSTRUCTION
CENTERLINE NOTES

DRAWN: CODY LESNIAK DATE: SEPTEMBER 9, 2025

GENERAL – 100

101 - Prewrite Conferences:

A prework conference will be held prior to the start of new construction and renovation operations. The Purchaser shall request the conference at least 48 hours prior to the time it is to be held. The conference will be attended by the Purchaser and/or his representatives, subcontractors and/or his or their representatives and the Authorized Officer and/or his representatives.

The purpose of the prework conference will be to review the required work, exhibits and specifications, and to establish a work schedule and a list of the Purchaser's representatives and subcontractors. A prework conferences shall be scheduled at a location agreed upon by all parties.

103 - Compaction equipment shall meet the following requirements:

103f - Vibratory roller. The drum diameter shall be not less than 48 inches, the drum width not less than 58 inches, and have a turning radius of 15 feet or less. Vibration frequency shall be regulated in steps to 1400, 1500, and 1600 vibrations per minute (VPM), corresponding to engine speeds of 1575, 1690, and 1800 RPM. The centrifugal force developed shall be 7 tons at 1600 RPM. It shall be activated by a power unit of not less than 25 horsepower. The vibratory roller shall be self-propelled or drawn by a vehicle of sufficient horsepower to enable the unit to travel through a loose layer of material at a speed ranging from 0.9 mile to 1.8 miles per hour, as directed by the Authorized Officer.

103i - Other. Compaction equipment approved by the Authorized Officer.

105 - All project activities shall meet the following BMP requirements:

105a - All heavy equipment shall be cleaned prior to initially entering or operating on BLM lands. The equipment shall be free of noxious weed seed, external petroleum residue, caked on dirt or grime, and other contaminants. Any leakage or contamination risk shall be corrected prior to continuing operation. An inspection by the Authorized Officer is required prior to beginning work.

105b - No refueling of any heavy equipment shall be done within 100 feet of standing or running water.

105c - The Purchaser and/or his representative(s), subcontractor(s) and/or his or their representative(s) shall comply with the following Sections of this contract in connection with any operations under this contract:

Section 26 - Watershed Protection

Section 27 - Refuse Control and Disposal of Waste Materials

Section 28 - Storage and Handling of Hazardous Material

CLEARING AND GRUBBING - 200

- 201 - This work shall consist of clearing, grubbing, removing and disposing of vegetation, debris, surface objects, and protruding obstructions within the clearing limits in accordance with these specifications and conforming to the lines, grades, dimensions and typical cross sections shown on the plans.
- 202 - Where clearing limits have not been staked, established by these specifications or shown on the plans, the limits shall extend 10 feet back of the top of the cut slope and 5 feet out from the toe of the fill slope.
- 202a - Where clearing limits for structures have not been staked or shown on the plans, the limits shall extend 10 feet out from the outside edge of the structure.
- 203 - Clearing shall consist of the removal and disposal of trees, logs, rotten material, brush, and other vegetative materials and surface objects in accordance with these specifications and within the limits established for clearing as specified under Subsections 202, and 202a, as shown on the plans, and as staked on the ground and/or as posted.
- 203b - Standing trees and snags to be cleared shall be felled within the limits established for clearing unless otherwise authorized.
- 204 - Grubbing shall consist of the removal and disposal of stumps, roots, and other wood material embedded in the ground and protruding obstacles remaining as a result of the clearing operation and in accordance with Subsections 204a, and 204c between the top of the cut slope and the toe of the fill slope.
- 204a - Stumps, including those overhanging cut banks, shall be removed within the required excavation limits.
- 204c - On excavated areas, roots and embedded wood shall be removed to a depth not less than 6 inches below the subgrade.
- 205 - Clearing and grubbing debris shall not be placed or permitted to remain in or under road embankment sections.
- 210 - Disposal of clearing and grubbing debris shall be by scattering over government owned lands outside of established clearing limits in a manner acceptable to the Authorized Officer. The areas for such scattering shall have the prior approval of the Authorized Officer.

CLEARING AND GRUBBING - 200

- 210a - Disposal of clearing and grubbing debris shall be by piling on government lands outside of established clearing limits in an area and in a manner acceptable to the Authorized Officer, when accumulations are too great to scatter.
- 210b - Disposal of clearing and grubbing debris, stumps and cull logs on non-government property by scattering this material outside of clearing limits will not be permitted unless the Purchaser obtains a written permit, or other approved documentation, from the property owner on whose property the disposal is to be made. The Purchaser shall furnish the Authorized Officer a certified copy of the permit and a written release from the property owner absolving the Government from responsibilities in connection with the disposal of debris on said property.
- 212 - No grading will be permitted prior to completion and approval by the Authorized Officer of the required clearing and grubbing work, except that stump grubbing may proceed with the excavation of the road prism.
- 213 - No clearing or grubbing debris shall be left lodged against standing trees or otherwise impede tree felling on any trees within the existing stands adjacent to the road construction.

TYPICAL CLEARING LIMITS

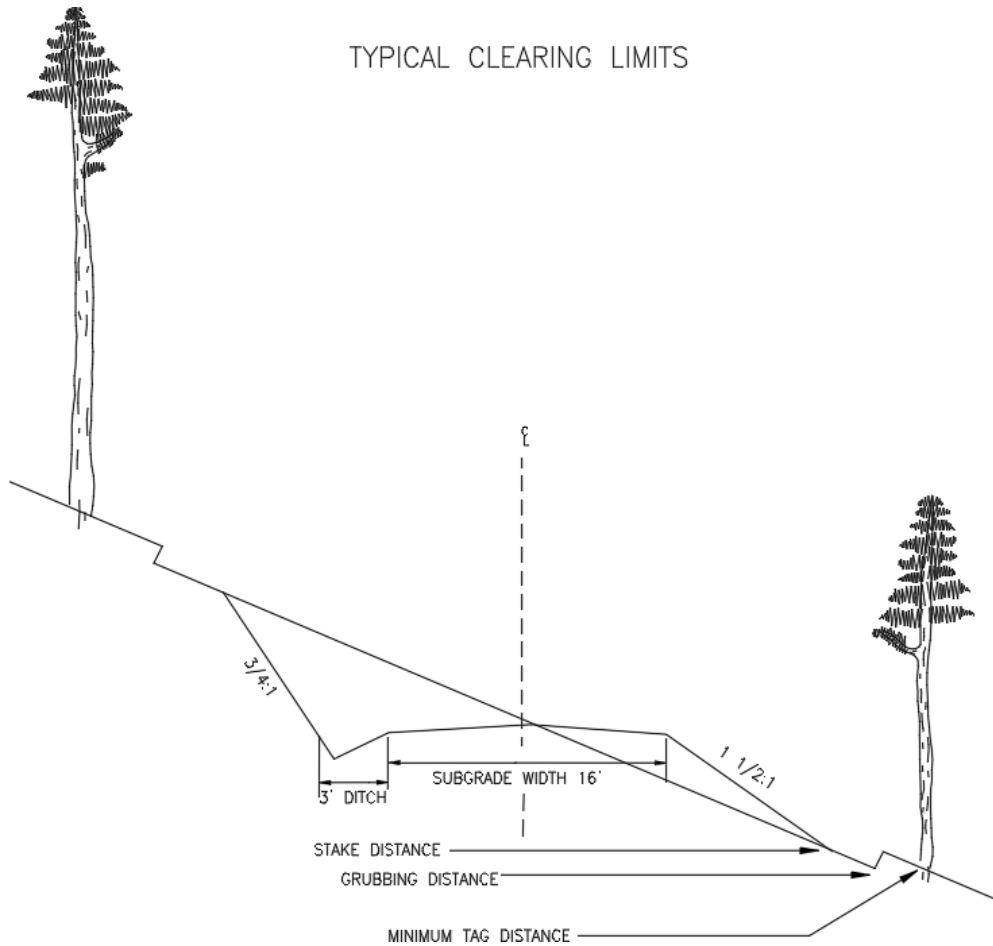

Side Slope %	Minimum Tag Distance uphill	Minimum Tag Distance downhill	Stake Distance uphill	Stake Distance downhill	Grubbing Distance uphill	Grubbing Distance downhill
0	18	17	11	10	16	15
5	18	17	11	10	16	15
10	19	17	12	10	17	15
15	19	18	12	11	17	16
20	20	19	13	12	18	17
25	20	21	13	14	18	19
30	21	23	14	16	19	21
35	23	27	16	20	21	25
40	24	32	17	25	22	30
45	26	38	19	31	24	36
50	26	18	19	11	24	16
55	27	18	20	11	25	16
60	29	18	22	11	27	16

Measurements in feet from centerline for a typical 16' subgrade
Full-bench construction shown in italics
Additional width required for junctions, turnouts, curves, culverts, etc.

EXCAVATION AND EMBANKMENT - 300

- 301 - This work shall consist of excavating, overhaul, placement of embankments, backfilling, borrowing, leveling, ditching, grading, in sloping, out sloping, crowning and scarification of the subgrade, compaction, disposal of excess and unsuitable materials, and other earth-moving work in accordance with these specifications and conforming to the lines, grades, dimensions, and typical cross sections shown on the plans.
- 302 - Excavation shall consist of the excavation of road and landing cut sections, borrow sites, backfilling, leveling, ditching, grading, compaction, and other earth moving work necessary for the construction of the roadway in accordance with these specifications and conforming to the lines, grades, dimensions, and typical cross sections shown on the plans.
- 303 - Suitable material removed from the excavation shall be used in the formation of embankment subgrade, shoulders, slopes, bedding, backfill for structures, and for other purposes as shown on the plans.
- 304 - Borrow shall consist of suitable material required for the construction of embankments or for other portions of the work; such material shall be obtained from sources selected by the Purchaser at his option and approved by the Authorized Officer.
- 305 - Embankment construction shall consist of the placement of excavated and borrowed materials, backfilling, leveling, grading, compaction, and other earth-moving work necessary for the construction of the roadway and landings in accordance with these specifications and conforming to the lines, grades, dimensions, and typical cross sections shown on the plans.
- 305a - Material used in the construction of embankment sections shall be free of stumps, cull logs, brush, muck, sod, roots, frozen material, and other deleterious materials and shall be placed and compacted as specified.
- 305b - Embankment materials shall be placed in successive parallel layers on areas cleared of stumps, cull logs, brush, sod, and other vegetative and deleterious materials, except as provided under Subsection 204. Roadway embankments of earth material shall be placed in horizontal layers not exceeding 8 inches in depth.

EXCAVATION AND EMBANKMENT - 300

- 306 - Layers of embankment and final subgrade material as specified under Subsections 305a and 305b shall be moistened or dried to a uniform optimum moisture content suitable for maximum density and compacted to full width with compacting equipment conforming to requirements of Subsection 103i.
- 306a - Minimum compaction for each layer of embankment material placed at optimum moisture shall be 1 hour of continuous compacting for each 6 stations of road or fraction thereof.
- 306e - The final subgrade including landings and turnouts shall be compacted to full width with compacting equipment conforming to the requirements of 103i. Minimum compaction shall be 1 hour of continuous compacting for each 6 stations of road or a fraction of as measured along the center line of the constructed road.
- 306f - Compaction of embankment layers placed as specified under Subsection 305b above shall be accomplished by routing construction equipment over full width of embankment structures.
- 306g - All fill slopes shall be compacted to (75) percent of maximum density, either by walking with cat/excavator or by pressing with excavator bucket, to prevent surface erosion and raveling.
- 313 - In cut areas where solid rock is encountered at, or near subgrade, the rock shall be excavated to a minimum depth of 6 inches below subgrade elevation and the excavated area backfilled with suitable material. The backfill material shall be processed to the optimum moisture content suitable for maximum density and compacted to full width in accordance with the requirements of Subsection 306e.
- 314 - When heavy clays, muck, clay shale, or other deleterious material for forming the roadbed is encountered in cuts at subgrade, it shall be excavated to a minimum depth of 2 feet below the subgrade elevation and the excavated area backfilled with a selected borrow material approved by the Authorized Officer. The backfill material shall be uniformly moistened or dried to the optimum moisture content suitable for maximum density in accordance with the requirements of subsection 306. Unsuitable material shall be disposed of as directed by the Authorized Officer.
- 315 - Borrow material required for construction of embankment or for other portions of the work shall be obtained from sources as shown on the plans.
- 316 - Borrow material from sources selected at the Purchaser's option shall be inspected and approved in writing by the Authorized Officer prior to placement.

EXCAVATION AND EMBANKMENT - 300

- 318 - Selected borrow or selected roadway excavation material shall be uniformly spread on the roadbed in lifts not to exceed 12 inches in depth until the required thickness shown on the plans is attained.
- 319 - Each layer shall be uniformly moistened or dried to the optimum moisture content suitable for maximum density and compacted to full width in accordance with the requirements of Subsection 306.
- 320 - Ditches shall conform to the slope, grade, dimensions, and shape of the required cross section shown on the plans. Roots, stumps, rocks, and other projections shall be removed to form smooth, even slopes.
- 321 - Excess excavated, unsuitable, or slide materials shall not be disposed of on areas where the material will encroach on a stream course or other body of water. Such materials shall be disposed of in accordance with Subsection 321c. Materials not disposed of in this manner shall be retrieved and disposed of at the Purchaser's expense and at the direction of the Authorized Officer.
- 321c - End-dumping will be permitted for the placement of excess materials under Subsection 321 in designated disposal areas or within areas approved by the Authorized Officer. Watering, rolling, and placement in layers are not required. Materials placed shall be sloped, shaped, and otherwise brought to a visible condition acceptable to the Authorized Officer.
- 324 - Excavated material shall not be allowed to cover boles of standing trees to a depth in excess of 1 foot on the uphill side.
- 327 - The finished grading shall be approved by the Authorized Officer in segments or for the total project. The Purchaser shall give the Authorized Officer 3 days' notice prior to final inspection of the grading operations.

PIPE CULVERTS - 400

- 401 - This work shall consist of furnishing and installing pipe culverts and other erosion control devices in accordance with these specifications and conforming to the lines, grades, dimensions, and typical cross sections shown on the plans. Individual lengths and locations are approximate; final lengths and locations will be determined by the Authorized Officer upon installation of the appurtenance structures. Additional pipe and erosion control devices may be required at the option of the Authorized Officer, in which case a reduction in the total purchase price shall be

PIPE CULVERTS - 400

made to offset the cost of furnishing and installing such items. Costs will be based upon the unit prices set forth in the current BLM Timber Appraisal Production Cost Schedule.

- 403 - Grade culverts shall have a gradient of from 2 percent to 4 percent greater than adjacent road grade. Grade culverts shall be skewed down grade 30 degrees as measured from the perpendicular to the centerline unless otherwise specified on the plans.
- 406 - Coupling bands shall conform to the requirements of AASHTO M 36 and AASHTO M 218 or AASHTO M 274 with the exception of band widths and the "Hugger"-type band which shall conform to the details, dimensions, and typical diagram shown on the plans.
- 408 - Pipe culverts and pipe-arch culverts shall be placed on the bed starting at the downstream end with the inside circumferential laps pointing downstream and with the longitudinal laps at the side or quarter points. Coupling bands of the type required under these specifications shall be installed to provide the circumferential and longitudinal strength necessary to preserve the pipe alignment, prevent separation of the pipe sections, and minimize infiltration of fill material.
- 410 - Pipe shall be unloaded and handled with reasonable care. If the Authorized Officer determines any structure is damaged to the extent that it is unsuitable for use in the road construction, it shall be replaced at the Purchaser's expense.
- 411 - Trenches necessary for the installation of pipe culverts shall conform to the lines, grades, dimensions, and typical diagram and the Culvert Installation Detail Sheet.
- 412 - Where ledge rock, boulders, soft, or spongy soils are encountered, they shall be excavated a minimum of 12 inches below the invert grade for a width of at least one pipe diameter or span on each side of the pipe and shall be backfilled with selected granular or fine readily compactable soil material.
- 413 - Pipe culverts and pipe-arch culverts shall be bedded on a fine readily compactable soil material having a depth of not less than 6 inches as shown on plans. Foundation material shall be of uniform density throughout the length of the structure and shall be shaped to fit the pipe.
- 416 - Side-fill material for pipe culverts shall be placed within 1 pipe diameter, or a minimum of 2 feet, of the sides of the pipe barrel, and to 1 foot over the pipe fine readily compactable soil or granular fill material free of excess moisture, muck, frozen material, roots, sod, or other deleterious or caustic material and devoid of

PIPE CULVERTS - 400

rocks or stones of sizes which may impinge upon and damage the pipe or otherwise interfere with proper compaction.

- 419 - The pipe culvert after being bedded and backfilled as required by these specifications shall be protected by a 1-foot cover of fill before heavy equipment is permitted to cross the drainage structure. Removal of the protection fill shall be as directed by the Authorized Officer.
- 423 - Construction of catch basins and ditch dams conforming to lines, grades, dimensions and typical diagrams shown on the plans, shall be required for grade culverts.
- 424 - Construction of splash pads conforming to lines, grades, dimensions and typical diagram shown in the plans, shall be required and at the specified locations and with riprap amounts as stated in the table in Subsection 401.
- 426 - Culvert markers consisting of 5-foot steel fence posts painted green with white top, shall be furnished, fabricated, and installed by the Purchaser at grade culverts as shown on the plans and as directed by the Authorized Officer.
- 427 - Record culvert sizes, lengths and location (installed) on a copy of the culvert list. This culvert list shall be furnished to the Authorized Officer.
- 428 - Remove and dispose of old culverts in a legal manner, and for any fees required. The Purchaser shall remove the old culverts from the work site within three 3 working days of completion of the culvert replacement work for each road prior to road acceptance.
- 429 - Keep the excavation site dewatered so that the installation of culverts is completed under dry conditions. Dispose of excess water by using pumping or natural drainage ways near the site in a manner that will avoid damage to adjacent property. Diversion streams shall not be returned to the natural channel until all in-stream work has been completed.

CULVERT SUMMARY																	
Culvert Locations												Culvert Markers	Downspout (4)				Remarks (6)
Designed						As Built											
Road No.	Station (1)	Diameter (in)	Material (2)	Length (ft) (1)	Skew Angle	Installation Type (3)	Road No.	Station	Diameter (in)	Gage	Length (ft)		Type	Diameter (in)	Length	Type of Elbow (5)	
P3	0+00	18	CMP	30													
P3	6+50	18	CMP	50													
P4	0+00	18	CMP	30													
Total				110													

- (1) Designed culvert lengths and locations are approximate.
 (2) Material: ASP=Aluminized Squash Pipe CPP=Corrugated Poly Pipe CMP=Corrugated Metal Pipe
 (3) See Culvert Installation sheet.
 (4) Downspout Types: 1 = Full Round 2 = Half Round 3 = Rectangular Flume
 (5) Elbow Types: 1 = Conventional or Fabricated 2 = Turner Type 3 = Slip Joint
 (6) Include special sections, structures, headwalls, footings, and other data.

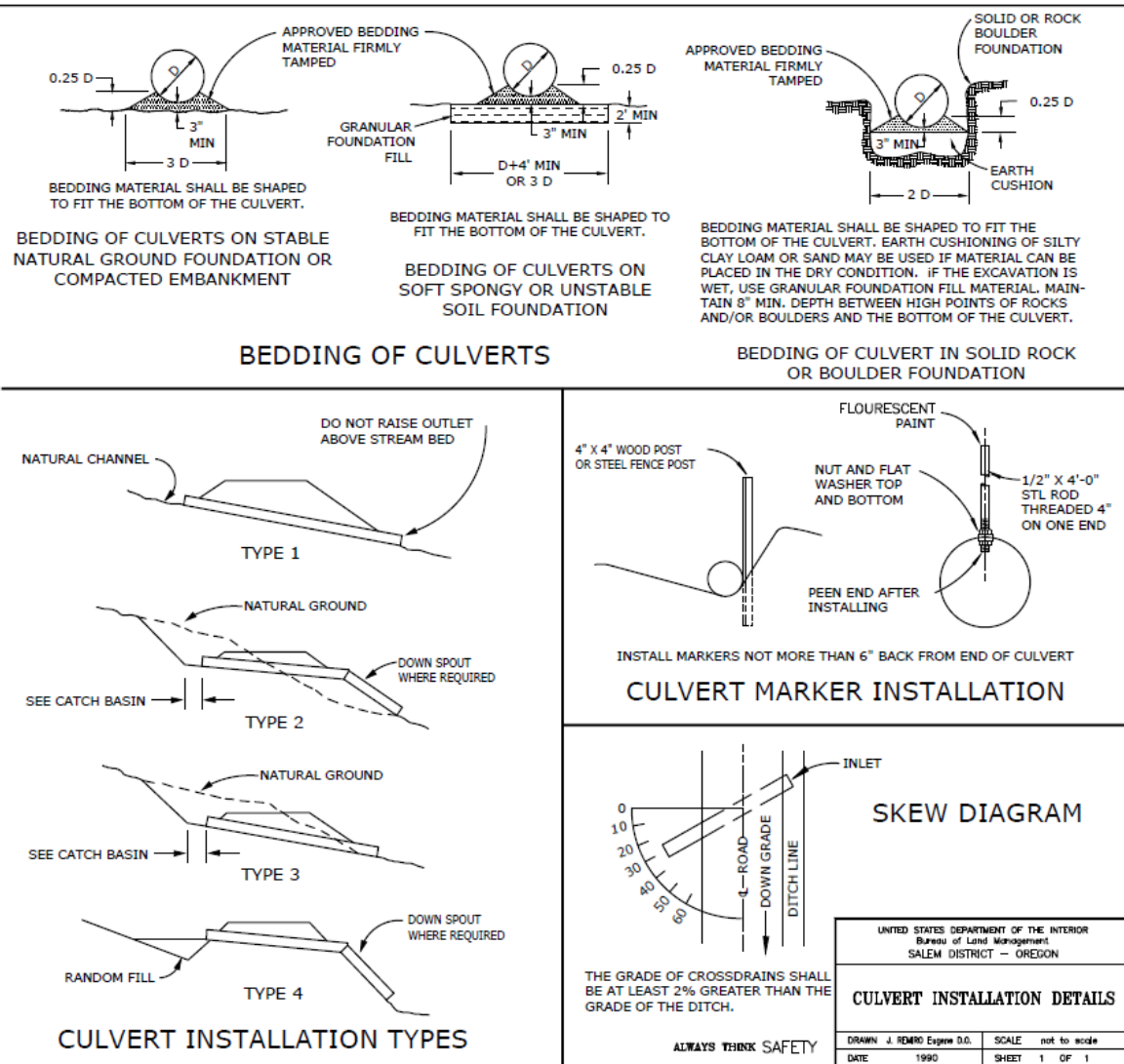
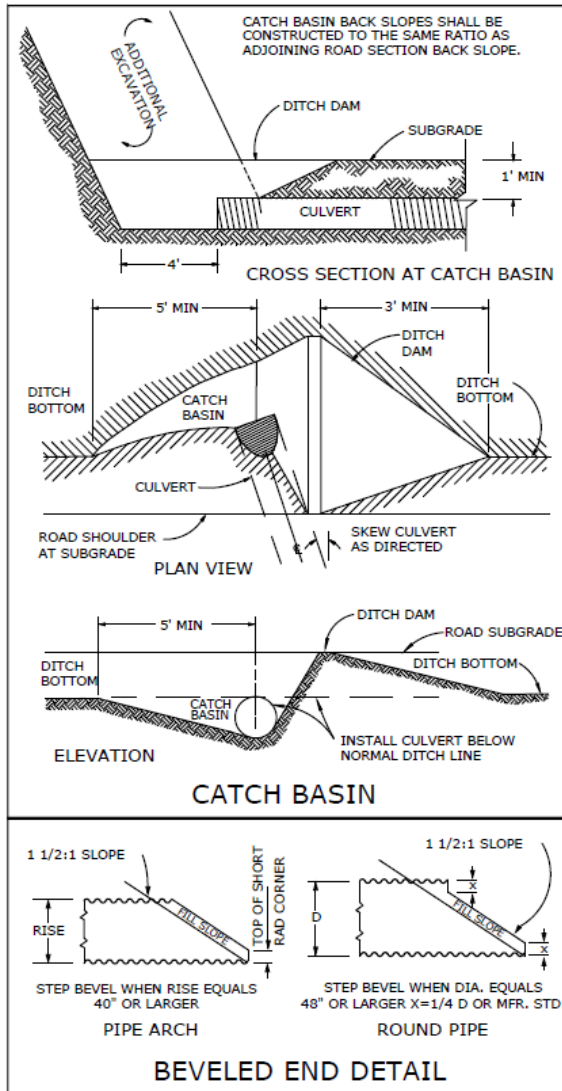

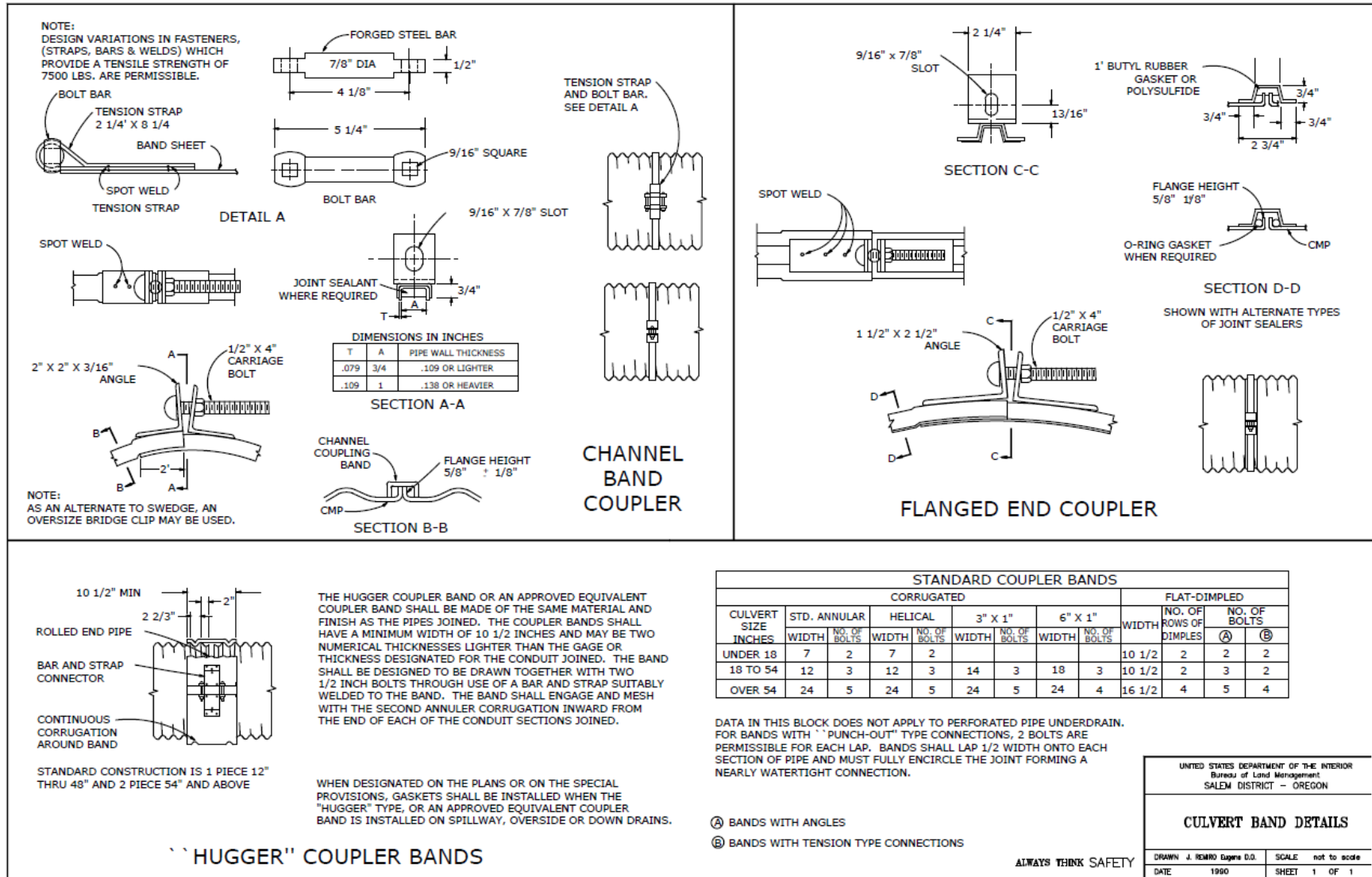

RENOVATION AND IMPROVEMENT OF EXISTING ROADS - 500

- 501 - This work shall consist of reconditioning and preparing the roadbed and shoulders, minor excavation and/or embankment, cleaning and shaping drainage ditches, trimming vegetation from cut and embankment slopes, and cleaning and repairing drainage structures of existing roads in accordance with these specifications as shown on the plans.
- 502 - The existing road surface shall be bladed and shaped to the lines, grades, dimensions, and typical cross sections shown on the plans.
- 504 - Existing road surface shall be uniformly moistened or dried to the optimum moisture content suitable for maximum density and compacted to full width with equipment conforming to requirements of Subsections 103i.
- 504a - Minimum compaction required shall be 1 hour of continuous rolling for each 6 stations of road, or fraction thereof, as measured along the centerline per layer of material.
- 506 - The inlet end of existing drainage structures shall be cleared of vegetative debris and boulders that are of sufficient size to obstruct normal stream flow. Pipe inverts shall be cleared of sediment and other debris lodged in the barrel of the pipe. The outflow area of pipe structures shall be cleared of rock and vegetative obstructions which will impede the structure's designed outflow configuration. Catch basins shall conform to the lines, grade, dimensions, and typical diagram shown on the plans.
- 507 - Existing and new drainage structures listed in the Culvert Summary in Section 400 shall be replaced and placed with structures of the type, gauge, diameter, and length shown on the plans and in accordance with the placement requirements set forth under Section 400 of these specifications.
- 509 - The finished grading shall be approved by the Authorized Officer 3 days prior to surfacing operations. The Purchaser shall give the Authorized Officer 3 days' notice prior to final inspection of the grading operations.

WATERING - 600

- 601 - This work shall consist of furnishing and applying water required for the compaction of embankments, roadbeds, backfills, base courses, surface courses, finishing and reconditioning of existing roadbeds, laying dust, or for other uses in accordance with these specifications.

WATERING - 600

- 602 - Water, when needed for compaction or laying dust, shall be applied at the locations, in the amounts, and during the hours as directed by the Authorized Officer. Amounts of water to be provided will be the minimum needed to properly execute the compaction requirements in conformance with these specifications.
- 603 - Water trucks used in this work shall be equipped with a distributing device of ample capacity and of such design as to ensure uniform application of water on the road bed.
- 604 - Water required under these specifications is subject to applicable State water regulations.
- 605 - The Purchaser shall secure the necessary water permits for use of water source(s) selected by the Purchaser and approved by the Authorized Officer.

AGGREGATE BASE COURSE - 1000
CRUSHED ROCK MATERIAL

- 1001 - This work shall consist of furnishing, hauling, and placing one or more lifts of crushed rock material on roadbeds approved for placing crushed rock material, in accordance with these specifications and conforming to the dimensions and typical cross sections shown on the plans. Material not conforming to these specifications will be rejected and shall be removed from the road at the purchaser's expense.
- 1002a - Crushed rock materials may be obtained from commercial sources selected by the Purchaser at his option and expense providing that the rock materials selected comply with the specifications in this section.
- 1003 - Crushed rock material produced from gravel shall have 3 manufactured fractured faces on 65 percent, by weight, of the material retained on the No. 4 sieve.
- 1004 - Crushed rock materials shall consist of hard durable rock fragments conforming to the following gradation requirements:

AGGREGATE BASE COURSE
CRUSHED ROCK MATERIAL

Percentage by Weight Passing Square Mesh Sieves
(AASHTO T 11 & T 27)
GRADATION

Sieve Designation	A	B	C	D	F	G	H	I
(6) -inch	-	-	-	-	-	-	-	100
3-inch	100	-	100	-	100	-	-	45-65
2-inch	90-95	100	-	100	65-95	100	100	-
1 1/2-inch	-	90-95	-	-	-	-	-	-
1-inch	45-75	50-90	-	-	-	50-85	60-90	-
3/4-inch	-	-	-	-	28-70	-	-	-
1/2-inch	-	-	-	-	-	27-60	44-70	-
3/8-inch	-	-	-	-	-	-	-	-
No. 4	15-45	15-50	-	-	10-35	15-40	28-50	0-10
No. 8	-	-	-	-	-	-	20-41	-
No. 10	-	-	-	-	-	-	-	-
No. 30	-	-	-	-	5-22	8-26	9-26	-
No. 40	5-25	5-25	-	-	-	-	-	-
No. 200	2-15	2-15	-	-	3-10	3-12	3-12	-

- 1006 - Crushed rock material shall show durability value of not less than 35, as determined by AASHTO T 210.
- 1008 - If additional binder or filler is necessary in order to meet the grading or plasticity requirements, or for satisfactory bonding of the material, it shall be uniformly blended with the crushed rock material at the crushing and screening plant prior to placing on the road, unless otherwise agreed. The material for such purposes shall be obtained from sources approved by the Authorized Officer and shall be free from stones, vegetative matter, and other deleterious materials.
- 1008a - Each layer of crushed rock material shall be thoroughly mixed on the roadbed by alternately blading, to full depth, until a uniform mixture has been obtained. The mixture shall then be spread to full width. When completed, the spreading shall produce a surface which is smooth, presents uniform shoulder lines, and conforms to the specified cross section.
- 1009 - The roadbed, as shaped and compacted under Sections 300 and 500 of these specifications, shall be approved by the Authorized Officer prior to placement of crushed rock materials.

AGGREGATE BASE COURSE - 1000
CRUSHED ROCK MATERIAL

- 1010 - Crushed rock materials shall be placed and processed on the approved roadbed in accordance with these specifications and conforming to the lines, grades, dimensions, and typical cross sections shown on the plans and compacted in layers not to exceed 6 inches in depth. When more than one layer is required, each shall be shaped, processed, compacted, before the succeeding layer is placed. Irregularities or depressions that develop during compaction of the top layer shall be corrected by loosening the material at these places and adding or removing crushed rock material until the surface is smooth and uniform.
- 1010a - Crushed rock material used to repair or reinforce a soft, muddy, frozen, yielding, or rutted roadbed shall not be construed as surfacing under this specification.
- 1011 - Crushed rock material shall be compacted by routing construction and hauling equipment over the full width of each layer placed.
- 1012 - Each layer of crushed rock material shall be placed, processed, shaped, moistened or dried to a uniform moisture content suitable for maximum compaction, and compacted to full width by compaction equipment conforming to the requirements of Subsection 103i. Minimum compaction shall be deemed adequate when the surface can withstand five passes of a truck with H-20 loading without appreciable deformation.
- 1013 - Each layer of crushed rock material for base placed, processed, and shaped as specified shall be uniformly moistened or dried to the optimum moisture content suitable for maximum density and compacted to full width until a uniform density of not less than 95 percent of the maximum density is attained as determined by AASHTO T 99, Method D.

AGGREGATE SURFACE COURSE - 1200
CRUSHED ROCK MATERIAL

- 1201 - This work shall consist of furnishing, hauling, and placing one or more layers of crushed rock material on base courses approved for placing crushed rock material in accordance with these specifications and conforming to the dimensions and typical cross sections shown on the plans. Material not conforming to these specifications will be rejected, and shall be removed from the road at the purchaser's expense.
- 1202a - Crushed rock materials used in this work may be obtained from commercial sources selected by the Purchaser at his option and expense, providing the rock materials furnished comply with the specifications.

AGGREGATE SURFACE COURSE - 1200
CRUSHED ROCK MATERIAL

- 1203 - When crushed rock material is produced from gravel, not less than 65 percent by weight of the particles retained on the No. 4 sieve will have 3 manufactured fractured faces.
- 1204 - Crushed rock material shall consist of hard durable rock fragments conforming to the following gradation requirements:

AGGREGATE SURFACE COURSE
CRUSHED ROCK MATERIAL

Percentage by weight passing square mesh sieves
AASHTO T 11 & T 27
GRADATION

Sieve Designation	C	C-1	D	D-1	E	E-1
1-1/2-inch	100	100	-	-	-	-
1-inch	-	-	100	100	-	-
3/4-inch	50-90	60-90	-	70-98	100	100
1/2-inch	-	-	-	-	-	70-98
No. 4	25-50	30-55	30-60	36-60	40-75	44-70
No. 8	-	22-43	-	25-47	-	30-54
No. 30	-	11-27	-	12-31	-	15-34
No. 40	5-25	-	5-30	-	5-35	-
No. 200	2-15	3-15	3-15	3-15	2-15	3-15

- 1206 - Crushed rock material shall show a durability value of not less than 35 as determined by AASHTO T210.
- 1208 - If additional binder or filler material is necessary to meet the grading or plasticity requirements or for satisfactory bonding of the material, it shall be uniformly blended with the crushed rock material at the crushing and screening plant prior to placing on the road, unless otherwise agreed. The material for such purposes shall be obtained from sources approved by the Authorized Officer and shall be free from stones, vegetative matter, and other deleterious materials.
- 1208a - Each layer of crushed rock material shall be thoroughly mixed on the roadbed by alternately blading, to full depth, until a uniform mixture has been obtained. The mixture shall then be spread to full width. When completed, the spreading shall produce a surface which is smooth, presents uniform shoulder lines, and conforms to the specified cross section.

AGGREGATE SURFACE COURSE - 1200
CRUSHED ROCK MATERIAL

- 1209 - Shaping and compacting of roadbed and base course shall be completed and approved, prior to placing crushed rock material, in accordance to the requirements of Subsections 300 and 500 for placing on the roadbed and landings and Subsection 1000 for placing on the base course. Notification for final inspection prior to rocking shall be 7 days prior to the inspection and shall be 10 days prior to start of surfacing operations.
- 1210 - Crushed rock material conforming to the requirements of these specifications shall be placed on the approved roadbed, landings, and base course in accordance with these specifications and conforming to the lines, grades, dimensions, and typical cross sections shown on the plans. Compacted layers shall not exceed 4 inches in depth. When more than one layer is required, each shall be shaped, processed, compacted, and approved by the Authorized Officer before the succeeding layer is placed. Irregularities or depressions that develop during compaction of the top layer shall be corrected by loosening the material at these places and then adding or removing crushed rock material until the surface is smooth and uniform.
- 1210a - Crushed rock material used to repair or reinforce soft, muddy, frozen, yielding, or rutted roadbed shall not be construed, as surfacing required by this specification.
- 1212 - Each layer of crushed rock material placed, processed, and shaped as specified shall be moistened or dried to a uniform moisture content suitable for maximum compaction and compacted to full width by compacting equipment conforming to the requirements of Subsection 103i. Minimum compaction shall be 1 hour of continuous compacting for each 6 stations, or fraction thereof.
- 1213 - Each layer of crushed rock material placed, uniformly processed, and shaped as specified shall be uniformly moistened or dried to the optimum moisture content suitable for maximum density and compacted to full width until a uniform density of not less than 95 percent of maximum density is attained as determined by AASHTO T 99, Method C or D.

Summary of Rock Quantities

Road Number	Minor Road Renovation Length (miles)	Major Road Renovation Length (miles)	New Construct Length (miles)	Base Course (3"-0)					Surface Course: (1.5"-0)				
				Road	Patch	Culverts	Slump	Estimated Cubic Yards	Road	Patch	Culverts	Slump	Estimated Cubic Yards
P3			0.26										80
Exhibit D - Maintenance Rock													300
TOTAL	0.00	0.00	0.26					0					380

EROSION CONTROL – 1700

- 1701 - This work shall consist of measures to control soil erosion or water pollution during the construction operation through the use of berms, dikes, dams, sediment basins, fiber mats, netting, gravel, mulches, grasses, slope drains, and other erosion control devices or methods in accordance with these specifications and conforming to the lines, grades, dimensions and typical cross sections shown on the plans.
- 1704 - The erosion control provisions specified under this Subsection shall be coordinated with the Soil Stabilization requirements of Section 1800.
- 1708a - Road segments not completed during dry weather periods shall be winterized, by providing a well-drained roadway using water bars, maintaining drainage, and performing additional measures necessary to minimize erosion and other damage to the roadway, as directed by the Authorized Officer. Portions of roads not having surface rock in place will be blocked or barricaded to prevent vehicular traffic.

SOIL STABILIZATION – 1800

- 1801 - This work shall consist of seeding and mulching on designated cut, fill, borrow, disposal, and special areas in accordance with these specifications. This work is required for road acceptance under Section 18 of this contract.
- 1802a - Soil stabilization work consisting of seeding and mulching shall be performed on disturbed areas and special areas in accordance with these specifications and as shown on the plans.
- 1803 - Soil stabilization work as specified under Subsection 1802a shall be performed during the following seasonal periods:

From: September 15	To: October 30
From: March 1	To: April 31

If soil stabilization of disturbed areas is not completed by the specified fall date, the Purchaser shall treat disturbed areas and then complete the requirements of Section 1800 the next construction season. The Authorized Officer may modify the above seasonal dates to conform to existing weather conditions and changes in the construction schedule.

- 1803a - The Purchaser shall begin soil stabilization work within 10 days of the starting work date when notified by the Authorized Officer.
- 1804 - The Purchaser shall provide native grass/forb seed or other plant materials for this project.

All seed provided must meet corresponding germination, purity, and weed-content requirements:

Species	Germination Min. %	Purity Min. %	Weed Content Max. %
Blue Wildrye (Elymus Glaucus)	75	99	1

The Purchaser shall furnish the Authorized Officer a Seed Test Result for the mix from a certified seed testing lab Oregon State University, Crop Certification Service, which shall include: date of test; lot number of each kind of seed; and results of tests as to name, percentages of purity and of germination, weed species and percentage of weed content, for each kind of seed furnished and, in case of mixture, the proportions of each kind of seed. The seed must have been tested within the last 6 months to be accepted for use on this contract. The Purchaser shall provide in writing that the seed mixture is free of noxious weed species.

SOIL STABILIZATION – 1800

- 1806a - Additional soil stabilization work consisting of seeding and mulching, may be required at the option of the Authorized Officer. Providing the additional stabilization is not due to Purchaser negligence as specified in Sec. 12 of the contract, a reduction in the total purchased price shall be made to offset the cost of furnishing and applying such additional stabilization material. Cost shall be based upon the unit price set forth in the current BLM Timber Appraisal Production Cost Schedule.
- 1808 - Mulch materials conforming to the requirements of Subsection 1808a shall be furnished by the Purchaser and applied in accordance with Subsection 1812.
- 1808a - Straw mulch shall be certified weed free from commercial grain fields and native grass fields. Straw mulch shall be from oats, wheat, rye, or other approved grain crops and shall be free from, mold, or other objectionable material. Straw mulch shall be in an air-dry condition and suitable for placement.
- 1809 - Mulch material shall be delivered to the work area in a dry state. Material found to be wet will not be accepted. Material to be used in the mulching operation may be stockpiled along the road designated for treatment provided that it is maintained in a dry state and has the approval of the Authorized Officer.
- 1812 - The Purchaser shall furnish and apply to the area designated for treatment as shown on the plans, a mixture of grass seed and mulch, material at the application rate to be determined by the Authorized Officer based on visual observation of trial applications.
- 1814 - The Purchaser may reduce the application rate on partially covered slopes and refrain from application on areas already well stocked with grass or on rock surfaces as determined by the Authorized Officer.
- 1815 - The seed and mulch materials shall be placed by the dry method in accordance with the requirements set forth in Subsection 1815b.
- 1815b - Dry Method - Blowers, mechanical seeders, seed drills, landscape seeders, cultipacker seeders, fertilizer spreaders, or other approved mechanical seeding equipment may be used when seed and fertilizer are to be applied in dry form.
- 1821 - Mulch that collects at the end of culverts or accumulates to excessive depths on the slopes shall be evenly spread by hand methods, as directed by the Authorized Officer.

ROADSIDE BRUSHING - 2100

- 2101 - This work shall consist of the removal of vegetation from the road prism - variable distance, and inside curves in accordance with these specifications and conforming to the lines, grades, dimensions, and typical cross sections shown on the Roadside Brushing Detail Sheet of this exhibit, at designated locations as shown in the plans.
- 2102 - Roadside brushing may be performed mechanically with self powered, self-propelled equipment and or manually with hand tools, including chain saws.
- 2103 - Vegetation cut manually or mechanically less than 6 inches in diameter at D.B.H.O.B. shall be cut to a maximum height of 2 inches above the ground surface or above obstructions such as rocks or stumps on cut and fill slopes and all limbs below the 2 inch area will be severed from the trunk.
- 2109 - Debris resulting from this operation shall be scattered downslope from the roadway. Debris shall not be allowed to accumulate in concentrations. Debris in excess of foot in length and 2 inches in diameter shall not be allowed to remain on cut slopes, ditches, roadways or water courses, or as directed by the Authorized Officer.
- 2115 - Mechanical brush cutters shall not be operated when there are people and occupied vehicles within 400 feet of the immediate operating area.
- 2116 - Traffic warning signs shall be required at each end of the work area. Signs shall meet the requirements of the Manual on Uniform Traffic Devices.

ROADSIDE BRUSHING DETAIL SHEET

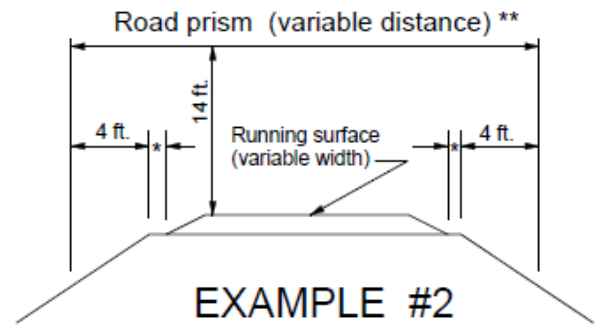
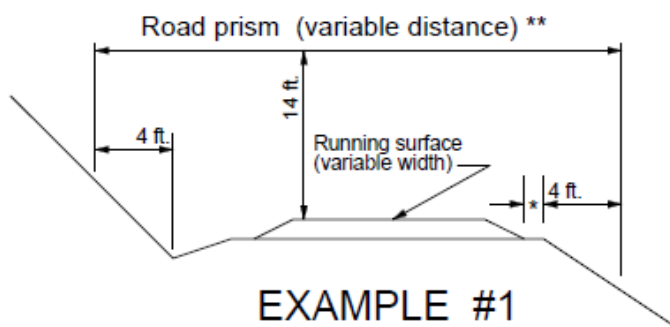

(NO SCALE)

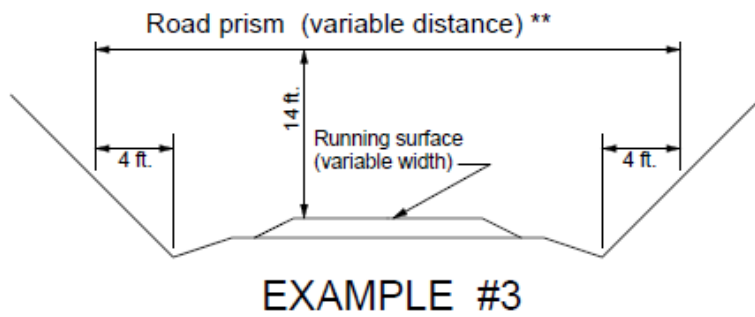

- * Variable distance between running surface and start of fill slope
- ** All areas within the variable distance shall be free of all vegetation capable of growing one (1) foot in height or higher and all overhanging limbs and branches 14 feet in elevation above the running surface

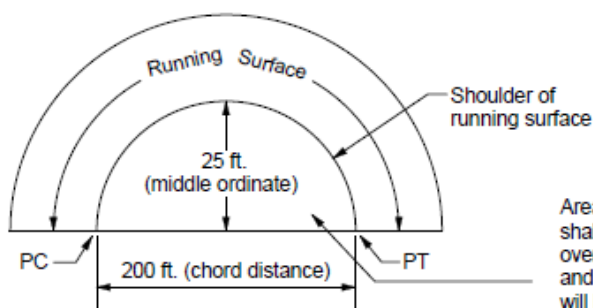

SIGHT DISTANCE DIAGRAM

Area to be cut:
shall be free of
overhanging limbs
and all vegetation
will be cut to a
maximum height
of one (1) foot.

NOTE:

Prior to beginning roadside brushing the purchaser shall establish a control section in a location determined by the Authorized Officer. This section will be used to physically and visually establish acceptable cutting and cleanup standards to be used for the remaining roadside brushing.

ROAD MAINTENANCE SPECIFICATIONS

General road maintenance specifications are designated by numeric symbols according to the type of work performed as follows:

SECTION	DESCRIPTION
	Table of Contents
3000	General
3100	Operational Maintenance
3200	Seasonal Maintenance
3300	Final Maintenance
3400	Other Maintenance
3500	Stabilization
	Stabilization Plan Details

GENERAL - 3000

- 3001 The Purchaser shall be required to maintain all roads as shown on the Exhibit D Road Use and Maintenance map of this contract in accordance with Sections 3000, 3100, 3200, 3300, and 3400 of this exhibit.
- 3002 The Purchaser shall maintain the cross section of existing dirt or graveled roads to the existing geometric standards. Any roads required to be constructed, improved, or renovated under terms of this contract shall be maintained to the geometric standards required in Exhibit C of this contract.
- 3003 The minimum required maintenance on any roads shall include the provisions specified in Subsections 3101, 3104, and 3105.
- 3004 The Purchaser shall be responsible for providing timely maintenance and cleanup on any road(s) with logging units substantially completed prior to moving operations to other roads. The maximum length of non-maintained or non-cleanup of the road prism shall not exceed the sum of one (1) mile at any time. Release of maintenance requirements may be granted, upon written request, when the conditions specified in Sections 3300 and 3400 are met satisfactorily.

OPERATIONAL MAINTENANCE - 3100

- 3101 The Purchaser shall blade and shape the road surface and shoulders with a motor grader. Banks shall not be undercut. Back blading with tractors or similar equipment will be allowed only around landings and other areas when approved by the Authorized Officer. The Purchaser shall be permitted to remove ice or snow from roads authorized for use under this contract subject to the following terms and conditions:
- (1) Notification to BLM must be provided twenty-four (24) hours in advance of ice and snow removal operations.
 - (2) Snowplowing shall be performed by utilizing a motor patrol grader or similar machine as approved by the Authorized Officer. Grader blades shall be equipped with shoes, runners, or other device to keep the grader blade a minimum of two inches (2") above the road surface. Any damage to the road or displacement of surfacing material will be the responsibility of the Purchaser to repair and/or replace at their expense.
 - (3) Snow shall be plowed to the outside shoulder of the road and not into the ditchline. Snow berms created on the shoulder of the road must be swept off the road surface or day-lighted to allow surface water to drain off. Ditches and culverts shall be left functional upon completion of operations.
 - (4) Existing turnouts along road must be cleared of snow to allow for safe vehicle passage.

OPERATIONAL MAINTENANCE - 3100

(5) No chemical and/or salt-based de-icer is allowed for use. Sand or ¾” minus or smaller crushed rock may be applied to the road surface for additional traction on iced sections. Traction rock shall be uniformly distributed and no greater than 1” depth. Purchaser shall clear road surface of traction rock as directed by the Authorized Officer. Any traction rock used will be at the Purchaser’s expense.

3102 The Purchaser shall furnish and place or stockpile at least **300 cubic yards** of aggregate conforming to the requirements in Section 1000 and 1200 of Exhibit C of this contract on the roadway as necessary to maintain the dimensions and typical cross sections shown on the Exhibit C plans and at locations and in the amounts designated by the Authorized Officer.

This aggregate shall be used to repair surface failures and areas of depleted surface depth excluding damages covered by Section 12 of this contract. The aggregate shall be furnished, hauled, placed, spread, and compacted by use of dump trucks, water trucks, and motor grader or similar equipment.

3103 The purchaser shall maintain established berms and place additional berms using adjacent material where needed to protect fills as directed by the Authorized Officer.

3104 The purchaser shall perform other road cleanup including removal of debris, fallen timber, bank slough, and slides which can practicably be accomplished by a motor grader, rubber tired front end bucket loader, rubber tired backhoe or comparable equipment, and by the use of hand tools.

3105 The Purchaser shall be responsible for maintaining normal flow in drainage structures. This includes cleaning out drainage ditches, catch basins, clearing pipe inverts of sediment and other debris lodged in the barrel of the pipe, and maintaining water dips and water-bars using equipment specified in Subsection 3104 and other culvert cleaning and flushing equipment.

3106 The Purchaser shall be responsible for repair and replacement of all materials eroded from road shoulders and fill slopes, up to fifteen station yards in quantity, at any one site. This work includes unlimited multiple sites on all roads required to be maintained by the Purchaser. Prior to repair and replacement of eroded material exceeding fifteen station yards at any one site, the Purchaser and the Authorized Officer or their Authorized Representatives shall agree in writing, in the field, to the quantity of material, borrow source and method of repair. Work may commence immediately after agreement.

Upon completion of agreed upon work, a reduction in timber sale purchase price will be made to offset the cost of the work based upon current BLM Road Cost Guide. Adjustments in purchase price for completed work shall be made as necessary and no less than once per year when actual work is ongoing.

OPERATIONAL MAINTENANCE - 3100

3107 The Purchaser shall cut or trim trees and brush which obstructs vision or prevents the safe passage of traffic along the traveled way when directed by the Authorized Officer.

The Purchaser shall also cut trees or brush encroaching on the road prism that are a result of his activities or winter damage during the contract period. Disposal of such vegetative material shall be in accordance with Section 2100 of Exhibit C.

3108 The Purchaser shall avoid fouling gravel or bituminous surfaces through covering with earth and debris from side ditches, slides or other sources. The Purchaser shall also avoid blading surfacing material off the running surface of the roadway. Skidding of logs on the roadway in or outside designated logging units is not authorized without prior written approval by the Authorized Officer. Repair required caused by such skidding activity is not considered maintenance and shall be repaired at the Purchaser's expense.

SEASONAL MAINTENANCE - 3200

3201 The Purchaser shall perform preventative maintenance at the end of Purchaser's hauling each season and during non-hauling periods which occur between other operations on the contract area. This includes requirements specified in Section 3100.

3202 The purchaser shall perform and complete maintenance specified in Sections 3000, 3100, and 3200 on all roads maintained by him, prior to October 1 each year, except as specified in Subsection 3203, after initial commencement of construction or logging operations. Thereafter, all roads shall have continuous preventive maintenance and road cleanup until suspension of seasonal operations. This includes all roads used and not used during the proceeding operating seasons.

3203 The Purchaser shall complete road cleanup and maintenance, as specified in Section 3100, at the completion of logging operations on any roads located in an area separate from the area where logging activities will resume.

3204 The Purchaser shall be responsible for performing post storm inspections and maintenance during the winter season to minimize erosion and potential road or watershed damage.

FINAL MAINTENANCE - 3300

3301 The Purchaser shall complete final maintenance and/or damage repairs on all roads used under terms of their contract within thirty 30 calendar days following the completion of hauling and in accordance with Sec. 16(b) of this contract. This work shall include any maintenance and/or damage repairs specified in Sections 3000, 3100, and 3200 necessary to meet the conditions specified in Subsection 3002 and shall be executed in accordance with Subsection 3302 of this section.

FINAL MAINTENANCE - 3300

The Authorized Officer may grant acceptance of Purchaser's maintenance responsibility in part where certain individual roads or road segments are no longer of any use to the Purchaser's remaining removal operations, providing that all contract requirements as specified under Sec. 16(b), Special Provisions Sections 3000, 3100, 3200 and 3300 of the maintenance specifications have been completed and a relinquishment of cutting and removal rights on cutting units tributary to these roads is signed by the Purchaser. Request for partial acceptance must be submitted in writing by the Purchaser.

3302 The Purchaser shall perform final road maintenance only when weather or soil moisture conditions are suitable for normal maintenance equipment operations as determined by the Authorized Officer.

If final maintenance is delayed after the date required in Subsection 3301 of this contract by adverse soil moisture or unsuitable equipment operating conditions, the Purchaser will be notified by the Authorized Officer when soil moisture and equipment operating conditions are suitable. The Purchaser shall then be required to complete final maintenance within 30 days.

OTHER MAINTENANCE - 3400

3401 The Purchaser shall repair any damage to road surfaces that was specified under Subsection 3108. This repair includes restoring the roadway to the designed standard and replacement of surfacing with approved surface material. This repair is not limited to use of equipment specified in Subsection 3104.

STABILIZATION – 3500

3501 Stabilization shall consist of installing water bars, drain dips, placement of slash and blocking road from access by vehicles. This work is required for road acceptance under Section 18 of this contract.

3503 Stabilization shall be performed on existing roads in accordance with these specifications, and as shown on the plans at the following locations:

Road No. or Site	Length (mi)	Comment
P1	0.1	Barricade, drivable waterbar
P2	0.22	Barricade, drivable waterbar
P3	0.26	Barricade, drivable waterbar
P4	0.11	Barricade, drivable waterbar

* No barricade needed if road rocked at Purchaser's expense.

STABILIZATION – 3500

- 3504 Stabilization work shall be completed at the end of timber hauling. All soil stabilization work shall be performed during the following seasonal periods to address soil moisture or as determined by the Authorized Officer: **From May 1 to November 30.**
- 3506 Stockpiled slash shall be used to protect exposed areas created by the Purchaser's operations described in these sections. Slash shall be uniformly spread and placed without bunching. The operation shall produce a dense, uniform mat. Where slash is not available, exposed soil areas shall be stabilized in accordance with Section 1800 of Exhibit C.
- 3508 Protect areas mulched and treated with slash placement from damage by Purchaser traffic or construction equipment. Damaged areas shall be repaired by the Purchaser.
- 3509 Access shall be blocked with barricades as shown on the attached typical detail sheet and at locations flagged by the Authorized Officer.
- 3513 Water bars and drain dips shall be installed across full width of roadway as shown on the attached typical detail sheet and at locations flagged by the Authorized Officer.
- 3514 Protection of exposed surfaces shall be accomplished by placement of soil stabilization material in accordance with Section 1800 and placement of slash described in Subsection 3506 on designated roadways, disturbed areas, cut banks, fill slopes and other areas disturbed by the Purchaser's operations in accordance with these specifications and as shown in the plans.

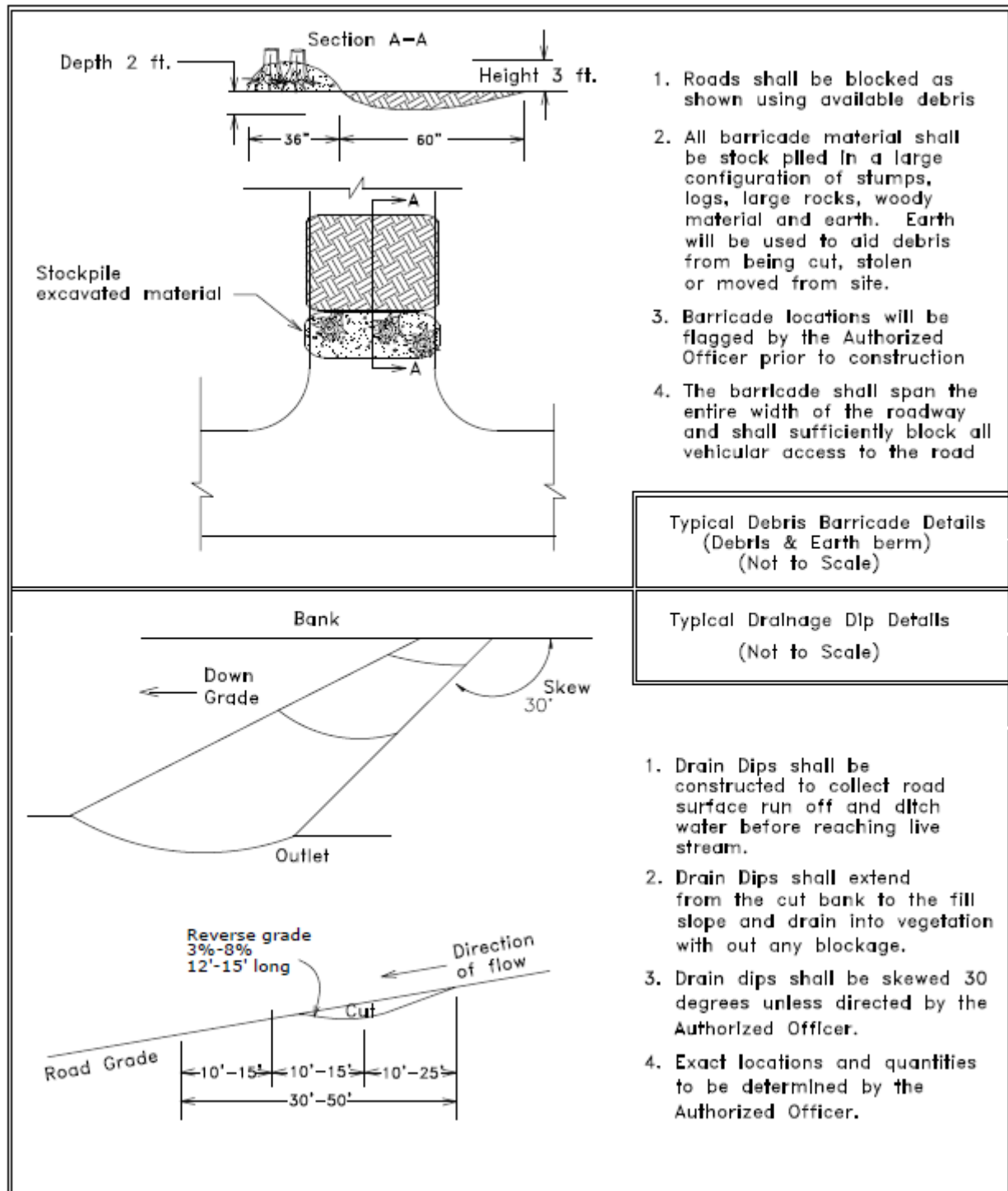

1. Waterbars shall be constructed as shown.
2. Exact locations will be flagged by the Authorized Officer prior to construction.
3. All waterbars shall be skewed 30 degrees.
4. Waterbars shall extend from the cut bank to the fill slope and be readily crossed by passenger type vehicles.



Typical NON-Drivable
Waterbar Details
(Not to scale)

Typical Drivable
Waterbar Details
(Not to scale)

1. Waterbars shall be constructed as shown.
2. Exact locations will be flagged by the Authorized Officer prior to construction.
3. All waterbars shall be skewed 30 degrees.

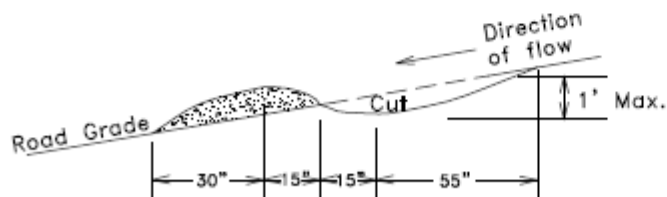

4. Waterbars shall extend from the cut bank to the fill slope and be readily crossed by passenger type vehicles.
5. The mound of material shall be compacted from the cut bank to the fill slope and shall be passable by passenger type vehicles.



ROAD USE AND MAINTENANCE MAP - ORN01-TS-2026.0102
T. 5 S., R. 4 E., Section 5, 9; W.M.

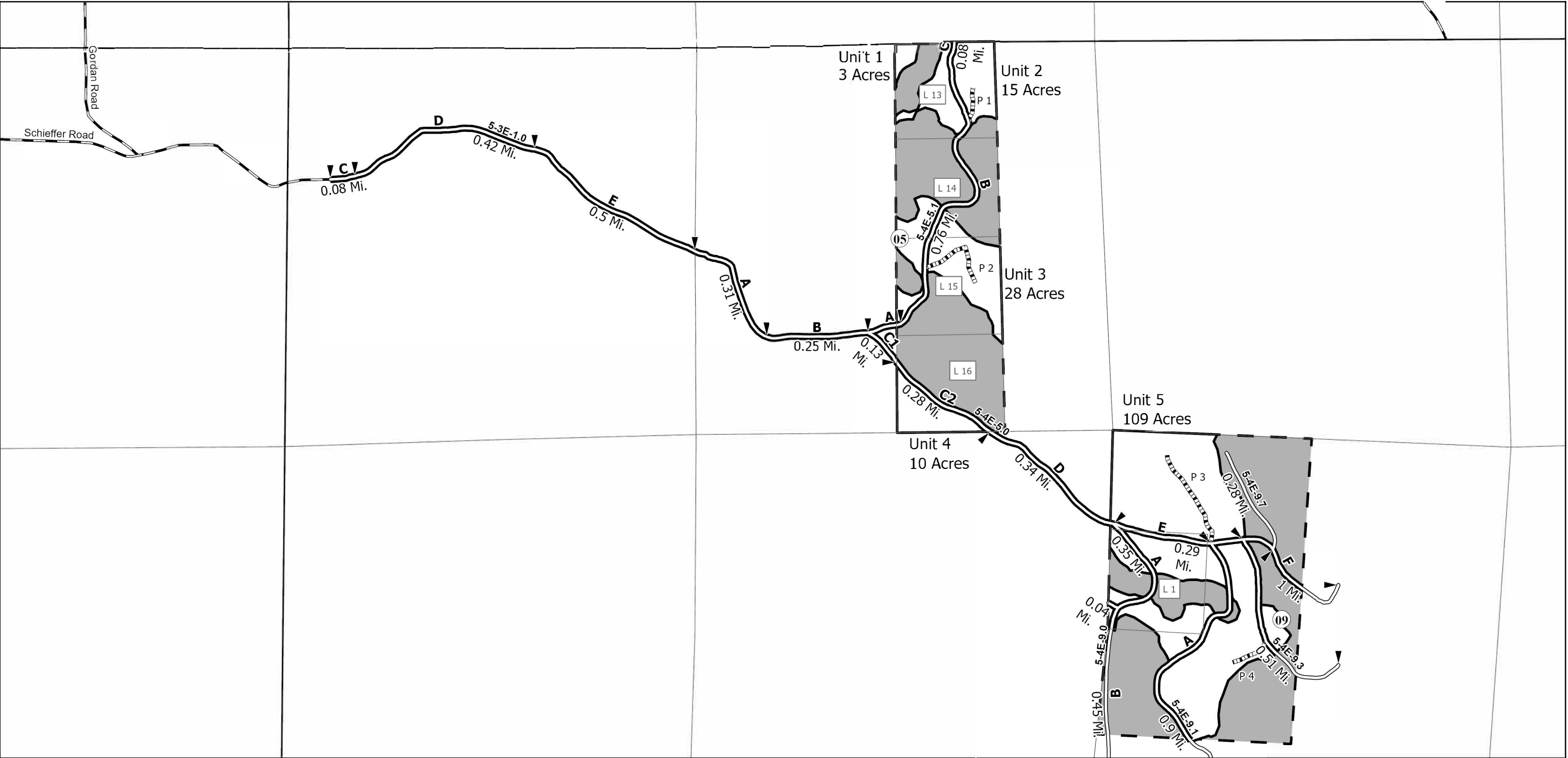

- New Road Construction
- County Road
- Existing Road
- Haul Route - Purchaser Maintenance
- Sale Area
- Contract Area
- Reserve Area
- Lot

0 0.5 1 Miles



No warranty is made by the Bureau of Land Management as to the accuracy, reliability, or completeness of this map or the data displayed for individual use or aggregate use with other data. Date Exported: 12/3/2025

EXHIBIT I SPECIFICATIONS FOR SNAG CREATION

GENERAL:

1. Designated conifer trees (166) shall have tops removed (topping) by saw cutting, high girdling, or be base girdled as directed by the Authorized Officer.
2. Up to one third (55) of the trees to be treated shall be high girdled. Up to one third (56) of the trees to be treated shall be base girdled. Up to one third (55) of the trees to be treated shall be Topped.
3. Topped, top girdled or girdled trees shall be well distributed within unit boundaries as directed by the Authorized Officer. Do not create snags within falling distance of power lines, structures or roads that will remain open after harvesting activities are complete.
4. The Purchaser shall furnish all labor, equipment, supervision, and supplies to perform all work.

HIGH GIRDLE:

1. Girdling height of live trees will vary by stand age and should range from 50-120 feet, or the top third of the tree. Average girdling height is likely to be 80-110 feet in the 60–70-year-old stands, and 60-80 feet in the 40–50-year-old stands. (See Illustration #1)
2. Trees High Girdled shall retain 15-25 live limbs that are at least 5 feet in length below the girdled site.
3. All cuts will completely sever the cambium but not exceed ½ inch depth into the wood of the tree.
4. All cuts will be free of sawdust and debris.
5. High Girdled trees shall be marked with high visibility florescent orange flagging around the bole at a point ten to twenty feet above the ground so that it is readily visible from at least one hundred (100) feet away from the tree in all directions and two pieces of flagging tied to a branch, or bole, directly below the girdling site.

TOPPING:

1. Topping shall be done at a point within approximately 50 to 100 feet in height where the diameter of the main stem is between ten and fourteen (10-14) inches, or as directed by the Authorized Officer. (See Illustration #2)
2. Remove live limbs 10 feet below the point where the tree is topped.

3. Treetops which are severed shall be completely severed from the tree and in such a manner that they are lying completely on the ground. No tops shall remain hung up in tops of other trees or leaning against the bole of any tree.
4. Severed tree tops which land on or immediately adjacent to a constructed fire trail, within a fuel reduction area, or in the right-of-way of a road or designated trail shall be moved as directed by the Authorized Officer the same day in which it was severed.
5. The top of the main stem of the tree shall be cut flat (no face cut notch or angled back cut).
6. The top of the main stem shall then have a vertical "V" notch cut at least six (6) inches down into the stem with the open end of the "V" approximately three (3) inches or 1/3 the diameter of the cut face in width or be otherwise modified as directed by the Authorized Officer.
7. Florescent orange flagging shall be hung around the bole at a point ten to twenty feet above the ground so that it is readily visible from at least one hundred (100) feet away from the tree in all directions.

BASAL GIRDLE:

1. Making three (3) parallel cuts completely around the tree. The distance between the top and the bottom of the cuts shall not exceed twelve inches.
2. Cuts must penetrate at least ½ inch, but not more the 1 inch into the wood of the tree.
3. Trees shall be girdled between 3 to 4 feet from ground level. (Refer to Illustration #3)
3. Florescent orange flagging shall be hung around the bole at above where the tree was girdled so that it is readily visible from at least one hundred (100) feet away from the tree in all directions.

Illustration #1 – High-Girdling

Crown Girdling Specifications:

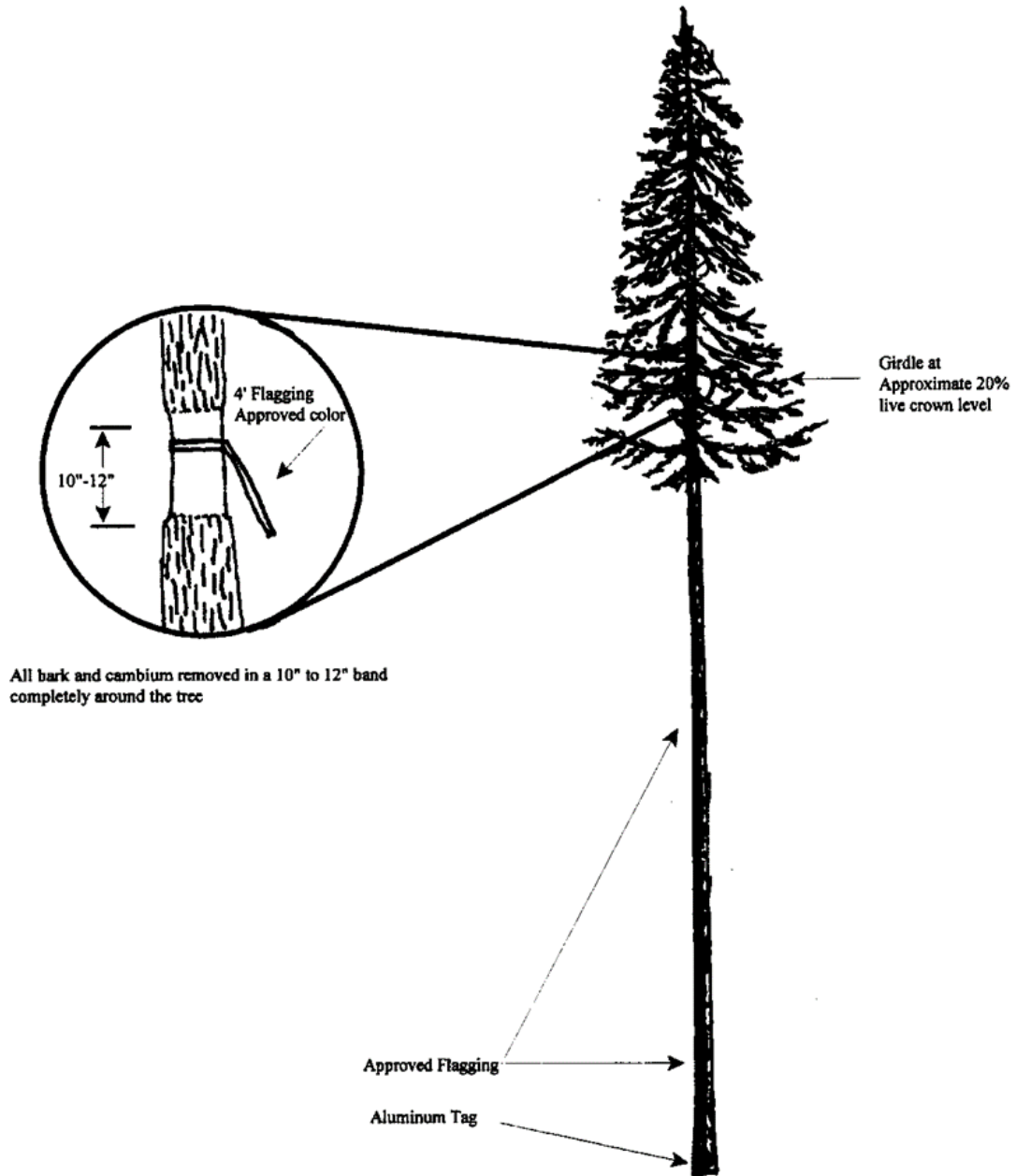

Illustration #2 – Saw-topping.

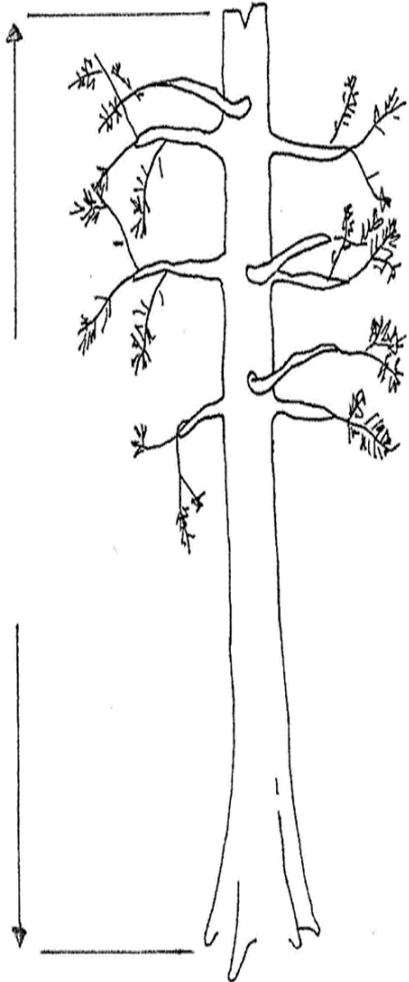
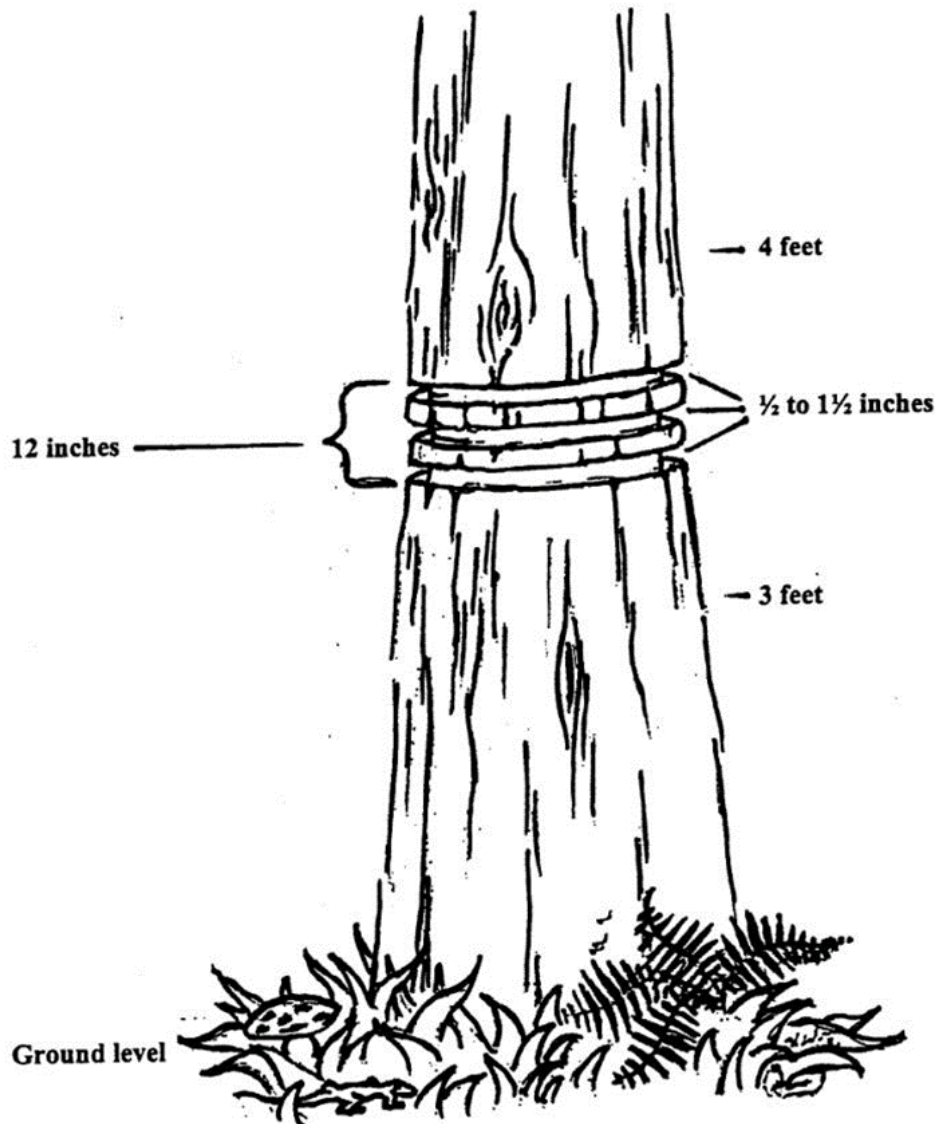

Illustration #3 – Basal Girdling





UNITED STATES DEPARTMENT OF THE INTERIOR
Bureau of Land Management
Northwest Oregon District

Vicinity Map
John Boy
Timber Sale
Page 1 of 1

TIMBER SALE CONTRACT MAP - ORN01-TS-2026.0102

T. 5 S., R. 4 E., Section 5, 9; W.M.

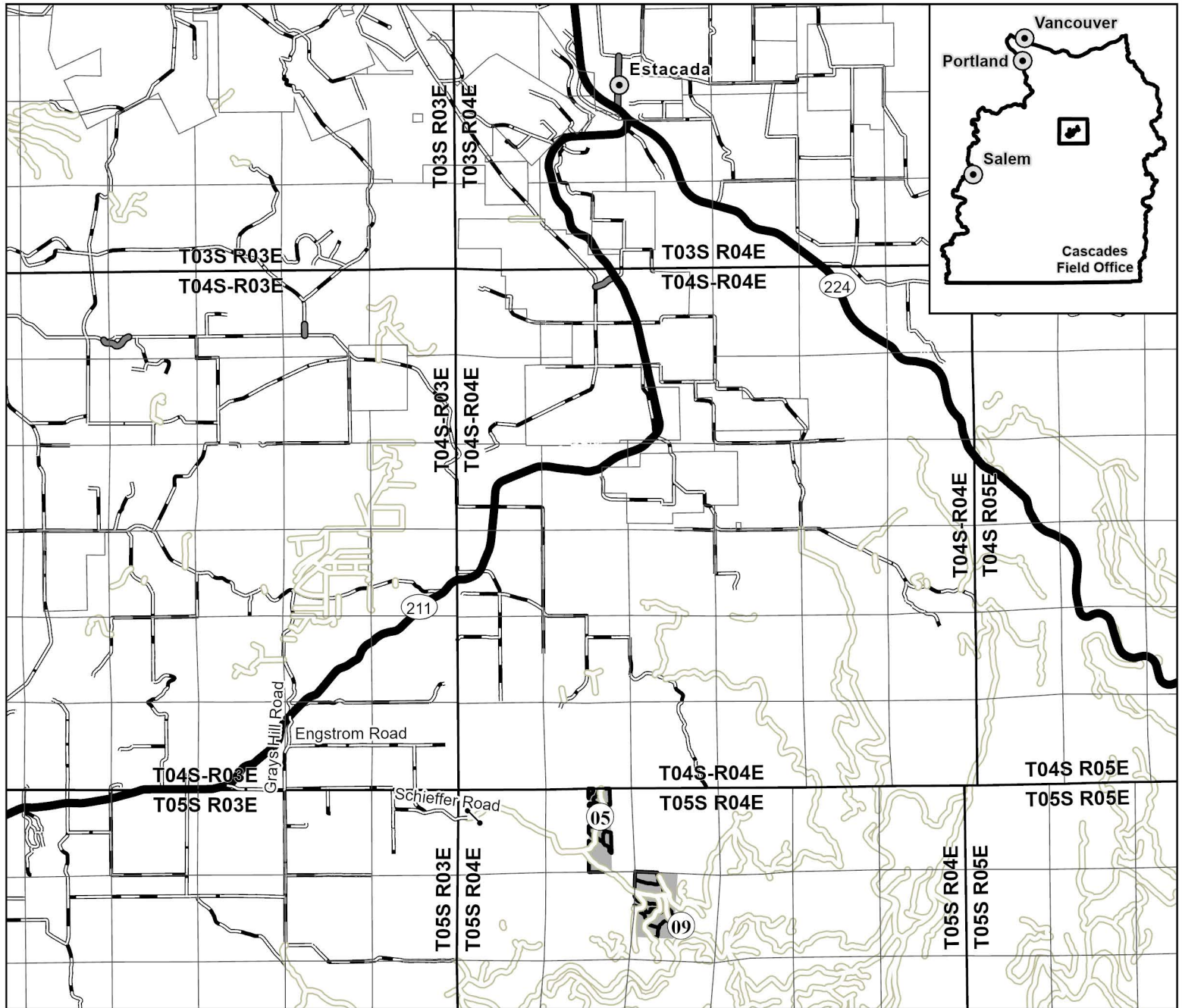

- Gate
- Highways
- Major Road
- Existing Road
- County Road
- Sale Area
- Reserve Area

0 2 4 Miles





**United States
Department of the Interior
Bureau of Land Management**

Timber Appraisal

Sale Name:	John Boy	Sale Date:	Wednesday, February 25, 2026
BLM District:	NW Oregon DO	Unit of Measure:	16' MBF
Contract #:	ORN01-TS-2026.0102	Contract Term:	36 months
Sale Type:	Advertised	Contract Mechanism:	5450-003
		Lump Sum Sale of Timber and other Wood Products	

Content

Timber Appraisal Summary
Stumpage Summary
Unit Summary
Stump to Truck
Transportation
Engineering Allowances
Other Allowances

Prepared By: Rainey, Matthew D - 1/5/2026

Approved By: Rainey, Matthew D - 1/5/2026

Legal Description of Contract Area

Land Status	County	Township	Range	Section	Subdivision	Meridian
O&C	Clackamas	5S	R4E	5	Lots 13,14,15,16	Willamette
O&C	Clackamas	5S	R4E	9	NW1/2NW1/4, Lot1,SE1/4NW1/4, N1/2NW1/4	Willamette

Species Totals

Species	Net	Gross Merch	Gross	# of Merch Logs	# of Cull Logs	# of Trees
Douglas Fir	6,368.0	6,683.0	6,724.0	75,113	76	16,913
Western Hemlock	1,359.0	1,449.0	1,449.0	19,527	0	4,925
Western Redcedar	96.0	105.0	105.0	2,395	0	887
Totals	7,823.0	8,237.0	8,278.0	97,035	76	22,725

Cutting Area Acres

Regeneration Harvest Acres	Partial Cut Acres	Right of Way Acres	Total Acres	Net Volume per Acre
150.0	15.0	2.0	167.0	46.8

Logging Costs

Stump to Truck	\$1,002,113.79
Transportation	\$395,424.00
Road Construction	\$53,274.26
Maintenance/Rockwear	\$20,550.10
Road Use	\$0.00
Other Allowances	\$47,343.50
Total:	\$1,518,705.65
Total Logging Cost per MBF:	\$194.13

Utilization Centers

Location	Distance	% of Net Volume
RSG Molalla Or.	25.0 miles	100%

Profit & Risk

Profit	11%
Risk	0%
Total Profit & Risk	11%

Tract Features

Quadratic Mean DBH	17.3 in
Average GM Log	85 bf
Average Volume per Acre	46.8 mbf
Recovery	94%
<u>Net MBF volume:</u>	
Green	7,823.0 mbf
Salvage	0 mbf
Export	0 mbf
<u>Ground Base Logging:</u>	
Percent of Sale Volume	90%
Average Yarding Slope	20%
Average Yarding Distance	250 ft
<u>Cable Logging:</u>	
Percent of Sale Volume	10%
Average Yarding Slope	50%
Average Yarding Distance	400 ft
<u>Aerial Logging:</u>	
Percent of Sale Volume	0%
Average Yarding Slope	0%
Average Yarding Distance	0 ft

Cruise

Cruise Completed	August 2025
Cruised By	Salmon
Cruise Method	
Variable Plot /100%	

Stumpage Computation

Species	# of Trees	Net Volume	Pond Value	(-) Profit & Risk	(-) Logging Costs	(+) Marginal Log Value	Appraised Price/MBF	Appraised Value (\$)
Douglas Fir	16,913	6,368.0	\$583.39	\$64.17	\$194.13	\$0.00	\$325.10	\$2,070,236.80
Western Hemlock	4,925	1,359.0	\$449.95	\$49.49	\$194.13	\$0.00	\$206.30	\$280,361.70
Western Redcedar	887	96.0	\$736.77	\$81.04	\$194.13	\$0.00	\$461.60	\$44,313.60
Totals	22,725	7,823.0						\$2,394,912.10

Percent of Volume By Log Grade

Species	No. 1 & 2 Peeler	No. 3 Peeler	Special Mill	No. 2 Sawmill	No. 3 Sawmill	No. 4 Sawmill	Camp Run
Douglas Fir			1.0%	58.0%	37.0%	4.0%	

Species	Peeler	No. 1 Sawmill	Special Mill	No. 2 Sawmill	No. 3 Sawmill	No. 4 Sawmill	Camp Run
Western Hemlock				52.0%	42.0%	6.0%	

Species	No. 1 Sawmill	No. 2 Sawmill	No. 3 Sawmill	No. 4 Sawmill			Camp Run
Western Redcedar							100.0%

Unit: 1

Species	Net	Gross Merch	Gross	# of Trees
Douglas Fir	117.0	122.0	124.0	309
Western Hemlock	27.0	29.0	29.0	99
Western Redcedar	2.0	2.0	2.0	18
Totals:	146.0	153.0	155.0	426

Net Volume/Acre: 48.7 MBF

Regeneration Harvest	3.0
Partial Cut	0.0
Right of Way	0.0
Total Acres:	3.0

Unit: 2

Species	Net	Gross Merch	Gross	# of Trees
Douglas Fir	502.0	532.0	532.0	1,339
Totals:	502.0	532.0	532.0	1,339

Net Volume/Acre: 33.5 MBF

Regeneration Harvest	0.0
Partial Cut	15.0
Right of Way	0.0
Total Acres:	15.0

Unit: 3

Species	Net	Gross Merch	Gross	# of Trees
Douglas Fir	1,087.0	1,140.0	1,147.0	2,886
Western Hemlock	253.0	270.0	270.0	919
Western Redcedar	18.0	20.0	20.0	166
Totals:	1,358.0	1,430.0	1,437.0	3,971

Net Volume/Acre: 48.5 MBF

Regeneration Harvest	28.0
Partial Cut	0.0
Right of Way	0.0
Total Acres:	28.0

Unit: 4

Species	Net	Gross Merch	Gross	# of Trees
Douglas Fir	388.0	407.0	409.0	1,031
Western Hemlock	91.0	97.0	97.0	328
Western Redcedar	6.0	7.0	7.0	59
Totals:	485.0	511.0	513.0	1,418

Net Volume/Acre: 48.5 MBF

Regeneration Harvest	10.0
Partial Cut	0.0
Right of Way	0.0
Total Acres:	10.0

Unit: 5

Species	Net	Gross Merch	Gross	# of Trees
Douglas Fir	4,191.0	4,396.0	4,425.0	11,133
Western Hemlock	988.0	1,053.0	1,053.0	3,579
Western Redcedar	70.0	76.0	76.0	644
Totals:	5,249.0	5,525.0	5,554.0	15,356

Net Volume/Acre: 48.2 MBF

Regeneration Harvest	109.0
Partial Cut	0.0
Right of Way	0.0
Total Acres:	109.0

Unit: RW

Species	Net	Gross Merch	Gross	# of Trees
Douglas Fir	83.0	86.0	87.0	215
Totals:	83.0	86.0	87.0	215

Net Volume/Acre: 41.5 MBF

Regeneration Harvest	0.0
Partial Cut	0.0
Right of Way	2.0
Total Acres:	2.0

Total Stump To Truck	Net Volume	\$/MBF
\$1,002,113.79	7,823.0	\$128.10

Stump to Truck: Falling, Bucking, Yarding, & Loading

Yarding System	Unit of Measure	# of Units of Measure	\$/Unit of Measure	Total Cost	Remarks
Cable: Medium Yarder	GM MBF	534.0	\$284.52	\$151,933.68	Units 1,3 / 8 regen acres / Unit 2-10 thin acres 5 loads/day 5MBF
Shovel	GM MBF	7,703.0	\$110.37	\$850,180.11	Right Away volume included @ 8 loads/day 5MBf
Subtotal				\$1,002,113.79	

Additional Costs

Item	Unit of Measure	# of Units of Measure	\$/Unit of Measure	Total Cost	Remarks
Subtotal				\$0.00	

Additional Moves

Equipment	Unit of Measure	# of Units of Measure	\$/Unit of Measure	Total Cost	Remarks
Subtotal				\$0.00	

Comments:

534 MBF of cable volume @ 5 loads/day 5 MBF / load

7703 MBF of ground volume @ 8loads/day 5MBF/load

Total	Net Volume	\$/MBF
\$395,424.00	7,823.0	\$50.55

Utilization Center	One Way Mileage	Description	Unit of Measure	# of Units	\$/Unit of Measure	Total Cost	% of Sale Volume
RSG Molalla Or.	25.0	All Species	GM MBF	8,238.0	\$48.00	\$395,424.00	100%

Engineering Allowances

Total	Net Volume	\$/MBF
\$73,824.36	7,823.0	\$9.44

Cost Item	Total Cost
Road Construction:	\$53,274.26
Road Maintenance/Rockwear:	\$20,550.10
Road Use Fees:	\$0.00

Comments:
Purchaser Maintenance Allowance \$20,550.10

Total	Net Volume	\$/MBF
\$47,343.50	7,823.0	\$6.05

Environmental Protection

Cost item	Total Cost
Basal Gridle Trees	\$1,960.00
High Gridle Trees	\$6,875.00
Tree Topping	\$11,000.00
Equipment Washing	\$400.00
Equipment Washing	\$400.00
10% Admin Cost	\$1,983.50
Subtotal	\$22,618.50

Fire Prevention & Control

Cost item	Total Cost
Landing pile and cover	\$375.00
Landing Pile Burn	\$375.00
Machine Pile Burn	\$875.00
Machine Pile Burn	\$4,750.00
Machine Pile and Cover	\$15,200.00
Machine Pile and Cover	\$3,150.00
Subtotal	\$24,725.00

Comments:

Fuels Appraisal includes 3 acres of landing piles and 45 acres of machine piling for 48 total acres of piling. No Buy-out offered.

Snag Creation: \$200/tree topping require climbing / \$125/tree high gridle require climbing/\$35 ground basal gridle

Information for Timber Sale Notice, Prospectus, Sec. 43 & 44

John Boy Timber Sale

ORN01-TS-2026.0102

Approx # of trees	Est Volume MBF 32'	Species	Est Volume MBF 16'	Appraised \$/MBF	Appraised Value (\$)
16,913	5,144.0	Douglas Fir	6,368.0	\$325.10	\$2,070,236.80
4,925	1,096.0	Western Hemlock	1,359.0	\$206.30	\$280,361.70
887	69.0	Western Redcedar	96.0	\$461.60	\$44,313.60
22,725	6,309.0		7,823.0		\$2,394,912.10

CRUISED BY:	Salmon
CRUISE COMPLETED:	August 2025
COMBINED SAMPLING ERROR:	9.97%

CRUISE DESIGN/METHOD Description:
Variable Plot /100%

TRACT FEATURES

ALL SPECIES

QM DBH	17.3	INCHES
GM LOG	85	BD FT
Total Gross Volume	8,279	MBF
Recovery	94	%
Salvage	0	MBF
Export	0	MBF

Dominant Species: Douglas Fir

QM DBH	17.7	INCHES
GM Log	89	BD FT
Recovery	95	%
Salvage	0	MBF

EXPORT VOLUME (LE-1)	Port Orford Cedar	0	MBF
-----------------------------	-------------------	---	-----

Reserve Tree Paint Color	Reserve Tree Count
	0

Harvest Tree Paint Color	Harvest Tree Count
	0