



GeoPlatform Login via ArcGIS Field Maps & ArcGIS Collector

Instructions are shown using Field Maps. Login for Collector is the same process. **Users must first set up an authenticator app (or other authentication method) with Login.gov before attempting to use with an Esri mobile app.** Return to the [Authentication Application](#) section for setup instructions.

This section is primarily for External Partners with GeoPlatform **BLM Partner Data Editor** accounts needing to log into ArcGIS Field Maps or Collector. **GeoPlatform BLM Publishers** or **GeoPlatform BLM State Admins** can login for management or troubleshooting purposes. All other BLM employees can access GeoPlatform content through their existing **BLM SAML AGOL** account or their **BLM Mobile Editor** account provided the account has been added to the GeoPlatform Group.

The mobile application of ArcGIS Collector can be downloaded through either the Google Play Store (Android devices) or the App Store (iOS devices), depending on your device. Please use the following information as a general guide.

These instructions begin as if you are currently signed into Collector with an existing account. If you are not currently signed in, skip to number 3 and continue with similar steps from there.

1. Open ArcGIS Collector on your mobile device and tap **Sign in with ArcGIS Online**.
2. Type **geoplatform** into the text box.
3. Check **Remember this URL**.
 - a. This will be remembered on subsequent logins, and you will only have to tap **GeoPlatform**.

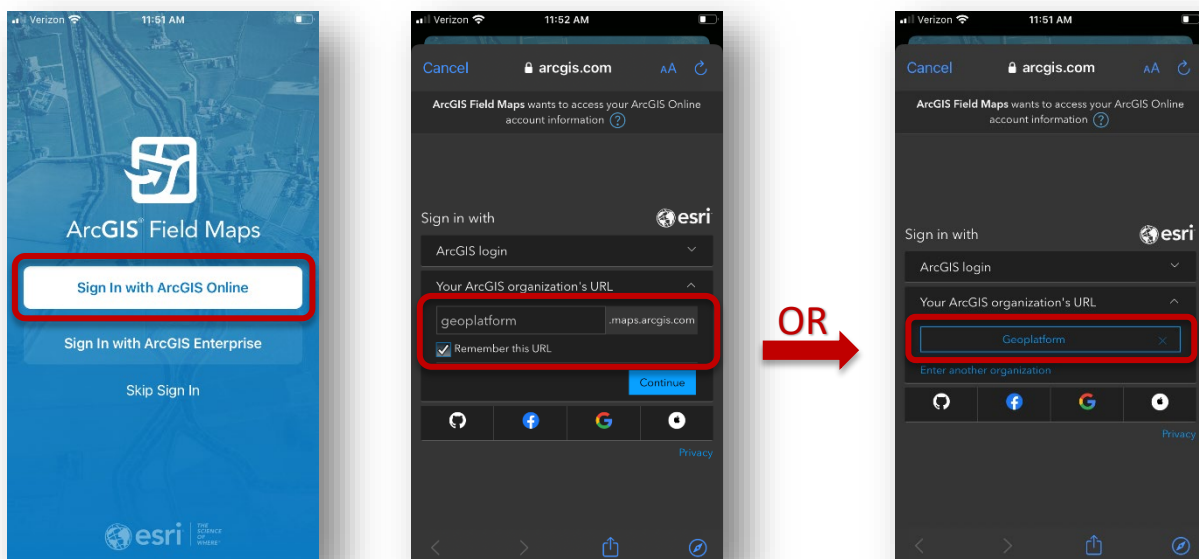

4. On the next screen, tap **GeoPlatform Login.gov Account**.
5. Enter your **Login.gov email and password** (the email registered to your Login.gov account).
6. Tap **Sign in**.

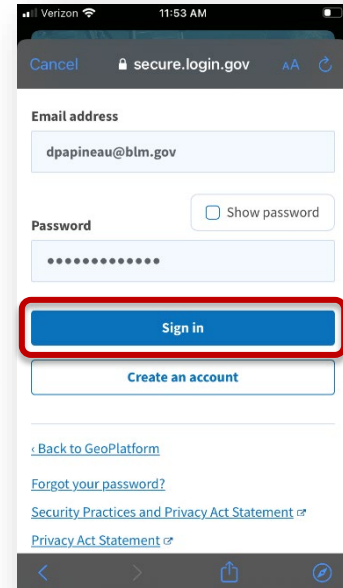
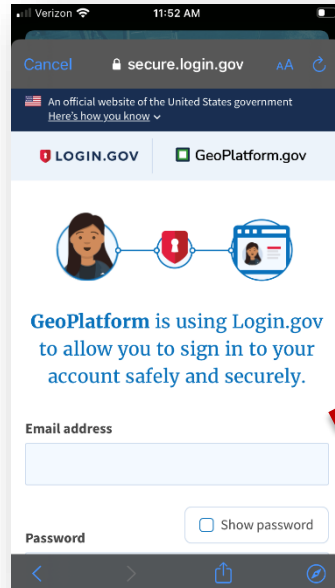
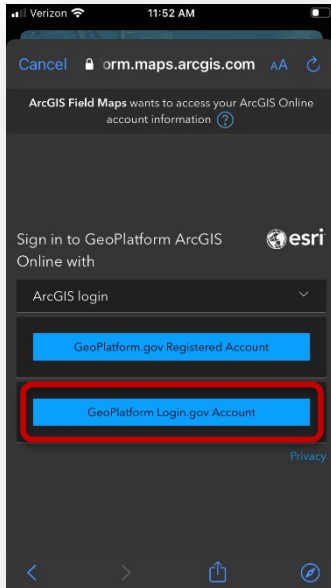

7. Your next steps will depend on the authentication methods you have set up. If you have an **authenticator app** set up (e.g., Microsoft Authenticator), you will be prompted to enter the security code.
 - a. If you need to use a different method than what is being presented, tap **Choose another authentication method** at the bottom, and choose the appropriate authentication method. This other method must first be set up at Login.gov.
8. Push notifications are currently not enabled, so you will have to return to the home screen and **open MS Authenticator** (assumes MS Authenticator is on same device).

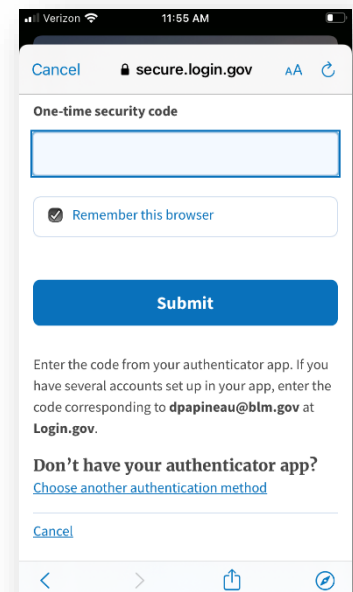



9. **Tap to copy** (or remember) the **Login.gov** code.
10. Return to the home screen and open the **Field Maps** app. **Tap and paste** (or manually enter) the Login.gov code.
11. Tap **Submit**.

Note: There is a 30 second window to copy and enter the code into Field Maps. If the timer is nearing the end, wait for a new code to populate and the timer to reset before attempting to copy/paste it into Field Maps.

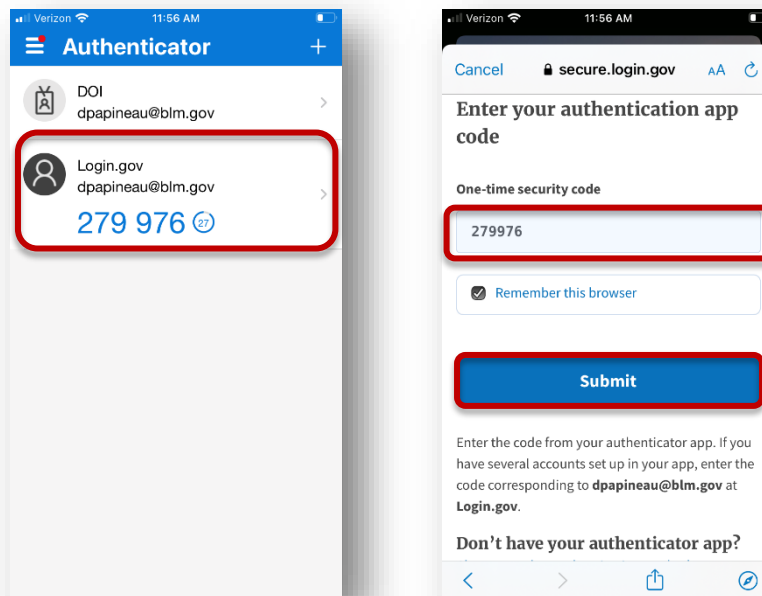

12. You should now be logged in and see the **Maps** screen on the Field Maps app.
 - a. If you get some sort of “log in failure” notification, repeat the log in process until you’ve logged in successfully.
 - b. Alternatively, you can try logging into Collector, then return to Field Maps and attempt to log in again.



GeoPlatform Login via Survey123

Users must first set up an authenticator app (or other authentication method) with Login.gov before attempting to use with an Esri mobile app. Return to the [Authentication Application](#) section for setup instructions. Additionally, the account must be elevated above the default role and support data editing (requires a [Remedy ticket](#)).

This section is primarily for External Partners with GeoPlatform **BLM Partner Data Editor** accounts needing to log into Survey123. **GeoPlatform BLM Publishers** or **GeoPlatform BLM State Admins** can log in for management or troubleshooting purposes. All other BLM employees can access GeoPlatform content through their existing **BLM SAML AGOL** account (with any role beyond **BLM User**) or **BLM Mobile Editor** account provided the account has been added to the GeoPlatform Group.

The mobile application of ArcGIS Survey123 can be downloaded through either the Google Play Store (Android devices) or the App Store (iOS devices), depending on your device. Please use the following information as a general guide.

1. Open Survey123 on your mobile device and tap using the **Manage ArcGIS connections**
2. Tap **Add connection** at the bottom
3. Type **geoplatform.maps.arcgis.com** in the text box

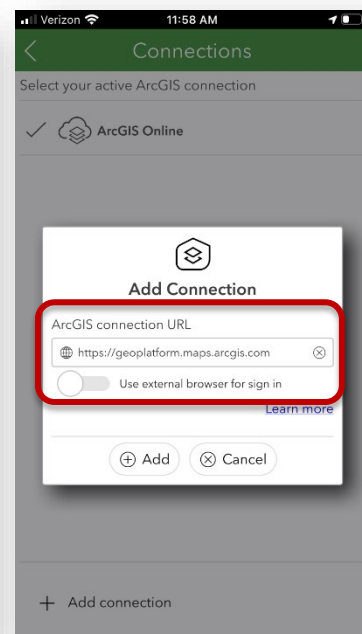
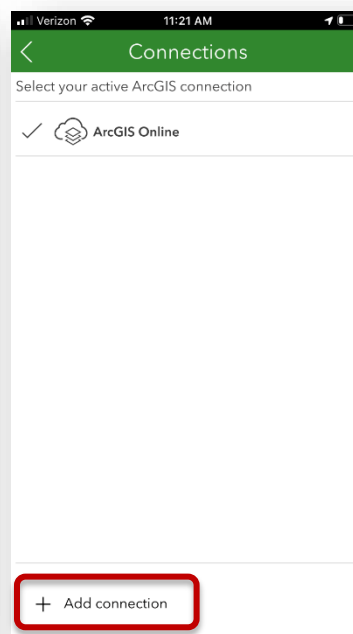
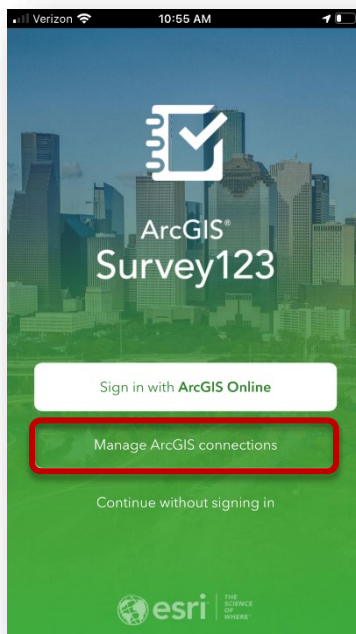



4. You should now see **GeoPlatform ArcGIS Online** as an available connection in Survey123. Tap the **back arrow** (top left) to return to the Sign In screen.
5. Tap **Sign in with GeoPlatform ArcGIS Online**
6. Tap **GeoPlatform Login.gov Account**

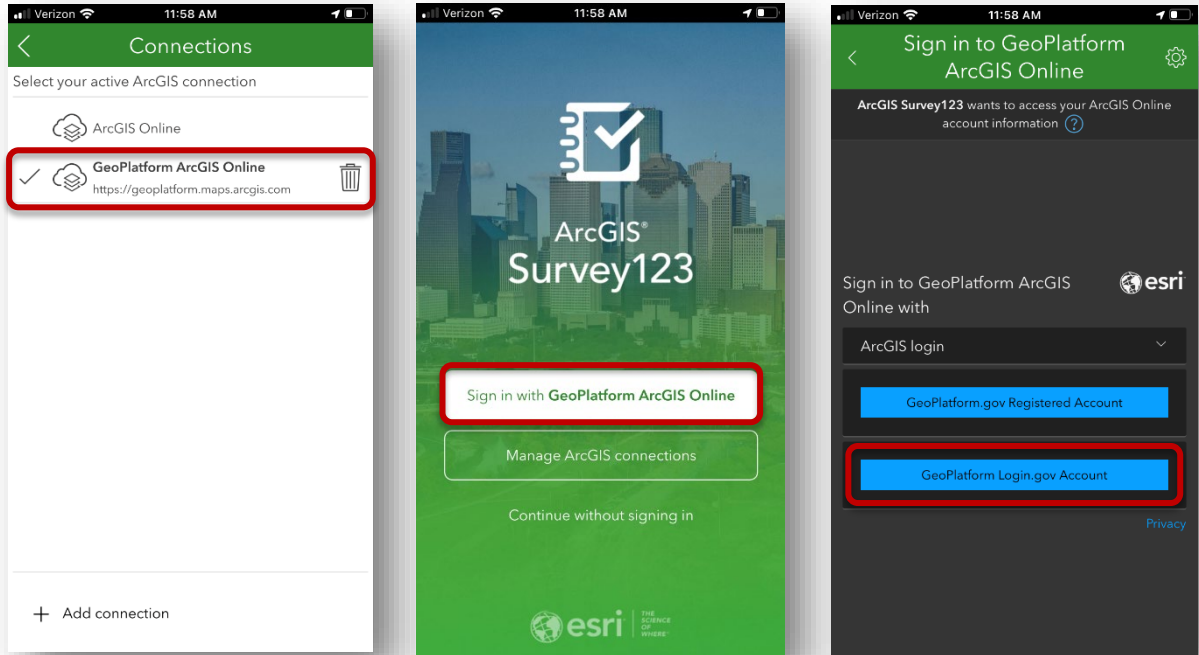

7. Enter your **Login.gov email and password** (the email registered to your Login.gov account)
8. Tap **Sign in**

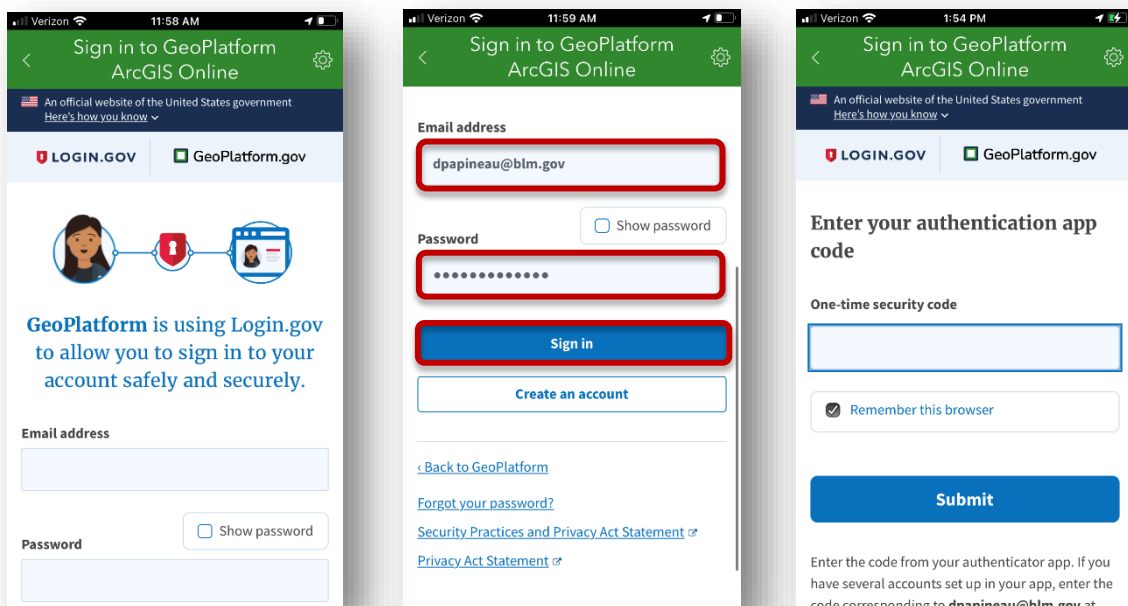

9. Your next steps will depend on the authentication methods you have set up. If you have an **authenticator app** set up (e.g., Microsoft Authenticator), you will be prompted to enter the security code.
 - a. If you are authenticating with a different method, that method must first be set up at Login.gov.
10. Push notifications are currently not enabled, so you will have to return to the home screen and **open MS Authenticator** (assumes MS Authenticator is on same device).
11. Tap to copy (or remember) the **Login.gov code**
12. Return to the home screen and open the **Field Maps** app. **Tap and paste** (or manually enter) the **Login.gov code**.
13. Tap **Submit**

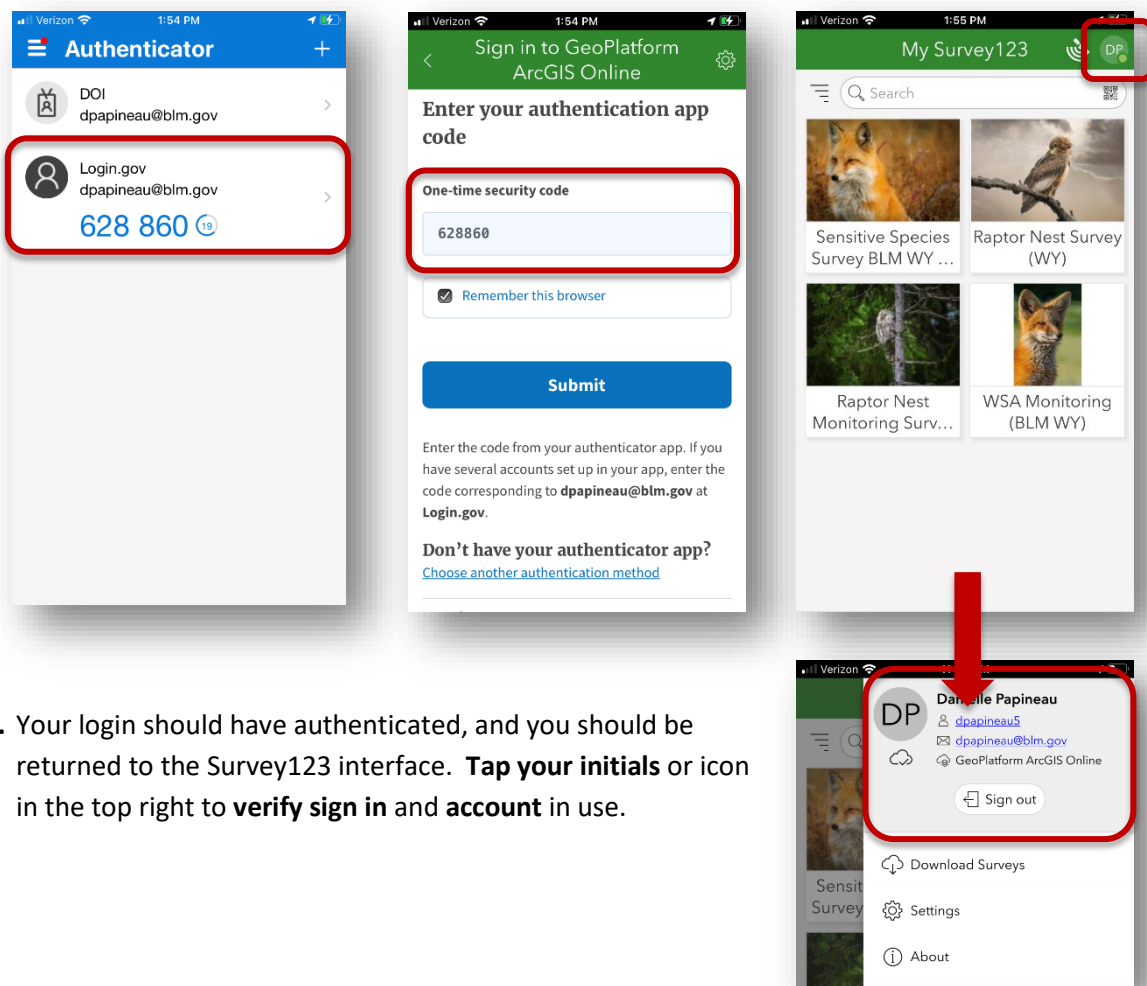

14. Your login should have authenticated, and you should be returned to the Survey123 interface. **Tap your initials** or icon in the top right to **verify sign in** and **account** in use.

Link: [Survey123 Quick Reference \(Esri\)](#)