



# PROSPECTUS



United States Department of the Interior  
BUREAU OF LAND MANAGEMENT  
Springfield Interagency Office, Northwest Oregon District  
3106 Pierce Parkway, Suite E, Springfield, Oregon 97477  
<http://www.blm.gov>

July 26, 2023

Parcel No. 2  
Contract No. ORN05-TS23-555  
Upper Willamette Field Office

Ghost Town

## TIMBER SALE NOTICE

**NOTICE IS HEREBY GIVEN** that the Bureau of Land Management will offer for sale timber as described herein for oral auction, pursuant to Instructions to Bidders, as stated on Form No. 5440-9, attached. Written and oral bids will be received by the District Manager, or their representative, at the **NORTHWEST OREGON DISTRICT'S SPRINGFIELD INTERAGENCY OFFICE, 3106 PIERCE PARKWAY, SPRINGFIELD, OREGON**. The timber sale will commence at 10:00 a.m. on Thursday, **August 24, 2023**.

**THIS TIMBER SALE NOTICE** does not constitute the decision document for purposes of appeal of a forest management decision. Consistent with 43 CFR Subpart 5003.2(b), the date the BLM posts the forest management decision on the BLM's ePlanning website establishes the effective date of the decision for purposes of an administrative appeal.

**A WRITTEN BID** on Form 5440-9 at not less than the appraised price on a unit basis per species and the required minimum bid deposit shall be required to participate in oral bidding for each tract.

**THE SUCCESSFUL BIDDER**, as a condition of award, will be required to complete and/or sign the following forms:

1. Form 5430-11, a certification that the bid was arrived at by the bidder or offerer independently, and was tendered without collusion with any other bidder or offerer.
2. Form 5450-17, Export Determination.

**PRE-AWARD QUALIFICATIONS.** The high bidder may be required to furnish information to determine the ability to perform the obligations of the contract. If the high bidder is determined not qualified, not responsible or refuses to respond within 15 days of a request for information pertaining to qualifications, the contract may be offered and awarded for the amount of the high bid to the highest of the bidders who is qualified, responsible, and willing to accept the contract.

**A PERFORMANCE BOND** in an amount not less than 20 percent of the total purchase price will be required for all contracts of \$2,500 or more, but the amount of the bond shall not be in excess of \$500,000, except when the Purchaser opts to increase the minimum bond as provided in 43 CFR 5451.2. A minimum performance bond of not less than \$500 will be required for all installment contracts less than \$2,500.

**INSTALLMENT PAYMENTS** may be authorized for sales of \$500 or more. Required installments will be determined by BLM. For sales under \$500,000, installments will not be less than 10% of the total purchase price. For sales of \$500,000 or more, installment payments shall be \$50,000.

**LOG EXPORT AND SUBSTITUTION.** All timber sales, including timber from Federal rights-of-ways, shall be subject to the restrictions relating to the export and substitution of unprocessed timber from the United States in accordance with P.L. 94-165 and 43 CFR 5400 and 5424, as amended.

**LOG EXPORT AND SUBSTITUTION RESTRICTIONS.** Excepting Port-Orford-cedar, all timber offered for sale hereunder is restricted from export from the United States in the form of unprocessed timber and is prohibited from being used as a substitute for exported private timber.

**SPECIAL PROVISIONS.** A revised Special Provision has been added to the contract which enables the Contracting Officer to suspend the contract to facilitate protection of certain plant or animal species, and/or to modify or terminate the contract when necessary to: (1) Comply with the Endangered Species Act or to prevent incidental take of northern spotted owls in accordance with management direction in the Record of Decision (ROD) and Resource Management Plan (RMP), or; (2) Comply with a stay or remedy issued by the Interior Board of Land Appeals or a court order, or; (3) Protect species which were identified for protection in accordance with management direction established in the ROD and RMP.

**ADDITIONAL INFORMATION** concerning each timber sale tract described herein is available at the Springfield Interagency Office. A copy of the timber sale contract is also available for inspection at the Springfield Interagency Office. This prospectus includes maps and tables that cannot be made Section 508 compliant. For help with its data or information, please contact the Northwest Oregon District's Springfield Interagency Office at (541) 683-6776.

**THE VOLUMES LISTED** herein are estimates only, based on 16-foot taper breaks, which must be taken into consideration if comparisons are made with volume predictions based on other standards. The volumes based on 32-foot taper breaks are shown for comparison purposes. No sale shall be made for less than the total purchase price, without regard to the amount bid per unit, even though quantity of timber actually cut or removed or designated for taking is more or less than the estimated volume or quantity so listed.

**AN ENVIRONMENTAL ASSESSMENT** was prepared for this sale, and a Finding of No Significant Impact has been documented. These documents are available for inspection as background for this sale at the Northwest Oregon District's Springfield Interagency Office.

**ACCESS** to a sale may be through a locked gate (see individual sale information). Prospective bidders may obtain a key from the Northwest Oregon District's Springfield Interagency Office. Any other persons interested in visiting the timber sale site should first contact this office at (541) 683-6600.

Attachments:

- Form 5440-9
- Form 5430-11
- Form 5450-17
- Form 5450-22

NORTHWEST OREGON DISTRICT  
UPPER WILLAMETTE FIELD OFFICE

**TIMBER SALE NOTICE  
LUMP SUM  
EUGENE MASTER UNIT**

PARCEL NO.: 2  
SALE DATE: August 24, 2023

Contract No.: ORN05-TS23-555, Ghost Town  
Lane County, Oregon: O&C: Oral Auction

Bid Deposit Required: \$326,300.00

All timber designated for cutting on Lot 4, Sec. 7, T. 16 S., R. 1 E.; SW1/4SW1/4, SE1/4SE1/4, Sec. 11, SE1/4NE1/4, S1/2NW1/4, N1/2SW1/4, NE1/4SE1/4, S1/2SE1/4, Sec. 15, N1/2NW1/4, SW1/4NW1/4, Sec. 23, T. 16 S., R. 1 W.; Will. Mer.

Estimated Volume 32' Log (MBF)	Species	Estimated Volume 16' Log (MBF)	Appraised Price Per MBF	Estimated Volume Times Approx. Price
8,854	Douglas-fir	10,214	\$318.80	\$3,256,223.20
58	Western hemlock	68	\$80.60	5,480.80
10	Bigleaf maple	12	\$29.20*	350.40
8,922	Totals	10,294		\$3,262,054.40

\* = 10% Pond Value

APPRAISED PRICES are calculated by determining market value through the analytical appraisal method. The minimum bid increment will be \$0.10 per MBF or multiples thereof.

LOG EXPORT RESTRICTIONS: All timber offered for sale hereunder is restricted from export from the United States in the form of unprocessed timber and is prohibited from being used as a substitute for exported private timber.

NOTE: The volume for this timber sale has been calculated using 16 foot eastside Scribner rules, and the 32 foot log volumes are estimates derived from the 16 foot volumes.

CRUISE INFORMATION: The timber volumes for Douglas-fir and western hemlock in the Regeneration Harvest Areas and Partial Harvest Area were based on a variable plot cruise for estimating board foot volume. Plots were measured using a 40 basal area factor for a total of 210 plots. Bigleaf maple in all Regeneration Harvest Areas were based on a 100% cruise for estimating board foot volume. The timber volumes for Douglas-fir in the right-of-ways were based on a 3P cruise for estimating board foot volume. A map showing the location of the plots and sample trees is available at the Springfield Interagency Office.

With respect to merchantable Douglas-fir (sample) trees; the average tree is 15.9" DBHOB; the average log contains 78 bd. ft.; the total gross merchantable volume is approximately 10,604 MBF; and 96% recovery is expected.

CUTTING AREA: Approximately 172 acres shall be regeneration harvested, 49 acres partially harvested, and approximately 9.2 acres of right-of-way shall be cleared.

ACCESS: Access to the sale is provided by:

1. A public road;
2. BLM existing roads;
3. BLM roads to be constructed;
4. Roads covered by Right-of-Way and Road Use Agreement E-662 between Weyerhaeuser Timber Holdings, Inc. and the United States. In the construction, renovation, use, and maintenance of private roads, and in the use of tailholds, guybacks, and a yarding wedge, the Purchaser shall enter into a license agreement with Weyerhaeuser Timber Holdings, Inc. The license agreement shall be delivered to Weyerhaeuser Timber Holdings, Inc. for execution at least 15 days prior to any use of company roads. See the Prospectus for full terms and conditions of use.

ROAD MAINTENANCE: The Purchaser shall pay to the BLM a road maintenance fee of \$3,340.43 and rockwear fee of \$7,332.07. The Purchaser shall pay a road use fee of \$16,425.00 and a rockwear fee of \$12,406.62, to Weyerhaeuser Timber Holdings, Inc. See the Exhibit D map for specifications of road maintenance responsibility. Only the map page of the Exhibit D is included in the Prospectus. Refer to the contract file for the full Exhibit D.

**In addition to the quantities shown below, 350 cubic yards (truck measure) of maintenance rock (200 cubic yards of 3" minus and 150 cubic yards of 1-1/2" minus) is required. Additional road reinforcement (rocking) may be required for wet weather haul and will be at the Purchaser's expense.**

**ROAD CONSTRUCTION:**

Spurs 7A, 11A, 15A, 15C, 15D, 23A, and 23B, and Road Nos. 16-1-10.2, 16-1-10.3 Ext., 16-1-11 Ext., 16-1-12.2 Ext., 16-1-14 Ext., 16-1-14.1, 16-1-15.5, and 16-1-18.

Length: 32.30 / 81.17 Stations

Class: SN-14 / SN-16

Special Requirements: Operations limited to periods of dry weather. Natural surfaced spurs and roads shall be waterbarred and left in a weather proof condition prior to the onset of wet weather each year of the contract. Installation of stream crossing culverts will be limited to the ODFW in-stream work window, June 1 – October 31, unless a waiver is obtained from ODFW to allow work outside of this time.

**ROAD RENOVATION:**

Spur 15B, Road Nos. 16-1-10 por. 2&3, 16-1-10.3, 16-1-10.4, 16-1-11, 16-1-12 Segs E & F, 16-1-12.2, 16-1-13, 16-1-14, 16-1-14.2, 16-1-15, and 16-1-15.1.

Length: 17.80 / 364.32 Stations

Class: SN-14 / SN-16

Special Requirements: Natural surfaced spurs and roads shall be waterbarred and left in a weather proof condition prior to the onset of wet weather each year of the contract.

Rock Source: Wendling Road Quarry (T. 16 S., R. 1 W., Section 15)

Estimated Rock Quantities (CY truck measure)

<u>3/4" Minus</u>	<u>1-1/2" Minus</u>	<u>3" Minus</u>	<u>6" Jaw Run</u>	<u>Rip Rap</u>	<u>Spl Pad</u>
409	4,426	4,195	5,884	30	58

Culverts:

<u>Diameter:</u>	<u>Length:</u>	<u>Number:</u>
18"	430'	14
24"	163'	5
72"	35'	1

**Total Estimated Exhibit C Road Costs (construction and renovation): \$510,172.95**

**ROAD DECOMMISSIONING:**

Spurs 11A, 15A, 15B, 15C, 15D, and 23B and Road Nos. 16-1-10.2, 16-1-10.3, 16-1-10.3 Ext., 16-1-14 Ext., and 16-1-15.5.

Barriers: 3

Estimated Cost of Decommissioning: \$3,353.15

Special Requirements: Operations limited to periods of dry weather.

**DURATION OF CONTRACT: Duration of the contract will be 36 months for cutting and removal of timber.**

**SPECIAL PROVISIONS:** The contract will contain special provisions regarding road construction, road renovation, road maintenance, road decommissioning, logging methods, prevention of erosion, logging residue reduction, snag creation, quarry development plan, and submission of a written logging plan specifying landing locations and logging schedule.

Under Sec. 26 of the timber sale contract, ground-based logging and mechanical felling will be prohibited during periods of excessive soil moisture. This will normally limit ground-based logging and mechanized felling from June 1 to October 15.

**OTHER SPECIAL REQUIREMENTS:**

1. Purchaser shall purchase from Weyerhaeuser Timber Holdings, Inc. timber from yarding wedges, road construction, and landing renovations.
2. The Purchaser shall be required to clean logging, road, decommissioning, and slash piling equipment prior to entry on BLM lands.
3. In the Right-of-Way (Clearing) of Spurs 15B and 15C, and Road No. 16-1-14 Ext. where they cross reserve areas, white painted trees shall be felled into the reserve areas.
4. Haul on all natural surface roads shall be limited to the dry season (typically June 1-Oct. 31).
5. The Purchaser shall provide a map of requested skyline corridor and skid trail locations, a minimum of seven (7) working days in advance of cutting.

6. When yarding through the Special Protection Area a maximum of two corridors shall be allowed, and slash must be placed to protect the berms from log damage. Lateral yarding beyond 75 feet shall be required.
7. The Purchaser shall be required to cut and process non-merchantable trees in the Regeneration Harvest Areas, except for oak and pine trees.
8. No felling, yarding, or loading is permitted in or through the Reserve Area shown on Exhibit A, except in Special Yarding Areas.
9. Long reaches, intermediate supports, and lift trees will be needed during cable operations.
10. In the Partial Harvest Areas, felled trees shall be bucked into log lengths not to exceed forty-one (41) feet before yarding.
11. In the Regeneration Harvest Areas, whole tree yarding or yarding with tops attached is required.
12. Upon completion of yarding, the Purchaser shall create two hundred forty-two (242) snags by topping and girdling.
13. The Purchaser shall perform logging residue reduction and site preparation work, to include lop and scatter, machine piling, piling at landings, and along roadsides, covering, and pile burning on up to 106 acres.
14. Black 6 Mil plastic shall be required for all pile covering.
15. The Purchaser shall be required to spread BLM-provided seed and mulch at culverts and designated areas.
16. The Purchaser shall be required to file a Notification of Operations with the Oregon Department of Forestry for all harvest operations, snag creation, road construction, and renovation on federal and private lands.

OPTIONAL CONTRIBUTION: The Purchaser will not have the option of contributing funds in lieu of completing logging residue reduction work.

NARRATIVE DESCRIPTION OF HOW TO GET TO SALE AREA:

This sale is accessed through locked gates. Prospective bidders may obtain a key from the Springfield Interagency Office and proceed to the sale area. Any other persons interested in visiting the timber sale should first contact Brian Bickford at (541) 683-6164.

To Harvest Area No. 3: From Springfield, proceed on Marcola Rd. for approximately 11 miles to the junction of Wendling Rd. Proceed east on Wendling Rd. for approximately 3.5 miles to the junction with Road No. 16-1-10. Proceed south on Road No. 16-1-10 for approximately 0.7 mile to the harvest areas.

To Harvest Area No. 2: Return to the junction of Road No. 16-1-10 and Road No. 16-1-10.4. Proceed east on Road No. 16-1-10.4 for approximately 0.1 mile the junction with Road No. 16-1-10.5. Proceed southeast on Road No. 16-1-10.5 for approximately 0.7 mile, then follow the flagging and posting to Harvest Area 2. To access the eastern portion of Harvest Area No. 2, return to the junction of Road Nos. 16-1-10.4 and 16-1-10.5 and proceed east on Road No. 16-1-10.4 for approximately 1.3 mile. The harvest area is accessed on foot to the south.

To Harvest Area No. 4: From Harvest Area No. 2, proceed south on Road No. 16-1-10.5 for approximately 2.1 miles to the junction of Road No. 16-1-12. Proceed west on Road No. 16-1-12 for approximately 0.6 mile to the harvest area.

To Harvest Area No. 1: Return to the junction of Road No. 16-1-10.1 and Road No. 16-1-10.4. Proceed east on Road No. 16-1-10.1 for approximately 1.6 mile to the junction with the Road No. 16-1-12. Proceed south on the Road No. 16-1-12 for approximately 0.9 mile to the junction with Road No. 16-1-13. Proceed east on Road No. 16-1-13 for approximately 0.2 mile. The harvest area is accessed on foot to the north.

UNITED STATES  
DEPARTMENT OF THE INTERIOR  
Bureau of Land Management

Ghost Town Timber Sale Contract No. ORN05-TS23-555  
T. 16 S., R. 1 E., Sec. 7; T. 16 S., R. 1 W., Sec 11, 15, 23, Will. Mer., Northwest Oregon District

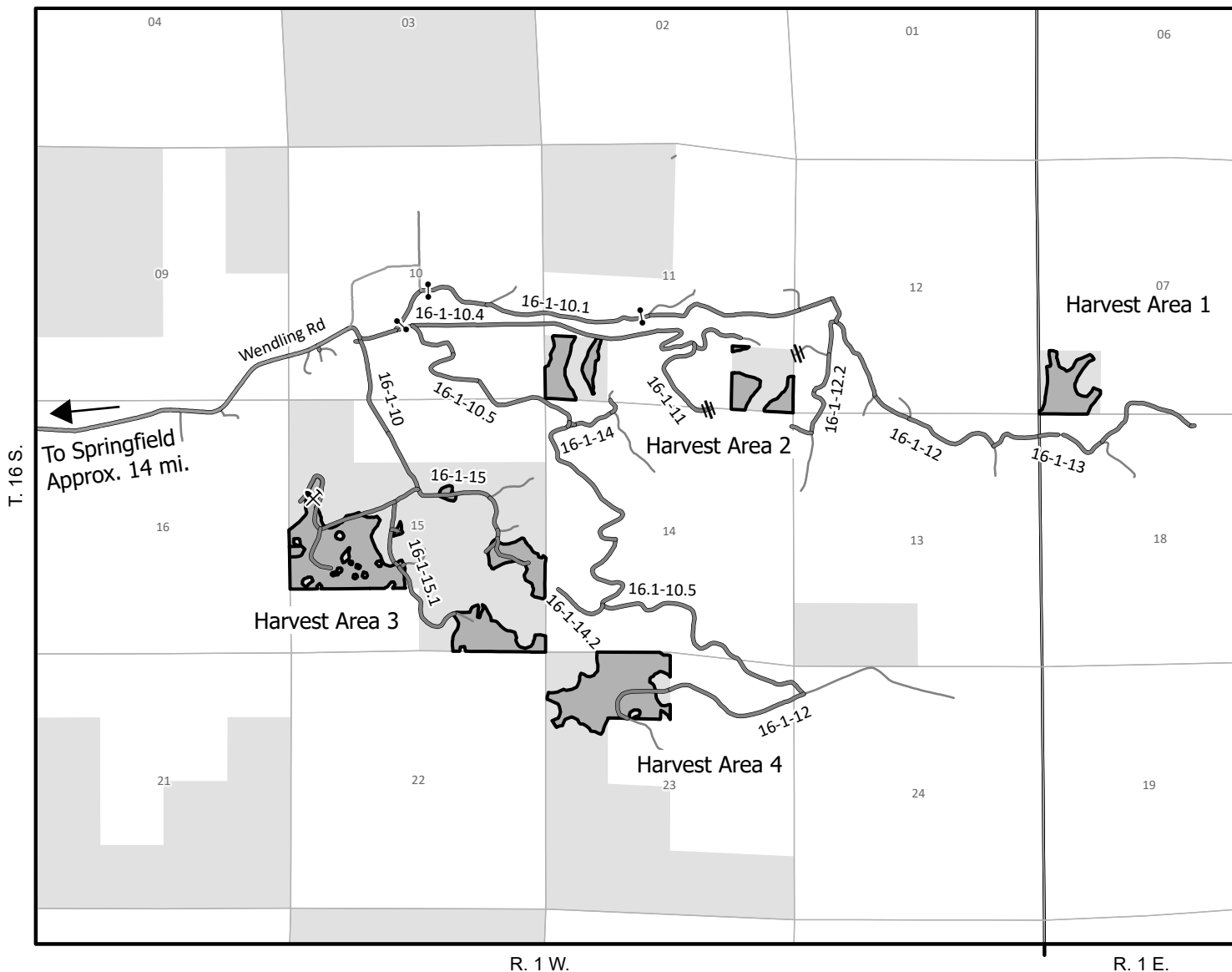

**NARRATIVE DESCRIPTION OF HOW TO GET TO SALE AREA:**

This sale is accessed through locked gates. Prospective bidders may obtain a key from the Springfield Interagency Office and proceed to the sale area. Any other persons interested in visiting the timber sale should first contact Brian Bickford at (541) 683-6164.

**To Harvest Area No. 3:** From Springfield, proceed on Marcola Rd. for approximately 11 miles to the junction of Wendling Rd. Proceed east on Wendling Rd. for approximately 3.5 miles to the junction with Road No. 16-1-10. Proceed south on Road No. 16-1-10 for approximately 0.7 mile to the harvest areas.

**To Harvest Area No. 2:** Return to the junction of Road No. 16-1-10 and Road No. 16-1-10.4. Proceed east on Road No. 16-1-10.4 for approximately 0.1 mile the junction with Road No. 16-1-10.5. Proceed southeast on Road No. 16-1-10.5 for approximately 0.7 mile, then follow the flagging and posting to Harvest Area 2. To access the eastern portion of Harvest Area No. 2, return to the junction of Road Nos. 16-1-10.4 and 16-1-10.5 and proceed east on Road No. 16-1-10.4 for approximately 1.3 mile. The harvest area is accessed on foot to the south.

**To Harvest Area No. 4:** From Harvest Area No. 2, proceed south on Road No. 16-1-10.5 for approximately 2.1 miles to the junction of Road No. 16-1-12. Proceed west on Road No. 16-1-12 for approximately 0.6 mile to the harvest area.

**To Harvest Area No. 1:** Return to the junction of Road No. 16-1-10.1 and Road No. 16-1-10.4. Proceed east on Road No. 16-1-10.1 for approximately 1.6 mile to the junction with the Road No. 16-1-12. Proceed south on the Road No. 16-1-12 for approximately 0.9 mile to the junction with Road No. 16-1-13. Proceed east on Road No. 16-1-13 for approximately 0.2 mile. The harvest area is accessed on foot to the north.

- Haul Route
- Existing Road
- Harvest Area
- Gate
- || Inaccessible
- ✕ Quarry
- Township Lines
- Section Lines
- BLM Administered Lands

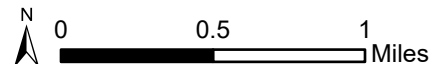

United States Department of the Interior  
Bureau of Land Management  
Oregon State Office  
P.O. Box 2965  
Portland, Oregon 97208-2965

No warranty is made by the Bureau of Land Management as to the accuracy, reliability, or completeness of these data for individual or aggregate use with other data. Original data were compiled from various sources. This information may not meet National Map Accuracy Standards. This product was developed through digital means and may be updated without notification.

## Seasonal Restriction Matrix

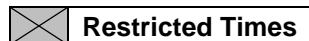

Restricted Times

Restricted Activity:	Jan		Feb		Mar		Apr		May		June		July		Aug		Sept		Oct		Nov		Dec	
	1	15	1	15	1	15	1	15	1	15	1	15	1	15	1	15	1	15	1	15	1	15	1	15
<b>Road Construction, Renovation, Decommissioning, Dry Season Haul, and Stream Culvert Installation, Replacement, or Removal</b>																								
<ul style="list-style-type: none"> <li>November 1 – May 31, both days inclusive.</li> <li>May vary due to weather conditions; soil moisture still overrides weather conditions.</li> </ul>																								
<b>Partial Harvest Area Yarding-Sap Flow</b>																								
<ul style="list-style-type: none"> <li>April 1 to June 15, both days inclusive.</li> <li>Sap flow restrictions may be conditionally waived at the discretion of BLM.</li> </ul>																								
<b>Mechanized Felling and Ground Based Yarding</b>																								
<ul style="list-style-type: none"> <li>October 16 – May 31, both days inclusive.</li> <li>May vary due to weather conditions; soil moisture still overrides weather conditions.</li> </ul>																								

NOTE: This chart is for informational purposes only. Refer to Section 42 Special Provisions of the timber sale contract for exact date restrictions and specifications. Subject to transient winter snow, elevation ranges from 900 – 2000 feet.

UNITED STATES  
DEPARTMENT OF THE INTERIOR  
Bureau of Land Management

EXHIBIT A

Sheet 1 of 4

Ghost Town Timber Sale Contract No. ORN05-TS23-555  
T. 16 S., R. 1 E., Sec. 7 Will. Mer., Northwest Oregon District

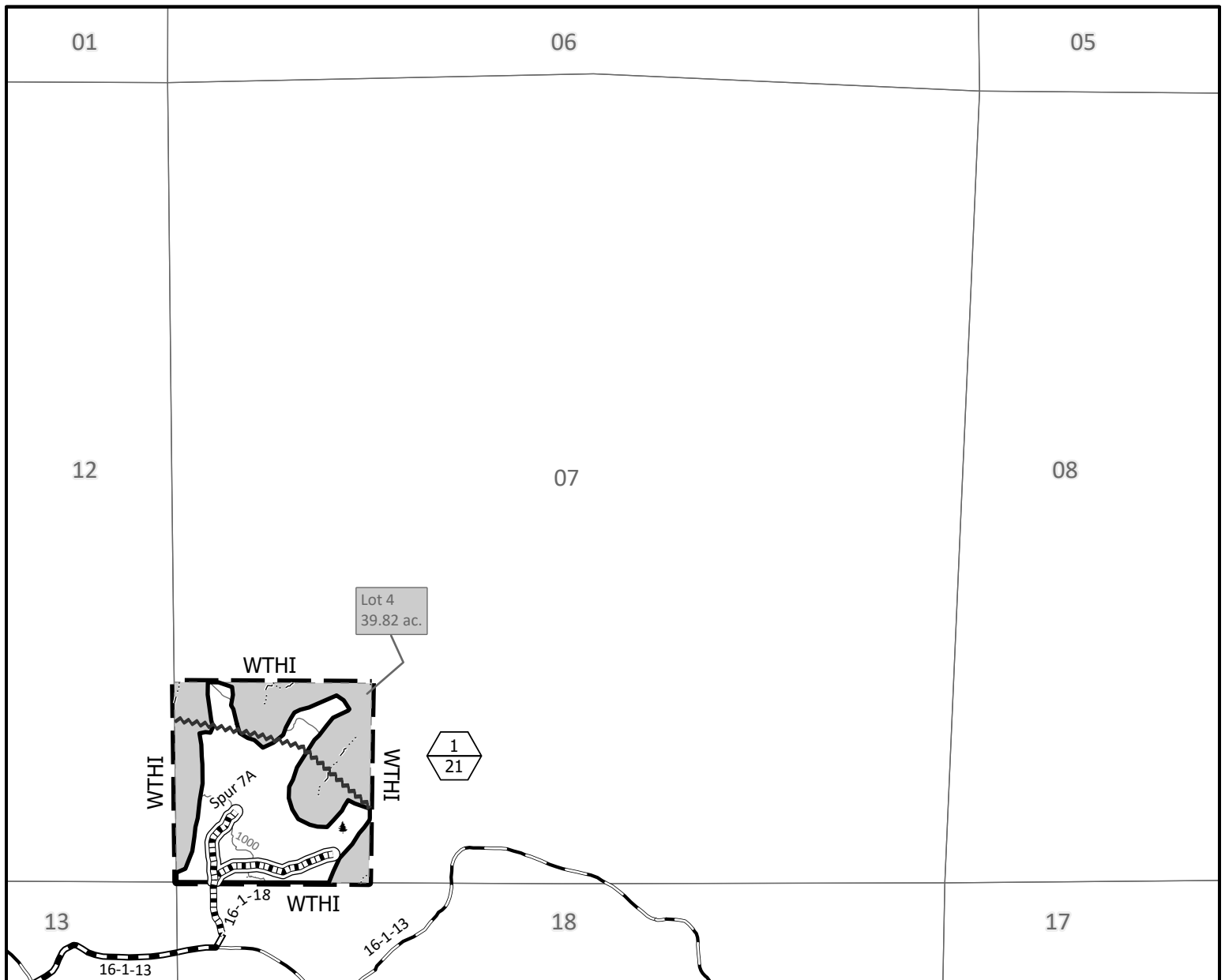

- Contract Area
- Special Protection Area
- Boundary of Cutting Area - Posted, Painted
- Regeneration Harvest Area
- Right-of-Way (Clearing)
- Reserve Area
- New Construction - Rock
- Renovation/Improvement
- Rocked Road
- Approximate Location of Pink Painted Trees
- Streams
- Unit Number (Top)  
Unit Acres (Bottom)

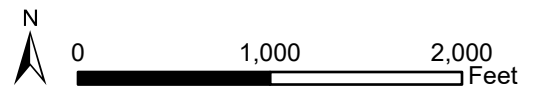

Totals for Sale	
Regeneration Harvest Area	172.00
Partial Harvest Area	49.00
Right-of-Way (Clearing)	9.00
Reserve Area	329.82
Contract Area	559.82

Totals for Section 7	
Regeneration Harvest Area	21.00
Right-of-Way (Clearing)	1.50
Reserve Area	17.32
Contract Area	39.82

No warranty is made by the Bureau of Land Management as to the accuracy, reliability, or completeness of these data for individual or aggregate use with other data. Original data were compiled from various sources. This information may not meet National Map Accuracy Standards. This product was developed through digital means and may be updated without notification.

United States Department of the Interior  
Bureau of Land Management  
Oregon State Office  
P.O. Box 2965  
Portland, Oregon 97208-2965



**UNITED STATES  
DEPARTMENT OF THE INTERIOR  
Bureau of Land Management**

Ghost Town Timber Sale Contract No. ORN05-TS23-555  
T. 16 S., R. 1 W., Sec. 11 Will. Mer., Northwest Oregon District

**EXHIBIT A**

Sheet 2 of 4

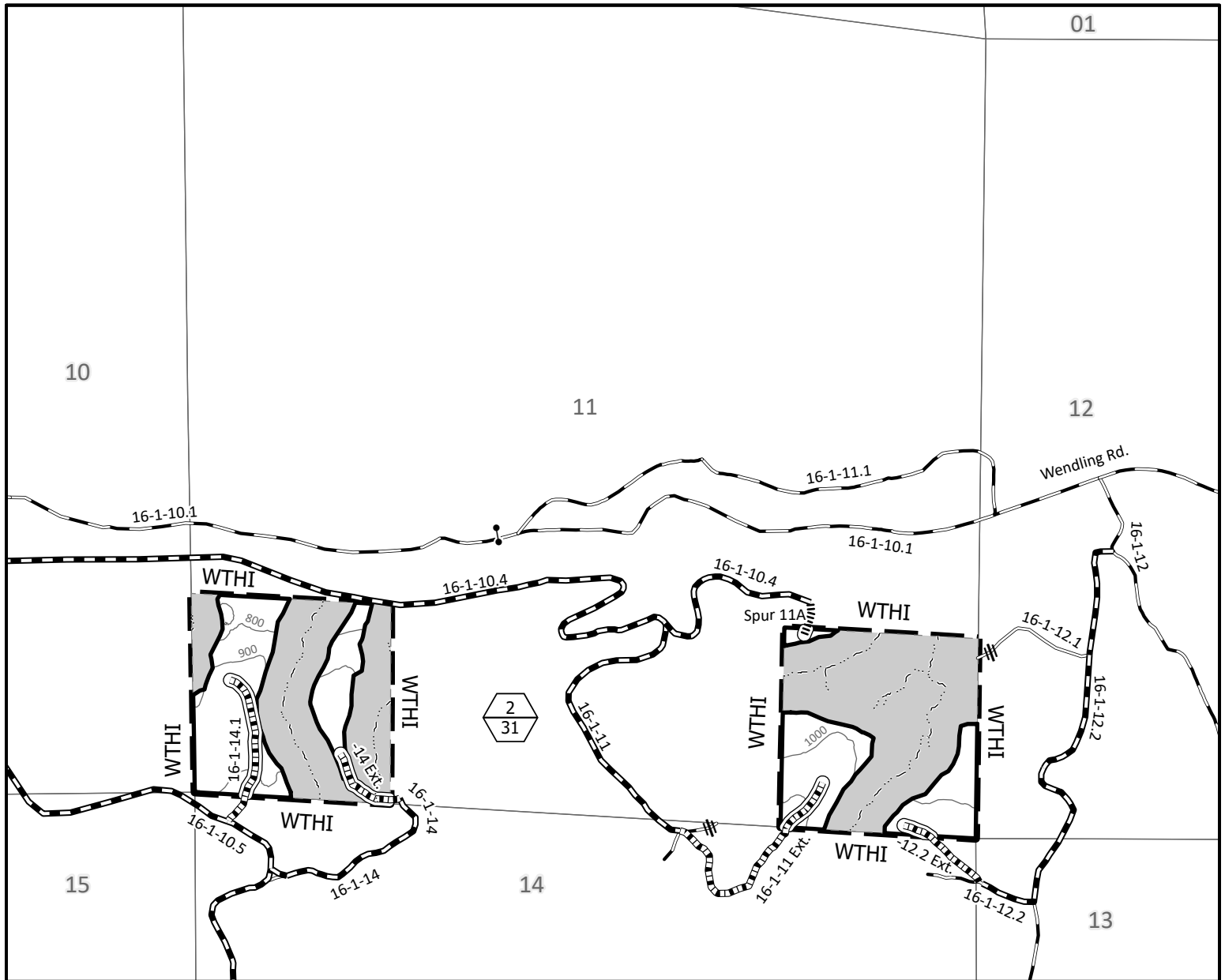

- |  |   |  |  |
|--|---|--|--|
|  | Contract Area                                 |  | Rocked Road                              |
|  | Boundary of Cutting Area -<br>Posted, Painted |  | Natural Road                             |
|  | Regeneration Harvest Area                     |  | Gate                                     |
|  | New Construction - Rock                       |  | Inaccessible                             |
|  | New Construction - Natural                    |  | Streams                                  |
|  | Renovation/Improvement                        |  | Unit Number (Top)<br>Unit Acres (Bottom) |
|  | Right-of-Way (Clearing)                       |  |  |
|  | Reserve Area                                  |  |  |

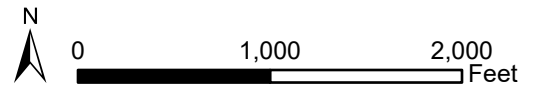

Totals for Section 11	
Regeneration Harvest Area	31.0
Right-of-Way (Clearing)	1.7
Reserve Area	47.3
Contract Area	80.0

No warranty is made by the Bureau of Land Management as to the accuracy, reliability, or completeness of these data for individual or aggregate use with other data. Original data were compiled from various sources. This information may not meet National Map Accuracy Standards. This product was developed through digital means and may be updated without notification.

United States Department of the Interior  
Bureau of Land Management  
Oregon State Office  
P.O. Box 2965  
Portland, Oregon 97208-2965

## Sheet 3 of 4

[illegible]

- 

Totals for Section 15	
Regeneration Harvest Area	60.0
Partial Harvest Area	49.0
Right-of-Way (Clearing)	5.2
Reserve Area	205.8
Contract Area	320.0

No warranty is made by the Bureau of Land Management as to the accuracy, reliability, or completeness of these data for individual or aggregate use with other data. Original data were compiled from various sources. This information may not meet National Map Accuracy Standards. This product was developed through digital means and may be updated without notification.

United States Department of the Interior  
Bureau of Land Management  
Oregon State Office  
P.O. Box 2965  
Portland, Oregon 97208-2965

**UNITED STATES  
DEPARTMENT OF THE INTERIOR  
Bureau of Land Management**

**EXHIBIT A**

Sheet 4 of 4

Ghost Town Timber Sale Contract No. ORN05-TS23-555  
T. 16 S., R. 1 W., Sec. 23 Will. Mer., Northwest Oregon District

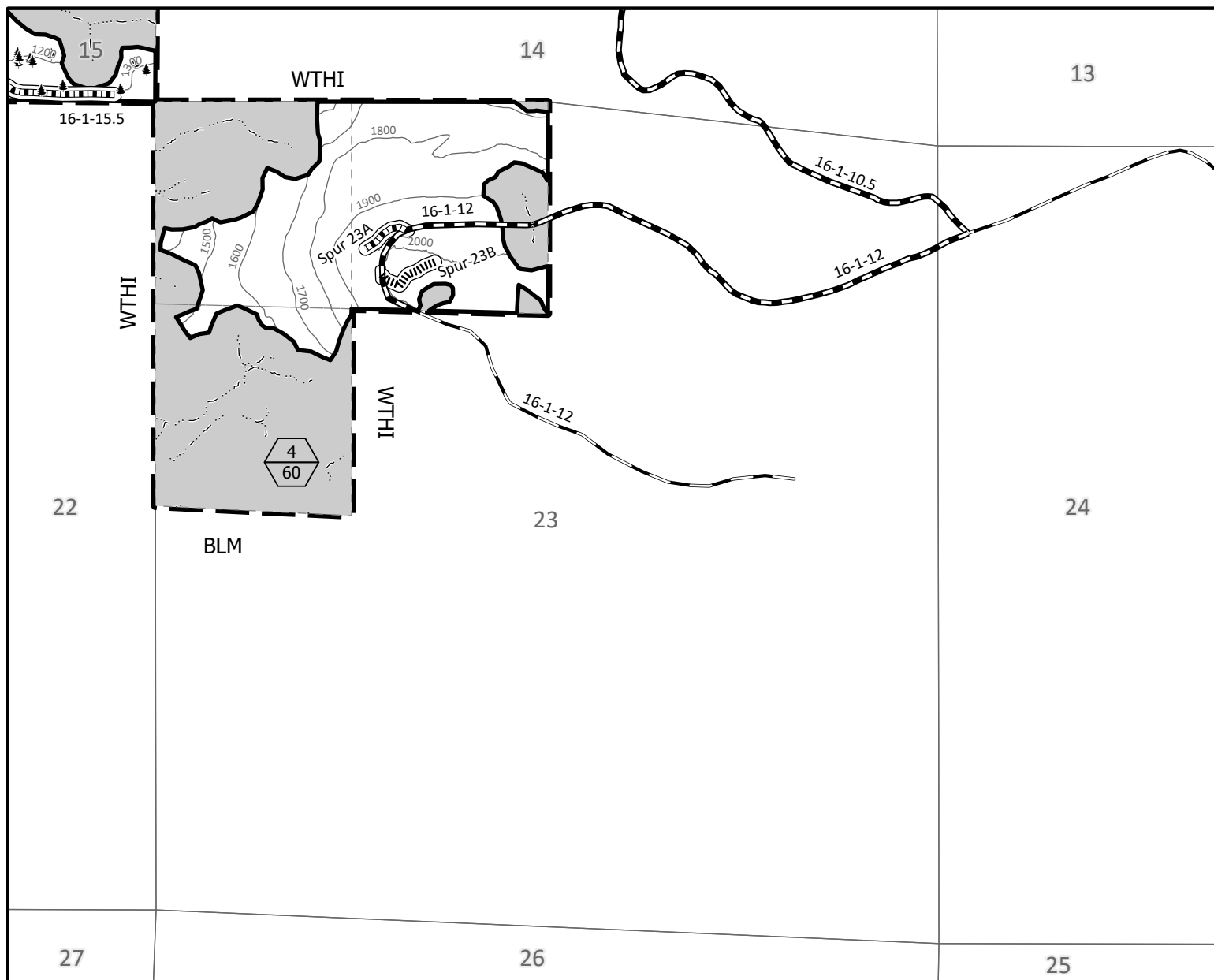

- |  |   |  |   |
|--|---|--|---|
|  | Contract Area                                 |  | New Construction - Rock                       |
|  | Boundary of Cutting Area -<br>Posted, Painted |  | New Construction - Natural                    |
|  | Regeneration Harvest Area                     |  | Renovation/Improvement                        |
|  | Right-of-Way (Clearing)                       |  | Rocked Road                                   |
|  | Reserve Area                                  |  | Approximate Location of<br>Pink Painted Trees |
|  |   |  | Streams                                       |
|  |   |  | Unit Number (Top)<br>Unit Acres (Bottom)      |

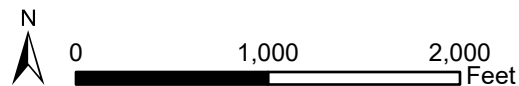

Totals for Section 29	
Regeneration Harvest Area	60.0
Right-of-Way (Clearing)	0.6
Reserve Area	59.4
Contract Area	120

No warranty is made by the Bureau of Land Management as to the accuracy, reliability, or completeness of these data for individual or aggregate use with other data. Original data were compiled from various sources. This information may not meet National Map Accuracy Standards. This product was developed through digital means and may be updated without notification.

United States Department of the Interior  
Bureau of Land Management  
Oregon State Office  
P.O. Box 2965  
Portland, Oregon 97208-2965

UNITED STATES  
DEPARTMENT OF THE INTERIOR  
BUREAU OF LAND MANAGEMENT

**EXHIBIT B**

**LUMP SUM SALE**

Contract No.

ORN05-TS23-555

Ghost Town

The following estimates and calculations of value of timber sold are made solely as an administrative aid for determining: (1) adjustments made or credits given in accordance with Secs. 6, 9, or 11; (2) when payments are due; and (3) value of timber subject to any special bonding provisions. The value of timber will be determined by multiplying the value per acre as shown below, times the amount of acreage as determined by the Authorized Officer, which has been cut or removed or designated for taking. Except as provided in Sec. 2, Purchaser shall be liable for total purchase price even though quantity of timber actually cut or removed or designated for taking is less than the estimated volume or quantity shown. Cutting areas are shown on **Exhibit A**.

SPECIES	ESTIMATED VOLUME OR QUANTITY <i>(Units Specified)</i>	PRICE PER UNIT	AMOUNT OF ESTIMATED VOLUME OR QUANTITY X UNIT PRICE
Douglas-fir	10,214.0 MBF		
Western hemlock	68.0 MBF		
Bigleaf maple	12.0 MBF		
<b>TOTALS</b>	<b>10,294.0 MBF</b>		

The apportionment of the total purchase price is as follows:

Partial Harvest Area No. 3 – 49.0 Acres (14.5 MBF/Acre)

Douglas-fir	697.0 MBF
Western hemlock	14.0 MBF
	<hr/> 711.0 MBF

Regen Harvest Area No. 1 – 21.0 Acres (54.5 MBF/Acre)

Douglas-fir	1,139.0 MBF
Western hemlock	6.0 MBF
	<hr/> 1,145.0 MBF

Regen Harvest Area No. 2 – 31.0 Acres (54.6 MBF/Acre)

Douglas-fir	1,682.0 MBF
Western hemlock	10.0 MBF
	<hr/> 1,692.0 MBF

Regen Harvest Area No. 3 – 60.0 Acres (54.6 MBF/Acre)

Douglas-fir	3,255.0 MBF
Western hemlock	19.0 MBF
	<hr/> 3,274.0 MBF

Regen Harvest Area No. 4 – 60.0 Acres (54.8 MBF/Acre)

Douglas-fir	3,255.0 MBF
Western hemlock	19.0 MBF
Bigleaf maple	12.0 MBF
	<hr/> 3,286.0 MBF

Right-of-Way Area 1 – 1.5 Acres (7.3 MBF/Acre)

Douglas-fir	11.0 MBF
	<hr/> 11.0 MBF

UNITED STATES  
DEPARTMENT OF THE INTERIOR  
BUREAU OF LAND MANAGEMENT

**EXHIBIT B**

LUMP SUM SALE

Contract No.

ORN05-TS23-555

Ghost Town

SPECIES	ESTIMATED VOLUME OR QUANTITY <i>(Units Specified)</i>	PRICE PER UNIT	AMOUNT OF ESTIMATED VOLUME OR QUANTITY X UNIT PRICE
---------	--	----------------	--

Continued, page 2

<u>Right-of-Way Area 2</u> – 1.7 Acres	(47.6 MBF/Acre)
Douglas-fir	81.0 MBF
	<hr/> 81.0 MBF

<u>Right-of-Way Area 3</u> – 5.4 Acres	(12.8 MBF/Acre)
Douglas-fir	69.0 MBF
	<hr/> 69.0 MBF

<u>Right-of-Way Area 4</u> – 0.6 Acres	(41.7 MBF/Acre)
Douglas-fir	25.0 MBF
	<hr/> 25.0 MBF

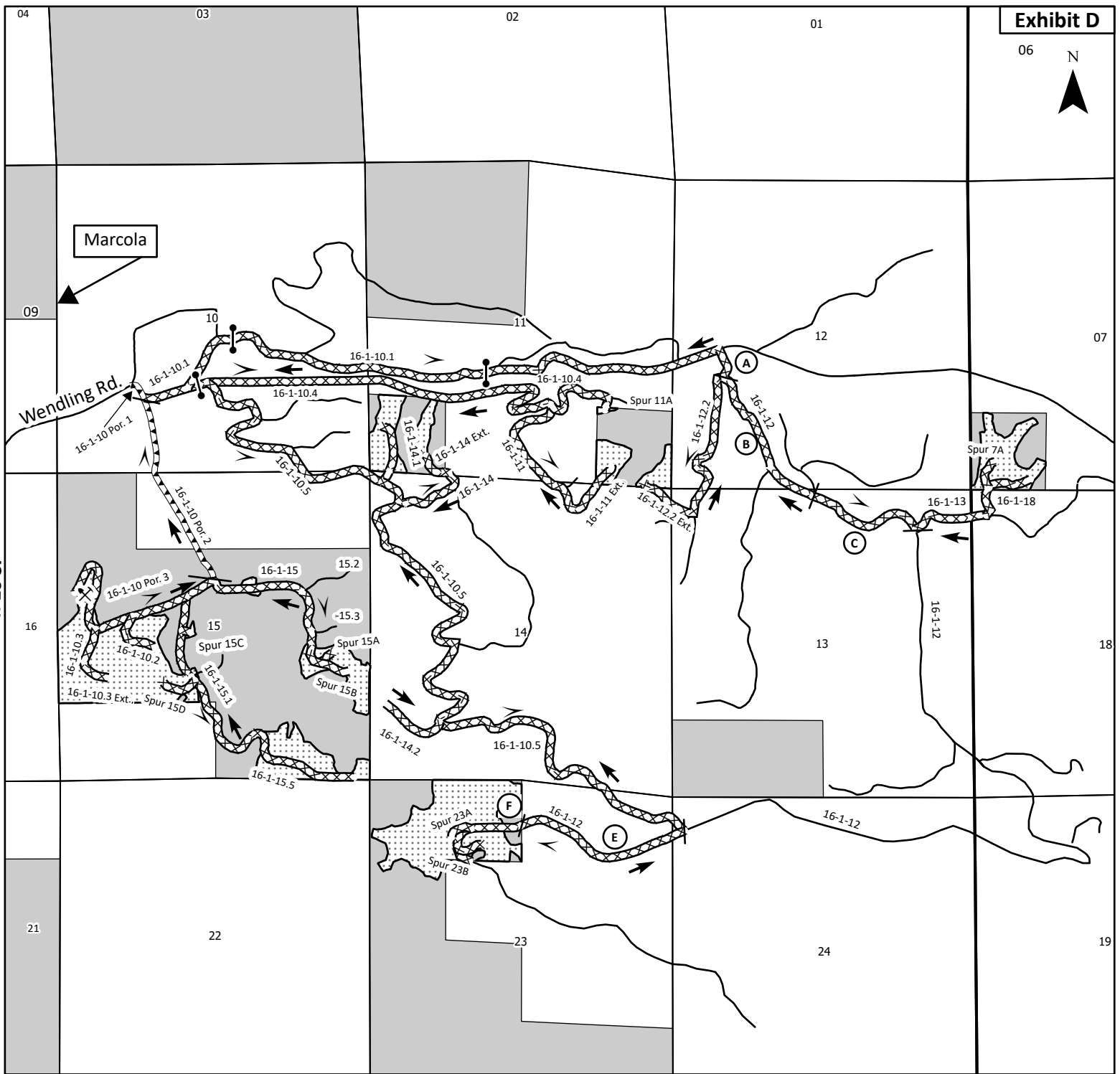
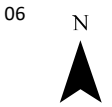

R. 1 W. R. 1 E.

**SALE NAME: GHOST TOWN**  
**CONTRACT NO.: ORN05-TS23-555**

**United States Department of the Interior**  
**Bureau of Land Management**  
**Northwest Oregon District, Upper Willamette Field Office**

**Legend**

- |                       |                           |
|-----------------------|---------------------------|
| BLM Maintenance       | Bureau of Land Management |
| Purchaser Maintenance | Private                   |
| Gate                  | Other Roads               |
| Quarry                | Harvest Unit              |
| Segment Break         | Timber Haul Route         |
| Segment               | Mineral Haul Route        |

0 0.25 0.5 1 Miles

**Road Maintenance Map**  
**T.16 S., R1 W., Sections 10, 11, 12, 13, 14, 15, 23, & 24**  
**T.16 S., R1 E., Sections 07 & 18**  
**Willamette Meridian, Lane County, Oregon**



**Designed By: M. Reller**  
**Drawn By: M. Reller**  
**Date: March 2023**



SEC. 43 - Timber Reserved From Cutting and/or Removal

- (a) All timber on the Reserve Areas shown on Exhibit A, which is attached hereto and made a part hereof, and all yellow painted and posted trees which are on or mark the boundaries of the Reserve Areas. Exhibit A contains 4 sheets.
- (b) All trees marked with yellow paint above and below stump height in the Regeneration Harvest Areas and Partial Harvest Area shown on Exhibit A.
- (c) All trees marked with pink paint above and below stump height in the Approximate Location of Pink Painted Trees shown on Exhibit A. Pink painted trees felled for safety or operational reasons shall remain on site. Where necessary for safety or operational reasons, pink painted trees may be bucked into shorter lengths and/or moved within the unit as close to where felled as safely possible.
- (d) All trees marked with white paint above and below stump height in the Right-of-Way (Clearing) of Spurs 15B and 15C, and Road No. 16-1-14 Ext., where they pass through the Reserve Area as shown on Sheets 2 and 3 of Exhibit A. White painted trees shall be felled into the Reserve Areas. Where necessary for safety or operational reasons, white painted trees may be bucked into shorter lengths and/or moved within the Reserve Areas adjacent to the Right-of-Way (Clearing) to facilitate the use and maintenance of roads.
- (e) All existing decay class 1-2 down wood and snags greater than 20 inches in diameter at the large end and greater than 20 feet in length in the Harvest Areas and Special Yarding Areas shown on Exhibit A. Decay classes are illustrated on Exhibit I and Exhibit L, which are attached hereto and made a part hereof. Where necessary for safety or operational reasons, such down woody material and snags may be felled and/or bucked into shorter lengths and/or moved within the unit.
- (f) All existing decay class 3-5 down wood and snags in the Harvest Areas and Special Yarding Areas shown on Exhibit A. Decay classes are illustrated on Exhibit I and Exhibit L. Where necessary for safety or operational reasons, such down woody material and snags may be felled and/or bucked into shorter lengths and/or moved within the unit.
- (g) In the Harvest Areas and Special Yarding Areas shown on Exhibit A, all oaks and pines which do not present a safety hazard, or where felling is not needed for operational activities, as determined by the Authorized Officer. All oaks and pines that are felled for safety and operational reasons shall remain on site. Where necessary for safety or operational reasons, oaks and pines may be bucked into shorter lengths and/or moved within the unit as close to where felled as safely possible.
- (h) In the Partial Harvest Area shown on Exhibit A, all Pacific yew and hardwood trees which do not present a safety hazard, or where removal is not needed for operational activities, as determined by the Authorized Officer. All Pacific yew and hardwood trees that are felled for safety and operational reason shall remain on site. Where necessary for safety or operational reasons, Pacific yew and hardwood trees may be bucked into shorter lengths and/or moved within the unit as close to where felled as safely possible.

SEC. 44 - Special Provisions

- (a) Logging
  - (1) Before beginning operations on the contract area for the first time or after a shutdown of 14 or more days, the Purchaser shall notify the Authorized Officer in writing of the date they plan to begin operations. This written notification must be received by the Authorized Officer no less than 14 days prior to the date the Purchaser plans to begin or resume operations. The Purchaser shall also notify the Authorized Officer in writing if they intend to cease operations for any period of 10 or more days.
  - (2) Prior to the commencement of operations, the Purchaser shall obtain from the Authorized Officer written approval of a written operations and logging plan commensurate with the terms and conditions of the contract which shall include measures needed to assure protection of the environment and watershed.

- A pre-work conference between the Purchaser's authorized representative and the Authorized Officer's representative must be held at a location designated by the Authorized Officer before the logging plan will be approved. All logging shall be done in accordance with the plan.
- (3) No felling, yarding, or loading is permitted in or through the Reserve Areas shown on Exhibit A, except when yarding through Special Yarding Areas shown on Exhibit A. Where necessary for safety or operational reasons, corridor and skid trail trees shall be cut and removed in accordance with Section 44(a)(16).
  - (4) No ground based operations shall be allowed in or through the Special Protection Area shown on Sheet 1 of Exhibit A. A maximum of two (2) cable yarding corridors shall be allowed to cross the Special Protection Area, and slash and logs shall be placed within the corridors where they cross the Special Protection Area to reduce damage to the berms and cutbanks in this area.
  - (5) In the Regeneration Harvest Areas shown on Exhibit A, all trees designated for cutting shall be felled to the lead, whole tree yarded, or yarded with tops attached. Trees shall be directionally felled away from Special Protection Area, Reserve Areas, pink painted trees, and yellow painted trees, except when necessary for safety reasons.
  - (6) In the Regeneration Harvest Areas shown on Exhibit A, all hardwoods except when reserved in Section 43(g), more than six (6) inches in diameter shall be felled concurrently with all other trees designated for cutting. All tops and branches must be free of the central stem to the extent that it is within a maximum of twenty (20) inches of the ground at all points.
  - (7) In the Regeneration Harvest Areas shown on Exhibit A, at all landings, all non-merchantable logs (including hardwoods) more than 8 inches in diameter at the large end and exceeding 8 feet in length shall be decked at a location designated by the Authorized Officer.
  - (8) In the Partial Harvest Area shown on Exhibit A, all trees designated for cutting shall be felled to the lead and bucked into log lengths not to exceed 41 feet before being yarded unless otherwise approved by the Authorized Officer. Trees shall be directionally felled away from Reserve Areas and pink painted trees, except when necessary for safety or operational reasons.
  - (9) Haul on all natural surface roads shall be limited to the dry season (typically June 1 through October 31), as determined by the Authorized Officer.
  - (10) Mechanized felling and ground based yarding shall occur typically between June 1 – October 15 or as approved by the Authorized Officer.
  - (11) In the Partial Harvest Area shown on Exhibit A, no harvest activities shall be conducted from April 1 to June 15 of each year, both days inclusive, for sap flow, unless otherwise requested and approved in writing by the Authorized Officer.
  - (12) Prior to attaching any logging equipment to a reserve tree, the Purchaser shall obtain approval from the Authorized Officer and shall take precautions to protect the tree from damage as directed in writing by the Authorized Officer.
  - (13) In the Regeneration Harvest Areas and Partial Harvest Area shown on Exhibit A, felling and yarding may be done with ground based equipment on slopes of 35% or less. In the Partial Harvest Area, the use of a log loader shall not be permitted for in-unit yarding unless approved by the Authorized Officer. In the Regeneration Harvest Areas, felling and yarding may be done with specialized ground based equipment on slopes up to 50%. The specialized ground based equipment shall be approved by the Authorized Officer prior to the start of mechanized felling and yarding operations. Only purpose-built carriers with boom-mounted felling heads may be approved. Purpose-built carriers may be of articulated, rubber-tired design, or the leveling track-mounted design.



- (14) In the Regeneration Harvest Areas, Partial Harvest Area, and Special Yarding Areas shown on Exhibit A, all slopes greater than 35% (or 50% if specialized ground based equipment is used as stated in Section 44(a)(13)) shall be yarded with a carriage equipped skyline system capable of laterally yarding at least 75 feet from the skyline road. The carriage shall be capable of being held in position on the skyline during lateral yarding. During yarding, the lead end of the logs shall be suspended clear of the ground. Intermediate supports and/or lift trees may be needed.
- (15) Before clearing any skid trail or skyline road necessary for yarding, the Purchaser shall:
- (aa) Space designated skid trails or skyline roads at a minimum of 150 feet apart unless approved by the Authorized Officer. Parallel settings are preferred if topography allows.
  - (bb) Mark the location of the skid trail or skyline road on the ground with fluorescent pink plastic flagging. Such skid trails or skyline roads shall be limited to the minimum width necessary for yarding of logs. The width of each skid road or skyline road shall not exceed 12 feet.
  - (cc) Place skid trails and skyline roads on the landscape to avoid disturbance to reserved trees, where feasible.
  - (dd) Provide a map of requested skid trail or skyline road locations a minimum of seven (7) working days in advance of cutting to obtain approval of the locations from the Authorized Officer. Proposed skid trails and skyline roads shall remain free from felled trees until approved.
- (16) Before cutting and removing any reserve trees necessary to facilitate logging in the Regeneration Harvest Areas, Partial Harvest Area, and Special Yarding Areas shown on Exhibit A, the Purchaser shall identify the location of the skid trails and skyline roads in accordance with Section 44(a)(15) and tieback, guyline, lift, intermediate support, and danger trees on the ground in a manner approved by the Authorized Officer at the pre-work conference and documented in the Logging Plan. Said Purchaser identification of trees to be cut and removed does not constitute authority to proceed with cutting and removal. In addition, before proceeding, the following conditions must be met:
- (aa) All skid trails and/or skyline roads upon which timber is identified by the Purchaser to be cut and removed in accordance with this special provision must be necessary for the safe and expeditious removal of timber sold under this contract and shall be limited to the minimum width necessary for yarding of logs with a minimum of damage to reserve trees, however, unless otherwise approved in writing by the Authorized Officer, the width of each skid trail, and/or skyline road shall be limited to 12 feet.
  - (bb) The Purchaser may immediately cut and remove additional timber to clear skid trails and skyline roads; and provide tailhold, tieback, guyline, lift and intermediate support trees; and clear danger trees when the trees have been marked with blue paint above and below stump height by the Authorized Officer and thereby approved for cutting and removal by the Authorized Officer. The volume of the timber to be sold will be determined by the Authorized Officer in accordance with Bureau of Land Management prescribed procedures. No timber may be cut or removed under terms of this provision unless sufficient installment payments have been made in accordance with Section 3(b) of the contract or sufficient bonding has been provided in accordance with Section 3(d) of the contract.
  - (cc) The Purchaser agrees that sale of this additional timber shall be accomplished by a unilateral modification of the contract executed by the Contracting Officer and that such timber shall be sold at the unit prices shown in Exhibit B of this contract unless: the value of the timber must be reappraised subject to the terms for contract extension set forth in Section 9 of the contract.

- (dd) This authorization for the Purchaser to cut and remove additional timber prior to the execution of a modification may be withdrawn by the Contracting Officer if the Authorized Officer determines that the Purchaser has cut and removed any tree not previously marked and approved for cutting by the Authorized Officer, which under Section 10 of the contract constitutes a violation of the contract and under Section 13 of the contract may constitute a trespass rendering the Purchaser liable for damages under applicable law.
  - (ee) If authorization is withdrawn, the Contracting Officer shall issue a written notice to the Purchaser that the sale of additional timber under this special provision is no longer approved. In this case, the Purchaser shall inform the Authorized Officer at least one (1) working day prior to the need for cutting and removing any additional timber, and execute a bilateral modification prior to cutting for such additional approved timber at the unit prices shown in Exhibit B of the contract, or in accordance with Section 8 or Section 9 of the contract, as determined by the Authorized Officer in accordance with this provision. The Contracting Officer may issue a written order to the Purchaser to suspend, delay, or interrupt any or all contract work for the period of time deemed necessary and appropriate for the Government to safely measure and mark additional timber.
  - (ff) The Government may reserve trees previously designated for cutting and removal by applying yellow paint in the Regeneration Harvest Areas above and below stump height and the letter "R" on two sides of the trees as replacements for additional trees cut and removed for skid trails, and/or skyline roads, when the Authorized Officer determines such reservation is necessary to maintain stand densities consistent with objectives set forth in the management prescription. This may include the replacement of trees damaged by storm events, insects, or disease. The volume of this timber to be reserved will be determined by the Authorized Officer in accordance with Bureau of Land Management prescribed procedures and the value shall be based on the unit prices shown in Exhibit B of the contract. The Purchaser agrees that the Total Purchase Price shall be reduced accordingly through a unilateral modification to the contract executed by the Contracting Officer.
- (17) In accordance with the requirements of Section 8 of the contract it has been determined that it is in the best interest of the Government and within the provisions of 43 CFR 5402.0-6 to sell additional timber located in the Harvest Areas to meet all applicable State safety laws, codes, or regulations. This timber must be cut or removed so that the Purchaser can continue active falling and yarding operations. The Purchaser is, therefore, authorized to cut and remove such additional timber in accordance with the provisions of Section 8 of the contract: provided, that:
- (aa) Pink painted trees felled for safety or operational reasons shall not be removed, in accordance with Section 43(c).
  - (bb) The Purchaser shall identify each tree sold and cut in accordance with the provision by marking the cut surface of the stump immediately after falling with a large "X". The "X" shall be cut with a chain saw. The stump shall be marked by hanging flagging so that the stump can be visually located from a distance of not less than 50 feet. The Purchaser shall also paint an identifiable "X" on the butt log. The butt log shall remain on the contract area until such time as the Authorized Officer has scaled such additional timber and authorizes removal from the contract area.
  - (cc) The volume and price for such timber shall be determined by the Authorized Officer in accordance with Bureau of Land Management prescribed procedures and paid for by the Purchaser in accordance with Section 3(b) or 3(f) of the contract as required by Section 8 of the contract.
  - (dd) No timber may be cut or removed under the terms of this provision if all contract payments required by Section 3(b) or 3(f) of the contract have been made.

(ee) The permission to cut and remove additional timber contained in this provision may be withdrawn by the Contracting Officer if the Authorized Officer determines that the Purchaser:

- (1) Failed to properly mark any stump with the "X" cut.
- (2) Failed to identify the location of any stump.
- (3) Cut any reserve tree in or adjacent to skyline yarding roads that was not necessary to facilitate skyline yarding.
- (4) Cut any reserve tree in or adjacent to tractor skid trails that was not necessary to facilitate ground based yarding.
- (5) Failed to properly segregate any pulled over tree that was yarded to the landing.
- (6) Cut any reserve tree that was not severely (as defined during the prework conference and documented in the approved logging plan) damaged from felling and yarding operations.
- (7) Cut more than the minimum number of trees necessary to properly serve as guyline anchor stumps.
- (8) Cut or topped more than the minimum number of trees necessary to properly serve as tailhold trees.
- (9) Failed to maintain accurate and current (no more than 24 hours old) documentation of cut and removed timber.

If the permission to cut and remove additional timber provision is withdrawn, the Purchaser shall inform the Authorized Officer at least five working days prior to the need for cutting and yarding any guyline tree, tailhold tree, tie-back tree, danger tree, corridor tree, pulled over tree, and severely damaged tree. All sales of additional timber shall comply with Section 8 of the contract. The Contracting Officer may order the Purchaser, in writing, to suspend, delay, or interrupt all or any part of the work of this contract for the period of time that the Contracting Officer determines appropriate for the Government to safely measure and mark additional timber.

All skyline yarding and/or ground based equipment skid trails upon which timber may be cut and removed in accordance with this special provision must be needed for the removal of timber sold under this contract and shall be limited to the narrowest width necessary for the yarding of logs with minimum damage to reserved trees.

The Purchaser shall be liable for damages in accordance with Section 13 of the contract for any reserved timber cut or removed in violation of the terms of this special provision.

- (18) Unless otherwise authorized in writing by the Contracting Officer, the Purchaser shall brand clearly and legibly one end of all logs with a scaling diameter (small end inside bark) of over ten (10) inches, prior to the removal of timber from the contract area. All loads of eleven (11) logs or more will have a minimum of ten (10) logs clearly and legibly branded on one end regardless of the diameter of the logs. All logs will be branded on loads of ten (10) logs or less. One end of all branded logs to be processed domestically will be marked with a three (3) square inch spot of highway yellow paint. The purchaser will stop trucks for accountability monitoring at mutually agreed upon locations when notified by the Authorized Officer.

If multiple trailers (mule trains) are used, each bunked load shall be considered an individual load, and these guidelines will apply to each bunked load. If a flatbed stake trailer is used, each bundle will be treated as a separate load.

At the discretion of the Contracting Officer, the Purchaser may be required to brand and paint all logs. Any increased costs for log branding and painting shall be the responsibility of the Purchaser.

(b) Road Construction, Renovation, Improvement, Use, and Maintenance

- (1) The Purchaser shall construct Spurs 7A, 11A, 15A, 15C, 15D, 23A, 23B, and Road Nos. 16-1-10.2, 16-1-10.3 Ext., 16-1-11 Ext., 16-1-12.2 Ext., 16-1-14 Ext., 16-1-14.1, 16-1-15.5, 16-1-18; renovate Spur 15B and Road Nos. 16-1-10, 16-1-10.3, 16-1-10.4, 16-1-11, 16-1-12 Segs. E & F, 16-1-12.2, 16-1-13, 16-1-14, 16-1-14.2, 16-1-15, and 16-1-15.1 in strict accordance with the plans and specifications shown on Exhibit C, which is attached hereto and made a part hereof. Exhibit C contains 44 sheets.
- (2) Prior to removal of any timber, except right-of-way timber, the required construction and renovation of the haul route for that timber shall be completed as specified in Exhibit C. The required construction and renovation of roads shall occur between June 1 and October 31, and are subject to dry conditions as determined by the Authorized Officer.
- (3) Culvert replacement/installation on streams shall be done between June 1 and October 31 (both days inclusive), and shall be completed prior to hauling and fall rains. During installation of the stream culverts, dewatering of the culvert bed, silt fences and/or straw bales may be required as directed by the Authorized Officer. All work shall be completed in accordance with the plans and specifications shown in Exhibit C.
- (4) A quarry development plan must be reviewed on site with the contractor for the drilling, blasting, and crushing of the rock for this timber sale before any drilling or blasting shall occur. The plan and location of development shall be agreed upon by the Authorized Officer.
- (5) The Purchaser shall furnish and place 350 cubic yards of surface maintenance rock in accordance with Exhibit D, which is attached hereto and made part hereof. Exhibit D contains 5 sheets. Road reinforcement (rocking) and additional maintenance that may be required for wet weather haul shall be at the Purchaser's expense. Purchaser shall be required to provide to the BLM notice of placement and locations where maintenance rock is placed.
- (6) BLM Maintenance: The Purchaser is authorized to use the roads listed below and shown on Exhibit D, which are under the jurisdiction of the Bureau of Land Management, for the removal of Government timber sold under the terms of this contract, and/or the hauling of rock as required in Exhibits C and D, provided that the Purchaser pay the required maintenance and/or rockwear obligations described in Section 44(b)(9) and Section 44(b)(10). The Purchaser shall pay current Bureau of Land Management maintenance and rockwear fees for the sale of additional timber under modification to the contract.

<u>Road No. and Segment</u>	<u>Length Miles Used</u>	<u>Road Ownership</u>	<u>Road Surface Type</u>
16-1-10 por. 1	.11	BLM	Paved
16-1-10 por. 2	.65	BLM	Rock

- (7) Purchaser Maintenance: The Purchaser is authorized to use the roads listed below and shown on Exhibit D which are under the jurisdiction of the Bureau of Land Management, and/or Weyerhaeuser Timber Holdings, Inc. for the removal of Government timber sold under the terms of this contract and/or the hauling of rock as required in Exhibits C and D, provided that the Purchaser comply with the conditions set forth in Sections 44(b)(8), and pay the required rockwear obligation described in Section 44(b)(10). The Purchaser shall pay current Bureau of Land Management rockwear fees for the sale of additional timber under modification to the contract.

<u>Road No. and Segment</u>	<u>Length Miles Used</u>	<u>Road Ownership</u>	<u>Road Surface Type</u>
Spur 7A	.10	BLM	Natural
Spur 11A	.04	BLM	Natural
Spur 15A	.05	BLM	Natural
Spur 15B	.21	BLM	Natural
Spur 15C	.03	BLM	Natural
Spur 15D	.12	BLM	Natural
Spur 23A	.08	BLM	Rock

Spur 23B	.09	BLM	Natural
16-1-10 por. 3	.77	BLM	Rock
16-1-10.1	2.07	WTHI*	Paved/Rock
16-1-10.2	.17	BLM	Natural
16-1-10.3	.13	BLM	Natural
16-1-10.3 Ext.	.12	BLM	Natural
16-1-10.4	1.65	WTHI*	Rock
16-1-10.5	3.27	WTHI*	Rock
16-1-11	.42	WTHI*	Rock
16-1-11 Ext.	.30	BLM	Rock
16-1-12 Segs A-C	1.05	WTHI*	Rock
16-1-12 Seg. E	.59	WTHI*	Rock
16-1-12 Seg. F	.33	BLM	Rock
16-1-12.2	.59	WTHI*	Rock
16-1-12.2 Ext.	.12	BLM	Rock
16-1-13	.26	WTHI*	Rock
16-1-14	.24	WTHI*	Rock
16-1-14 Ext.	.11	BLM	Rock
16-1-14.1	.21	BLM	Rock
16-1-14.2	.23	WTHI*	Rock
16-1-15	.54	BLM	Rock
16-1-15.1	.69	BLM	Rock
16-1-15.5	.41	BLM	Rock
16-1-18	.24	BLM	Rock

\*WTHI = Weyerhaeuser Timber Holdings, Inc.

- (8) Except for the road maintenance in accordance with Section 44(b)(6), the Purchaser shall perform any required road repair and maintenance work on roads used by them, under the terms of Exhibit D, "Road Maintenance Specifications", of this contract.
- (9) The Purchaser shall pay to the Government a road maintenance obligation in the amount of Three Thousand Three Hundred Forty and 43/100 dollars (\$3,340.43) for the transportation of timber included in the contract price over the roads listed in Section 44(b)(6).

The maintenance fee shall be paid prior to removal of any timber from the contract area; provided, however, that if the total of such amount exceeds One Thousand and 00/100 dollars (\$1,000.00), the Authorized Officer may allow the Purchaser to make the payment in installments of not less than One Thousand and 00/100 dollars (\$1,000.00) in the same manner as and together with payments required in Section 3 of this contract.

- (10) The Purchaser shall pay to the Government a road maintenance obligation for rockwear in the amount of Seven Thousand Three Hundred Twenty-two and 07/100 dollars (\$7,322.07) for the transportation of timber included in the contract price over the roads listed in Section 44(b)(6) and 44(b)(7).

This rockwear fee shall be paid prior to removal of any timber from the contract area; provided, however, that if the total of such amount exceeds One Thousand and 00/100 dollars (\$1,000.00), the Authorized Officer may allow the Purchaser to make the payment in installments of not less than One Thousand and 00/100 dollars (\$1,000.00) in the same manner as and together with payments required in Section 3 of this contract.

- (11) In the construction of Spur 11A, and Road Nos. 16-1-11 Ext., 16-1-12.2 Ext., 16-1-14 Ext., 16-1-14.1, 16-1-18; the renovation, use, and maintenance of Road Nos. 16-1-10.1, 16-1-10.4, 16-1-10.5, 16-1-11, 16-1-12 Segs A, B, C, and E, 16-1-12.2, 16-1-13, 16-1-14; and use of a yarding wedge at the end of Road No. 16-1-14.2., and tailhold and/or guybacks, the Purchaser shall comply with the conditions of Right-of-Way and Road Use Agreement No. E-662 between the United States of America and Weyerhaeuser Timber Holdings, Inc. Prior to the use of said roads, the Purchaser shall furnish the Authorized Officer a copy of the executed License Agreement. Default by the Purchaser of said Right-of-Way and Road Use Agreement, or any License Agreement executed pursuant thereto, for failure to pay appropriate road use fees shall be considered a violation of this contract.

The amount of unpaid fees shall be considered as the amount of damage suffered by the Government as a result of the violation of this provision. Said agreement is available for inspection at the Bureau of Land Management, Springfield Interagency Office, 3106 Pierce Parkway Suite E, Springfield, Oregon. Such conditions include but are not limited to the following actions by the Purchaser:

- (aa) Obtain a license agreement from Weyerhaeuser Timber Holdings, Inc. The license agreement, bond and insurance certificate shall be delivered to Weyerhaeuser Timber Holdings, Inc. at least 15 days prior to use of company roads.
- (bb) Furnish a performance bond in the amount of Ten Thousand and 00/100 dollars (\$10,000.00).
- (cc) Maintain comprehensive liability insurance covering all operations, including vehicles, in amounts not less than One Million and 00/100 dollars (\$1,000,000.00) bodily injury for injury to any one person, One Million and 00/100 dollars (\$1,000,000.00) for any one occurrence, and One Million and 00/100 dollars (\$1,000,000.00) property damage for any one occurrence.
- (dd) Pay a lump sum road use fee of Sixteen Thousand Four Hundred Twenty-five and 00/100 dollars (\$16,425.00) prior to log hauling. Additional road use fees may be due as a result of modification volume to the contract.
- (ee) Pay maintenance fees monthly, for volume hauled the previous month, at the rate per MBF equal to the appropriate BLM fee current at the time of hauling. Such payment to be accompanied by a report of volume hauled as a proration of the volume set forth in Exhibit B of the contract. Total maintenance fees payable shall be the product of the applicable rates and the estimated volume set forth in said Exhibit B and additional volume as sold by contract modification.
- (ff) All rockwear fees due as a result of modification shall be paid at rates current at the time of modification, with payment made prior to contract termination.
- (gg) The Purchaser shall maintain Road Nos. 16-1-10.1, 16-1-10.4, 16-1-10.5, 16-1-11, 16-1-12 Segs A-C and E, 16-1-12.2, 16-1-13, 16-1-14, and 16-1-14.2, in accordance with Section 44(b)(8).
- (hh) Prior to cutting or removing any timber from the road right-of-ways, the Purchaser shall purchase approximately 36 MBF of timber required for the construction of Spur 11A and Road Nos. 16-1-11 Ext., 16-1-12.2 Ext., 16-1-14 Ext., 16-1-14.1, and 16-1-18, according to Weyerhaeuser Timber Holdings, Inc. license agreement specifications.
- (12) With the prior written approval of the Authorized Officer, the Purchaser may arrange for cooperative maintenance with other users on roads included in Section 44(b)(7) of this contract; provided, that such cooperative arrangement shall not relieve the Purchaser of their liability for the maintenance and repair of such roads resulting from wear or damage, in accordance with this contract. Prior to hauling, the Purchaser shall furnish the Authorized Officer a copy of any cooperative maintenance agreement(s) entered into with other users on these roads.
- (13) The Purchaser also agrees that if they elect to use any private road which is the subject of a right-of-way agreement with the Government, for the removal of Government timber sold under the terms of this contract, they shall request and agree to the modification of this contract to provide for such use.

(c) Environmental Protection

- (1) The Purchaser shall be required to clean logging, piling, road, and decommissioning equipment to remove dirt and plant debris that may contain noxious weed seeds from the undercarriage, tracks and tire treads prior to entry on BLM. The Authorized Officer shall require inspection of equipment to see that it was cleaned prior to arrival on site.

- (2) In addition to the requirements set forth in Section 26 of this contract, the Purchaser shall apply native seed and certified weed-free mulch to cut and fill slopes and ditch lines with the potential for sediment delivery to wetlands, Riparian Reserves, floodplains, and waters of the State, as determined by the Authorized Officer. The BLM will provide native seed and mulch as needed.
- (3) Snag Creation
- (aa) Snag creation shall be completed within 90 days upon receiving notification from the Authorized Officer.
  - (bb) Purchaser shall select and top 72 trees and girdle 170 standing trees greater than 20 inch DBH. Location of selected trees shall be in accordance with and approved in writing by the Authorized Officer. Portions of trees topped shall remain reserved.
  - (cc) Purchaser shall top trees at a height between 40 and 60 feet. Trees shall have the top completely severed.
  - (dd) The Purchaser shall girdle the stem of the tree at a height of 2 to 5 feet from the ground line. The Purchaser shall complete three parallel cuts spaced 10 to 12 inches apart around the entire stem of the tree for each girdle. The Purchaser shall make cuts to penetrate into the wood and cambium layer of the tree. Trees selected shall be greater than 20 inch DBH or as directed by the Authorized Officer.
  - (ee) No adjustment of volume or value shall be made to meet these requirements.
  - (ff) The Purchaser shall tally all trees by diameter class and species on a daily basis. The tally may be requested by the Authorized Officer at any time during falling/girdling operations. At the end of falling/girdling operations, a completed tree tally shall be submitted to the Authorized Officer.
- (4) Cable yarding corridors shall be waterbarred and covered with slash immediately after use if necessary to prevent erosion, as determined by the Authorized Officer.
- (5) Upon each season's shutdown and prior to fall rains, the Purchaser shall block skid trails and natural surfaced roads and shall place them in an erosion-resistant condition by constructing waterbars and/or lead-off ditches. Rocked roads on which Exhibit D final maintenance has not been completed, and that have been determined by the Authorized Officer to not be in an erosion-resistant condition shall have waterbars and/or lead-off ditches constructed. Waterbars shall be constructed in accordance with the specifications shown on Exhibit H, which is attached hereto and made a part hereof. Exhibit H contains 2 sheets. Blocking and water bars shall be completed as directed by the Authorized Officer.
- (6) In addition to the requirements set forth in Section 26 of this contract, the Purchaser shall, upon completion of hauling and yarding, complete skid trail and road decommissioning measures. Skid trail and road decommissioning shall be completed during the dry season, typically between June 1 and October 31, as determined by the Authorized Officer.
- (aa) Purchaser shall decompact skid trails, spurs, and roads to a depth of 18 inches with decompaction equipment such as a track mounted excavator with ripping teeth and an opposable thumb. Minimize damage to residual tree roots. The Purchaser shall decompact the entire trail prism. If equipment other than an excavator is used, it shall be approved by the Authorized Officer. It shall also be capable of decompacting to the required depth and provide lateral shatter of compacted layer. The Purchaser shall construct drainage dips, waterbars and/or lead-off ditches as directed by the Authorized Officer. Waterbars and drainage dips shall be constructed in accordance with the specifications shown on Exhibit H.
  - (bb)
  - (cc) Purchaser shall block skid trails and roads with root wads, logs and/or slash as directed by the Authorized Officer.

<b>Roads</b>	<b>Surface</b>	<b>(aa) Decompact</b>	<b>(bb) Drainage</b>	<b>(cc) Block</b>
Skid Trails	Natural	X	X	X
Spur 11A	Natural	X	X	X
Spur 15A	Natural	X	X	
Spur 15B	Natural	X	X	X
Spur 15C	Natural	X	X	X
Spur 15D	Natural		X	X
Spur 23B	Natural	X	X	X
16-1-10.2	Natural	X	X	X
16-1-10.3	Natural	X	X	X
16-1-10.3 Ext.	Natural	X	X	
16-1-14 Ext.	Rock		X	X
16-1-15.5	Rock		X	X

(d) Fire Prevention

- (1) Primarily for purposes of fire prevention and control, the Purchaser shall, prior to the operation of power-driven equipment in construction or logging operations under this contract during fire season or periods of fire danger, prepare a fire prevention and control plan to the satisfaction of the Authorized Officer.

(e) Logging Residue Reduction

- (1) In addition to the requirements of Sections 15 and 26 of this contract, and notwithstanding the Purchaser's satisfactory compliance with State laws and regulations regarding offsetting or abating the additional fire hazard created by this operation and the State's willingness to release the Purchaser from liability for such hazard, the Purchaser shall remain responsible to the Government for performance of the following logging residue reduction and/or site preparation measures required by this contract: Perform logging residue reduction and site preparation work on approximately One hundred and six (106) acres of Harvest Areas. Slash, as defined for this section, shall mean all material (brush, limbs, tops, unmerchantable stems, and chunks) severed or knocked over as a result of purchaser's operations under the terms of this contract.
- (aa) Prior to commencement of any logging residue reduction and/or site preparation, a pre-work conference between the Purchaser's representative and the Authorized Officer must be held at a location designated by the Authorized Officer. All logging residue reduction and/or site preparation shall be done in accordance with the plans developed at the pre-work conference.
- (bb) Lop and Scatter slash within thirty (30) acres of the Regeneration Harvest Areas as directed by the Authorized Officer. All top and side branches must be cut free of the central stem so that such stem is reduced to the extent that it is within twelve (12) inches of the ground at all points. All logging slash and slashed woody vegetation that is greater than six (6) feet in length and between one (1) inch and six (6) inches in diameter shall be lopped and scattered. Larger material which has a portion meeting this specification must be bucked at the six (6) inch diameter.
- (cc) Machine pile and cover slash within ground based harvested portions of the Regeneration Harvest Areas as directed by the Authorized Officer. Slash shall be piled by a machine equipped with a hydraulic thumb or a controllable, grapple head. If the purchaser elects to cable yard areas that were planned for ground-based harvest (areas less than 35% slope) and the slash exceeds 6 inches in depth, piling will be required as directed by the Authorized Officer.
- (1) Unmerchantable logs greater than six (6) inches on the small end shall be left in place or positioned so that they will not be burned.



- (2) Machine piles shall be located as far as possible from reserve trees, culverts, or unit boundaries to minimize damage.
  - (3) Machine piles shall be kept free of dirt and other non-woody debris and constructed as compactly as possible. There should be an adequate supply of finer fuels located within and under the covered area of the pile to ensure ignition of the larger fuels. Slash left on the ground shall not exceed 6 inches in depth.
  - (4) All piles shall be covered with black six (6) Mil polyethylene plastic to cover at least fifty (50) percent of the surface of each pile, minimum plastic size of 10' x 10' cover. Plastic shall be held in place with woody debris and tied with combustible cord. The plastic must be secured so that it is held in place during strong wind conditions and maintains coverage for at least one year. The Purchaser is required to furnish the covering materials. Covering shall be completed at the time of piling or as directed by the Authorized Officer.
  - (5) Harvest Areas shall be piled during the same season that they are logged, unless otherwise directed by the Authorized Officer.
- (dd) Pile and cover landing slash and slash within twenty-five (25) feet of all roads within or adjacent to the harvest units. All tops, broken pieces, limbs and debris more than two (2) inches in diameter at the large end and longer than three (3) feet in length shall be piled within fifteen (15) days of completion of hauling logs from that landing. Landing piles shall be kept free of dirt and located at least twenty (20) feet from any reserve tree and/or as directed by the Authorized Officer.
- (1) All logs greater than six (6) inches in diameter at the large end and longer than eight (8) feet in length shall be decked or windrowed at the location designated by the Authorized Officer, except logs sold and removed from the contract area.
  - (2) Upon completion of landing and roadside piling, the Purchaser shall prepare the piles for burning by securely covering each pile with black six (6) Mil polyethylene plastic. Landing and roadside piles shall be at least fifty (50) percent covered with the covering extending three-quarters of the way down all sides, minimum plastic size of 10' x 10'. There should be an adequate supply of finer fuels located within and under the covered area of the pile to ensure ignition of the larger fuels. Plastic shall be held in place with woody debris and tied with combustible cord. The plastic must be secured so that it is held in place during strong wind conditions and maintains coverage for at least one year. The Purchaser is required to furnish the covering materials. The timing of this covering work shall be in accordance with instructions from the Authorized Officer. If the structure of the landing piles will not permit adequate consumption of piled debris by burning, the Purchaser shall re-pile them at the direction of the Authorized Officer.
- (2) Notwithstanding the provisions of Sec. 15 of this contract, the Government shall assume all obligations for disposal or reduction of fire hazards created by Purchaser's operations on Government lands, except for burning and mop-up assistance as required herein, and measures required in Section 44(e).  
In accordance with written instruction to be issued by the Authorized Officer at least 10 days in advance of the earliest date of required performance, the Purchaser shall, under supervision of the Authorized Officer or designated representative, assist in preparing units for burning, burning, mop-up, and patrol by furnishing, at the Purchaser's own expense, the services of personnel and equipment on harvest area as shown below:
- (aa) For Igniting, Holding, and Mop-Up of Piles:
    - (1) One (1) work leader (Firefighter Type 1 (FFT1)) to supervise crew and equipment operations, and to serve as Purchaser's representative.
    - (2) Two (2) person crew (Firefighter Type 2 (FFT2)).

- (3) Sufficient fuel for burning, five (5) drip torches or propane burners, one (1) power saw, and one (1) backpack pump, one (1) tool for each crew member.
- (4) Radios capable of inter-crew communications and communication with a BLM representative at a ratio of one (1) radio per every five (5) crew members.
- (5) All ignition, holding, and mop-up personnel will be directly supervised by a BLM representative.

Aircraft and pilots used for Logging Residue Reduction or the suppression of escaped fires from Logging Residue Reduction operations, shall be acquired from a list of aircraft and pilots approved (i.e., carded for these specific activities) by the Office of Aircraft Services or the U.S. Forest Service. This list is available from BLM District Offices upon request.

All listed personnel shall be physically fit, experienced, and fully capable of functioning as required. In addition, all listed personnel shall be qualified according to the National Wildfire Coordinating Group (NWCG) Wildland Fire Qualification System Guide, PMS-310-1 and provide documentation of these qualifications. On the day of ignition all listed personnel shall be fluent in speaking and understanding English, clothing shall consist of long pants and long sleeved shirts and be of approved aramid fabric (Nomex™ or equivalent), as well as being free of diesel fuel oil. All personnel shall wear boots with minimum eight (8) inch tall uppers that provide ankle support, approved hardhats, and leather gloves. Personnel who do not meet these requirements or do not have proper clothing and personal protective equipment (PPE) will not be allowed to participate. All listed tools and equipment shall be in good usable condition. All power-driven equipment shall be fully fueled and available for immediate use. During periods of use under this subsection, the Purchaser shall provide fuel and maintenance for all such power-driven equipment.

Except as provided hereafter for fire escapement, the Purchaser shall continue the required assistance in mop up on each cutting unit shown on Exhibit A for seventy-two (72) hours, as directed by the Authorized Officer within a five (5) day period commencing at 8:00 a.m. the day following the completion of ignition in that unit, or until released from such service by the Government, whichever occurs first.

In event of a fire escapement, the Purchaser's personnel and equipment shall, under supervision of the Authorized Officer, take action to control and mop up the escaped fire until released from such service by the Government. If it becomes necessary to use furnished personnel and equipment for the suppression of a fire which escapes from the prescribed fire area for a period beyond the remainder of the day in which the fire escapes, then the Government shall, at its option: (1) reimburse the Purchaser for such additional use of personnel and equipment at wage rates shown in the current Administratively Determined Pay Rates for the Western Area and at equipment rates shown in the current Oregon-Washington Interagency Fire Fighting Equipment Rental Rates schedule until the Purchaser is released from such service by the Government; or (2) release the Purchaser from additional suppression work and assume responsibility for suppressing the escaped fire.

In situations where an escaped fire is controlled and contained by an adequate fire break (i.e., trail, road, stream, rock formation, etc.), the Government may permit the Purchaser to remove personnel for that day; provided that all mop up work on the escaped fire is included with mop up work on the prescribed fire area. In such an event, the Purchaser must sign a statement of agreement to complete mop up work on all escaped fire areas concurrently with mop up work on the prescribed fire area.

In case of injury to personnel or damage to equipment furnished as required by this subsection, liability shall be borne by the Purchaser, unless such injury or damage is caused by Government negligence.

Time is of the essence in complying with this provision. In the event the Purchaser fails to provide the personnel and equipment required herein, the Purchaser shall be responsible for all additional cost incurred by the Government in disposing of slash including but not limited to the wages and other costs of providing federal employees and others as substitute labor force, the cost of providing substitute equipment and appropriate additional overhead expenses. If the Purchaser's failure results in a deferral of burning and new conditions necessitate additional personnel and equipment to accomplish the planned burn, the Purchaser also shall be responsible for such additional costs.



**United States  
Department of the Interior  
Bureau of Land Management**

**Timber Appraisal**

---

<b>Sale Name:</b>	Ghost Town	<b>Sale Date:</b>	Thursday, August 24, 2023
<b>BLM District:</b>	NW Oregon DO	<b>Unit of Measure:</b>	16' MBF
<b>Contract #:</b>	ORN05-TS-2023.0555	<b>Contract Term:</b>	36 months
<b>Sale Type:</b>	Advertised	<b>Contract Mechanism:</b>	5450-003
		Lump Sum Sale of Timber and other Wood Products	

---

**Content**

**Timber Appraisal Summary**  
**Stumpage Summary**  
**Unit Summary**  
**Stump to Truck**  
**Transportation**  
**Engineering Allowances**  
**Other Allowances**

**Prepared By:** Cranmer, Kyle M - 7/19/2023

**Approved By:** Coppersmith, Jason H - 7/20/2023

## Legal Description of Contract Area

Land Status	County	Township	Range	Section	Subdivision	Meridian
O&C	Lane	16S	1E	7	Lot 4	Willamette
O&C	Lane	16S	1W	11	SW1/4SW1/4, SE1/4SE1/4,	Willamette
O&C	Lane	16S	1W	15	SE1/4NE1/4, S1/2NW1/4, N1/2SW1/4, NE1/4SE1/4, S1/2SE1/4	Willamette
O&C	Lane	16S	1W	23	N1/2NW1/4, SW1/4NW1/4	Willamette

## Species Totals

Species	Net	Gross Merch	Gross	# of Merch Logs	# of Cull Logs	# of Trees
Douglas Fir	10,214.0	10,604.0	10,680.0	136,506	1,042	27,587
Western Hemlock	68.0	71.0	76.0	1,766	279	558
Bigleaf Maple	12.0	12.0	12.0	420	0	138
<b>Totals</b>	<b>10,294.0</b>	<b>10,687.0</b>	<b>10,768.0</b>	<b>138,692</b>	<b>1,321</b>	<b>28,283</b>

## Cutting Area Acres

Regeneration Harvest Acres	Partial Cut Acres	Right of Way Acres	Total Acres	Net Volume per Acre
172.0	49.0	9.2	230.2	44.7

**Logging Costs**

Stump to Truck	\$1,770,328.65
Transportation	\$705,342.00
Road Construction	\$510,172.95
Maintenance/Rockwear	\$43,644.56
Road Use	\$16,425.00
Other Allowances	\$63,947.15
<b>Total:</b>	<b>\$3,109,860.31</b>
<b>Total Logging Cost per MBF:</b>	<b>\$302.10</b>

**Utilization Centers**

<b>Location</b>	<b>Distance</b>	<b>% of Net Volume</b>
Eugene/Springfield	28.0 miles	100 %

**Profit & Risk**

Profit	11 %
Risk	1 %
<b>Total Profit &amp; Risk</b>	<b>12 %</b>

**Tract Features**

<b>Quadratic Mean DBH</b>	15.8 in
<b>Average GM Log</b>	77 bf
<b>Average Volume per Acre</b>	44.7 mbf
<b>Recovery</b>	96 %
<b><u>Net MBF volume:</u></b>	
<b>Green</b>	10,294.0 mbf
<b>Salvage</b>	0 mbf
<b>Export</b>	0 mbf
<b><u>Ground Base Logging:</u></b>	
<b>Percent of Sale Volume</b>	33 %
<b>Average Yarding Slope</b>	15 %
<b>Average Yarding Distance</b>	210 ft
<b><u>Cable Logging:</u></b>	
<b>Percent of Sale Volume</b>	67 %
<b>Average Yarding Slope</b>	55 %
<b>Average Yarding Distance</b>	405 ft
<b><u>Aerial Logging:</u></b>	
<b>Percent of Sale Volume</b>	0 %
<b>Average Yarding Slope</b>	0 %
<b>Average Yarding Distance</b>	0 ft

## **Cruise**

**Cruise  
Completed**

April 2023

**Cruised By**

K. Cranmer, B. Dotson, A.  
Maynard

### **Cruise Method**

The timber volumes for Douglas-fir and western hemlock in the Regeneration Harvest Areas and Partial Harvest Area were based on a variable plot cruise for estimating board foot volume. Plots were measured using a 40 basal area factor for a total of 210 plots. Bigleaf maple in all Regeneration Harvest Areas were based on a 100% cruise for estimating board foot volume. The timber volumes for Douglas-fir in the right-of-ways were based on a 3P cruise for estimating board foot volume. A map showing the location of the plots and sample trees is available at the Springfield Interagency Office. With respect to merchantable Douglas-fir (sample) trees; the average tree is 15.9" DBHOB; the average log contains 78 bd. ft.; the total gross merchantable volume is approximately 10,604 MBF; and 96% recovery is expected.

## Stumpage Computation

Species	# of Trees	Net Volume	Pond Value	(-) Profit & Risk	(-) Logging Costs	(+) Marginal Log Value	Appraised Price/MBF	Appraised Value (\$)
Douglas Fir	27,587	10,214.0	\$705.53	\$84.66	\$302.10	\$0.00	\$318.80	\$3,256,223.20
Western Hemlock	558	68.0	\$434.89	\$52.19	\$302.10	\$0.00	\$80.60	\$5,480.80
Bigleaf Maple	138	12.0	\$291.66	\$35.00	\$302.10	\$0.00	\$29.20 *	\$350.40
<b>Totals</b>	<b>28,283</b>	<b>10,294.0</b>						<b>\$3,262,054.40</b>

\* Minimum Stumpage values were used to compute the Appraised Price/MBF (10 % of Pond Value)

## Percent of Volume By Log Grade

Species	No. 1 & 2 Peeler	No. 3 Peeler	Special Mill	No. 2 Sawmill	No. 3 Sawmill	No. 4 Sawmill	Camp Run
Douglas Fir				63.0 %	33.0 %	4.0 %	

Species	Peeler	No. 1 Sawmill	Special Mill	No. 2 Sawmill	No. 3 Sawmill	No. 4 Sawmill	Camp Run
Western Hemlock				13.0 %	80.0 %	7.0 %	

Species	No. 1 Sawmill	No. 2 Sawmill	No. 3 Sawmill	No. 4 Sawmill	No. 5 Sawmill		Camp Run
Bigleaf Maple							100.0 %



**Ghost Town****Unit Summary****ORN05-TS-2023.0555****Unit: PH-3**

Species	Net	Gross Merch	Gross	# of Trees
Douglas Fir	697.0	734.0	734.0	5,523
Western Hemlock	14.0	16.0	16.0	70
<b>Totals:</b>	<b>711.0</b>	<b>750.0</b>	<b>750.0</b>	<b>5,593</b>

**Net Volume/Acre: 14.5 MBF**

Regeneration Harvest	0.0
Partial Cut	49.0
Right of Way	0.0
<b>Total Acres:</b>	<b>49.0</b>

**Unit: RH-1**

Species	Net	Gross Merch	Gross	# of Trees
Douglas Fir	1,139.0	1,182.0	1,191.0	2,637
Western Hemlock	6.0	7.0	7.0	60
<b>Totals:</b>	<b>1,145.0</b>	<b>1,189.0</b>	<b>1,198.0</b>	<b>2,697</b>

**Net Volume/Acre: 54.5 MBF**

Regeneration Harvest	21.0
Partial Cut	0.0
Right of Way	0.0
<b>Total Acres:</b>	<b>21.0</b>

**Unit: RH-2**

Species	Net	Gross Merch	Gross	# of Trees
Douglas Fir	1,682.0	1,744.0	1,758.0	3,893
Western Hemlock	10.0	10.0	11.0	88
<b>Totals:</b>	<b>1,692.0</b>	<b>1,754.0</b>	<b>1,769.0</b>	<b>3,981</b>

**Net Volume/Acre: 54.6 MBF**

Regeneration Harvest	31.0
Partial Cut	0.0
Right of Way	0.0
<b>Total Acres:</b>	<b>31.0</b>

**Unit: RH-3**

Species	Net	Gross Merch	Gross	# of Trees
Douglas Fir	3,255.0	3,376.0	3,402.0	7,535
Western Hemlock	19.0	19.0	21.0	170
<b>Totals:</b>	<b>3,274.0</b>	<b>3,395.0</b>	<b>3,423.0</b>	<b>7,705</b>

**Net Volume/Acre: 54.6 MBF**

Regeneration Harvest	60.0
Partial Cut	0.0
Right of Way	0.0
<b>Total Acres:</b>	<b>60.0</b>

**Unit: RH-4**

Species	Net	Gross Merch	Gross	# of Trees
Douglas Fir	3,255.0	3,376.0	3,402.0	7,535
Western Hemlock	19.0	19.0	21.0	170
Bigleaf Maple	12.0	12.0	12.0	138
<b>Totals:</b>	<b>3,286.0</b>	<b>3,407.0</b>	<b>3,435.0</b>	<b>7,843</b>

**Net Volume/Acre: 54.8 MBF**

Regeneration Harvest	60.0
Partial Cut	0.0
Right of Way	0.0
<b>Total Acres:</b>	<b>60.0</b>

**Unit: ROW-1**

Species	Net	Gross Merch	Gross	# of Trees
Douglas Fir	11.0	11.0	12.0	22
<b>Totals:</b>	<b>11.0</b>	<b>11.0</b>	<b>12.0</b>	<b>22</b>

**Net Volume/Acre: 7.3 MBF**

Regeneration Harvest	0.0
Partial Cut	0.0
Right of Way	1.5
<b>Total Acres:</b>	<b>1.5</b>

**Unit: ROW-2**

Species	Net	Gross Merch	Gross	# of Trees
Douglas Fir	81.0	84.0	84.0	149
<b>Totals:</b>	<b>81.0</b>	<b>84.0</b>	<b>84.0</b>	<b>149</b>

**Net Volume/Acre: 47.6 MBF**

Regeneration Harvest	0.0
Partial Cut	0.0
Right of Way	1.7
<b>Total Acres:</b>	<b>1.7</b>

**Unit: ROW-3**

Species	Net	Gross Merch	Gross	# of Trees
Douglas Fir	69.0	71.0	71.0	224
<b>Totals:</b>	<b>69.0</b>	<b>71.0</b>	<b>71.0</b>	<b>224</b>

**Net Volume/Acre: 12.8 MBF**

Regeneration Harvest	0.0
Partial Cut	0.0
Right of Way	5.4
<b>Total Acres:</b>	<b>5.4</b>

**Unit: ROW-4**

Species	Net	Gross Merch	Gross	# of Trees
Douglas Fir	25.0	26.0	26.0	69
<b>Totals:</b>	<b>25.0</b>	<b>26.0</b>	<b>26.0</b>	<b>69</b>

**Net Volume/Acre: 41.7 MBF**

Regeneration Harvest	0.0
Partial Cut	0.0
Right of Way	0.6
<b>Total Acres:</b>	<b>0.6</b>

Total Stump To Truck	Net Volume	\$/MBF
\$1,770,328.65	10,294.0	\$171.98

## Stump to Truck: Falling, Bucking, Yarding, &amp; Loading

Yarding System	Unit of Measure	# of Units of Measure	\$/Unit of Measure	Total Cost	Remarks
Cable: Medium Yarder	GM MBF	397.0	\$339.22	\$134,670.34	Cable: Medium Yarder PH- \$4.40/gal, 5mbf/load, 4 lds/day
Wheel Skidder	GM MBF	353.0	\$226.22	\$79,855.66	Wheel Skid Ground PH- \$4.40/gal, 5mbf/load, 5 lds/day
Cable: Medium Yarder	GM MBF	1,263.0	\$193.84	\$244,819.92	Cable: Medium Yarder RH Dead Ground \$4.40/gal, 5mbf/ld, 7 lds/day
Cable: Medium Yarder	GM MBF	5,491.0	\$169.61	\$931,328.51	Cable: RH- \$4.40/gal, 5mbf/ld, 8 lds/day
Shovel	GM MBF	192.0	\$144.67	\$27,776.64	Shovel ROW ROW- \$4.40/gal, 5mbf, 5 lds/day
Shovel	GM MBF	25.0	\$144.67	\$3,616.75	Shovel Riparian Reserve ROW's- \$4.40/gal, 5mbf, 5 lds/day
Shovel	GM MBF	37.0	\$144.67	\$5,352.79	SHovel Private ROW- \$4.40/gal, 5mbf, 5 lds/day
Shovel	GM MBF	2,991.0	\$112.44	\$336,308.04	Shovel Ground RH- \$4.40/gal, 5mbf/ld, 12 lds/day
<b>Subtotal</b>				<b>\$1,763,728.65</b>	

## Additional Costs

Item	Unit of Measure	# of Units of Measure	\$/Unit of Measure	Total Cost	Remarks
Intermediate Support	Each	22.0	\$300.00	\$6,600.00	\$300 per support
<b>Subtotal</b>				<b>\$6,600.00</b>	

### Additional Moves

Equipment	Unit of Measure	# of Units of Measure	\$/Unit of Measure	Total Cost	Remarks
Subtotal				\$0.00	

**Comments:**

Cable: Medium Yarder PH- \$4.40/gal, 5mbf/load, 4 lds/day  
Shovel Ground PH- \$4.40/gal, 5mbf/load, 5 lds/day  
Cable: Medium Yarder RH- \$4.40/gal, 5mbf/lb, 8 lds/day  
Shovel Ground RH- \$4.40/gal, 5mbf/lb, 12 lds/day  
Shovel ROW ROW- \$4.40/gal, 5mbf, 5 lds/day  
Shovel Private ROW- \$4.40/gal, 5mbf, 5 lds/day  
Shovel Riparian Reserve ROW's- \$4.40/gal, 5mbf, 5 lds/day  
Cable: Medium Yarder RH Dead Ground \$4.40/gal, 5mbf/lb, 7 lds/day  
Additional Supports for long corridors and laterals

Total	Net Volume	\$/MBF
\$705,342.00	10,294.0	\$68.52

Utilization Center	One Way Mileage	Description	Unit of Measure	# of Units	\$/Unit of Measure	Total Cost	% of Sale Volume
Eugene/Springfield	28.0	Log Haul	GM MBF	10,687.0	\$66.00	\$705,342.00	100 %

**Comments:**

\$110/hr x (2 hour + 1 hour delay at the yard) 3 hours round trip = \$330.00 divided by 5 mbf/load = \$66.00/GM mbf

**Engineering Allowances**

Total	Net Volume	\$/MBF
\$570,242.51	10,294.0	\$55.40

Cost Item	Total Cost
Road Construction:	\$510,172.95
Road Maintenance/Rockwear:	\$43,644.56
Road Use Fees:	\$16,425.00

**Comments:**

Road Construction see Ex C

Road Maint/Rockwear see Ex D

Road Use see Ex D

Total	Net Volume	\$/MBF
\$63,947.15	10,294.0	\$6.21

**Environmental Protection**

Cost item	Total Cost
Snag Creation Base Girdle	\$4,760.00
Snag Creation Topped	\$5,400.00
Equipment Washing	\$800.00
10% Admin Fee for Snags	\$1,016.00
<b>Subtotal</b>	<b>\$11,976.00</b>

**Fire Prevention & Control**

Cost item	Total Cost
Slash Disposal	\$44,100.00
<b>Subtotal</b>	<b>\$44,100.00</b>

**Logging**

Cost item	Total Cost
Cutting of Unmerchantable Timber	\$1,750.00
Skid Rd Decomm	\$2,768.00
<b>Subtotal</b>	<b>\$4,518.00</b>

**Road Construction, Maintenance, Use, & Decommissioning**

Cost item	Total Cost
Road Decomm	\$3,353.15
<b>Subtotal</b>	<b>\$3,353.15</b>

**Comments:**

Skid Road Decomm see appraisal sheet  
 Equipment washing see appraisal sheet  
 CWD see appraisal sheet  
 Slash disposal see Fuels appraisal  
 Cutting of Unmerch- See TSS Stips