



CALIFORNIA King Range

National Conservation Area

Recreation Fee Program Spending & Accomplishment Highlights 2022

Vault Toilet Pumping

Landscaping and Maintenance



Mattole Campground and Day Use Area



NCLS Monument at Black Sands Beach

Recreation fees collected in the King Range National Conservation Area (KRNCA) fund vault toilet pumping services for 8 bathrooms at four campgrounds and one high use day use area. Total visitation to these sites in 2022 was 129,280 visits.

The day use sites in the KRNCA consist of coastal bluffs that stretch along the coastline, displaying magnificent views of the Pacific Ocean. Recreation fees are used to contract janitorial services, such as: mow grass at the recreation sites, clean and stock the restrooms twice per week (spring/summer/fall), remove trash from the trash receptacles, and light maintenance, such as painting and repairing fence.

Amount Expended: \$8,820.00

Amount Expended: \$46,928.08

Recreation Fee Dollars

Recreation fee dollars are an investment in outdoor recreation. Current and future generations benefit as 100% of the funds collected are reinvested in the facilities and services that visitors enjoy, use, and value.

They support and enhance:

- Maintenance, repair, and facility enhancement related directly to visitor enjoyment, visitor access, and health and safety
- Interpretation, visitor information, visitor service, visitor needs assessments, and signs
- Habitat restoration directly related to wildlife- dependent recreation that is limited to hunting, fishing, wildlife observation, or photography
- Law enforcement related to public use and recreation
- Direct operating or capital costs associated with the recreation fee program



Other Accomplishments

BLM staff maintained front country day use and comping by contracting landscaping, trash removal and janitorial services.

Volunteers, students, and youth corps maintained two native plant gardens at Mal Coombs Park and Black Sands Beach.

Middle school students from Whale Gulch School installed 53 new bricks into the NCLS Monument, while studying public lands.

The King Range Alliance "Trailhead Hosts" provided vital information to front country visitors including ocean safety.

The King Range maintenance crew removed and replaced 4 weathered picnic tables at Mal Coombs Day Use Area.

Vicinity Map



Contacts

King Range National Conservation Area

Recreation Fee Program Contact

Phone Number: 707-986-5400

Email: BLM_CA_Web_KR@blm.gov

Web: <https://www.blm.gov/programs/national-conservation-lands/california/king-range-national-conservation-area>

[Published FLREA Triennial Report](https://doi.sciencebase.gov/flrea/)

<https://doi.sciencebase.gov/flrea/>

[Published FLREA Annual Revenue and Spending Plans](https://www.blm.gov/programs/recreation/permits-and-fees/flrea-revenue)

<https://www.blm.gov/programs/recreation/permits-and-fees/flrea-revenue>

[Connecting with Communities BLM Recreation Strategy](https://www.blm.gov/national-office/public-room/strategic-plan/connecting-communities-blm-recreation-strategy-summary)

<https://www.blm.gov/national-office/public-room/strategic-plan/connecting-communities-blm-recreation-strategy-summary>

Revenue & Expenditures

End of Year Carryover:	\$92,164.17
FY22 Revenue	
Recreation Use Permits (RUPs)	\$30,237.70
Special Recreation Permits (SRPs)	\$12,970.75
Individual Special Recreation Permits	\$0.00
Interagency Passes	\$80.00
Total Recreation Fee Revenue for FY22:	\$43,288.45

FY22 Expenditures	
Repair & Maintenance	\$54,598.09
Visitor Services	\$600.00
Law Enforcement	\$0.00
Habitat Restoration	\$547.99
Collections/Overhead	\$0.00
Total Recreation Fee Expenditures for FY22:	\$55,746.08



Planned Activities

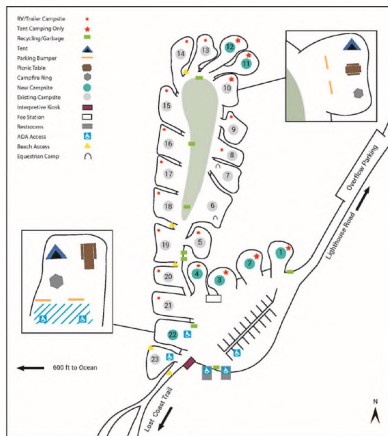

Mattole Campground Design Plan

Mattole Beach Campground Expansion Project

The Mattole Beach Campground will be expanded by eight campsites and 20 long-term parking spaces by the end of FY 2023, which will bring in additional revenue starting in FY2023. Infrastructure used for both day use and camping will be replaced, such as fire pits, picnic tables, directional signage, and trash bins.

New kiosks in the King Range frontcountry will be constructed and newly printed signage will contain important ocean safety, Leave No Trace and interpretive/educational information.

An updated business plan for collections and expenditures in the King Range will be completed in the next couple years, assisting in the future direction of fee collection and expenditures.

FY23 Planned Expenditures

Repair & Maintenance	\$55,000.00
Visitor Services	\$1,000.00
Law Enforcement	\$0.00
Habitat Restoration	\$0.00
Collections/Overhead	\$0.00
Total Recreation Fee Expenditures for FY23:	\$56,000.00
Carryover Funds To FY23:	\$79,706.54
FY23 Projected Revenue:	\$45,000.00

Connecting with Communities

The King Range National Conservation Area works closely with the King Range Alliance (KRA), a collaboration of local agencies working together to assist in public land management and interpretation. The collaboration consists of: Friends of the Lost Coast, Mattole Restoration Council, Sanctuary Forest, and the Mattole Salmon Group. With support from BLM and the Conservation Lands Foundation, the “Trail Stewards” and the “Trailhead Host” KRA programs are now in their third year. The Trail Stewards are local community volunteers who maintain trails in the King Range frontcountry. Trailhead Hosts are volunteers who stage themselves at trailheads on peak-season weekends to engage with visitors, ensuring they receive pertinent information regarding ocean safety, backpacking stipulations, Leave No Trace principles, tide predictions, and more.

The BLM Artist in Residence program at the King Range hosts two, 4-week sessions in the King Range in close collaboration with the Shelter Cove Arts and Recreation Foundation. Local community members have been receptive, supportive, and excited to participate in workshops and gallery shows that the residency has brought to the rural area.

