

Year: 2018

Inventory Unit Number/Name: OR-015-028A/ Dog Leg South

FORM 1

DOCUMENTATION OF BLM WILDERNESS INVENTORY FINDINGS ON RECORD

1. Is there existing BLM wilderness inventory information on all or part of this area?

No Yes (if more than one unit is within the area, list the names/numbers of those units):

a) **Inventory Source:** BLM Wilderness Inventory files for Pacific Power and Light Company (PP&L) Transmission Line: PP&L Roadless Area Inventory Files (1977).

b) **Inventory Unit Number(s)/Name(s):** OR-010-01-7 (1-28)/ Dog Leg

c) **Map Name(s)/Number(s):** Wilderness Review – Initial Inventory: Final Decision on Public Lands Obviously Lacking Wilderness Characteristics and Announcement of Public Lands to be Intensively Inventoried for Wilderness Characteristics; USDI BLM - Oregon and Washington, August 1979.

d) **BLM District(s)/Field Office(s):** Lakeview District, Lakeview Resource Area.

2. BLM Inventory Findings on Record:

Existing inventory information regarding wilderness characteristics (if more than one BLM inventory unit is associated with the area, list each unit and answer each question individually for each inventory unit):

Unit #	Size (historic acres)	Natural Condition? Y/N	Outstanding Solitude? Y/N	Outstanding Primitive & Unconfined Recreation? Y/N	Supplemental Values? Y/N
1-28	7,700	N	N	N	N/A
1-28A*	6,209	N	NA	NA	N/A

*The inventory of this unit was updated in 2012. However, due to a State Office-sponsored Wilderness Inventory Consistency Evaluation and subsequent guidance, the 2012 inventory analysis and findings are being replaced by this current 2018 inventory review. Documentation of the 2012 inventory can be found in the wilderness inventory project record.

Summarize any known primary reasons for prior inventory findings listed in this table:

In 1977/78 historic Unit 1-28 was described as flat to gently rolling, broken by a few low rims. Vegetation consisted of desert shrubs and crested wheatgrass in the south. Internal intrusions to naturalness included a seeding in the south and a couple of “ways.” External intrusions included a gravel county road to the north, a large power line to the west. Both of which could be seen from most of the area. No opportunities for solitude were identified. Low quality antelope hunting, hiking, and horseback riding were listed possible, but not outstanding recreation opportunities.

FORM 2

**DOCUMENTATION OF CURRENT WILDERNESS INVENTORY
CONDITIONS**

Unit Number/Name: OR-015-028A/ Dog Leg South

(1) Is the unit of sufficient size? Yes No

Between 2007 and 2016, BLM staff conducted field inventory in the area as part of a process to update its road and wilderness inventories and to gather additional information to supplement ONDA’s wilderness information. This fieldwork included photo documentation of the boundary and interior routes and a re-evaluation of wilderness characteristics for this area. Using both ONDA and BLM photos, field logs, and staff field knowledge, the BLM completed route analysis within the area in 2017.

The BLM determined that the inventory unit is bounded by BLM road 6164-D0 to the east; 7154-00 to the south and west; and a right-of-way for a Bonneville Power Administration power line to the north. Due to changes in boundary determinations (roads and power line rights-of-ways buffer corrections) and cut-outs of unnatural features (pipelines), approximately 41 acres were added to the unit.

Thus, based on these boundary and road determinations, the BLM found the Dog Leg South inventory unit to exceed the minimum size criteria at approximately 6,250 acres of BLM-administered lands.

Additional background on the process the BLM followed during this evaluation is contained in the document, *Wilderness Inventory Maintenance Process for the Lakeview Resource Area, BLM* and in the *Route Analysis Forms*. Both documents can be found in the wilderness inventory file.

DESCRIPTION OF CURRENT CONDITIONS:

This unit is located approximately 16 miles northwest of Alkali Lake, Oregon. It is approximately 4.5 miles long by 2 miles wide. Topographically, the unit consists mostly of minor rolling hills (25-100 ft. high) and rims (25-75 ft. high) along the eastern and western

boundaries. Overall, the unit ranges in elevation from 4,450 to 4,703 feet. Vegetation is comprised of sagebrush and grasses.

(2) Is the unit in a natural condition? Yes No N/A

In 1977/78, historic Unit 1-28 was found to be in an unnatural state due primarily to outside influences. Internal impacts included a seeding in the south and a couple of “ways.” External intrusions included a gravel county road to the north, a large power line to the west. Both of which could be seen from most of the area.

The unit currently contains the following man-made developments/disturbances: 627 acres of wildfire, 324 acres of chemical treatments, 324 acres of seeding, 5 miles of fence, 4 miles of reclaiming routes, 1.25 miles of motorized routes, and 1 waterhole.

Presently, almost 4 decades after the original inventory, these developments are weathered and grown over with herbaceous grasses and sagebrush. As a result, developments now fade into the background of the unit and are largely only noticeable at a close distance (1/4th mile or less) and are thus substantially unnoticeable from further distances. Furthermore, many of the disturbances are located near the perimeter of the unit and, as such, have a small area of influence. Additionally, areas that were seeded or allowed to revegetate naturally have returned to a natural, post fire, appearing condition

Based on a review of all the available information including photos, staff knowledge, and field review, the BLM concluded that the unit appears in a natural condition where the imprints of man are substantially unnoticeable.

(3) Does the unit (or the remainder of the unit if a portion has been excluded due to unnaturalness and the remainder is of sufficient size) **have outstanding opportunities for solitude?** Yes No N/A

In 1977/78, historic Unit 1-28 was found to lack outstanding opportunities for solitude.

The BLM acknowledges that there are limited opportunities for solitude within the Dog Leg South inventory unit. Topographically, the unit consists mostly of minor rolling hills (25-100 ft. high) and rims (25-75 ft. high) along the eastern and western boundaries. Overall, the unit ranges in elevation from 4,450 to 4,703 feet. Vegetation is comprised of sagebrush and grasses. These opportunities are less than outstanding as the area’s characteristic landscape lacks vegetative screening and existing topographic screening is insufficient to effectively allow those recreating in the area to avoid the sights and sounds of others.

Thus, for the reasons specified above and based on a review of all the available information including (BLM and citizen provided) photos, staff knowledge, and field review, the BLM concluded the Dog Leg South inventory unit does not possess outstanding opportunities for solitude.

(4) Does the unit (or the remainder of the unit if a portion has been excluded due to unnaturalness and the remainder is of sufficient size) **have outstanding opportunities for primitive and unconfined recreation?** Yes _____ No X N/A _____

In 1977/78, historic Unit 1-28 was found to possess low quality antelope hunting, hiking, and horseback riding, but otherwise lacked outstanding primitive recreation opportunities.

The BLM finds the unit offers limited opportunities for hiking, horseback riding, backpacking, camping, wildlife observation, exploration, scenery, photography, stargazing, trapping, and hunting. However, the BLM determined that the unit does not possess outstanding opportunities for primitive and unconfined recreation through either the diversity of recreational activities possible in the area or by the outstanding quality of one opportunity relative to opportunities found within the Lakeview Resource Area.

(5) Does the unit have supplemental values? Yes _____ No _____ N/A X

Supplemental values were not evaluated as the unit was determined to lack both outstanding opportunities for solitude and or primitive and unconfined recreation, and therefore does not meet the minimum wilderness criteria.

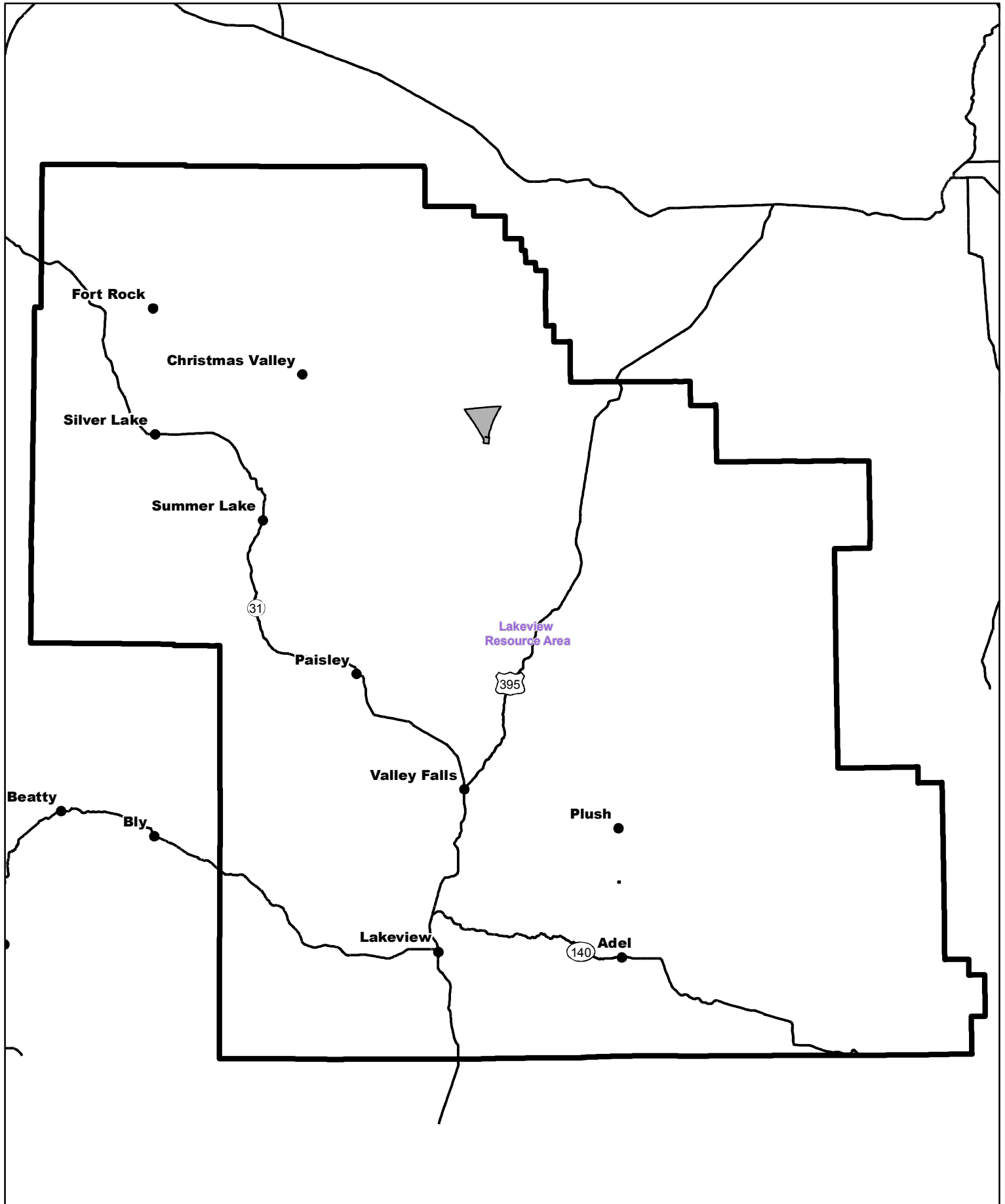

 Wilderness Character Inventory Unit

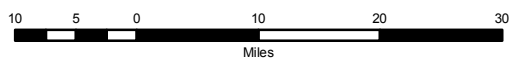

 No warranty is made by the Bureau of Land Management as to the accuracy, reliability, or completeness of these data for individual or aggregate use with other data. Original data were compiled from various sources. This information may not meet National Map Accuracy Standards. This product was developed through digital means and may be updated without notification.

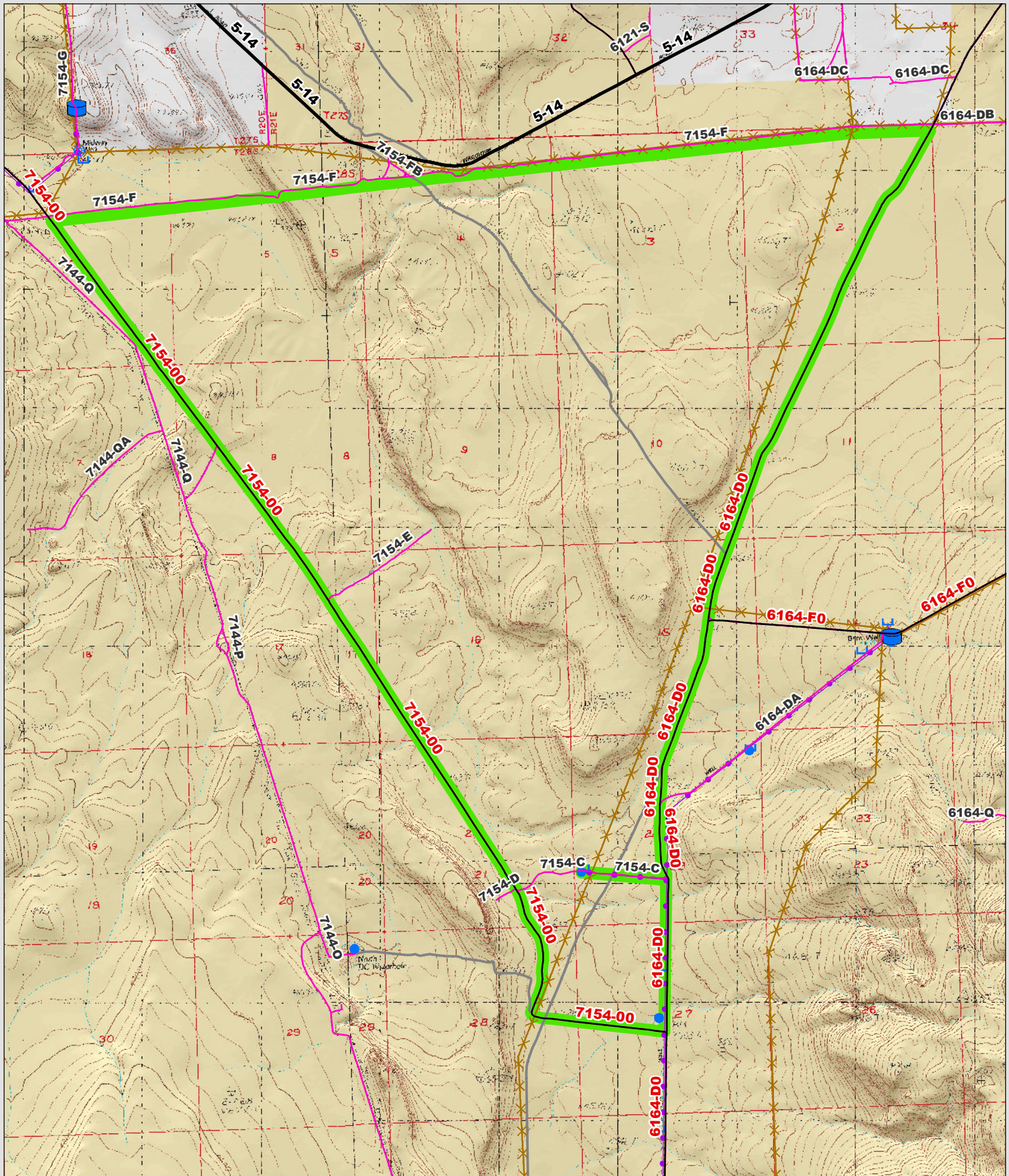

Wilderness Character Inventory Unit

Ownership

- Bureau of Land Management
- U.S. Forest Service
- State
- Private/Unknown

Roads/Trails

- Motorized Routes
- Highways
- Reclaiming Routes
- Interim Routes

Pipelines and Ditches

- Ditch
- Water Pipeline
- Guzzler
- Fences

Water Developments

- Dam
- Reservoir
- Spring Development
- Trough
- Water Diversion

Water Developments

- Water Tank
- Waterhole
- Well - Water

0.8 0.4 0 0.8 Miles

No warranty is made by the Bureau of Land Management as to the accuracy, reliability, or completeness of these data for individual or aggregate use with other data. Original data were compiled from various sources. This information may not meet National Map Accuracy Standards. This product was developed through digital means and may be updated without notification.