

# RECAPTURE CREEK

SAN JUAN County of Utah

Effective Date: 5/16/1956

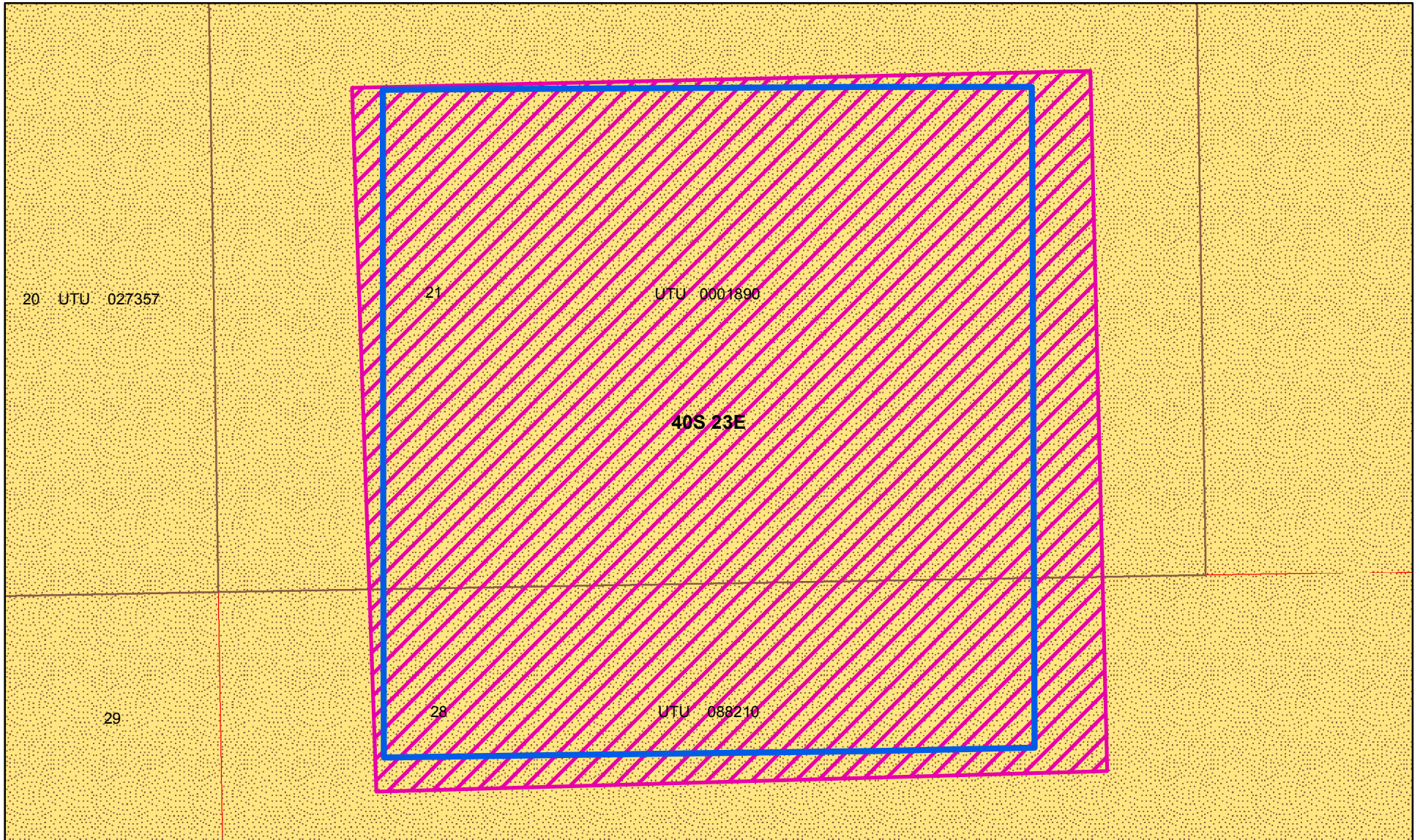

PA= Formation Name

PA= Hermosa PA UTU 0630200

Oil and Gas Unit Agreement

Oil and Gas Lease Parcels

Authorized Oil and Gas Lease Parcels

Pending Oil and Gas Lease Parcels

SITLA Oil and Gas Lease Parcels

UTU 063020X

Acres: 2320.0

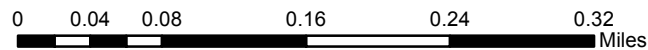

Bureau of Land Management (BLM)

US Forest Service (USFS)

National Park Service (NPS)

Indian Reservation (IR)

State

Private

Township

Section

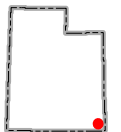

Date: 1/16/2018