

GOLDEN EAGLE 70 II

GRAND County of Utah

Effective Date: 12/5/2012

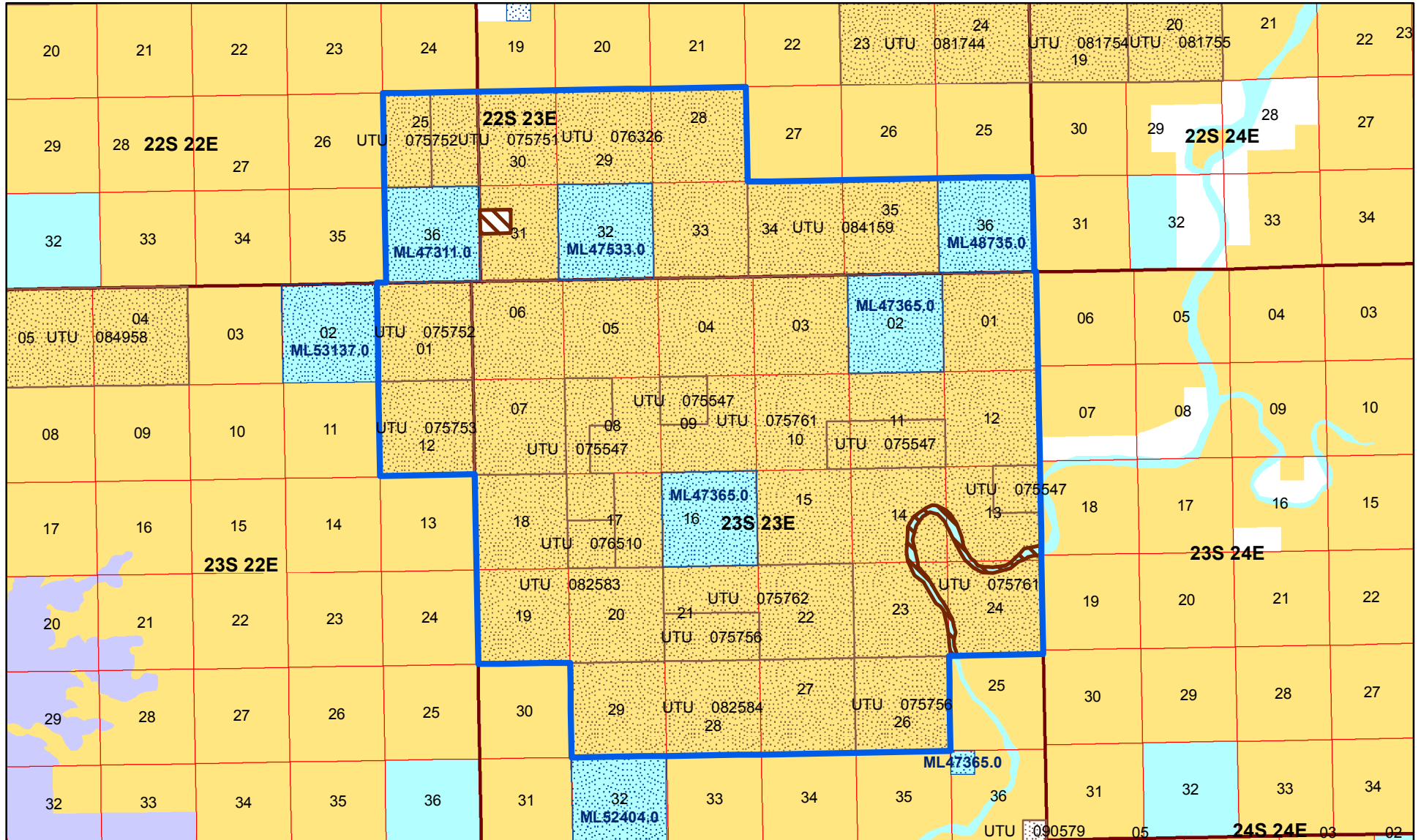

- Oil and Gas Unit Agreement
- Uncommitted Unit Tracts

Oil and Gas Lease Parcels

- Authorized Oil and Gas Lease Parcels
- Pending Oil and Gas Lease Parcels
- SITLA Oil and Gas Lease Parcels

UTU 088577X

Acres: 2320.0

- Bureau of Land Management (BLM)
- US Forest Service (USFS)
- National Park Service (NPS)
- Indian Reservation (IR)
- State
- Private
- Township
- Section

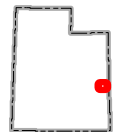
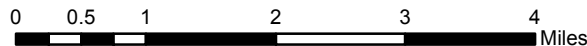

Date: 1/11/2018