

# BONANZA

UINTAH County of Utah

Effective Date: 5/31/2002

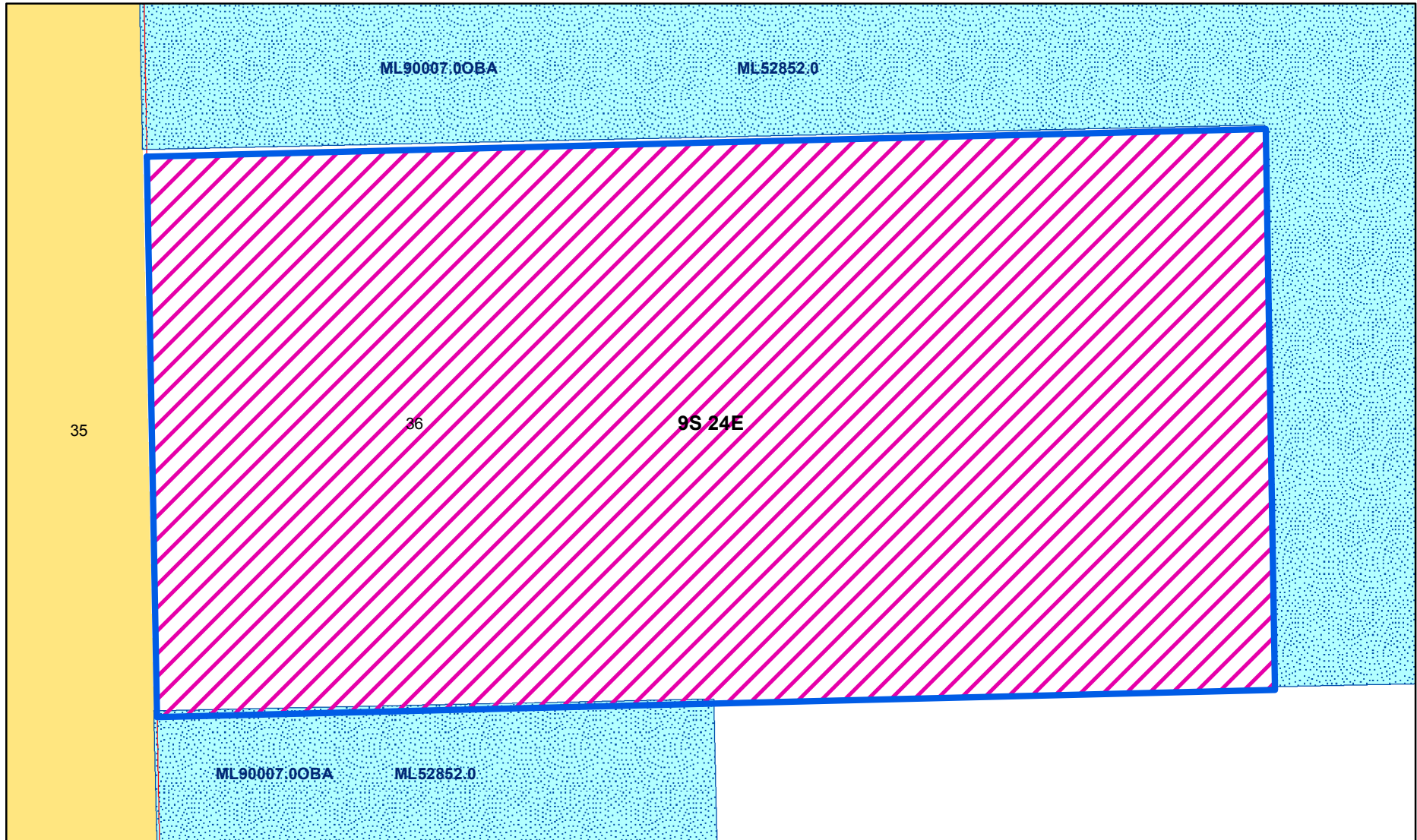

### PA= Formation Name

PA= Wasatch-Mesaverde "A"  
UTU 080155A

Oil and Gas Unit Agreement

### Oil and Gas Lease Parcels

Authorized Oil and Gas Lease Parcels

Pending Oil and Gas Lease Parcels

SITLA Oil and Gas Lease Parcels

**UTU 080155X**

Acres: 80.00

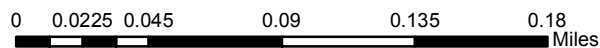

Bureau of Land Management (BLM)

US Forest Service (USFS)

National Park Service (NPS)

Indian Reservation (IR)

State

Private

Township

Section

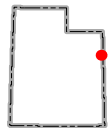

Date: 1/19/2018