

**WILDERNESS INVENTORY MAINTENANCE
IN BLM OREGON/WASHINGTON**

Year: **2008**

Inventory Unit Number/Name: **West Warm Springs Unit 3**

**FORM 1: DOCUMENTATION OF BLM WILDERNESS INVENTORY
FINDINGS ON RECORD:**

1. Is there existing BLM wilderness inventory information on all or part of this area?

No _____ Yes **X** (if more than one unit is within the area, list the names/numbers of those units):

a) Inventory Source: Wilderness Inventory, Proposed Initial Inventory – Roadless Areas and Islands Which Clearly Do Not Have Wilderness Characteristics, Oregon and Washington, April 1979

b) Inventory Unit Name(s)/Number(s): 2-113

c) Map Name(s)/Number(s): Proposed Initial Inventory Map, April 1979

d) BLM District(s)/Field Office(s): Burns District – Three Rivers Resource Area

2. BLM Inventory Findings on Record:

Existing inventory information regarding wilderness characteristics (if more than one BLM inventory unit is associated with the area, list each unit and answer each question individually for each inventory unit):

Inventory Source: These units were found to clearly not have wilderness characteristics present in the April 1979 report, so they were not described in detail.

Unit#/Name	Size (historic acres)	Natural Condition? Y/N	Outstanding Solitude? Y/N	Outstanding Primitive & Unconfined Recreation? Y/N	Supplemental Values? Y/N
NA					

**FORM 2 - DOCUMENTATION OF CURRENT WILDERNESS
INVENTORY CONDITIONS**

Unit Number/Name: West Warm Springs Unit 3

(1) Is the unit of sufficient size?

Current Unit Acres: 7,623 Yes X No _____

[State the BLM acreage of the unit. Describe the boundaries of the unit (roads, property lines, etc.) If the area meets one of the exceptions to the size criterion, check "Yes" and describe the exception. If more than one inventory unit is involved, list the acreage in each and evaluate each unit/subunit separately. Complete the analysis for (1), (2), (3), (4) and (5) for each unit or sub-unit. If you check "No" above, check "N/A" (Not Applicable) in the remaining boxes below, and you need not provide additional evaluation for the unit or subunit. Use additional space as necessary].

Description of the Current Conditions: (Include land ownership, location, topography, vegetation features and summary of major human uses/activities).

Citizen Information Received: NO

Boundary changes since 1979: The current unit boundaries appear to be similar to the 1979 2-113 unit (See Unit Boundary Map 1). There are now some new private land parcels along the outer edges of the unit

Current Unit Boundaries:

N: Private Land Ownership

NE: Non-BLM federal ownership not managed as designated wilderness or for wilderness values.

SE: BLM Road 8212-0-AA, BLM Road 7257-0-AA (BLM Route Analysis #50) and private land ownership

The ID-team confirmed that based on their knowledge of the area and reviewing the BLM information gathered as part of the unit boundary determination process that these routes do meet boundary road criteria.

(2) Is the unit in a natural condition?

Yes _____ No X N/A _____

Current Condition Description: The unit is located approximately 26 miles southwest of the community of Burns. The unit consists of flat to gently rolling hills with several dry lake playas. Vegetation is primarily big and low sagebrush, rabbit brush, grasses and greasewood.

Based on observations of staff during the field review, there is a considerable amount of off-road use by motorized vehicles in much this unit, especially in several of the playas. The unit currently has the following developments (See Unit Character Map):

- 14.2 miles of interior routes (non-boundary roads)
- 11 miles of fencing
- 2 waterholes

The ID-team found that this unit is not natural due to the extensive evidence of off-road use by motorized vehicles throughout the unit along with the interior routes, especially given the long narrow shape of the unit and its relatively small size.

(3) Does the unit have outstanding opportunities for solitude?

Yes _____ No _____ N/A X

(4) Does the unit have outstanding opportunities for primitive and unconfined recreation?

Yes _____ No _____ N/A X

(5) Does the unit have supplemental values?

Yes _____ No _____ N/A X

Summary of Findings and Conclusion

Unit Name and Number: West Warm Springs Unit 3

Summary Results of Analysis:

1. Does the area meet any of the size requirements? X Yes _____ No
2. Does the area appear to be natural? _____ Yes X No
3. Does the area offer outstanding opportunities for solitude or a primitive and unconfined type of recreation? _____ Yes _____ No X NA

4. Does the area have supplemental values? ☐ Yes ☐ No ☒ NA

Conclusion (Check One):

☐ The area-or a portion of the area-has wilderness character.

☒ The area does not have wilderness character.

Prepared by: Laura Dowlan, Wilderness Specialist

Team Members:

Laura Dowlan 9/5/08
Laura Dowlan, Outdoor Recreation Planner (Wilderness Specialist) – Burns District Date

Brett Page 8/20/08
Brett Page, Outdoor Recreation Planner – Burns District Date

Nick Miller 8/18/08
Nick Miller, Wildlife Biologist – Burns District Date

Rob Sharp 8/25/2008
Rob Sharp, Range Management Specialist – Burns District Date

Ronda L. Purdy 8-12-2008
Ronda Purdy, Range Technician – Burns District Date

Fred McDonald 8/22/08
Fred McDonald, Supervisory Natural Resource Specialist – Burns District Date

Willie Street 8-11-2008
Willie Street, Range Management Specialist – Burns District Date

Autumn Richardson 8-11-2008
Autumn Richardson, SCEP Range Management Specialist – Burns District Date

Approved by:

Joan M. Suther 8/27/08
Joan M. Suther, Three Rivers Field Manager – Burns District Date

This form documents information that constitutes an inventory finding on wilderness characteristics. It does not represent a formal land use allocation or a final agency decision subject to administrative remedies under either 43 CFR parts 4 or 1610.5-2.02

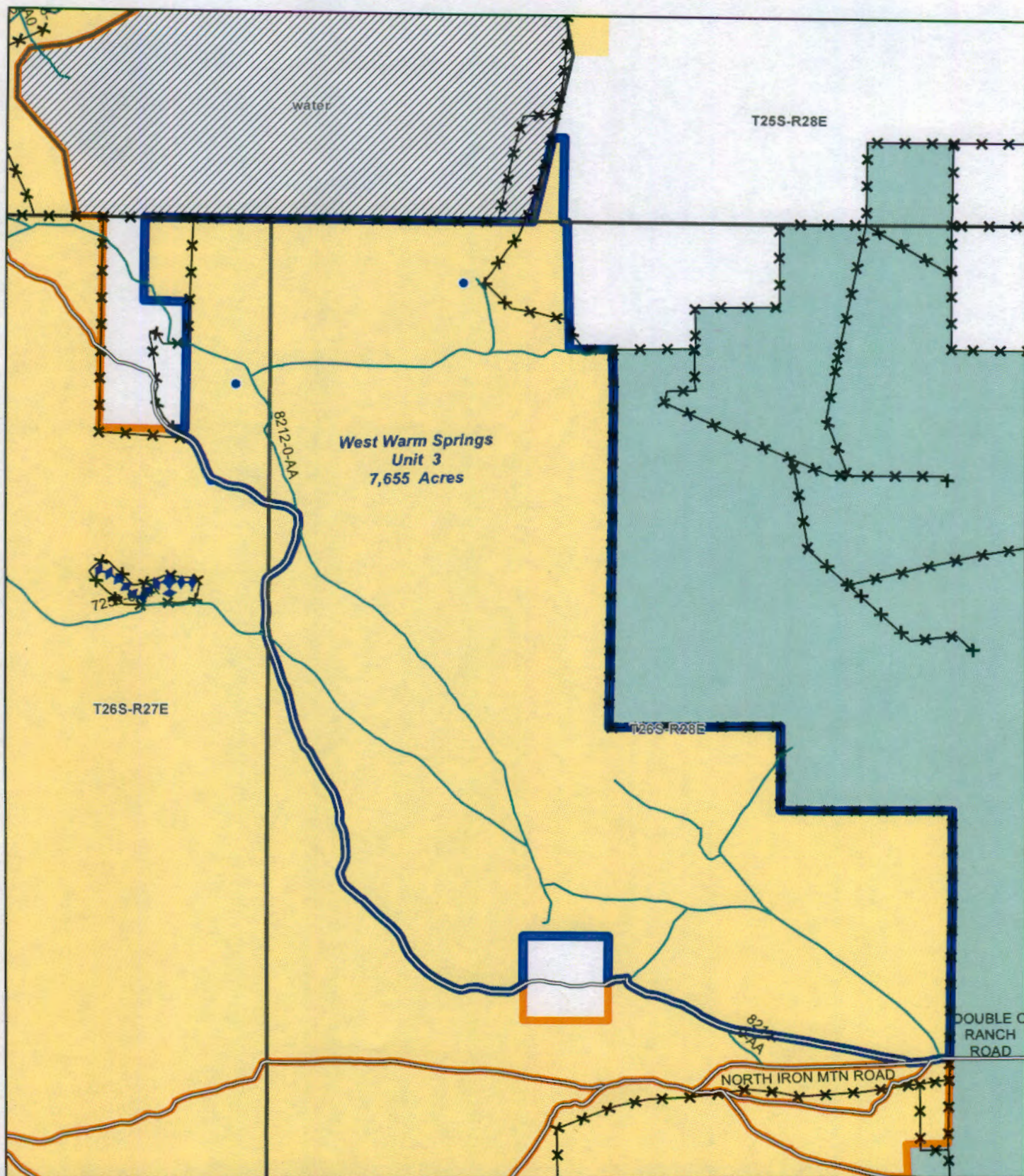

West Warm Springs Wilderness Character Unit Map ~3

- Unit 3 is 7,655 Acres
- Adjacent Units
- Unit Boundary Roads
- Interior Primitive Routes

- DIKE
- FENCE
- WATERHOLE

Land Administration

- Bureau of Land Management
- Private (White)
- U. S. Fish and Wildlife
- Undetermined; Water

0 0.3 0.6 1.2 Miles

Note: No warranty is made by the Bureau of Land Management as to the accuracy, reliability or completeness of these data for individual or aggregate use with other data. Original data was compiled from various sources. This information may not meet National Map Accuracy Standards. This product was developed through digital means and may be updated without notification. Ownership boundaries are accurate to within plus or minus 200 feet.



US DEPARTMENT OF THE INTERIOR
Bureau of Land Management
Bums District, Oregon
Three Rivers Resource Area



projects\WSA\InventoryReview\WestWarmSpt
IndividualUnit3Revised.mxd for Eric Haakenson
November 16, 2009
All legend elements may not appear on this map.