

TOWNSHIP II NORTH RANGE 31 EAST OF THE WILLAMETTE MERIDIAN, WASHINGTON

SPOKANE DISTRICT
FRANKLIN COUNTY

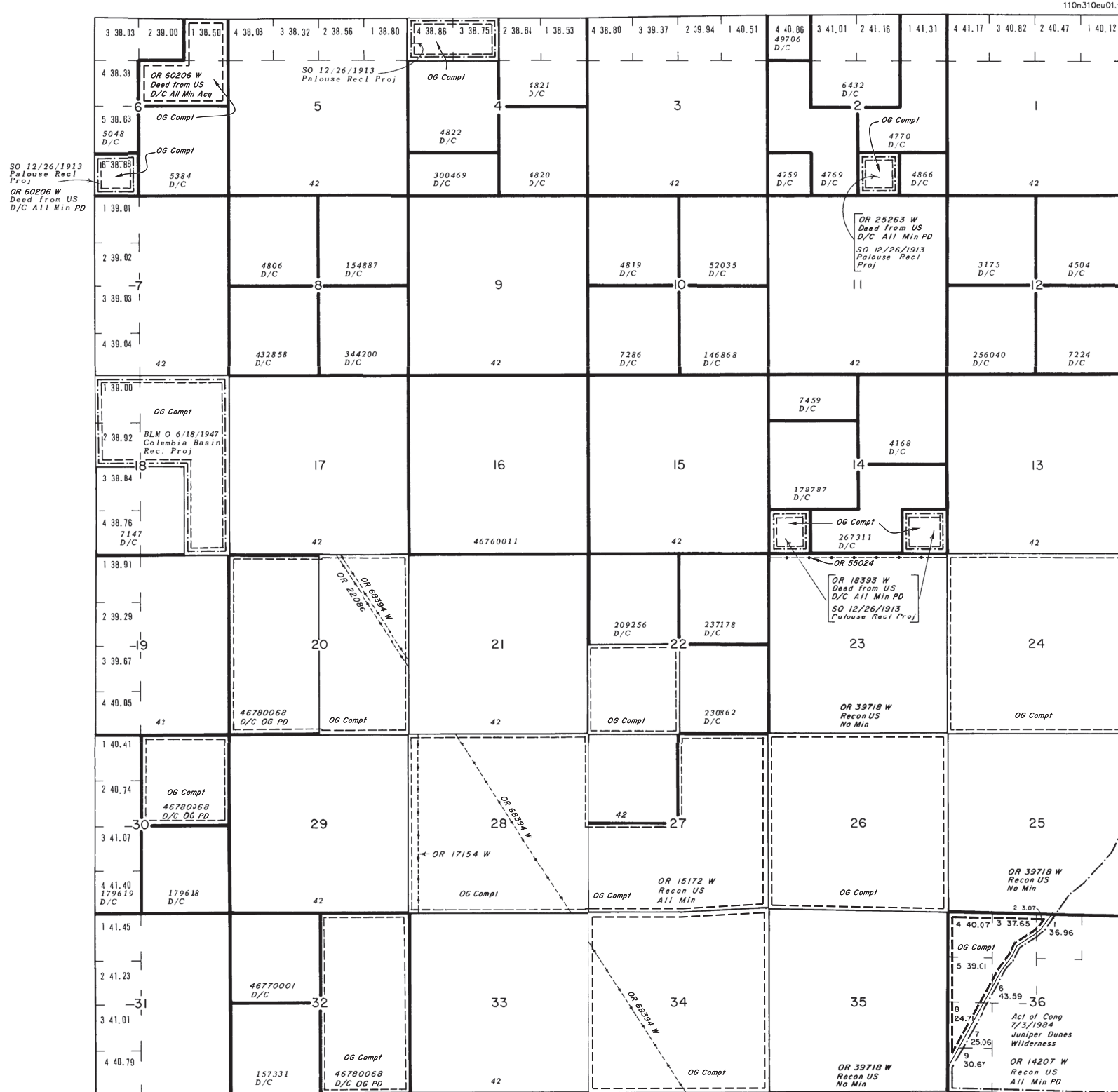

STATUS OF PUBLIC DOMAIN
LAND AND MINERAL TITLES
AND ACQUIRED LANDS

MT/USE PLAT

INDEX TO SEGREGATED TRACTS				
RESURVEY TRACT NO	ORIGINAL SURVEY			
	T	R	SEC	SUBDIVISION

FOR ORDERS AFFECTING DISPOSAL OR USE OF UNIDENTIFIED LANDS WITHDRAWN FOR CLASSIFICATION, MINERAL, WATER AND/OR OTHER PUBLIC PURPOSES, REFER TO INDEX OF MISCELLANEOUS DOCUMENTS.

Refer to HI for PL 167, R/W, Esmt, 44LD513, on all lands, see MTP and HI for US rights on private land

FILE REF: I10n310eu01.tif	AutoCAD/GTX
CONVERT JPEG: 07/31/2000	BY: H. GISCH
LAST UPDATE: 11/09/2022	BY: G. DAGUERRE
POSTED TO PUBLIC RECORDS: 11/09/2022	
SURVEYED TOWNSHIP	
SURVEYED COORDINATE SOURCE:	N/A
GCSB NAD 83 CURRENT TO:	N/A
IMAGE SOURCE:	SCANNED ORIGINAL MTP
PROJECTION:	N/A
COORDINATE ELEVATION:	N/A
SOURCE FOR METES & BOUNDS:	N/A
NOTES:	
USE PLAT: Lsbl Min	

WARNING STATEMENT
This plat is the Bureau's Record of Title, and should be used only as a graphic display of the township survey data. Records herein do not reflect title changes which may have been affected by lateral movements of rivers or other bodies of water. Refer to the cadastral surveys for official survey information.

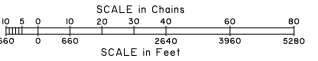

T. II N.
R. 31 E.