

TOWNSHIP 2 SOUTH RANGE 31 EAST OF THE WILLAMETTE MERIDIAN, OREGON  
 UMATILLA COUNTY  
 VALE DISTRICT

STATUS OF PUBLIC DOMAIN  
 LAND AND MINERAL TITLES  
 AND ACQUIRED LANDS  
 MT/USE PLAT

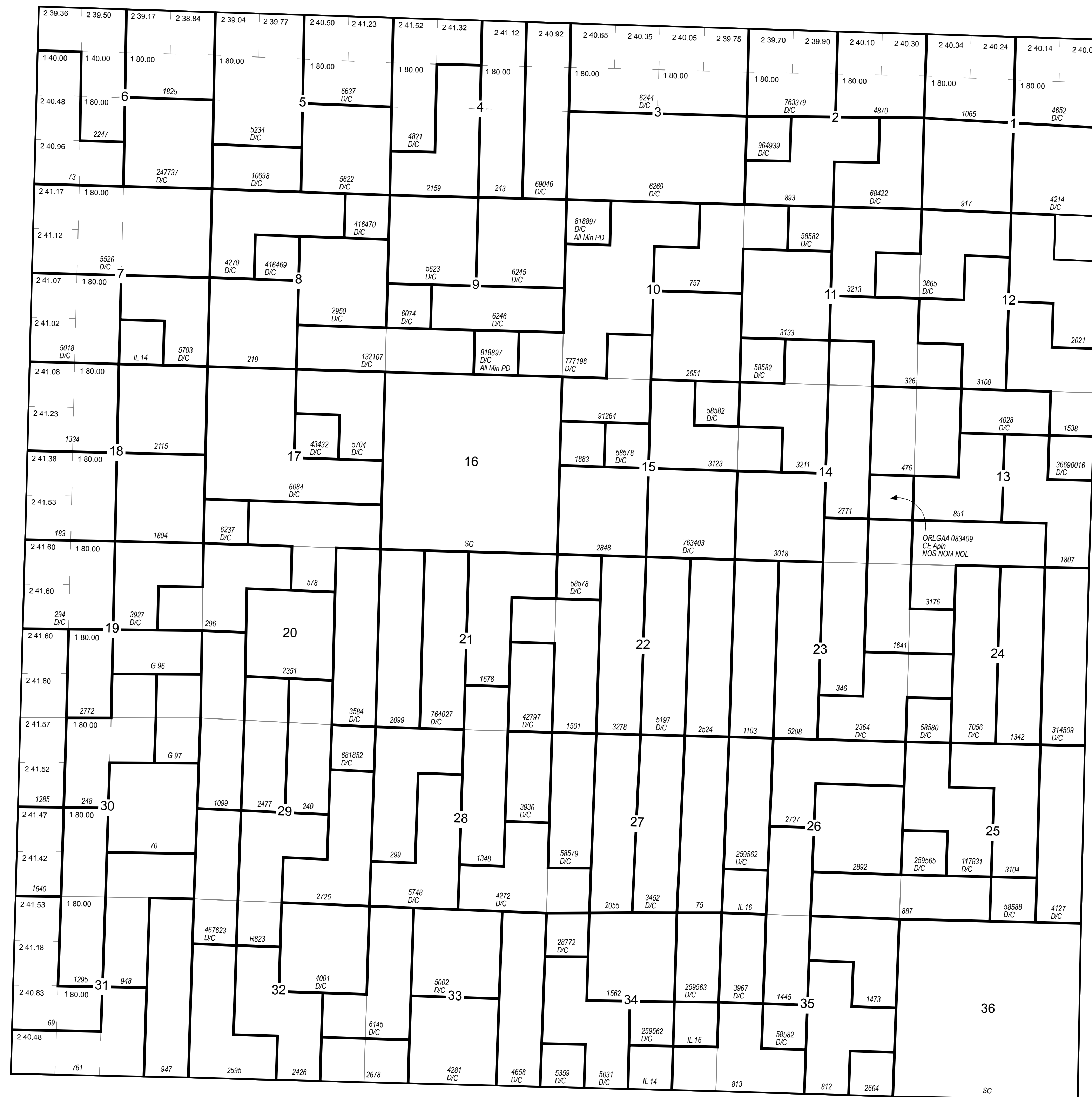

INDEX TO SEGREGATED TRACTS				
RESURVEY	ORIGINAL SURVEY			
TRACT NO	T	R	SEC	SUBDIVISION

FOR ORDERS AFFECTING DISPOSAL OR USE OF UNIDENTIFIED LANDS WITHDRAWN FOR CLASSIFICATION, MINERALS, WATER AND/OR OTHER PUBLIC PURPOSES REFER TO INDEX OF MISCELLANEOUS DOCUMENTS.

FILE REF:	020s310eu01.mxd
MTP EDITOR:	L. MOONEY
LAST UPDATE:	11/1/2010
POSTED TO PUBLIC RECORDS:	7/6/2018
PLSS SOURCE:	GCDB
PLSS DATE:	1/19/1996
PROJECTION:	UTM11
DATUM:	NAD83
NOTES:	
USE PLAT:	Lsbl Min

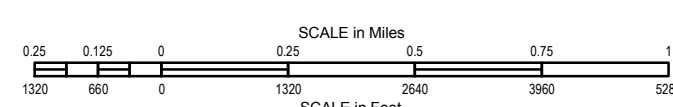

**WARNING STATEMENT**  
 This plat is the Bureau's Record of Title, and should be used only as a graphic display of the township survey data. Records hereon do not reflect title changes which may have been affected by lateral movements of river or other bodies of water. Refer to cadastral surveys for official information.