

TOWNSHIP 1 SOUTH RANGE 26 EAST OF THE WILLAMETTE MERIDIAN, OREGON

MORROW COUNTY
VALE DISTRICT

STATUS OF PUBLIC DOMAIN LAND AND MINERAL TITLES AND ACQUIRED LANDS

MT/USE PLAT

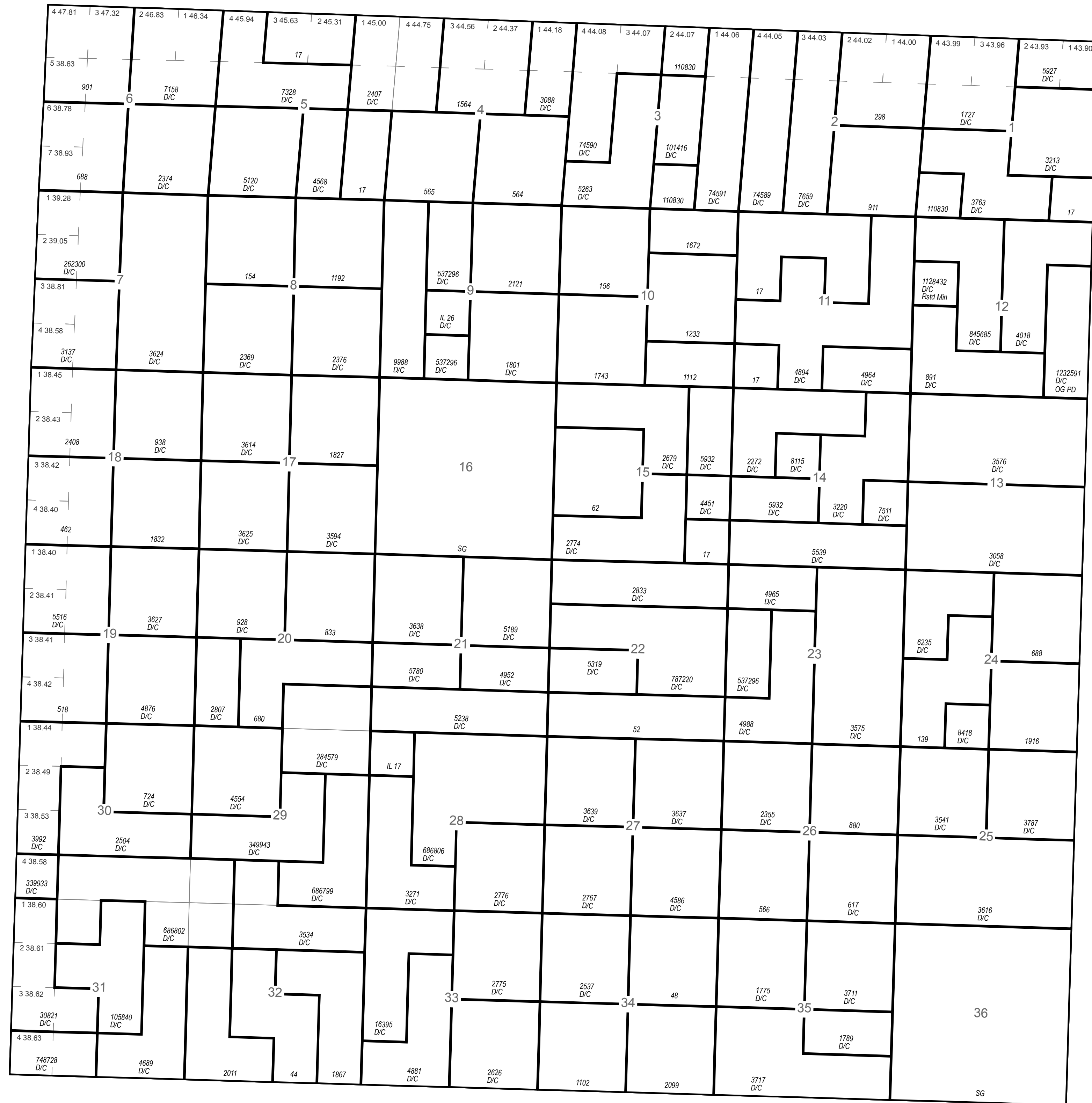

RESURVEY	ORIGINAL SURVEY			
TRACT NO.	T	R	SEC	SUBDIVISION

FOR ORDERS AFFECTING DISPOSAL OR USE OF UNIDENTIFIED LANDS WITHDRAWN FOR CLASSIFICATION, MINERALS, WATER AND/OR OTHER PUBLIC PURPOSES REFER TO INDEX OF MISCELLANEOUS DOCUMENTS.

(This area is intentionally left blank for recording orders and other public purposes.)

FILE REF:	010s260su01.mxd
MTP EDITOR:	D.SENN
LAST UPDATE:	8/2/2012
POSTED TO PUBLIC RECORDS:	2/23/2016
PLSS SOURCE:	CADNSD1
PLSS DATE:	9/2/1994
PROJECTION:	UTM11
DATUM:	NAD83
NOTES:	
USE PLAT:	Lstid Min

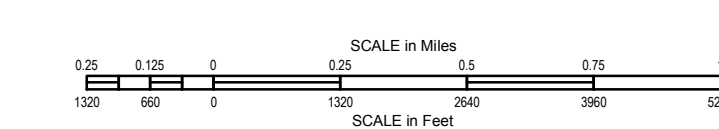

WARNING STATEMENT
This plat is the Bureau's Record of Title, and should be used only as a graphic display of the township survey data. Records hereon do not reflect title changes which may have been affected by lateral movements of river or other bodies of water. Refer to cadastral surveys for official information.

Will Mer
T. 1 S.
R. 26 E.