

**TOWNSHIP 1 NORTH RANGE 26 EAST OF THE WILLAMETTE MERIDIAN, OREGON**  
MORROW COUNTY  
VALE DISTRICT

**STATUS OF PUBLIC DOMAIN  
LAND AND MINERAL TITLES  
AND ACQUIRED LANDS**

**MT PLAT**

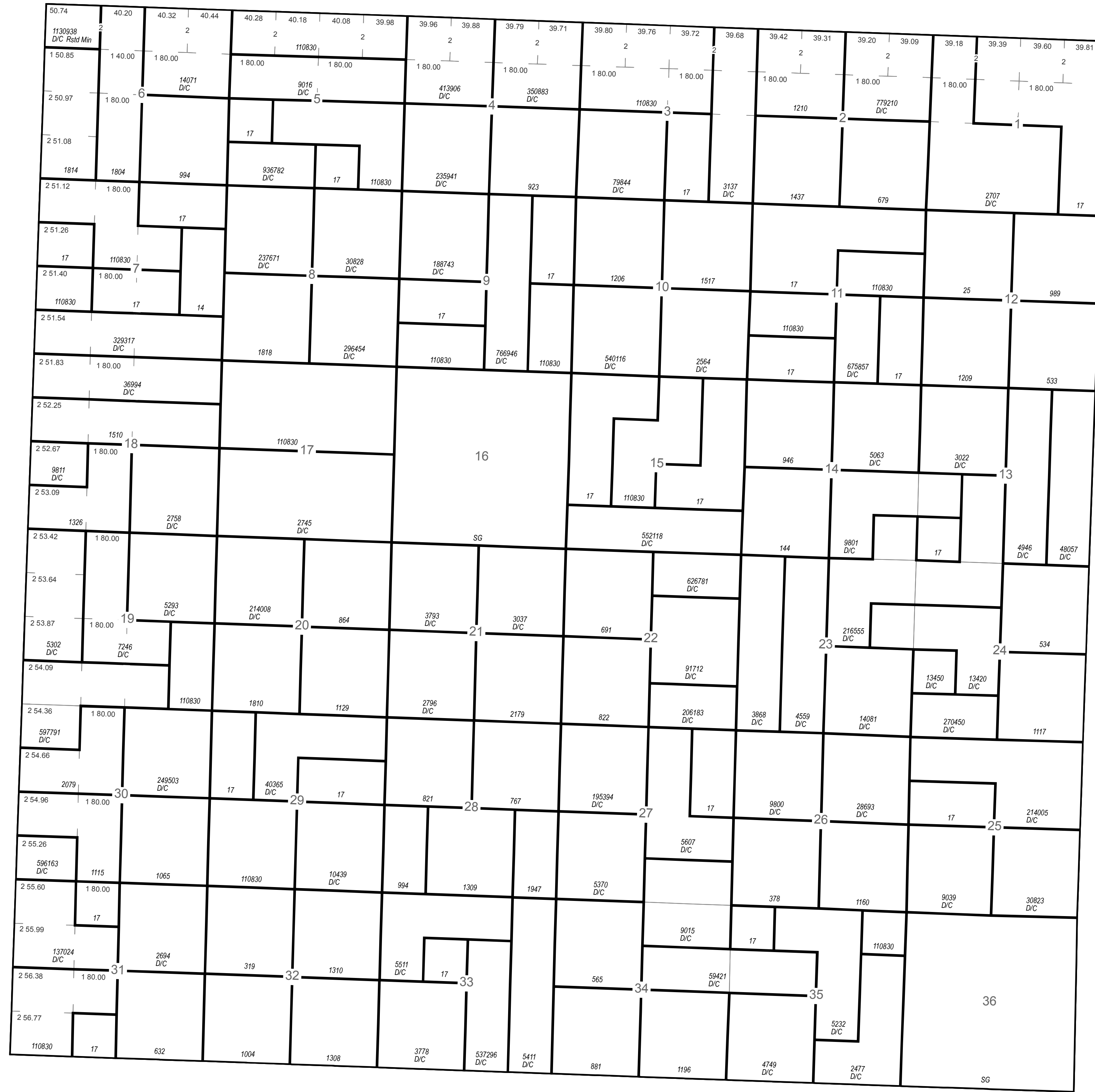

INDEX TO SEGREGATED TRACTS				
RESURVEY	ORIGINAL SURVEY			
TRACT NO	T	R	SEC	SUBDIVISION

FOR ORDERS AFFECTING DISPOSAL OR USE OF UNIDENTIFIED LANDS WITHDRAWN FOR CLASSIFICATION, MINERALS, WATER AND/OR OTHER PUBLIC PURPOSES REFER TO INDEX OF MISCELLANEOUS DOCUMENTS.

FILE REF:	010n260em01.mxd
MTP EDITOR:	D. DEARTH
LAST UPDATE:	6/27/2012
POSTED TO PUBLIC RECORDS:	2/23/2016
PLSS SOURCE:	CADNSD1
PLSS DATE:	2/7/2000
PROJECTION:	UTM11
DATUM:	NAD83
NOTES:	
USE PLAT:	

**WARNING STATEMENT**  
This plat is the Bureau's Record of Title, and should be used only as a graphic display of the township survey data. Records hereon do not reflect title changes which may have been affected by lateral movements of river or other bodies of water. Refer to cadastral surveys for official information.

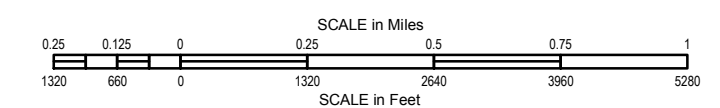

Will Mer  
T: 1 N.  
R: 26 E.