



# United States Department of the Interior

## BUREAU OF LAND MANAGEMENT

Eugene District Office

P.O. Box 10226

Eugene, Oregon 97440-2226

IN REPLY REFER TO:

5430A

To: Eugene District Office

Attn: Cynthia L. Phillips, Siuslaw Resource Area (541) 683-6776  
Terry Ray, Upper Willamette Resource Area (541) 683-6417  
Debra Wilson, Eugene District (541) 683-6798

### PROSPECTUS REQUEST

Please send the following information for the timber sale(s) to be sold on **February 14, 2013**.  
(Check appropriate boxes)

Parcel No.	Sale Name	Prospectus	EXHIBITS AND APPRAISALS				
			Road			Slash Disposal	Other ( <i>indicate</i> )
			Construction	Maintenance	Decom-missioning		
1	North Line						
2	Good Chance						

Mail to:

---

---

---

---

Requested by: \_\_\_\_\_



# United States Department of the Interior

## BUREAU OF LAND MANAGEMENT

Eugene District Office  
P.O. Box 10226  
Eugene, Oregon 97440-2226

IN REPLY REFER TO:  
5430A

January 16, 2013

**This advertisement includes:**

**Parcel No. 1 – North Line**

**Parcel No. 2 – Good Chance**

### TIMBER SALE NOTICE

**NOTICE IS HEREBY GIVEN** that the Bureau of Land Management will offer for sale timber as described herein for oral auction, pursuant to Instructions to Bidders, as stated on Form No. 5440-9 and subject to Notice of Requirement for Certification of Nonsegregated Facilities, Form No. 1140-4, attached. Written and oral bids will be received by the District Manager, or her representative, at the **EUGENE DISTRICT OFFICE, 3106 PIERCE PARKWAY, SPRINGFIELD, OREGON**. The timber sale will commence at 10:00 a.m. on Thursday, **February 14, 2013**.

This Timber Sale Notice does not constitute the decision document for purposes of protest and appeal of a forest management decision. Consistent with 43 CFR Subpart 5003 - Administrative Remedies, the notice of a timber sale, when published as a legal ad in a newspaper of general circulation shall constitute the decision document for purposes of protest and appeal. Protests may be filed with the Contracting Officer within 15 days of the publication of the aforementioned decision document in the newspaper. It is anticipated that the decision document will be published in The Register-Guard newspaper on or about January 16, 2013. BLM does not warrant publication on this exact date. All parties considering protest of the timber sale decision document are encouraged to review the aforementioned newspaper to ensure accurate knowledge of the exact publication date.

**A WRITTEN BID** on Form 5440-9 at not less than the appraised price on a unit basis per species and the required minimum bid deposit shall be required to participate in oral bidding for each tract.

**THE SUCCESSFUL BIDDER**, as a condition of award, will be required to complete and/or sign the following forms:

1. Form 1140-6, a certification that the bid was arrived at by the bidder or offerer independently, and was tendered without collusion with any other bidder or offerer.
2. Form 1140-7, Equal Opportunity Affirmative Action Program Representation, for all contracts over \$10,000.
3. Form 1140-8, Equal Opportunity Compliance Report Certification.
4. Form 5450-17, Export Determination.

**PRE-AWARD QUALIFICATIONS.** The high bidder may be required to furnish information to determine the ability to perform the obligations of the contract. If the high bidder is determined not qualified, not responsible or refuses to respond within 15 days of a request for information pertaining to qualifications, the contract may be offered and awarded for the amount of the high bid to the highest of the bidders who is qualified, responsible, and willing to accept the contract.

**A PERFORMANCE BOND** in an amount not less than 20 percent of the total purchase price will be required for all contracts of \$2,500 or more, but the amount of the bond shall not be in excess of \$500,000, except when the Purchaser opts to increase the minimum bond as provided in 43 CFR 5451.2. A minimum performance bond of not less than \$500 will be required for all installment contracts less than \$2,500.

**INSTALLMENT PAYMENTS** may be authorized for sales of \$500 or more. Required installments will be determined by BLM. For sales under \$500,000, installments will not be less than 10% of the total purchase price. For sales of \$500,000 or more, installment payments shall be \$50,000.

**LOG EXPORT AND SUBSTITUTION.** All timber sales, including timber from Federal rights-of-ways, shall be

subject to the restrictions relating to the export and substitution of unprocessed timber from the United States in accordance with P.L. 94-165 and 43 CFR 5400 and 5424, as amended.

**LOG EXPORT AND SUBSTITUTION RESTRICTIONS.** Excepting Port-Orford-cedar, all timber offered for sale hereunder is restricted from export from the United States in the form of unprocessed timber and is prohibited from being used as a substitute for exported private timber.

The BLM has revised the log export restrictions special provision to reduce the log branding and painting requirements. The new requirements include branding of one end of all logs with a scaling diameter of over 10 inches. All loads of 11 logs or more, regardless of the diameter of the logs, will have a minimum of 10 logs branded on one end. All logs will be branded on loads of 10 logs or less. One end of all branded logs will be marked with yellow paint. At the discretion of the Contracting Officer, the Purchaser may be required to brand and paint all logs. The Purchaser shall bear any increased costs for log branding and painting.

**ADDITIONAL INFORMATION** concerning each timber sale tract described herein is available at the above District Office. A copy of the timber sale contract is also available for inspection at the District Office. This prospectus includes maps and tables that cannot be made Section 508 compliant. For help with its data or information, please contact the Eugene District Office at 541-683-6798.

**THE VOLUMES LISTED** herein are estimates only, based on 16-foot taper breaks, which must be taken into consideration if comparisons are made with volume predictions based on other standards. The volumes based on 32-foot taper breaks are shown for comparison purposes. No sale shall be made for less than the total purchase price, without regard to the amount bid per unit, even though quantity of timber actually cut or removed or designated for taking is more or less than the estimated volume or quantity so listed.

**ENVIRONMENTAL ASSESSMENTS** were prepared for these sales, and Findings of No Significant Impact have been documented. These documents are available for inspection as background for these sales at the Eugene District Office.

**ACCESS** to a sale may be through a locked gate (see individual sale information). Prospective bidders may obtain a key from the Eugene District Office. Any other persons interested in visiting the timber sale site should first contact the District Office at 683-6600.

Attachments:

- Form 5440-9
- Form 1140-4
- Form 1140-6
- Form 5450-22
- Form 5430-1

EUGENE DISTRICT  
UPPER WILLAMETTE RESOURCE AREA

PARCEL NO.: 1  
SALE DATE: February 14, 2013

Tract No. E-13-657 North Line  
Linn & Lane County, Oregon: O&C

Bid Deposit Required: \$28,400.00

All timber designated for cutting on S1/2SW1/4, SW1/4SE1/4, Section 25; S1/2NE1/4, S1/2NW1/4, W1/2SW1/4, SE1/4, Section 35, T. 14 S., R. 1 W. Will. Mer.; SW1/4NW1/4, SW1/4, W1/2SE1/4, Section 1; Lot 2, Section 11, T. 15 S., R. 1 W. Will. Mer..

Estimated Volume 32' Log (MBF)	Species	Estimated Volume 16' Log (MBF)	Appraised Price Per MBF	Estimated Volume Times Approx. Price
3,060	Douglas-fir	3,443	\$ 81.00	\$ 278,883.00
24	Grand fir	27	\$ 37.10	1,001.70
71	Western hemlock	84	\$ 35.00	2,940.00
1	Western redcedar	1	\$ 320.00	320.00
1	Red alder	2	\$ 28.00	56.00
3,157	TOTALS	3,557		\$ 283,200.70

APPRAISED PRICES are calculated by determining market value through the analytical appraisal method. The minimum bid increment will be \$0.10 per MBF or multiples thereof.

LOG EXPORT RESTRICTIONS: All timber offered for sale hereunder is restricted from export from the United States in the form of unprocessed timber and is prohibited from being used as a substitute for exported private timber.

NOTE: The volume for this timber sale has been calculated using 16 foot eastside Scribner rules, and the 32 foot log volumes and the cubic log volumes are estimates derived from the 16 foot volumes.

CRUISE INFORMATION: Volume for Douglas-fir in Partial Harvest Area No. 1 and the right-of-ways has been cruised using the 3P system to select sample trees. The sample trees have been cruised and the volume computed using the **National Cruise Processing Program** for estimating volume in 16 foot lengths and the volume expanded to a total Partial Harvest Area No. 1 and right-of-way volume. A map showing the location and description of these sample trees is available at the Eugene District Office. The timber volumes for all other conifers and hardwoods in the right-of-ways were based on a 100% cruise using the **National Cruise Processing Program** for estimating board foot volume of trees in 16 foot logs.

Volume for the coniferous species in Partial Harvest Areas No. 2, 3, 4, 5 and 6 was variable plot cruised. Partial Harvest Areas No. 2, 3, 4, 5 and 6 contain a total of 260 plots and 91 randomly selected sample trees. The tree count was determined with a Relaskop using a 20 BAF. Sample trees were randomly selected and volume expanded to a total Partial Harvest Area volume in 16-foot lengths using the **National Cruise Processing Program**. A map showing the location of the sample trees is available at the Eugene District Office.

With respect to merchantable Douglas-fir (sample) trees: The average tree is 11.9" DBHOB; the average log contains 35 bd. ft.; the total gross merchantable volume is approximately 3,637 MBF; and 94% recovery is expected.

CUTTING AREA: Six areas totaling approximately 361 acres must be partial harvested and approximately 7 acres of right-of-way must be clear cut.

ACCESS: Access to the sale is provided by:

1. A public road;
2. BLM existing roads;
3. BLM roads to be constructed;
4. Roads covered by a Right-of-Way and Road Use Agreement E-573 between Weyerhaeuser Company and the United States. In the use and renovation of private roads, the Purchaser shall enter into a license agreement with Weyerhaeuser Company. The license agreement shall be delivered to Weyerhaeuser Company for execution at least 15 days prior to any use of company roads. See the Prospectus for full terms and conditions of use.
5. Roads covered by a Right-of-Way and Road Use Agreement E-370 between Timber Service Company and the United States. In the use and renovation of private roads, the Purchaser shall enter into a license agreement with Timber Service Company. The license agreement shall be delivered to Timber Service Company for execution at least 15 days prior to any use of company roads. See the Prospectus for full terms and conditions of use.

**ROAD MAINTENANCE:** The Purchaser shall pay Weyerhaeuser Company road use fees of \$7,114.00. In addition, the Purchaser shall either maintain the Weyerhaeuser owned roads or Weyerhaeuser will maintain their roads and the Purchaser shall pay maintenance fees estimated at \$1,362.13. The Purchaser shall pay Weyerhaeuser Company rockwear fees estimated at \$834.47. The Purchaser shall spread 1 load of crushed rock in lieu of rockwear fees on Weyerhaeuser owned Road No. 15-1-11. The Purchaser shall spread 4 loads of crushed rock in lieu of rockwear fees on Timber Service Company owned Road No. 14-1-34 Segs. A and C. The Purchaser shall pay BLM rockwear fees estimated at \$5,294.53. See Exhibit D map for specification of road maintenance responsibility. Only the map pages of Exhibit D are included in the Prospectus. Refer to the contract file for the full Exhibit D.

In addition to the quantities shown below, 250 CY (truck measure) of 1-1/2" minus maintenance rock is required. Load tickets for spot rock quantities are required.

**ROAD CONSTRUCTION:** Required

Suggested Rock Source: Commercial, Sweet Home, OR

Spurs 1A, 1B, 35A, 35A1, 35B, 35C, 35D, 35E, 35H, 35K.

Class: SN-14

Length: 42.45 Stations

Surfacing: 1-1/2" minus, 3" minus, Jaw Run (6" minus)

Width: 12'

Compacted Depth: 4"-9"

Estimated Quantities: 1-1/2" minus: 270 CY (truck measure)

Jaw Run (6" minus): 1,057 CY (truck measure)

Total estimated construction cost: \$39,771.49

Special Requirements in Road Construction: Operations limited to periods of dry weather. The Purchaser shall have the option to rock Spurs 1A and 1B. Additional drainage features may be required as directed by the Authorized Officer. Any costs for rocking and installation of cross drains will be at the Purchaser's expense and shall conform to the 1-1/2" minus BLM gradation "A".

**ROAD RENOVATION:** Required

Suggested Rock Source: Commercial, Sweet Home, OR

Spur 1F, Spurs 1H, Road Nos. 14-1-26 Seg. B2, 14-1-34, 14-1-35 Seg. A, 14-1-35 Seg. B, 14-1-35.1, 14-1-35.2, 14-1-35.3, 14-1-35.7, 14-1-35.8, 15-1-1.3, 15-1-2, 15-1-9, 15-1-11.1

Class: SN-14 / SN-16

Length: 555.08 Stations

Surfacing: 1-1/2" minus, 3" minus, Jaw Run (6" minus)

Width: 12'-14'

Compacted Depth: 4"-9"

Estimated Quantities: 3/4" minus: 300 CY (truck measure)

1-1/2" minus: 3,730 CY (truck measure)

3" minus: 1,342 CY (truck measure)

Jaw Run (6" minus): 100 CY (truck measure)

Pit run culvert armoring: 40 CY (truck measure)

Total estimated renovation cost: \$174,111.42

Culverts:		
Diameter:	Length:	Number:
18" CPP	330'	10
24" CPP	64'	2
24" CMP	36'	1
30" CMP	116'	3

Special Requirements in Road Renovation: Removal, replacement, and installation of stream culverts on Road Nos. 14-1-34 and 15-1-2 shall be done between June 1 and October 15 (both days inclusive). Removal, replacement, and installation of stream culverts on any other roads shall be done between July 15 and August 31 (both days inclusive). Prior to any renovation work on Road No. 14-1-35 Seg. B, lead-offs shall be constructed to drain wet areas located between Stas: 2+75 - 8+00. The Purchaser shall have the option to rock Spur 1H. Additional drainage features may be required as directed by the Authorized Officer. Any costs for rocking and installation of cross drains will be at the Purchaser's expense and shall conform to the 1-1/2" minus BLM gradation "A".

**ROAD DECOMMISSIONING:** Required

Roads: 14-1-26 Seg. B2, Spur 1A, Spur 1B, Spur 1F, Spur 1H

Length: 53.34 Stations

Barriers: 4

Culvert Removal: Road No. 14-1-26 Seg. B2

Estimated Cost of Decommissioning: \$4,054.71

Special Requirements in Road Decommissioning: Operations limited to periods of dry weather. Removal of stream culverts shall be done between July 15 and August 31 (both days inclusive). Two culverts on Road No. 14-1-26 Seg. B2 must be removed after harvest operations and shall be removed from BLM lands in a legal manner. Spurs that are optionally rocked shall not be decommissioned.

**Total estimated cost of construction, renovation, and decommissioning: \$217,937.62****DURATION OF CONTRACT:** Duration of the contract will be 36 months for cutting and removal of timber.**SPECIAL PROVISIONS:** The contract will contain special provisions regarding road construction, road renovation, road maintenance, road decommissioning, logging methods, prevention of erosion, logging residue reduction, submission of a written logging plan specifying landing locations, logging methods, and logging schedule.

Under Sec. 25 of the timber sale contract, groundbased logging will be prohibited during periods of excessive soil moisture. This will normally limit groundbased logging to July, August and September.

It is estimated that 233 MBF additional timber, such as corridor and guyline trees may be removed under the contract, but is not included in the advertised sale volume, nor is it included in the timber sale appraisal.

**A revised Special Provision, 42(d)(2)(cc), has been added to the contract which enables the Contracting Officer to allow the Purchaser to remove material from the Contract Area instead of disposing of slash by piling, covering and burning.**

**OTHER SPECIAL REQUIREMENTS:**

- 1. In Partial Harvest Area No. 3 as shown on Exhibit A, no harvest activities, including felling, yarding, decking, hauling or road work shall be conducted from March 1 to July 15 of each year, both days inclusive. This restriction is for wildlife purposes and may be waived or modified (reduced or extended).**
2. No felling, yarding, or loading is permitted in or through the Reserve Areas shown on Exhibit A.
3. Road renovation and hauling operations on native surface roads shall be restricted to dry periods (typically July 1 to September 30).
4. No yarding shall be conducted on the Partial Harvest Areas during sap flow from April 1 to June 15 of each year, both days inclusive, unless otherwise approved by the Authorized Officer.
5. The Purchaser shall provide a map of requested skyline and skid road locations a minimum of seven (7) working days in advance of cutting to obtain approval of the locations from the Authorized Officer.
6. Approximately 380 orange painted reserve trees are required for the creation of snags and coarse woody debris.
7. Corridors and skid trails may need to be adjusted to avoid cutting large trees 28 inches or greater DBH.
8. Purchaser shall pile logging slash at all landings and within 25 feet of the portion of Road Nos. 14-1-35, 14-1-35.1, 14-1-35.2, 14-1-35.3, 14-1-35.7, 14-1-35.8, 15-1-1.3, 15-1-2, and 15-1-9 within the Partial Harvest Areas as directed by the Authorized Officer.

**OPTIONAL CONTRIBUTION:** The Purchaser will have the option of performing slash pile burning or contributing One Thousand One Hundred Seventy-six and 26/100 dollars (\$1,176.26) in lieu thereof. The option must be declared prior to contract execution. Piling and covering are not included in the Optional Contribution and will remain the responsibility of the Purchaser.

**If the Purchaser has made such a contribution and later elects to remove all of the slash required to be piled, covered, and burned, the contribution will be refunded.**

**NARRATIVE DESCRIPTION OF HOW TO GET TO SALE AREA:** Portions of the sale are accessed through a locked gate. Prospective bidders may obtain a key from the Eugene District Office and proceed to the sale area. Any other persons interested in visiting the timber sale should first contact Brian Bickford at 541-683-6164.

From Brownsville, travel 7.3 miles east on Highway 228. Turn south on Brush Creek Road and travel 4 miles to Road No. 14-1-33 (Childers Road). Turn east on Road No. 14-1-33 and travel approximately 0.9 miles to Road No. 14-1-34. Continue east on Road No. 14-1-34 for approximately 1.5 miles to the junction with Road No. 15-1-2. Turn north onto Road No. 15-1-2 and follow Timber Sale Location signs to the Partial Harvest Areas.



# TIMBER SALE LOCATION MAP

SALE NAME: North Line Timber Sale

T. 14 S., R. 1 W., SEC. 25, 35, T. 15 S., R. 1 W., SEC. 1, 11, WILL. MER., EUGENE DISTRICT

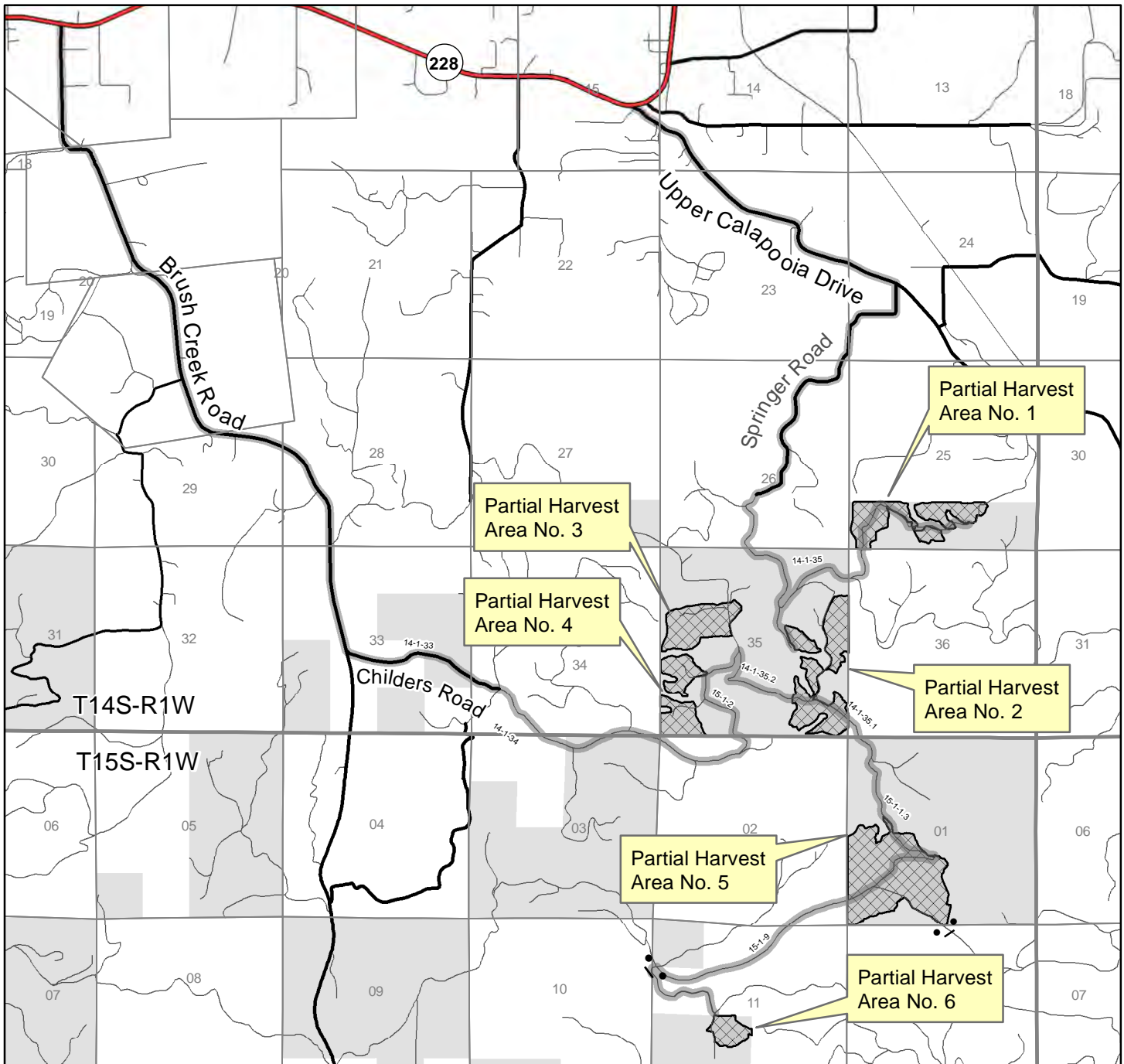

Sale Area BLM Ownership Highway Paved Road Sale Route Gate

**NARRATIVE DESCRIPTION OF HOW TO GET TO THE TIMBER SALE AREA:** Access to the sale is through a locked gate over private roads. Prospective bidders may obtain a key from the Eugene District Office and proceed to the sale area. Any other persons interested in visiting the timber sale site should first contact Brian Bickford at 541-683-6164.

From Brownsville, travel approximately 7.3 miles east on Highway 228. Turn south on Brush Creek Road and travel approximately 4 miles to Road No. 14-1-33 (Childers Road). Turn east on Road No. 14-1-33 and travel approximately 0.9 miles to Road No. 14-1-34. Continue east on Road No. 14-1-34 for approximately 1.5 miles to the junction with Road No. 15-1-2. Turn north onto Road No. 15-1-2 and follow the Timber Sale Location signs to Partial Harvest Areas 1-6.



0 0.5 1 Miles

11/15/2012

No warranty is made by the Bureau of Land Management as to the accuracy, reliability, or completeness of these data for individual or aggregate use with other data. Original data were compiled from various sources. This information may not meet National Map Accuracy Standards. This product was developed through digital means and may be updated without notification.

United States Department of the Interior  
Bureau of Land Management  
Oregon State Office  
P.O. Box 2965  
Portland, Oregon 97208-2965

		Jan		Feb		Mar		Apr		May		June		July		Aug		Sept		Oct		Nov		Dec	
		1	15	1	15	1	15	1	15	1	15	1	15	1	15	1	15	1	15	1	15	1	15	1	15
<b>Road Construction and Renovation</b>																									
<ul style="list-style-type: none"> <li>Typically, October 1 – June 30, may vary due to weather conditions.</li> </ul>																									
<b>Yarding (Sap flow)</b>																									
<u>Partial Harvest Area</u>																									
<ul style="list-style-type: none"> <li>April 1 – June 15, both days inclusive</li> <li>Sap flow restrictions may be conditionally waived at the discretion of BLM</li> </ul>																									
<b>Ground based yarding and decommissioning</b>																									
<u>Partial Harvest Area</u>																									
<ul style="list-style-type: none"> <li>October 1 – June 30, may vary due to weather conditions; soil moisture still overrides weather conditions.</li> </ul>																									
<b>Hauling on native-surfaced roads</b>																									
Soil moisture seasonal restriction																									
<ul style="list-style-type: none"> <li>Typically October 1 – June 30</li> </ul>																									
<b>Culvert Installation and Removal *</b>																									
<ul style="list-style-type: none"> <li>Rd. Nos. 14-1-34 and 15-1-2</li> <li>October 16 – May 31</li> <li>All other Rds. September 1 – July 14</li> </ul>																									
<b>Wildlife Seasonal Restrictions</b>																									
<u>Partial Harvest Area No. 3</u>																									
<ul style="list-style-type: none"> <li>March 1 – July 15, both days inclusive <ul style="list-style-type: none"> <li>Falling, Bucking, Yarding, Loading, Hauling, and any road work</li> </ul> </li> </ul>																									

NOTE: This chart is for informational purposes only. Refer to Section 42 Special Provisions of the timber sale contract for exact date restrictions and specifications. Subject to transient winter snow, elevation ranges from 600 – 3000 feet.





UNITED STATES  
DEPARTMENT OF THE INTERIOR  
BUREAU OF LAND MANAGEMENT

EXHIBIT "A"  
Sheet 1 of 4

SALE NAME: NORTH LINE TIMBER SALE CONTRACT NO.: ORE06-TS13-657  
T.14 S., R.1 W., SEC. 25, WILL. MER., EUGENE DISTRICT

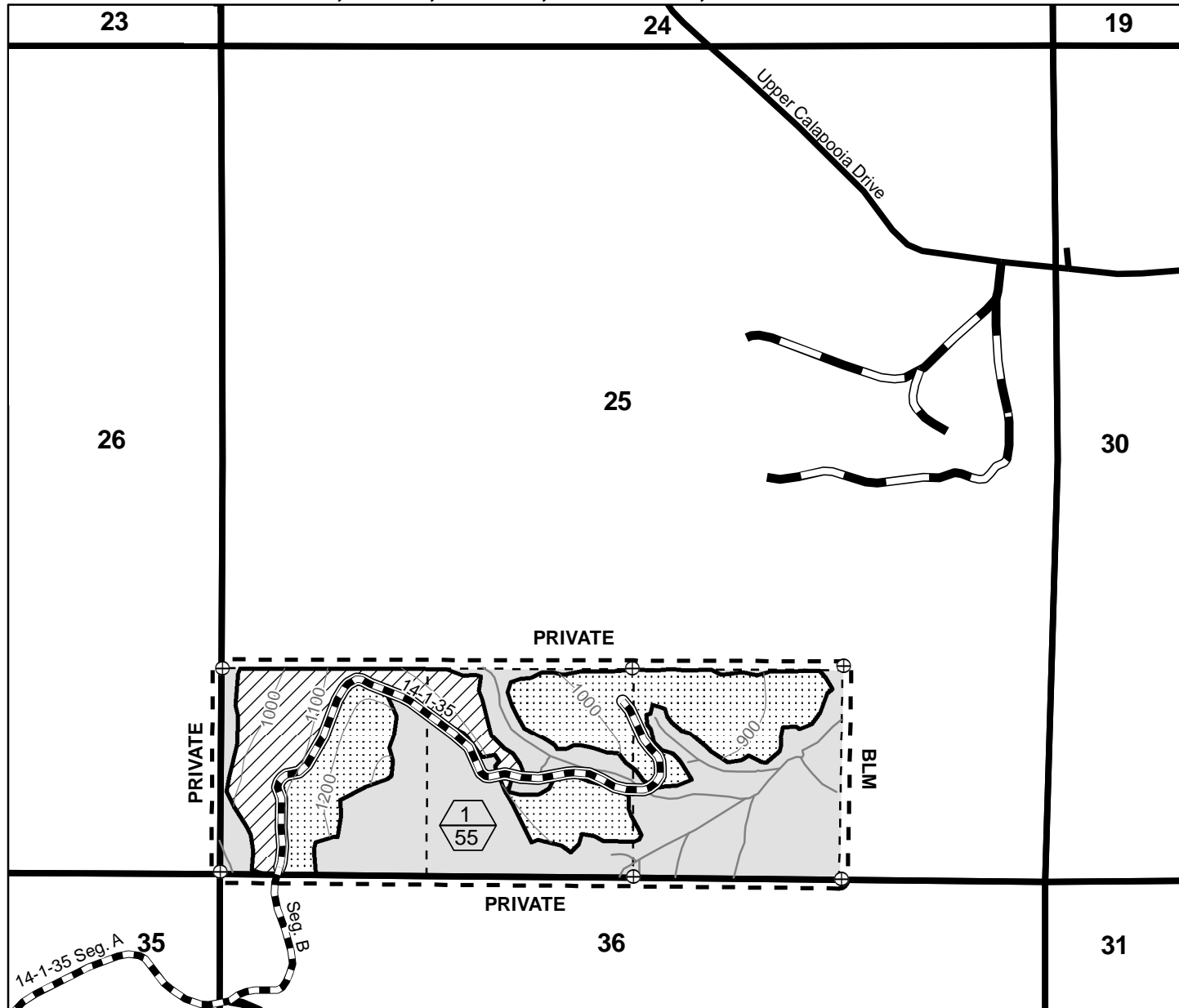

- Contract Area
- Partial Harvest Area - Blazed, Posted, Painted
- Partial Harvest Area - Ground Base
- Partial Harvest Area - Cable
- Right-of-Way ( Clear Cut )
- Reserve Area
- Section Line
- Stream
- Subdivisional Line
- Corner Found
- Unit Number (Top)
- Unit Acres (Bottom)
- Existing Road
- Road Renovation
- 100 Foot Contour
- County Road



0 500 1,000 Feet

1/8/2013

TOTAL FOR SECTION 25	
PARTIAL HARVEST AREA	55
RIGHT-OF-WAY (CLEAR CUT)	3
RESERVE AREA	62
CONTRACT AREA	120 ACRES

GRAND TOTAL FOR SECTIONS 25, 35, 1 and 11	
TOTAL PARTIAL HARVEST AREA	361
TOTAL RIGHT-OF-WAY (CLEAR CUT)	7
TOTAL RESERVE AREA	474.52
TOTAL CONTRACT AREA	842.52 ACRES

No warranty is made by the Bureau of Land Management as to the accuracy, reliability, or completeness of these data for individual or aggregate use with other data. Original data were compiled from various sources. This information may not meet National Map Accuracy Standards. This product was developed through digital means and may be updated without notification.

United States Department of the Interior  
Bureau of Land Management  
Oregon State Office  
P.O. Box 2965  
Portland, Oregon 97208-2965



UNITED STATES  
DEPARTMENT OF THE INTERIOR  
BUREAU OF LAND MANAGEMENT

EXHIBIT "A"  
Sheet 2 of 4

SALE NAME: NORTH LINE TIMBER SALE CONTRACT NO.: ORE06-TS13-657  
T.14 S., R.1 W., SEC. 35, WILL. MER., EUGENE DISTRICT

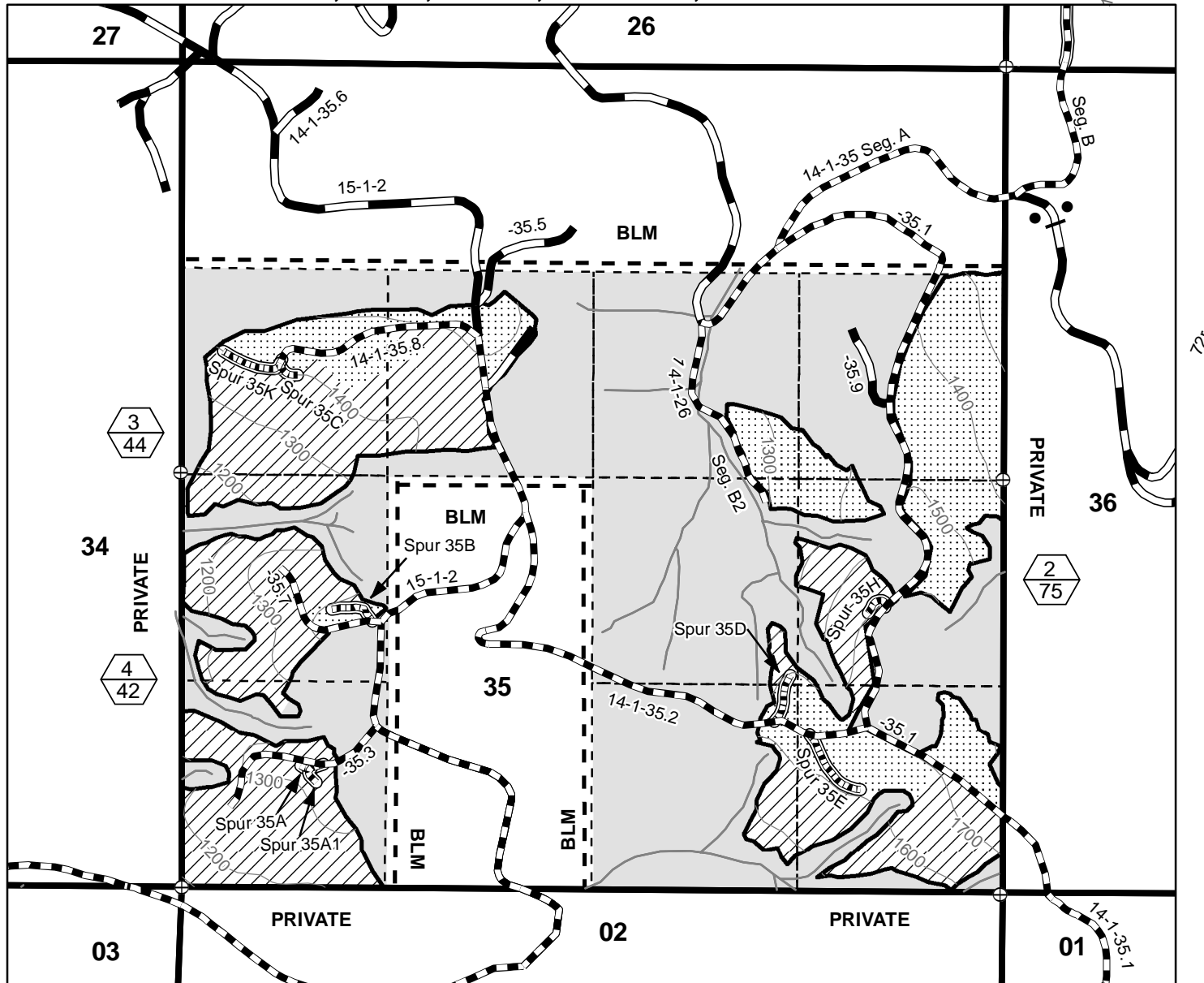

- Contract Area
- Partial Harvest Area - Blazed, Posted, Painted
- Partial Harvest Area - Ground Base
- Partial Harvest Area - Cable
- Reserve Area
- Section Line
- Right-of-Way ( Clear Cut )
- Corner Found
- Partial Harvest Area (Top)/ Partial Harvest Area Acres (Bottom)
- 100 Foot Contour
- Stream
- Subdivisional Line
- Existing Road
- Road Renovation
- New Construction - Rock Surface
- Gates



0 500 1,000 Feet

1/8/2013

TOTAL FOR SECTION 35	
PARTIAL HARVEST AREA	161
RIGHT-OF-WAY (CLEAR CUT)	2
RESERVE AREA	237
CONTRACT AREA	400 ACRES

No warranty is made by the Bureau of Land Management as to the accuracy, reliability, or completeness of these data for individual or aggregate use with other data. Original data were compiled from various sources. This information may not meet National Map Accuracy Standards. This product was developed through digital means and may be updated without notification.

United States Department of the Interior  
Bureau of Land Management  
Oregon State Office  
P.O. Box 2965  
Portland, Oregon 97208-2965



UNITED STATES  
DEPARTMENT OF THE INTERIOR  
BUREAU OF LAND MANAGEMENT

EXHIBIT "A"  
Sheet 3 of 4

SALE NAME: NORTH LINE TIMBER SALE CONTRACT NO.: ORE06-TS13-657  
T.15 S., R.1 W., SEC. 1, WILL. MER., EUGENE DISTRICT

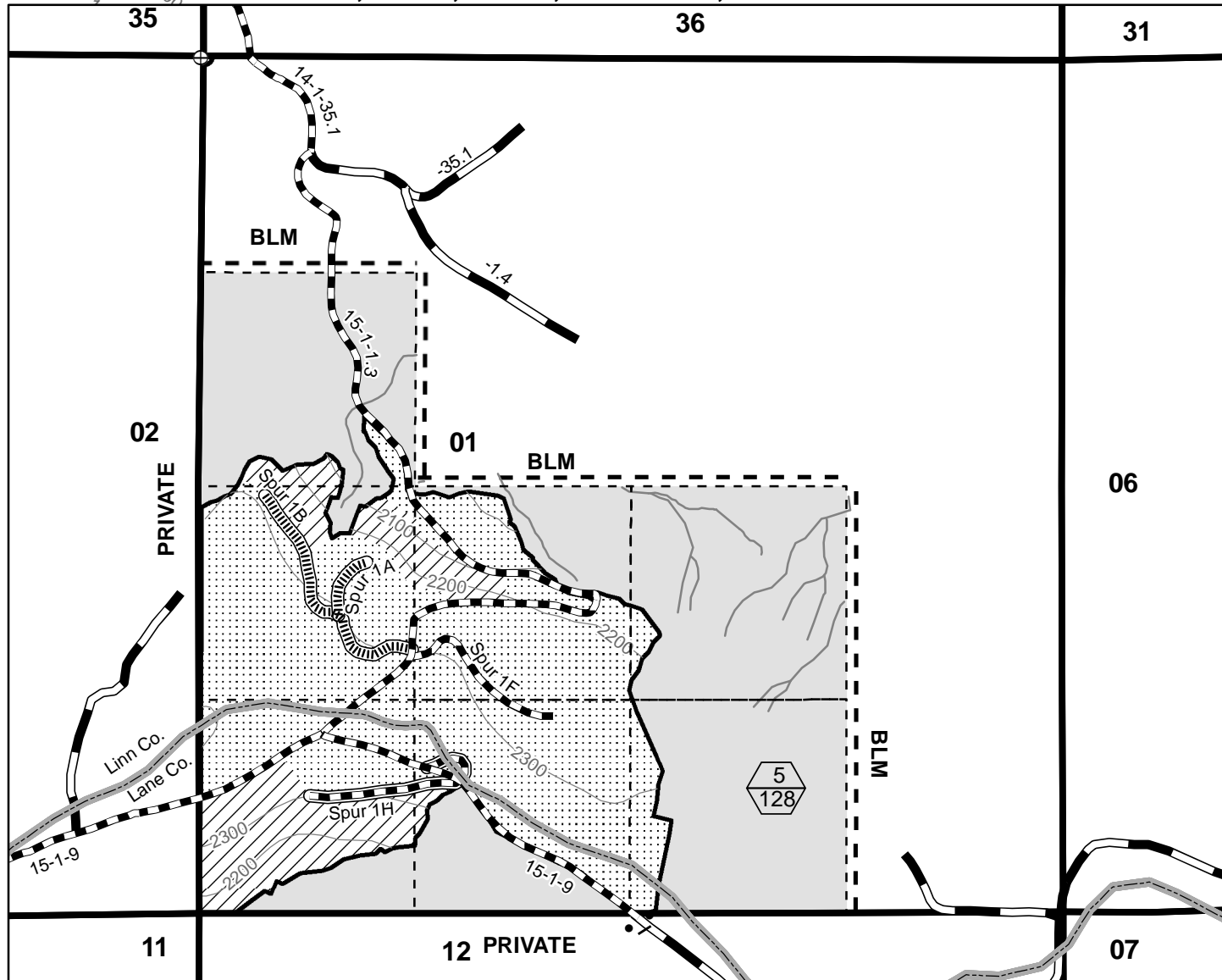

- Contract Area
- Partial Harvest Area - Blazed, Posted, Painted
- Partial Harvest Area - Ground Base
- Partial Harvest Area - Cable
- Reserve Area
- Section Line
- County Boundary
- Right-of-Way ( Clear Cut )
- Corner Found
- Partial Harvest Area (Top)/  
Partial Harvest Area Acres (Bottom)
- 100 Foot Contour
- Stream
- Subdivisional Line
- Road Renovation
- New Construction - Native Surface
- Existing Road
- Gate

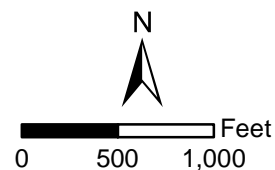

1/8/2013









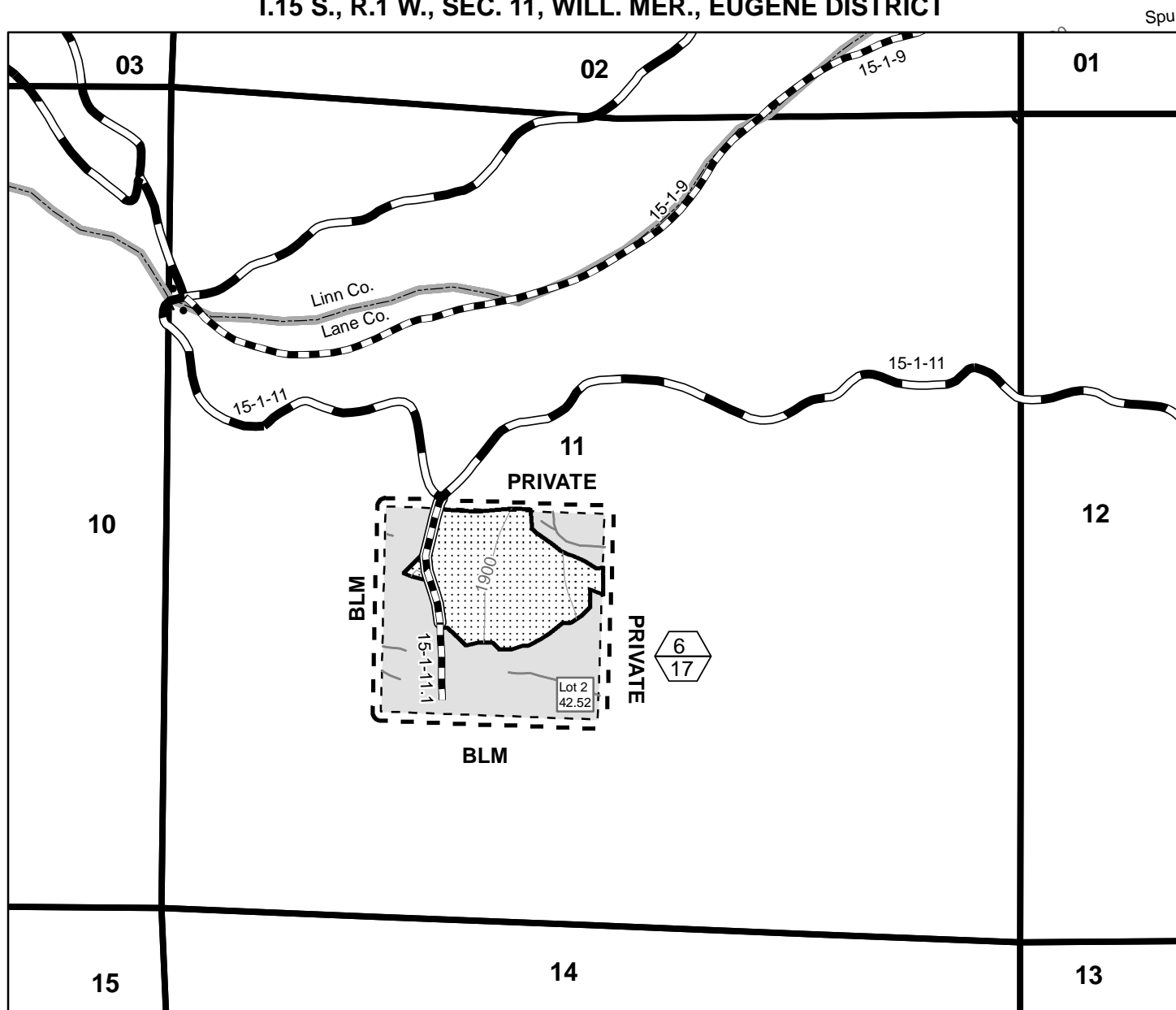







TOTAL FOR SECTION 1	
PARTIAL HARVEST AREA	128
RIGHT-OF-WAY (CLEAR CUT)	1
RESERVE AREA	151
CONTRACT AREA	280 ACRES

UNITED STATES  
DEPARTMENT OF THE INTERIOR  
BUREAU OF LAND MANAGEMENT

**EXHIBIT "A"**  
**Sheet 4 of 4**

**SALE NAME: NORTH LINE TIMBER SALE CONTRACT NO.: ORE06-TS13-657  
T.15 S., R.1 W., SEC. 11, WILL. MER., EUGENE DISTRICT**



- |  |  |   |                    |
|--|--|---|--------------------|
|  | Contract Area  |  | Stream             |
|  | Partial Harvest Area -<br>Blazed, Posted, Painted                  |  | Subdivisional Line |
|  | Partial Harvest Area - Ground Base                                 |  | Existing Road      |
|  | Partial Harvest Area - Cable                                       |  | Road Renovation    |
|  | Reserve Area   |  | Gates              |
|  | Section Line   |   |                    |
|  | County Boundary  |   |                    |
|  | Right-of-Way ( Clear Cut )   |   |                    |
|  | Corner Found   |   |                    |
|  | Partial Harvest Area (Top)/<br>Partial Harvest Area Acres (Bottom) |   |                    |
|  | 100 Foot Contour   |   |                    |



A horizontal number line with a black segment from 0 to 500 and a white segment from 500 to 1,000. The word "Feet" is at the right end.

1/8/2013

TOTAL FOR SECTION 11	
PARTIAL HARVEST AREA	17.00
RIGHT-OF-WAY (CLEAR CUT)	1.00
RESERVE AREA	<u>24.52</u>
CONTRACT AREA	42.52 ACRES

**UNITED STATES  
DEPARTMENT OF THE INTERIOR  
BUREAU OF LAND MANAGEMENT**

**EXHIBIT "A1"**  
**Sheet 1 of 4**

**SALE NAME: NORTH LINE TIMBER SALE CONTRACT NO.: ORE06-TS13-657**

**T.14 S., R.1 W., SEC. 25, WILL. MER., EUGENE DISTRICT**

## COARSE WOODY DEBRIS AND SNAG CREATION

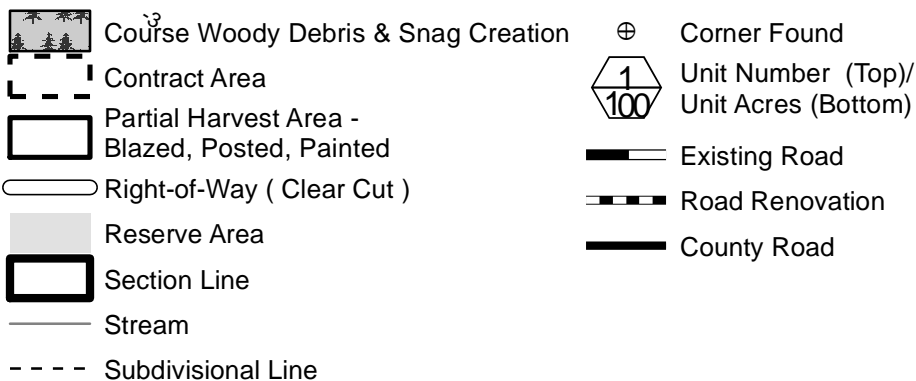
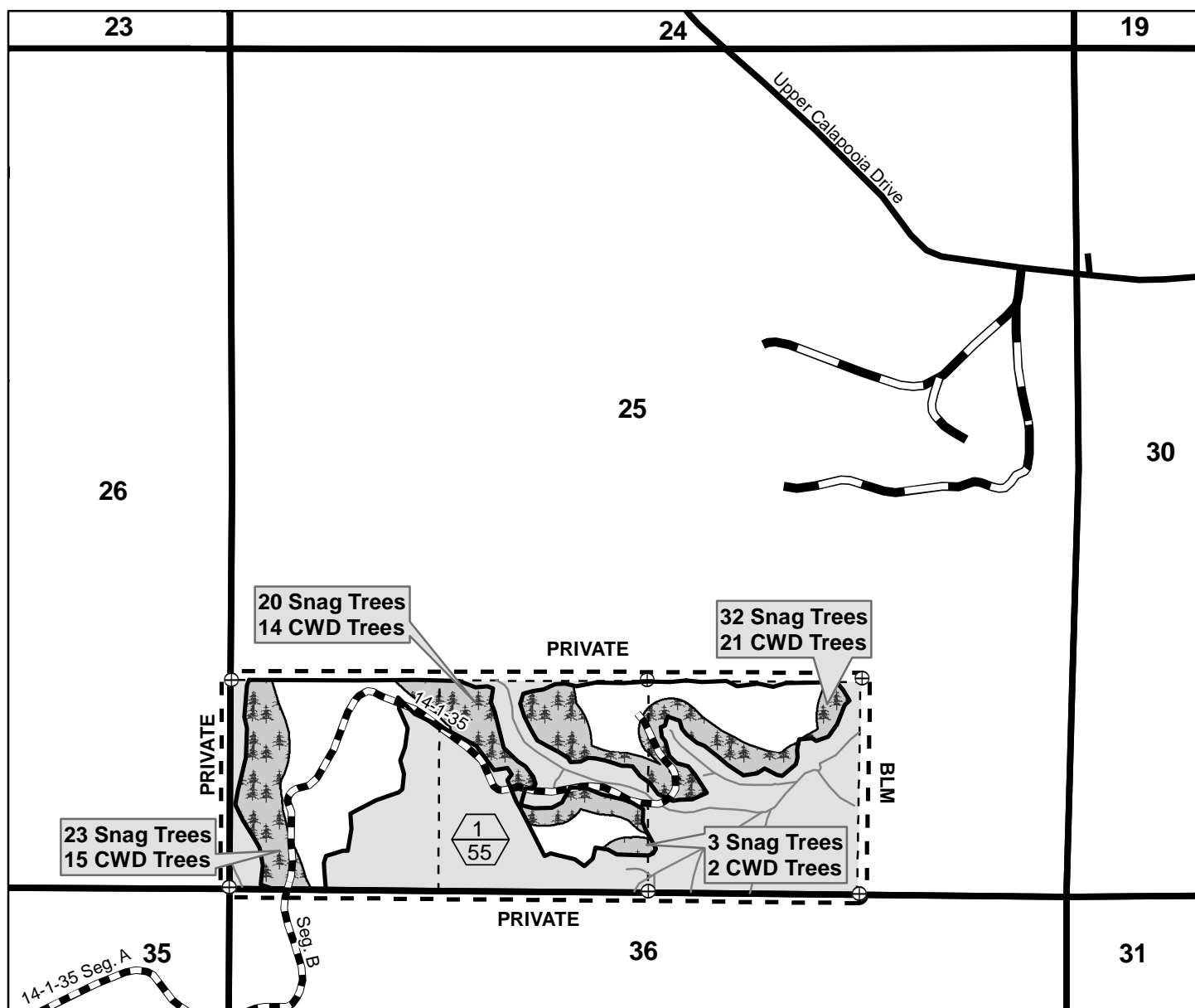

Treatment Acres	26
Total Snags	78
Total CWD	52



0 500 1,000 Feet

1/8/2013





UNITED STATES  
DEPARTMENT OF THE INTERIOR  
BUREAU OF LAND MANAGEMENT

EXHIBIT "A1"  
Sheet 3 of 4

SALE NAME: NORTH LINE TIMBER SALE CONTRACT NO.: ORE06-TS13-657  
T.15 S., R.1 W., SEC. 1, WILL. MER., EUGENE DISTRICT

COARSE WOODY DEBRIS AND SNAG CREATION

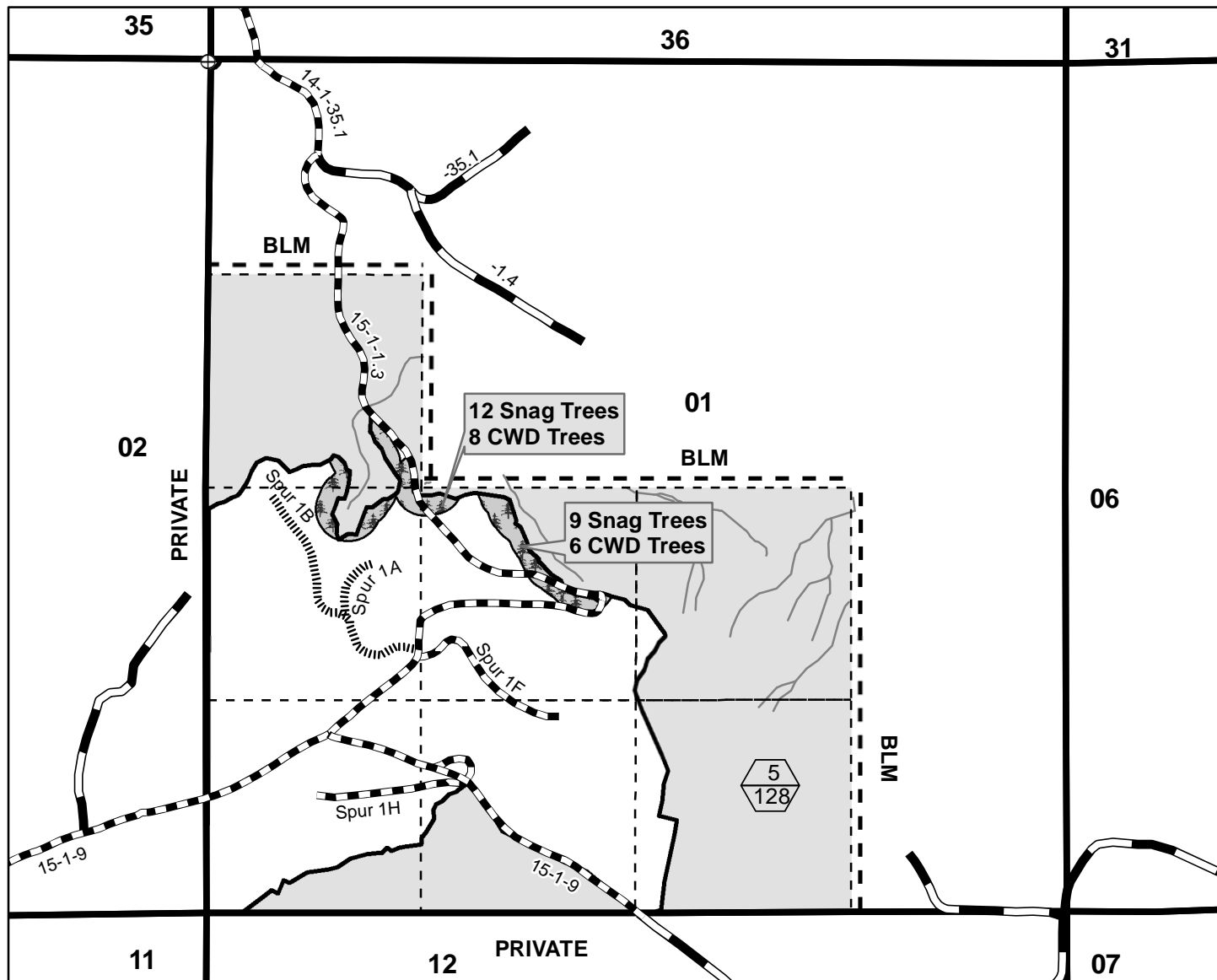

Coarse Woody Debris & Snag Creation



Contract Area



Partial Harvest Area -  
Blazed, Posted, Painted



Reserve Area



Section Line



Right-of-Way ( Clear Cut )



Corner Found



Unit Number (Top)/  
Unit Acres (Bottom)

Stream

Subdivisional Line

Road Renovation

New Construction - Native Surface

Existing Road

Treatment Acres	7
Total Snags	21
Total CWD	14



0 500 1,000 Feet

1/8/2013





UNITED STATES  
DEPARTMENT OF THE INTERIOR  
BUREAU OF LAND MANAGEMENT

EXHIBIT "A1"  
Sheet 4 of 4

SALE NAME: NORTH LINE TIMBER SALE CONTRACT NO.: ORE06-TS13-657  
T.15 S., R.1 W., SEC. 11, WILL. MER., EUGENE DISTRICT  
COARSE WOODY DEBRIS AND SNAG CREATION

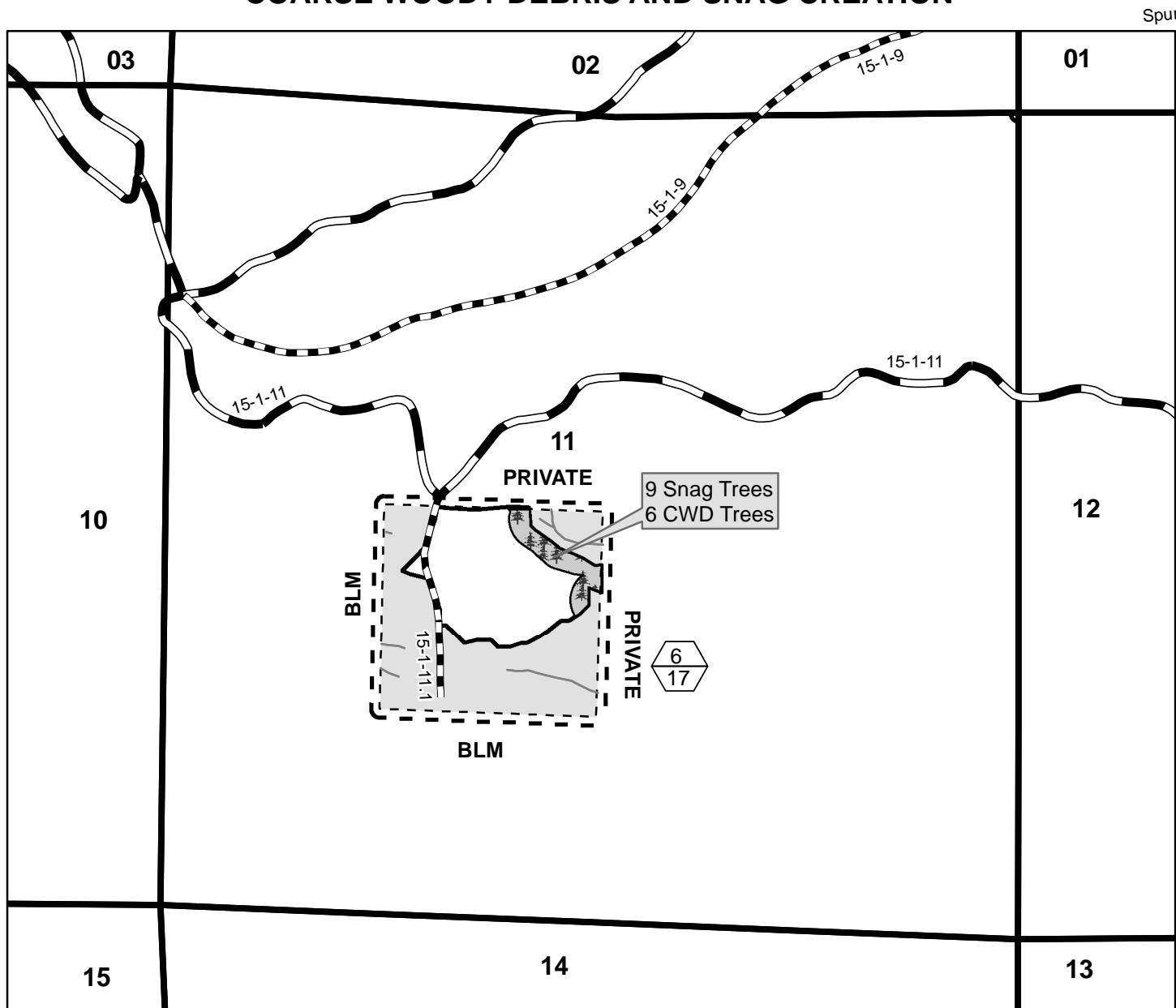

- Coarse Woody Debris & Snag Creation
- Contract Area
- Partial Harvest Area - Blazed, Posted, Painted
- Reserve Area
- Section Line
- Right-of-Way ( Clear Cut )
- Corner Found
- Unit Number (Top)/ Unit Acres (Bottom)
- Stream
- Subdivisional Line
- Existing Road
- Road Renovation

Treatment Acres	3
Total Snags	9
Total CWD	6



0 500 1,000 Feet

1/8/2013



EUGENE DISTRICT  
UPPER WILLAMETTE RESOURCE AREA

PARCEL NO.: 2  
SALE DATE: February 14, 2013

Tract No. E-12-656 Good Chance  
Lane (other) County, Oregon: O&C

Bid Deposit Required: \$7,400.00

All timber designated for cutting on NW1/4, N1/2SW1/4, Section 9,  
NW1/4SW1/4, S1/2SW1/4, Section 21, T. 16 S., R. 1 W., Will. Mer.

Estimated Volume 32' Log (MBF)	Species	Estimated Volume 16' Log (MBF)	Appraised Price Per MBF	Estimated Volume Times Approx. Price
538	Douglas-fir	592	\$ 123.00	\$ 72,816.00
21	Western hemlock	23	\$ 48.00	1,104.00
559	TOTALS	615		\$ 73,920.00

APPRAISED PRICES are calculated by determining market value through the analytical appraisal method. The minimum bid increment will be \$0.10 per MBF or multiples thereof.

LOG EXPORT RESTRICTIONS: All timber offered for sale hereunder is restricted from export from the United States in the form of unprocessed timber and is prohibited from being used as a substitute for exported private timber.

NOTE: The volume for this timber sale has been calculated using 16 foot eastside Scribner rules, and the 32 foot log volumes and the cubic log volumes are estimates derived from the 16 foot volumes.

CRUISE INFORMATION: Volume for Douglas-fir in Partial Harvest Area No. 1 was variable plot cruised. The Partial Harvest Area contains a total of 178 plots and 47 randomly selected sample trees. The tree count was determined with a Relaskop using a 20 BAF. Sample trees were randomly selected and volume expanded to a total Partial Harvest Area volume in 16-foot lengths using the **National Cruise Processing Program**. A map showing the location of the sample trees is available at the Eugene District Office.

Volume for Douglas-fir and Western Hemlock in Partial Harvest Area No. 2 has been cruised using the 3P system to randomly select 66 sample trees. The sample trees have been cruised and the volume computed using the **National Cruise Processing Program** for estimating volume in 16 foot lengths and the volume expanded to a total Partial Harvest Area volume. A map showing the location and description of these sample trees is available at the Eugene District Office.

With respect to merchantable Douglas-fir (sample) trees: The average tree is 10.3" DBHOB; the average log contains 29 bd. ft.; the total gross merchantable volume is approximately 598 MBF; and 99% recovery is expected.

CUTTING AREA: Two areas totaling approximately 107 acres must be partial harvested.

ACCESS: Access to the sale is provided by:

1. Public roads;
2. BLM existing roads;
3. Roads covered by a Right-of-Way and Road Use Agreement No. E-662 between Weyerhaeuser Company and the United States. In the use or renovation of private roads, the Purchaser shall enter into a license agreement with Weyerhaeuser Company. The license agreement shall be delivered to Weyerhaeuser Company for execution at least 15 days prior to any use of company roads. See the Prospectus for full terms and conditions of use.

ROAD MAINTENANCE: The Purchaser shall pay Weyerhaeuser Company road use fees of \$450.00. In addition, the Purchaser shall either maintain the Weyerhaeuser owned roads and pay Weyerhaeuser rockwear fees estimated at \$9.95, or Weyerhaeuser will maintain their roads and the Purchaser shall pay both road maintenance and rockwear fees to Weyerhaeuser estimated at \$120.16. The Purchaser shall pay BLM road maintenance fees of \$126.95 and rockwear fees of \$280.84. See Exhibit D map for specification of road maintenance responsibility. Only the map pages of Exhibit D are included in the Prospectus. Refer to the contract file for the full Exhibit D.

\*In addition to the quantities shown below, 100 CY (truck measure) of 1-1/2" minus maintenance rock is required.

ROAD CONSTRUCTION: N/AROAD RENOVATION: Required

Suggested Rock Source: Commercial, Springfield Vicinity

Rock surface: Road Nos. 16-1-9.3, 16-1-9.4, 16-1-9.6, &amp; 16-1-21

Class: SN-16

Length: 128.83 Stations (Rock surface)

Surfacing: 1-1/2" minus (Culvert Replacements Only)

Width: 14'-16'

Compacted Depth: 8" (Culvert Replacements Only)

Estimated Quantities (truck measure): 3/4" minus: 120 CY

1-1/2" minus: 30 CY

Class 3 Riprap: 20 CY

Culverts:		
Diameter:	Length:	Number:
18" CPP	60'	2
24" CPP	210'	6

Total estimated renovation cost: \$15,951.63

Special Requirements in Road Renovation: Culvert removal and replacement/installation on streams shall be done between June 1 and October 31 (both days inclusive).

ROAD DECOMMISSIONING: N/A

DURATION OF CONTRACT: Duration of the contract will be 36 months for cutting and removal of timber.

SPECIAL PROVISIONS: The contract will contain special provisions regarding road renovations, road maintenance, logging methods, prevention of erosion, logging residue reduction, submission of a written logging plan specifying landing locations, logging methods, and logging schedule.

It is estimated that 30 MBF additional timber, such as skid trail trees, or guyline trees, may be removed under the contract, but is not included in the advertised sale volume, nor is it included in the timber sale appraisal.

**This sale is being offered as a 100% groundbased yarding timber sale. If the Purchaser elects to cable yard any portion of the contract area a modification of the contract will be required and all standard cable yarding stipulations will apply.**

OTHER SPECIAL REQUIREMENTS:

1. The Purchaser shall be required to clean logging, road renovation, and decommissioning equipment to remove dirt and plant debris that may contain noxious weed seeds from the under carriage, tracks and tire treads prior to entry on BLM lands.
2. Two Douglas-fir Superior trees marked with a band of yellow and/or orange paint in the Approximate Location of the Superior Tree are reserved.
3. No felling or skidding shall be conducted on the Partial Harvest Areas during sap flow from April 1 to June 15 of each year, both days inclusive, unless otherwise approved by the Authorized Officer.
4. Piling, covering and burning of slash is required on all landings and within 25 feet of Road Nos. 16-1-5.3, 16-1-9.3, 16-1-9.4, and 16-1-9.6 on the portions of the harvest areas as directed by the Authorized Officer.

OPTIONAL CONTRIBUTION: The Purchaser will have the option of performing slash pile burning or contributing \$312.81 in lieu thereof. The option must be declared prior to contract execution. Piling and covering are not included in the Optional Contribution and will remain the responsibility of the Purchaser.

**If Purchaser elects to remove material instead of performing burning, and any pile burning is needed, there will be no refund of the optional contribution.**

NARRATIVE DESCRIPTION OF HOW TO GET TO THE TIMBER SALE AREA: Access to the sale is through several locked gates on roads which include segments of private ownership. Prospective bidders may obtain a key from the Eugene District Office. Any other persons interested in visiting the timber sale should first contact Brian Bickford at 541-683-6164.

For Partial Harvest Area No. 2, from Eugene proceed east on OR-126, take the 42nd Street exit towards Marcola. Travel north on 42nd Street, then east on Marcola Road. Proceed approximately 10 miles and turn east onto Wendling Road. Continue approximately 0.3 miles and head east onto Cartwright Creek Road. Proceed approximately 0.5 miles to gate then follow signs to the sale area.

For Partial Harvest Area No. 1, return to Marcola Road, continue north for 2.1 miles and turn east onto Paschelke Road. Continue through the covered bridge, take a slight left onto Road No. 16-1-5.3 and proceed for 1.1 miles to the gate on the right. Follow the signs to the sale area.



# TIMBER SALE LOCATION MAP

SALE NAME: Good Chance

T. 16 S., R. 1 W., SEC. 9, 21, WIL. MER., EUGENE DISTRICT

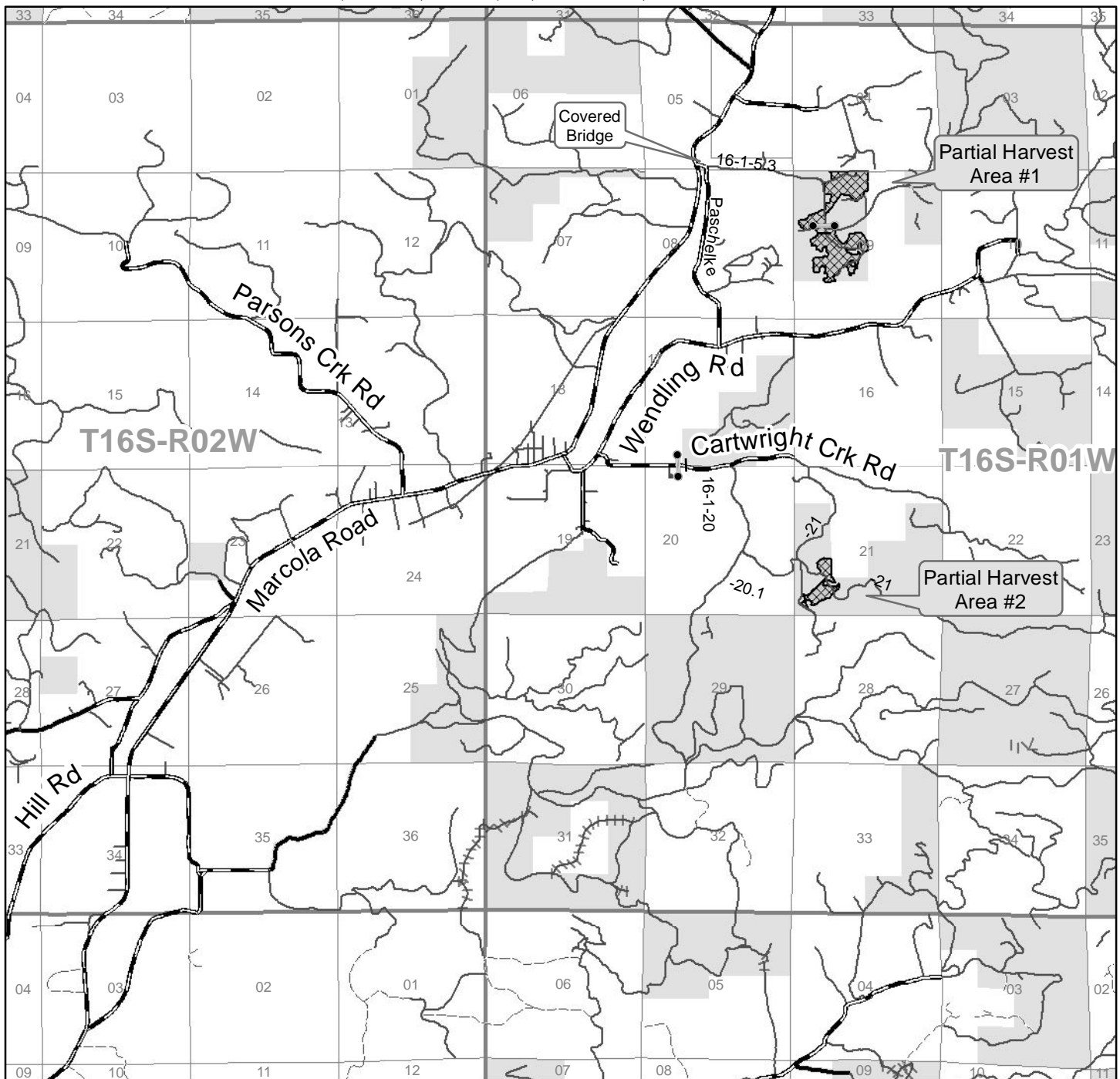

## NARRATIVE DESCRIPTION OF HOW TO GET TO THE TIMBER SALE AREA

For Partial Harvest Area No. 2, from Eugene proceed east on OR-126, take the 42nd Street exit towards Marcola. Travel north on 42nd Street, then east on Marcola Road. Proceed approximately 10 miles and turn east onto Wendling Road. Continue approximately 0.3 miles and head east onto Cartwright Creek Road. Proceed approximately 0.5 miles to gate then follow signs to the sale area.

For Partial Harvest Area No. 1, return to Marcola Road, continue north for 2.1 miles and turn east onto Paschelke Road. Continue through the covered bridge, take a slight left onto Road No. 16-1-5.3 and proceed for 1.1 miles to the gate on the right. Follow the signs to the sale area.

No warranty is made by the Bureau of Land Management as to the accuracy, reliability, or completeness of these data for individual or aggregate use with other data. Original data were compiled from various sources. This information may not meet National Map Accuracy Standards. This product was developed through digital means and may be updated without notification.



0 0.5 1 Miles

8/30/2012

United States Department of the Interior  
Bureau of Land Management  
Oregon State Office  
P.O. Box 2965  
Portland, Oregon 97208-2965

## Seasonal Restriction Matrix

Restricted Times are Shaded and X'd

	Jan		Feb		Mar		Apr		May		June		July		Aug		Sept		Oct		Nov		Dec	
	1	15	1	15	1	15	1	15	1	15	1	15	1	15	1	15	1	15	1	15	1	15	1	15
<b>Yarding (Sap flow)</b>																								
<u>Partial Harvest Area</u>																								
<ul style="list-style-type: none"> <li>April 1 – June 15, both days inclusive</li> <li>Sap flow restrictions may be conditionally waived at the discretion of BLM</li> </ul>																								
<b>Ground based yarding and decompacting</b>																								
<u>Partial Harvest Area</u>																								
<ul style="list-style-type: none"> <li>October 1 – June 30, may vary due to weather conditions; soil moisture still overrides weather conditions.</li> </ul>																								
<b>Culvert Installation and Removal</b>																								
<ul style="list-style-type: none"> <li>November 1 through May 31, both days inclusive.</li> </ul>																								

NOTE: This chart is for informational purposes only. Refer to Section 41 Special Provisions of the timber sale contract for exact date restrictions and specifications. Subject to transient winter snow, elevation ranges from 1000 – 2500 feet.



UNITED STATES  
DEPARTMENT OF THE INTERIOR  
BUREAU OF LAND MANAGEMENT

EXHIBIT "A"

Sheet 1 of 2

SALE NAME: GOOD CHANCE TIMBER SALE CONTRACT NO.: ORE06-TS13-656  
T. 16 S., R. 1 W., SEC. 9, WILL. MER., EUGENE DISTRICT

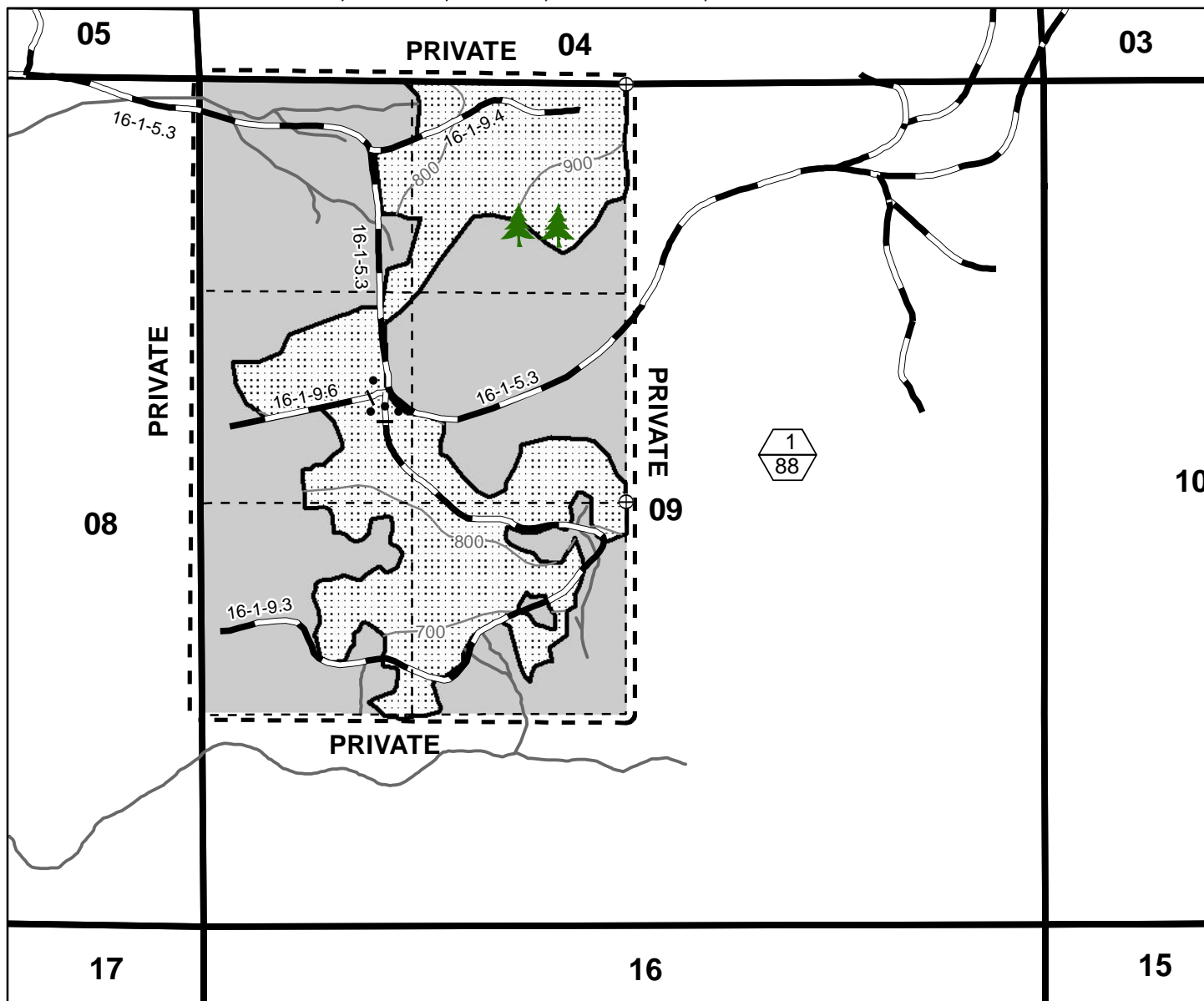

- |  |  |
|--|--|
| Partial Harvest Area - Groundbased             | Subdivisional Line                     |
| Partial Harvest Area - Blazed, Posted, Painted | Stream                                 |
| Reserve Area                                   | Existing Road                          |
| Section Line                                   | Approximate Location of Superior Tree  |
| 100' Contour                                   | Corner Found                           |
| Gate   | Unit Number (Top)/ Unit Acres (Bottom) |

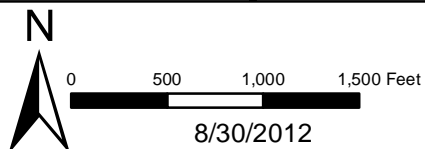

TOTAL FOR SECTION 9	
PARTIAL HARVEST AREA	88
RESERVE AREA	152
TOTAL CONTRACT AREA 240 ACRES	

GRAND TOTAL FOR SECTIONS 9 & 21	
TOTAL PARTIAL HARVEST AREA	107
TOTAL RESERVE AREA	253
TOTAL CONTRACT AREA 360 ACRES	

No warranty is made by the Bureau of Land Management as to the accuracy, reliability, or completeness of these data for individual or aggregate use with other data. Original data were compiled from various sources. This information may not meet National Map Accuracy Standards. This product was developed through digital means and may be updated without notification.

United States Department of the Interior  
Bureau of Land Management  
Oregon State Office  
P.O. Box 2965  
Portland, Oregon 97208-2965



UNITED STATES  
DEPARTMENT OF THE INTERIOR  
BUREAU OF LAND MANAGEMENT

EXHIBIT "A"  
Sheet 2 of 2

SALE NAME: GOOD CHANCE TIMBER SALE CONTRACT NO.: ORE06-TS13-656  
T. 16 S., R. 1 W., SEC. 21, WILL. MER., EUGENE DISTRICT

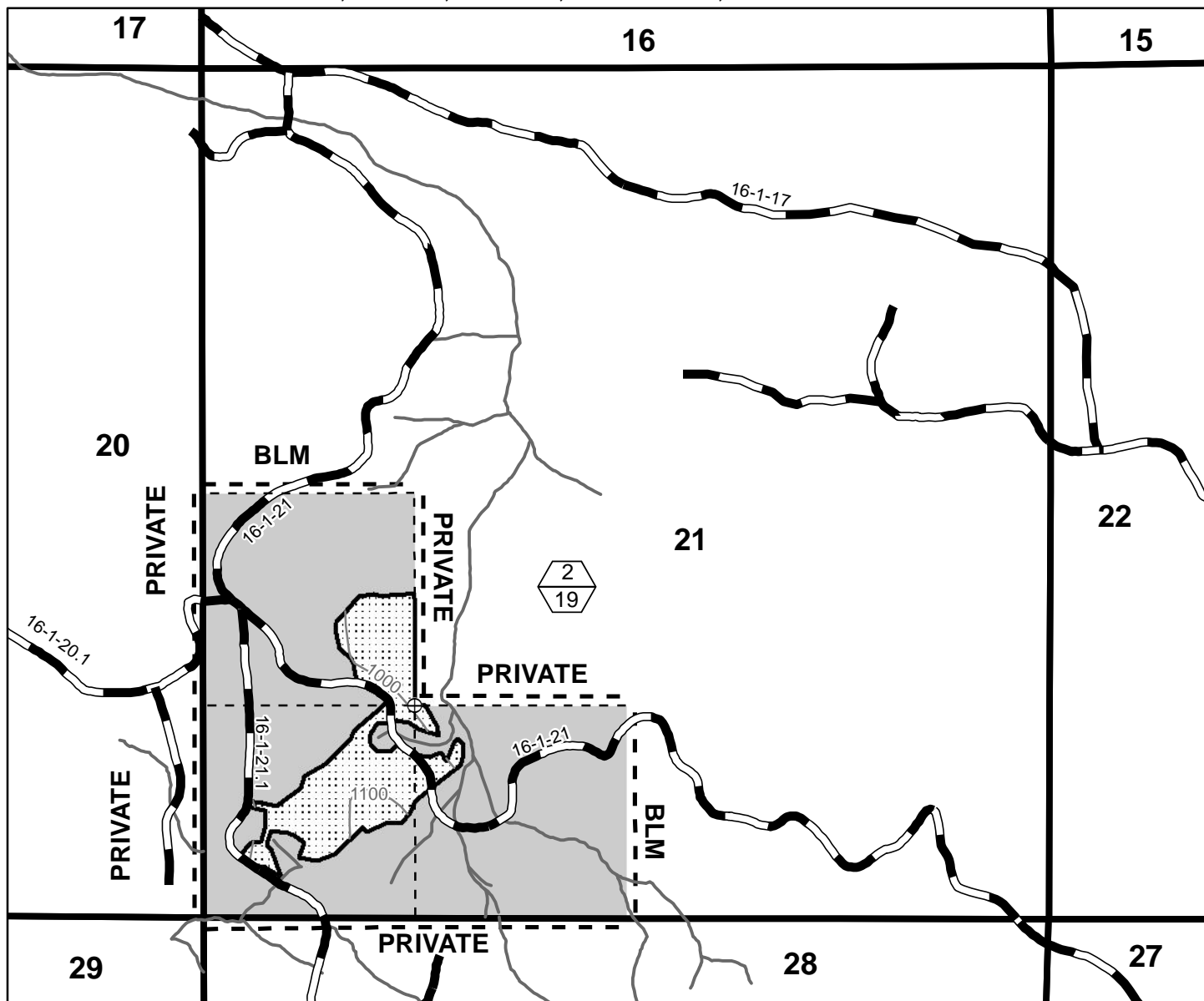

- Partial Harvest Area - Groundbased
- Partial Harvest Area - Blazed, Posted, Painted
- Reserve Area
- Section Line
- 100' Contour
- Subdivisional Line
- Stream
- Existing Road
- Corner Found
- Unit Number (Top)/ Unit Acres (Bottom)

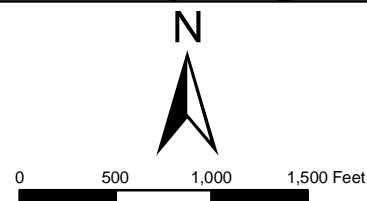

8/30/2012

TOTAL FOR SECTION 21	
PARTIAL HARVEST AREA	19
RESERVE AREA	101
TOTAL CONTRACT AREA 120 ACRES	

No warranty is made by the Bureau of Land Management as to the accuracy, reliability, or completeness of these data for individual or aggregate use with other data. Original data were compiled from various sources. This information may not meet National Map Accuracy Standards. This product was developed through digital means and may be updated without notification.

United States Department of the Interior  
Bureau of Land Management  
Oregon State Office  
P.O. Box 2965  
Portland, Oregon 97208-2965

UNITED STATES  
DEPARTMENT OF THE INTERIOR  
BUREAU OF LAND MANAGEMENT

NOTICE OF REQUIREMENT FOR CERTIFICATION  
OF NONSEGREGATED FACILITIES

Bidders and offerors are cautioned as follows: by signing this bid or offer or entering into this contract or lease, as the case may be, the bidder, offeror, or contractor will be deemed to have signed and agreed to the provisions of the Certification of Non-segregated Facilities in this solicitation. The certification provides that the bidder or offeror does not maintain or provide for his employees facilities which are segregated on a basis of race, color, religion, sex, or national origin, whether such facilities are segregated by directive or on a de facto basis. The certification also provides that he will not maintain such segregated facilities. Failure of a bidder or offeror to agree to the Certification of Nonsegregated Facilities will render his bid or offer nonresponsive to the terms of solicitations involving awards of contract exceeding \$10,000 which are not exempt from the provisions of the Equal Opportunity clause.

---

In accordance with 41 CFR 60, as amended May 19, 1967, and Executive Order No. 11246 of September 24, 1965, as amended, this notification will be included in all notices of invitations for bid, lease, offers, and requests for proposal where prospective nonexempt contracts may exceed \$10,000.