



# United States Department of the Interior

## BUREAU OF LAND MANAGEMENT

Eugene District Office

P.O. Box 10226

Eugene, Oregon 97440-2226

IN REPLY REFER TO:

5430A

To: Eugene District Office

Attn: Cynthia L. Phillips, Siuslaw Resource Area (541) 683-6776  
Terry Ray, Upper Willamette Resource Area (541) 683-6417  
Debra Wilson, Eugene District (541) 683-6798

### PROSPECTUS REQUEST

Please send the following information for the timber sales to be sold on **September 13, 2012**.  
(Check appropriate boxes)

Parcel No.	Sale Name	Prospectus	EXHIBITS AND APPRAISALS				
			Road			Slash Disposal	Other ( <i>indicate</i> )
			Construction	Maintenance	Decom-missioning		
1	Power Up						
2	Bickmore Creek						
3	Schaffer Road						

Mail to:

---

---

---

---

Requested by: \_\_\_\_\_



# United States Department of the Interior

## BUREAU OF LAND MANAGEMENT

Eugene District Office  
P.O. Box 10226  
Eugene, Oregon 97440-2226

IN REPLY REFER TO:  
5430A

August 15, 2012

**This advertisement includes:**

**Parcel No. 1 – Power Up**  
**Parcel No. 2 – Bickmore Creek**  
**Parcel No. 3 – Schaffer Road**

### TIMBER SALE NOTICE

**NOTICE IS HEREBY GIVEN** that the Bureau of Land Management will offer for sale timber as described herein for oral auction, pursuant to Instructions to Bidders, as stated on Form No. 5440-9 and subject to Notice of Requirement for Certification of Nonsegregated Facilities, Form No. 1140-4, attached. Written and oral bids will be received by the District Manager, or her representative, at the **EUGENE DISTRICT OFFICE, 3106 PIERCE PARKWAY, SPRINGFIELD, OREGON**. The timber sale will commence at 10:00 a.m. on Thursday, **September 13, 2012**.

A revised Special Provision has been added to the contract which enables the Contracting Officer to suspend the contract to facilitate protection of certain plant or animal species, and /or to modify or terminate the contract when necessary to:

1. Comply with the Endangered Species Act, or;
2. Comply with a court order, or;
3. Protect occupied marbled murrelet sites in accordance with the Standards and Guidelines of the Eugene District Record of Decision (ROD) and Resource Management Plan (RMP), or;
4. Protect species which were identified for protection through survey and manage and/or protection buffer standards and guidelines established in the ROD and RMP.

This contract provision limits the liability of the Government to the actual costs incurred by the Purchaser which have not been amortized by timber removed from the contract area.

This Timber Sale Notice does not constitute the decision document for purposes of protest and appeal of a forest management decision. Consistent with 43 CFR Subpart 5003 - Administrative Remedies, the notice of a timber sale, when published as a legal ad in a newspaper of general circulation shall constitute the decision document for purposes of protest and appeal. Protests may be filed with the Contracting Officer within 15 days of the publication of the aforementioned decision document in the newspaper. It is anticipated that the decision document will be published in The Register-Guard newspaper on or about September 13, 2012. BLM does not warrant publication on this exact date. All parties considering protest of the timber sale decision document are encouraged to review the aforementioned newspaper to ensure accurate knowledge of the exact publication date.

**A WRITTEN BID** on Form 5440-9 at not less than the appraised price on a unit basis per species and the required minimum bid deposit shall be required to participate in oral bidding for each tract.

**THE SUCCESSFUL BIDDER**, as a condition of award, will be required to complete and/or sign the following forms:

1. Form 1140-6, a certification that the bid was arrived at by the bidder or offerer independently, and was tendered without collusion with any other bidder or offerer.
2. Form 1140-7, Equal Opportunity Affirmative Action Program Representation, for all contracts over \$10,000.
3. Form 1140-8, Equal Opportunity Compliance Report Certification.
4. Form 5450-17, Export Determination.

**PRE-AWARD QUALIFICATIONS.** The high bidder may be required to furnish information to determine the ability to perform the obligations of the contract. If the high bidder is determined not qualified, not responsible or refuses to respond within 15 days of a request for information pertaining to qualifications, the contract may be offered and awarded for the amount of the high bid to the highest of the bidders who is qualified, responsible, and willing to accept the contract.

**A PERFORMANCE BOND** in an amount not less than 20 percent of the total purchase price will be required for all contracts of \$2,500 or more, but the amount of the bond shall not be in excess of \$500,000, except when the Purchaser opts to increase the minimum bond as provided in 43 CFR 5451.2. A minimum performance bond of not less than \$500 will be required for all installment contracts less than \$2,500.

**INSTALLMENT PAYMENTS** may be authorized for sales of \$500 or more. Required installments will be determined by BLM. For sales under \$500,000, installments will not be less than 10% of the total purchase price. For sales of \$500,000 or more, installment payments shall be \$50,000.

**LOG EXPORT AND SUBSTITUTION.** All timber sales, including timber from Federal rights-of-ways, shall be subject to the restrictions relating to the export and substitution of unprocessed timber from the United States in accordance with P.L. 94-165 and 43 CFR 5400 and 5424, as amended.

**LOG EXPORT AND SUBSTITUTION RESTRICTIONS.** Excepting Port-Orford-cedar, all timber offered for sale hereunder is restricted from export from the United States in the form of unprocessed timber and is prohibited from being used as a substitute for exported private timber.

The BLM has revised the log export restrictions special provision to reduce the log branding and painting requirements. The new requirements include branding of one end of all logs with a scaling diameter of over 10 inches. All loads of 11 logs or more, regardless of the diameter of the logs, will have a minimum of 10 logs branded on one end. All logs will be branded on loads of 10 logs or less. One end of all branded logs will be marked with yellow paint. At the discretion of the Contracting Officer, the Purchaser may be required to brand and paint all logs. The Purchaser shall bear any increased costs for log branding and painting.

**ADDITIONAL INFORMATION** concerning each timber sale tract described herein is available at the above District Office. A copy of the timber sale contract is also available for inspection at the District Office. This prospectus includes maps and tables that cannot be made Section 508 compliant. For help with its data or information, please contact the Eugene District Office at 541-683-6798.

**THE VOLUMES LISTED** herein are estimates only, based on 16-foot taper breaks, which must be taken into consideration if comparisons are made with volume predictions based on other standards. The volumes based on 32-foot taper breaks are shown for comparison purposes. No sale shall be made for less than the total purchase price, without regard to the amount bid per unit, even though quantity of timber actually cut or removed or designated for taking is more or less than the estimated volume or quantity so listed.

**AN ENVIRONMENTAL ASSESSMENT** was prepared for the Bickmore Creek sale, and a Finding of No Significant Impact has been documented. These documents are available for inspection as background for this sale at the Eugene District Office.

**ENVIRONMENTAL ANALYSES** were prepared for the Upper Siuslaw Landscape Plan Project, which includes portions of the Schaffer Road sale area, and for the Long Tom Landscape Plan Project, which includes the Power Up sale area and portions of the Schaffer Road sale area. A Finding of No Significant Impact and Decision Record for each EA have been documented. A Determination of NEPA Adequacy (DNA) has been documented for both of these sales. These documents are available for inspection as background for these sales at the Eugene District Office.

**ACCESS** to a sale may be through a locked gate (see individual sale information). Prospective bidders may obtain a key from the Eugene District Office. Any other persons interested in visiting the timber sale site should first contact the District Office at 683-6600.

Attachments:

- Form 5440-9
- Form 1140-4
- Form 1140-6
- Form 5450-22
- Form 5430-1

EUGENE DISTRICT  
SIUSLAW RESOURCE AREA

PARCEL NO.: 1  
SALE DATE: September 13, 2012

Tract No. E-13-503 Power Up  
Lane County, Oregon: O&C

Bid Deposit Required: \$21,200.00

All timber designated for cutting on: Lot 1; S1/2NE1/4; E1/2NW1/4; SE1/4, Section 7; N1/2NW1/4; SW1/4NW1/4, Section 17, T. 18 S., R. 6 W., Will. Mer.

Estimated Volume 32' Log (MBF)	Estimated Volume (CCF)	Species	Estimated Volume 16' Log (MBF)	Appraised Price Per MBF	Estimated Volume Times Approx. Price
1,539	3,041	Douglas-fir	1,737	\$ 118.00	\$ 204,966.00
87	181	Western hemlock	98	\$ 63.00	6,174.00
1,626	3,222	TOTALS	1,835		\$ 211,140.00

APPRAISED PRICES are calculated by determining market value through the analytical appraisal method. The minimum bid increment will be \$0.10 per MBF or multiples thereof.

LOG EXPORT RESTRICTIONS: All timber offered for sale hereunder is restricted from export from the United States in the form of unprocessed timber and is prohibited from being used as a substitute for exported private timber.

NOTE: The volume for this timber sale has been calculated using 16 foot eastside Scribner rules, and the 32 foot log volumes and the cubic log volumes are estimates derived from the 16 foot volumes.

CRUISE INFORMATION: Volume for all species have been cruised using the 3P system to select sample trees. A portion of the sample trees have been cruised and the volume computed using the **National Cruise Processing Program** for estimating volume in 16-foot lengths and the volume expanded to a total sale volume. A map showing the location and description of these sample trees is available at the Eugene District Office.

With respect to merchantable Douglas-fir (sample) trees: The average tree is 14.9" DBHOB; the average log contains 56 bd. ft.; the total gross merchantable volume is approximately 1,837 MBF; and 95% recovery is expected.

CUTTING AREA: Two areas totaling approximately 121 acres must be partial harvested and approximately 3 acres of right-of-way must be clear cut.

ACCESS: Access to the sale is provided by:

1. A public road;
2. BLM existing roads;
3. BLM roads to be constructed;
4. Roads covered by Right-of-Way and Road Use Agreement E-308 between Rosboro, LLC and the United States. In the use of private roads, the Purchaser shall enter into a license agreement with Rosboro, LLC. The license agreement shall be delivered to Rosboro, LLC for execution at least 15 days prior to any use of company roads. See the Prospectus for full terms and conditions of use.
5. Roads covered by Right-of-Way and Road Use Agreement E-308 between Oxbow Timber 1, LLC, and the United States. In the renovation, improvement and use of private roads, the Purchaser shall enter into a license agreement with Oxbow Timber 1, LLC. The license agreement shall be delivered to Oxbow Timber 1, LLC, for execution at least 15 days prior to any use of company roads. See the Prospectus for full terms and conditions of use.

ROAD MAINTENANCE: The Purchaser shall pay road maintenance fees estimated at \$574.72 to Rosboro, LLC. The Purchaser shall pay rockwear fees estimated at \$1,104.02 to Oxbow Timber 1, LLC. The Purchaser shall pay BLM a rockwear fee of \$955.42. See Exhibit D map for specification of road maintenance responsibility. Only the map page of Exhibit D is included in the Prospectus. Refer to the contract file for the full Exhibit D.

**ROAD CONSTRUCTION:** Required

Spurs A-G and Road Nos. 18-6-7.5 Ext. and 18-6-18.7 Ext.

Class: SN-14

Length: 36+65 stations

Surfacing: 6" (jaw run)

Width: 12'

Compacted Depth: 8"

Estimated Quantity: 1,784 CY (truck measure)

Total estimated excavation: 42 hours of tractor time.

Total estimated construction cost: \$58,941.21, including \$30,961.78 surfacing

Special Requirements in Road Construction: Operations limited to periods of dry weather.

Suggested Rock Source:

Commercial, Noti Vicinity

**ROAD RENOVATION:** Required

Road Nos: 18-6-7, -7.2, -7.5, -8.1 (portion), -18.6, -18.7, -18.8, -18.12

Class: SN-14

Length: 221+45 stations

Surfacing: N/A

Culvert Re-surfacing: 1-1/2" minus, 27 cu. yds. (truck measure)

Culvert Bedding: 3/4" minus, 106 cu. yds. (truck measure)

Slope Protection: Rip-rap, 16 cu. yds. (truck measure)

Total estimated renovation cost: \$17,632.43 including \$6,272.87 for surfacing and \$2,161.84 for drainage

Special Requirements in Road Renovation: Operations limited to periods of dry weather.

Suggested Rock Source:

Commercial, Noti Vicinity

Culverts:Diameter:Length:Number:

18"

122'

4

**ROAD IMPROVEMENT:** Required

Road No. 18-6-8.1 (portion)

Class: SN-14

Length: 7+50 stations

Surfacing: hot mix asphalt

Width: 14'

Compacted Depth: 4"

Estimated Quantity: 252 tons

Total estimated improvement cost: \$26,457.04

Special Requirements in Road Improvement: Operations limited to periods of dry weather.

**DURATION OF CONTRACT:** Duration of the contract will be 36 months for cutting and removal of timber.**SPECIAL PROVISIONS:** The contract will contain special provisions regarding road construction, road renovation, road improvement, road maintenance, logging methods, prevention of erosion, falling of snags, logging residue reduction, and submission of a written logging plan specifying spur road locations, landing locations, logging methods, and logging schedule.

Under Sec. 25 of the timber sale contract, tractor logging will be prohibited during periods of excessive soil moisture. This will normally limit tractor logging to July, August and September.

It is estimated that approximately 101 MBF of additional timber, such as corridor and guyline trees, may be removed under the contract, but it is not included in the advertised sale volume, nor is it included in the timber sale appraisal.

**A revised Special Provision has been added to the contract which enables the Contracting Officer to allow the Purchaser to remove material from the Contract Area instead of disposing of slash by piling, covering, and burning.****OTHER SPECIAL REQUIREMENTS:**

- Approximately 19 trees are marked with yellow paint above and below breast height in the Approximate Location of Special Habitat Trees. These trees shall not be felled or damaged during logging operations.
- The Purchaser shall have the option to rock Spurs C, D and E at Purchaser's expense.
- Trees within 100 feet of the Power Line Right-of-Way shall be directionally felled away from the power lines, as directed by the Authorized Officer.

- Only hauling is permitted in the Power Line Right-of-Way.
- During the use of Road Nos. 18-6-8.1 and 18-6-7.2 north of the Power Line Right-of-Way, the roads shall not be blocked for more than 20 minutes. At close of business each day, the roads shall be cleared to allow emergency nighttime access by the Bonneville Power Administration.
- The Purchaser shall have the option to rock Spurs C, D and E at Purchaser's expense.
- Yarding shall be done with a carriage equipped skyline capable of yarding 1,600 feet slope distance in the Partial Harvest Areas on slopes greater than 35%.
- When yarding to Road Nos. 18-6-18.8 and 18-6-18.12, artificial anchors may be required.
- Upon completion of hauling, all decommissioning shall be completed during the dry season and as directed by the Authorized Officer. Decommissioning measures include:
  - Decompact skid trails and natural surfaced roads with decompaction equipment, such as a track mounted excavator.
  - Construct drainage dips, waterbars and/or lead-off ditches.
  - Place logging slash, where available, on decompacted skid trails and road prisms.
  - Block at entry points using stumps, slash and/or cull logs.
- The Exhibit F contains explicit instruction on requirements for equipment and personnel involved in pile burning.
- No slash burning shall occur on or near the Power Line Right-of-Way.

**OPTIONAL CONTRIBUTION:** The Purchaser will have the option of performing pile burning or contributing \$618.76 in lieu thereof. The option must be declared prior to contract execution. Piling and covering are not included in the Optional Contribution and will remain the responsibility of the purchaser.

**If the Purchaser has made a contribution and later elects to remove all of the slash required to be piled, covered, and burned, the contribution will be refunded.**

**NARRATIVE DESCRIPTION OF HOW TO GET TO THE TIMBER SALE AREA:** Access to the sale is through two locked gates over private roads. Prospective bidders may obtain a key from the Eugene District Office. Any other persons interested in visiting the timber sale site should first contact Christopher Finn at (541) 683-6421.

From Veneta, travel south on Territorial Highway approximately 0.6 mile to Bolton Hill Road. Turn west onto Bolton Hill Road and continue approximately 3 miles southwest to Vaughn Road (County Road 4335). Turn west and travel approximately 2 miles to Road No. 18-6-8. Turn south onto Road No. 18-6-8, proceed through the gate and travel approximately 0.4 mile to Road No. 18-6-8.1. Turn southwest onto Road No. 18-6-8.1 and follow the Timber Sale Area signs to the timber sale.

# TIMBER SALE LOCATION MAP

## Power Up

### Township 18 S., Range 6 W., Sections 7, 17

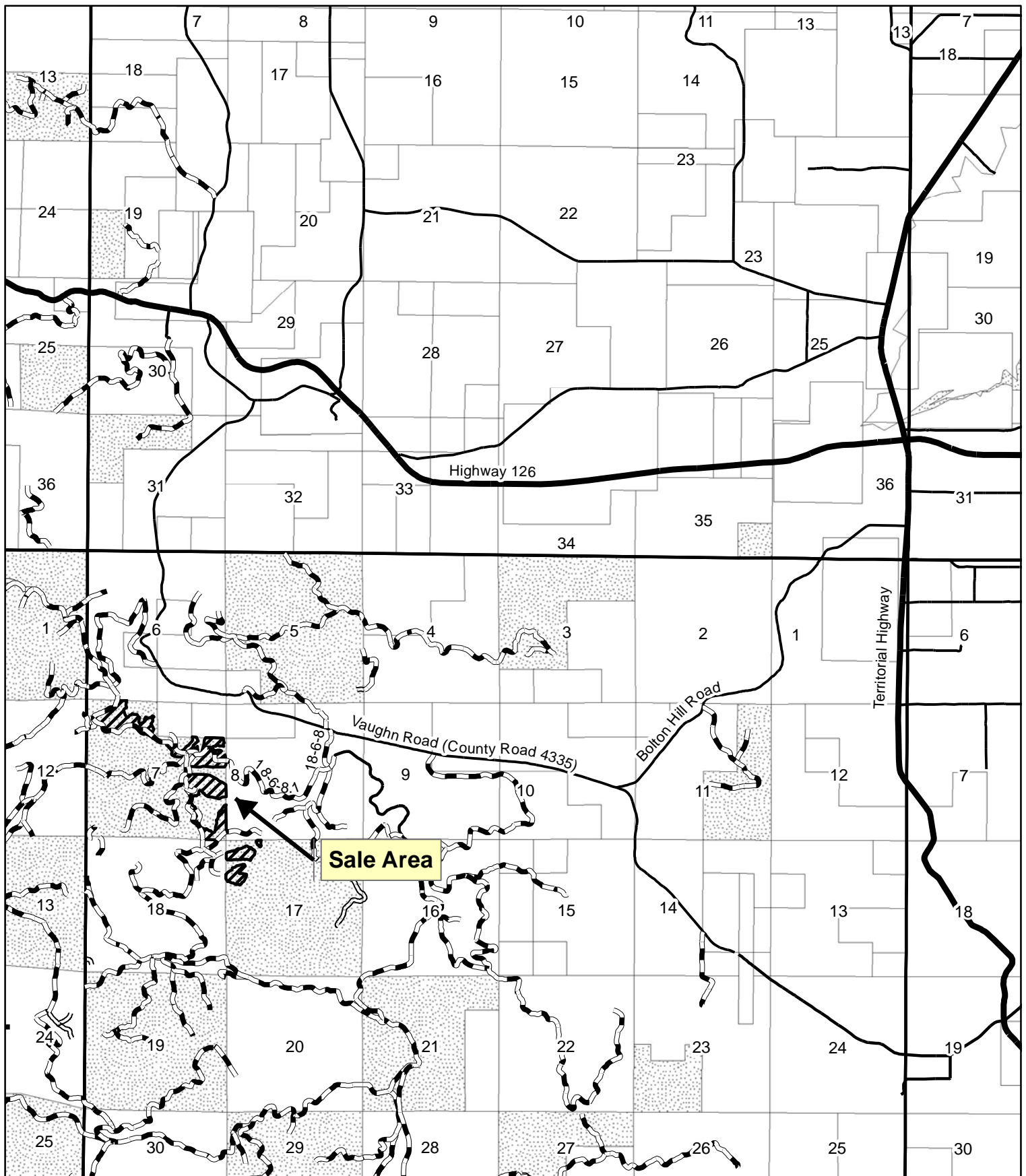

# Seasonal Restriction Matrix

Restricted Times are Shaded and X'd

	Jan		Feb		Mar		Apr		May		June		July		Aug		Sept		Oct		Nov		Dec	
	1	15	1	15	1	15	1	15	1	15	1	15	1	15	1	15	1	15	1	15	1	15	1	15
<b>Felling, yarding or loading</b>																								
<u>Partial Harvest Area</u>																								
<ul style="list-style-type: none"> <li>April 15 – June 15, both days inclusive</li> <li>Sap flow seasonal restriction may be conditionally waived</li> </ul>																								
<b>Ground-based yarding</b>																								
<u>Partial Harvest Area</u>																								
<ul style="list-style-type: none"> <li>Typically October 1 – June 30; may vary due to weather conditions</li> </ul>																								
<b>Right-of-way logging and clearing</b>																								
<u>Right-of-Way Area</u>																								
<ul style="list-style-type: none"> <li>Typically October 1 – May 31; may vary due to weather conditions</li> </ul>																								
<b>Hauling on natural surfaced roads</b>																								
<u>Partial Harvest Area</u>																								
<ul style="list-style-type: none"> <li>Typically October 15 – May 31; may vary due to weather conditions</li> </ul>																								

NOTE: This chart is for informational purposes only. Refer to Section 41 Special Provisions of the timber sale contract for exact date restrictions and stipulations.



DEPARTMENT OF THE INTERIOR  
BUREAU OF LAND MANAGEMENT

EXHIBIT A  
SHEET 1 OF 2

SALE NAME: POWER UP TIMBER SALE CONTRACT NO: ORE05-TS12-503

T. 18 S., R. 6 W., SEC. 7, WILL. MER., EUGENE DISTRICT

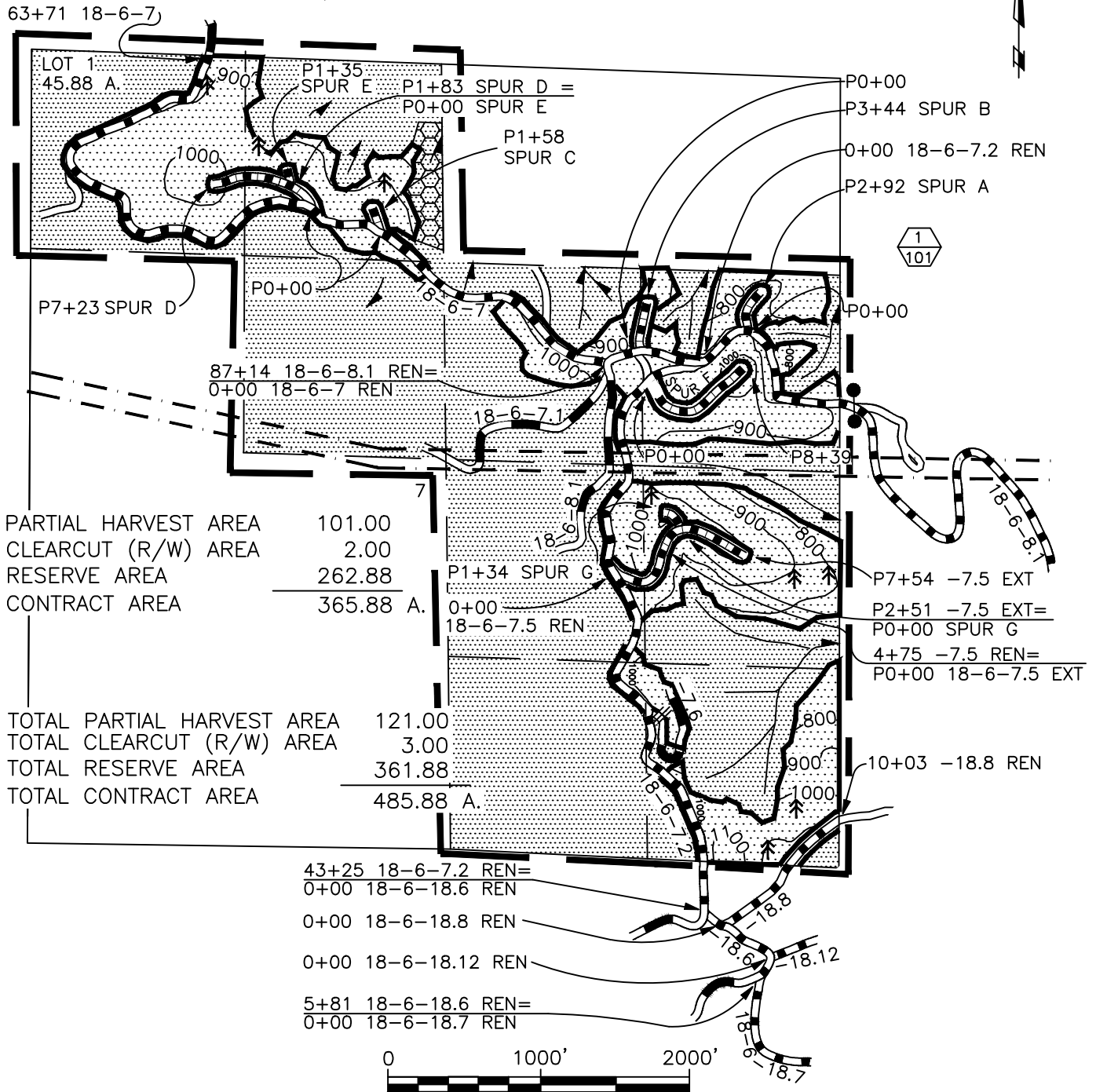

PARTIAL HARVEST AREA	101.00
CLEARCUT (R/W) AREA	2.00
RESERVE AREA	262.88
CONTRACT AREA	365.88 A.

TOTAL PARTIAL HARVEST AREA	121.00
TOTAL CLEARCUT (R/W) AREA	3.00
TOTAL RESERVE AREA	361.88
TOTAL CONTRACT AREA	485.88 A.

SCALE  
LEGEND

- PARTIAL HARVEST AREA
- RESERVE AREA
- CLEARCUT (R/W) AREA
- SPECIAL TAILHOLD AREA
- APPROXIMATE LOCATION OF SPECIAL HABITAT TREES 8 GROUPS (15 Trees)
- PARTIAL HARVEST NUMBER ACRES

- BOUNDARY - CONTRACT AREA
- BOUNDARY - CUTTING AREA (BLAZED, PAINTED & POSTED)
- ROCK SURFACED ROAD
- NATURAL SURFACED ROAD
- ROAD TO BE CONSTRUCTED
- ROAD TO BE RENOVATED
- BLOCKED ROAD
- POWER LINE RIGHT-OF-WAY
- STREAM

DATE: 7/15/12

EXHIBIT A  
SHEET 2 OF 2

T. 18 S., R. 6 W., SEC. 17, WILL. MER., EUGENE DISTRICT

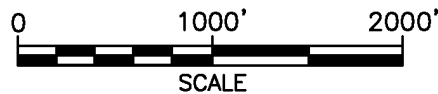

	PARTIAL HARVEST AREA		BOUNDARY - CONTRACT AREA
	RESERVE AREA		BOUNDARY - CUTTING AREA (BLAZED, PAINTED & POSTED)
	CLEARCUT (R/W) AREA		ROCK SURFACED ROAD
	PARTIAL HARVEST NUMBER ACRES		ROAD TO BE CONSTRUCTED
	APPROXIMATE LOCATION OF SPECIAL HABITAT TREES 4 TREES		ROAD TO BE RENOVATED
			STREAM

DATE: 7/15/12

EUGENE DISTRICT  
UPPER WILLAMETTE RESOURCE AREA

PARCEL NO.: 2  
SALE DATE: September 13, 2012

Tract No. E-12-658 Bickmore Creek  
Linn County, Oregon: O&C

Bid Deposit Required: \$45,700.00

All timber designated for cutting on SE1/4NE1/4, N1/2SE1/4, Section 20; Lot 3, SW1/4NW1/4, W1/2SE1/4, Section 21; S1/2, Section 25; E1/2NE1/4, NE1/4SE1/4, Section 28; SE1/4SW1/4, SE1/4, Section 34; S1/2NW1/4, SW1/4, NW1/4SE1/4, Section 35, T. 14 S., R. 2 W. Will. Mer.; Lots 1 and 2, S1/2NE1/4, SE1/4, Section 3, T. 15 S., R. 2 W. Will. Mer.

Estimated Volume 32' Log (MBF)	Estimated Volume (CCF)	Species	Estimated Volume 16' Log (MBF)	Appraised Price Per MBF	Estimated Volume Times Approx. Price
6,289	13,126	Douglas-fir	7,100	\$ 52.00	\$ 369,200.00
46	108	Grand fir	61	\$ 31.20	1,903.20
19	44	Western hemlock	23	\$ 32.50	747.50
238	571	Western redcedar	285	\$ 297.00	84,645.00
3	8	Red alder	4	\$ 76.00	304.00
6,595	13,857	TOTALS	7,473		\$ 456,799.70

APPRAISED PRICES are calculated by determining market value through the analytical appraisal method. The minimum bid increment will be \$0.10 per MBF or multiples thereof.

LOG EXPORT RESTRICTIONS: All timber offered for sale hereunder is restricted from export from the United States in the form of unprocessed timber and is prohibited from being used as a substitute for exported private timber.

NOTE: The volume for this timber sale has been calculated using 16 foot eastside Scribner rules, and the 32 foot log volumes and the cubic log volumes are estimates derived from the 16 foot volumes.

CRUISE INFORMATION: Volume for Douglas-fir in the right-of-ways has been cruised using the 3P system to select sample trees. The sample trees have been cruised and the volume computed using the **National Cruise Processing Program** for estimating volume in 16 foot lengths and the volume expanded to a total right-of-way volume. A map showing the location and description of these sample trees is available at the Eugene District Office. The timber volumes for all other conifers and hardwoods in the right-of-ways were based on a 100% cruise using the **National Cruise Processing Program** for estimating board foot volume of trees in 16 foot logs.

Volume for the coniferous species in the Partial Harvest Areas was variable plot cruised. The Partial Harvest Areas contain a total of 291 plots and 125 randomly selected sample trees. The tree count was determined with a Relaskop using a 20 BAF. Sample trees were randomly selected and volume expanded to a total Partial Harvest Area volume in 16-foot lengths using the **National Cruise Processing Program**. A map showing the location of the sample trees is available at the Eugene District Office.

With respect to merchantable Douglas-fir (sample) trees: The average tree is 12.5" DBHOB; the average log contains 39 bd. ft.; the total gross merchantable volume is approximately 7,548 MBF; and 94% recovery is expected.

CUTTING AREA: Four areas totaling approximately 573 acres must be partial harvested and approximately 12 acres of right-of-way must be clear cut.

ACCESS: Access to the sale is provided by:

1. A public road;
2. BLM existing roads;
3. BLM roads to be constructed;
4. Roads covered by a Right-of-Way and Road Use Agreement E-573 between Weyerhaeuser Company and the United States. In the use and renovation of private roads, the Purchaser shall enter into a license agreement with Weyerhaeuser Company. The license agreement shall be delivered to Weyerhaeuser Company for execution at least 15 days prior to any use of company roads. See the Prospectus for full terms and conditions of use.
5. Roads covered by a Right of Way and Road Use Agreement E-370 between Timber Service Company and the United States. In the use and renovation of private roads, the Purchaser shall enter into a license agreement with Timber

Service Company. The license agreement shall be delivered to Timber Service Company for execution at least 15 days prior to any use of company roads. See the Prospectus for full terms and conditions of use.

6. Roads covered by a Right of Way and Road Use Agreement E-370A between Lost Creek Timber and the United States. In the use and renovation of private roads, the Purchaser shall enter into a license agreement with Lost Creek Timber. The license agreement shall be delivered to Lost Creek Timber for execution at least 15 days prior to any use of company roads. See the Prospectus for full terms and conditions of use.

**ROAD MAINTENANCE:** The Purchaser shall pay Weyerhaeuser Company road use fees of \$1,069.45. In addition, the Purchaser shall either maintain the Weyerhaeuser owned roads and pay Weyerhaeuser rockwear fees estimated at \$193.62, or Weyerhaeuser will maintain their roads and the Purchaser shall pay both road maintenance and rockwear fees to Weyerhaeuser estimated at \$493.55. The Purchaser shall pay Timber Service Company road use fees of \$22,959.30 and rockwear fees estimated at \$417.98. The Purchaser shall pay Lost Creek Timber road use fees of \$6,638.00. The Purchaser shall pay BLM road maintenance fees of \$30,805.97. See Exhibit D map for specification of road maintenance responsibility. Only the map pages of Exhibit D are included in the Prospectus. Refer to the contract file for the full Exhibit D.

\*In addition to the quantities shown below, 250 CY (truck measure) of 1-1/2" minus and 250 CY (truck measure) of 3" minus maintenance rock is required.

**ROAD CONSTRUCTION:** Required Required Rock Source: BLM, Blagen Quarry, T. 15 S., R. 2 W., Sec. 3, W.M.

Natural surface: Spurs 20D, 25E

Rock surface: Spurs 3B Seg. B, 3D, 3F, 3J, 3Y, 3Z, 20B, 20C, 25T, 25V, 35B, 35S1, 35S2, & Road No. 15-2-3.1

Class: SN-14 / SN-16

Length: 10.7 Stations (Natural surface), 97.51 Stations (Rock surface)

Surfacing: 1-1/2" minus, 3" minus, Jaw Run (6" minus)

Culverts:

Diameter:	Length:	Number:
18" CPP	510'	14

Width: varies

Compacted Depth: 6"-10"

Estimated Quantities (truck measure): 3/4" minus: 150 CY

1-1/2" minus: 1,052 CY

3" minus: 146 CY

Jaw Run (6" minus): 2,936 CY

Pit Run armoring: 3 CY

Total estimated construction cost: \$129,437.39

Special Requirements in Road Construction: No sidecast material shall be permitted on Spur 3J between stations 1+00 to 2+20. Spur 3F is Purchaser located and shall be approved in writing prior to construction. Culvert removal and replacement/installation on streams shall be done between June 1 and October 15 (both days inclusive).

**ROAD RENOVATION:** Required Required Rock Source: BLM, Blagen Quarry, T. 15 S., R. 2 W., Sec. 3, W.M.

Natural surface: Road Nos. 14-2-28.6, 14-2-35.2

Rock surface: Spurs 3B, 3Y, 25Z, 35S, and Road Nos. 14-2-16, 14-2-21, 14-2-21.1 Seg. B, 14-2-21.2, 14-2-25.1, 14-2-25.2, 14-2-25.4, 14-2-25.7, 14-2-25.8, 14-2-36.1, 15-2-3, 15-2-3.1

Paved surface: Road Nos. 14-2-16, 14-2-35, 16-1-5

Class: SN-14 / SN-16

Length: 20.06 Stations (Natural surface), 397.9 Stations (Rock surface), 931.4 Stations (Paved Surface)

Surfacing: 1-1/2" minus, 3" minus

Culverts:

Diameter:	Length:	Number:
18" CPP	726'	21
24" CPP	136	4
30" CMP	124'	3
36" CMP	74'	2

Width: varies

Compacted Depth: 4"-10"

Estimated Quantities (truck measure): 3/4" minus: 381 CY

1-1/2" minus: 2,200 CY

3" minus: 889 CY

Jaw Run (6" minus): 686 CY

Pit run armoring: 17 CY

Asphalt: 47 tons

Downspout:

Diameter:	Length:	Number:
18"	20'	1

Total estimated renovation cost: \$156,388.94

Special Requirements in Road Renovation: Culvert removal and replacement/installation on streams shall be done between June 1 and October 15 (both days inclusive), except for culverts located on Road No. 16-1-5 which shall be completed between June 1 and October 31 (both days inclusive). Resurfacing of asphalt is required over culvert installations on paved roads. The temporary culverts on Road Nos. 14-2-21.2 and 14-2-35.2 must be installed prior to any road renovation work or hauling of timber. 100 CY (truck measure) of 1-1/2" minus crushed rock shall be placed on Road No. 14-2-21 prior to any hauling at locations determined by the Authorized Officer. The Purchaser shall be required to notify and coordinate with Pacific Power and Light prior to any construction or renovation on Road Nos. 14-2-35.1 and 14-2-35.2.

**ROAD DECOMMISSIONING:** Required

Roads: Spurs 3B, 20D, 25E, and Road Nos. 14-2-21.2, 14-2-28.6, 14-2-35.2

Length: 57.58 stations (Block & Waterbar only)

Barriers: 4 (includes 2 earthen barricades)

Remove Temporary Culvert: 2 – Road Nos. 14-2-21.2 and 14-2-35.2

Estimated Cost of Decommissioning: \$3,986.93

Special Requirements in Road Decommissioning: Culvert removal on streams shall be done between June 1 and October 15 (both days inclusive). The temporary culverts on Road Nos. 14-2-21.2 and 14-2-35.2 must be removed post-harvest operations and placed in locations determined by the Authorized Officer.

**Total estimated cost of construction, renovation, and decommissioning: \$289,813.26**

**DURATION OF CONTRACT:** Duration of the contract will be 36 months for cutting and removal of timber.

**SPECIAL PROVISIONS:** The contract will contain special provisions regarding road construction, road renovation, road maintenance, road decommissioning, logging methods, prevention of erosion, logging residue reduction, submission of a written logging plan specifying landing locations, logging methods, and logging schedule.

Under Sec. 25 of the timber sale contract, groundbased logging will be prohibited during periods of excessive soil moisture. This will normally limit groundbased logging to July, August and September.

It is estimated that 681 MBF additional timber, such as corridor and guyline trees may be removed under the contract, but is not included in the advertised sale volume, nor is it included in the timber sale appraisal.

**A revised Special Provision, 41(e)(2)(cc), has been added to the contract which enables the Contracting Officer to allow the Purchaser to remove material from the Contract Area instead of disposing of slash by piling, covering and burning.**

**OTHER SPECIAL REQUIREMENTS:**

- 1. In Partial Harvest Area No. 1 as shown on Exhibit A, no harvest activities, including felling, yarding, decking, hauling or road work shall be conducted from November 15 to March 15 of each year, both days inclusive. Hauling timber on Road No. 14-2-16 removed from other Partial Harvest Areas is not restricted. This restriction is for wildlife purposes and shall not be waived.**
- 2. Aggregate production is required at the BLM Blagen Quarry located in T. 15 S., R. 2 W., Sec. 3, W.M. No blasting or crushing shall be allowed from November 15 to March 15 due to wildlife restrictions.**
- 3. Notification and coordination with Pacific Power and Light shall be required prior to any road construction or renovation of Road Nos. 14-2-35.1 and 14-2-35.2, and prior to logging operations in Partial Harvest Area No. 4, Section 35.**
4. The location of Spur 3F in Partial Harvest Area No. 3 shall be determined by the Purchaser. The final spur road location, landings, and clearing limits shall be identified with flagging and shall be approved by the Authorized Officer in writing prior to construction.
5. Surfacing on Paved Road Nos. 14-2-16, 14-2-35, and 16-1-5 shall be protected during logging operations as directed by Authorized Officer. Any necessary repairs after logging is completed shall be in accordance with Exhibit D.
6. Landings on Road Nos. 14-2-16, 14-2-35, and 16-1-5 that block traffic shall have prior approval by the Authorized Officer. Whenever felling and yarding operations present a hazard to traffic on the roads above, the Purchaser shall provide signs to control traffic. The roads shall not be blocked by such operations for more than twenty minutes.
7. No felling, yarding, or loading is permitted in or through the Reserve Areas shown on Exhibit A, except in the Approximate Area Where Yarding Corridors are Permitted in Reserve Areas. A maximum of two corridors shall be allowed. All trees cut in this area shall remain onsite.
8. In the Special Yarding Area shown on Exhibit A, a maximum of two skid roads shall be allowed.
9. Approximately 729 orange painted reserve trees are required for the creation of snags and coarse woody debris.
10. Corridors and skid trails may need to be adjusted to avoid cutting large trees 28 inches or greater DBH.

11. Piling, covering and burning of slash is required on all landings and within 25 feet of Road Nos. 14-2-35, 14-2-35.1, 15-2-3, and 16-1-5 within the Partial Harvest Areas.

OPTIONAL CONTRIBUTION: The Purchaser will have the option of performing slash pile burning or contributing Eight hundred thirty one and 64/100 dollars (\$831.64) in lieu thereof. The option must be declared prior to contract execution. Piling and covering are not included in the Optional Contribution and will remain the responsibility of the Purchaser.

**If the Purchaser has made such a contribution and later elects to remove all of the slash required to be piled, covered, and burned, the contribution will be refunded.**

NARRATIVE DESCRIPTION OF HOW TO GET TO SALE AREA: Portions of the sale are accessed through locked gates. Prospective bidders may obtain a key from the Eugene District Office and proceed to the sale area. Any other persons interested in visiting the timber sale should first contact Brian Bickford at 541-683-6164.

From Brownsville, travel 1.6 miles east on Highway 228. Turn south on Courtney Creek Road and travel 2.4 miles until it becomes Timber Road (also called Road No. 14-2-16) and continue for approximately 0.3 miles to Partial Harvest Area 1. Follow Timber Sale Location signs to remaining areas.



# TIMBER SALE LOCATION MAP

SALE NAME: Bickmore Creek

T. 14 S., R. 2 W., SEC. 20, 21, 25, 28, 34, 35; T. 15 S., R. 2 W., SEC. 3, WIL. MER., EUGENE DISTRICT

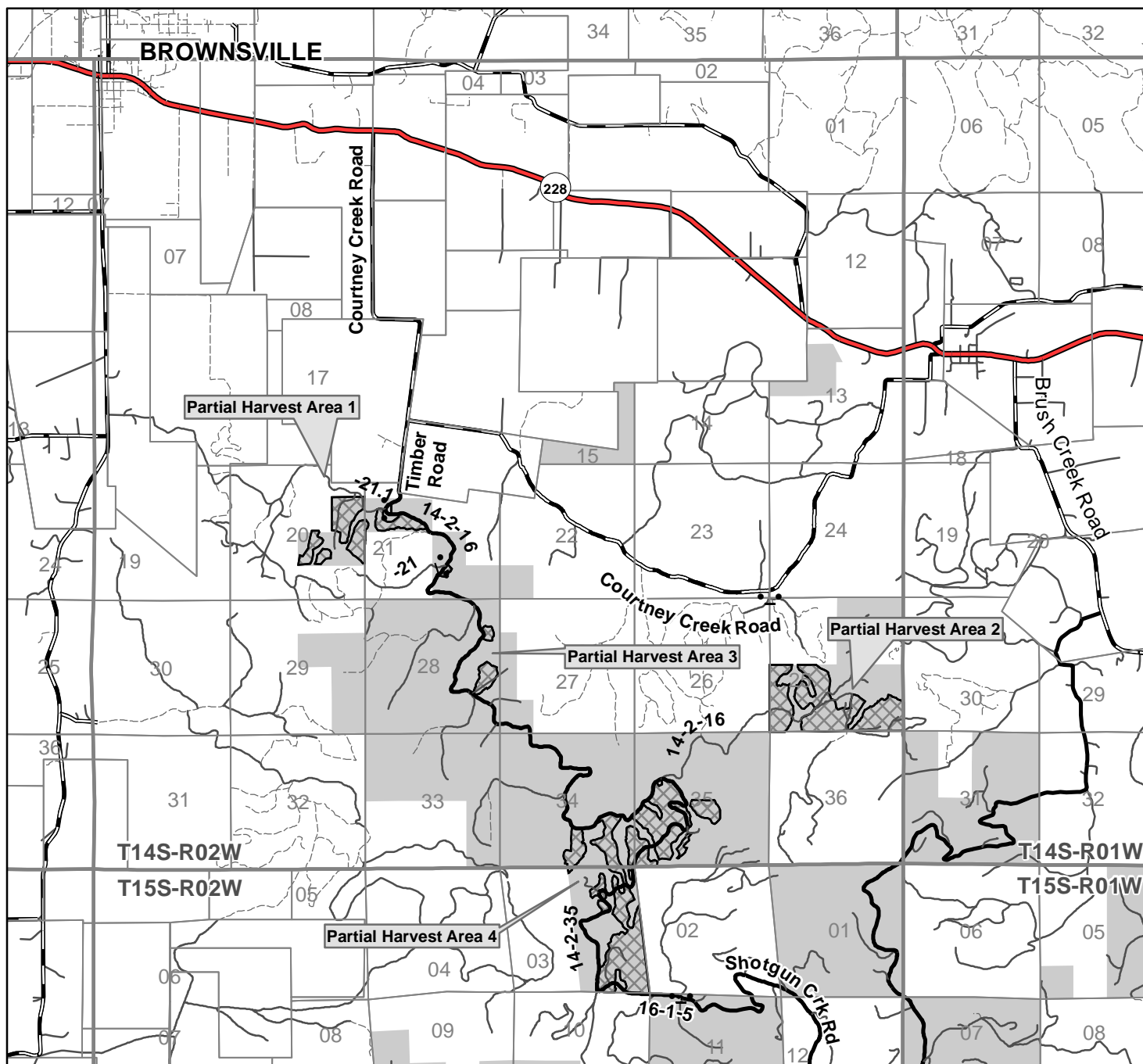

## NARRATIVE DESCRIPTION OF HOW TO GET TO THE TIMBER SALE AREA:

Portions of the sale are accessed through locked gates. Prospective bidders may obtain a key from the Eugene District Office and proceed to the sale area. Any other persons interested in visiting the timber sale should first contact Brian Bickford at 541-683-6164.

From Brownsville, travel 1.6 miles east on Highway 228. Turn south on Courtney Creek Road and travel 2.4 miles until it becomes Timber Road (also called Road No. 14-2-16) and continue for approximately 0.3 miles to Partial Harvest Area 1. Follow Timber Sale Location signs to remaining areas.

No warranty is made by the Bureau of Land Management as to the accuracy, reliability, or completeness of these data for individual or aggregate use with other data. Original data were compiled from various sources. This information may not meet National Map Accuracy Standards. This product was developed through digital means and may be updated without notification.



0 0.5 1 1.5 Miles

7/26/2012

United States Department of the Interior  
Bureau of Land Management  
Oregon State Office  
P.O. Box 2965  
Portland, Oregon 97208-2965

# Seasonal Restriction Matrix

Restricted Times are Shaded and X'd

	Jan		Feb		Mar		Apr		May		June		July		Aug		Sept		Oct		Nov		Dec	
	1	15	1	15	1	15	1	15	1	15	1	15	1	15	1	15	1	15	1	15	1	15	1	15
<b>Road Construction and Renovation</b>																								
<ul style="list-style-type: none"> <li>Typically, October 1 – May 31, may vary due to weather conditions.</li> </ul>		X	X	X	X	X	X	X	X	X									X	X	X	X	X	X
<b>Yarding (Sap flow)</b>																								
<u>Partial Harvest Area</u>							X	X	X	X	X													
<ul style="list-style-type: none"> <li>April 1 – June 15, both days inclusive</li> <li>Sap flow restrictions may be conditionally waived at the discretion of BLM</li> </ul>							X	X	X	X	X													
<b>Ground based yarding and decommissioning</b>																								
<u>Partial Harvest Area</u>		X	X	X	X	X	X	X	X	X	X	X							X	X	X	X	X	X
<ul style="list-style-type: none"> <li>October 1 – June 30, may vary due to weather conditions; soil moisture still overrides weather conditions.</li> </ul>		X	X	X	X	X	X	X	X	X	X	X							X	X	X	X	X	X
<b>Hauling on natural-surfaced roads</b>																								
Soil moisture seasonal restriction		X	X	X	X	X	X	X	X	X	X	X							X	X	X	X	X	X
<ul style="list-style-type: none"> <li>Typically October 1 – June 30</li> </ul>		X	X	X	X	X	X	X	X	X	X	X							X	X	X	X	X	X
<b>Culvert Installation and Removal *</b>																								
<ul style="list-style-type: none"> <li>Rd. No. 16-1-5 November 1 through May 31</li> <li>All other Rds. October 15 – May 31.</li> </ul>		X	X	X	X	X	X	X	X	X									X	X	X	X	X	X
<b>Wildlife Seasonal Restrictions</b>																								
<u>Partial Harvest Area No. 1 and BLM Blagen</u>		X	X	X	X	X																X	X	X
<u>Quarry (aggregate production)</u>																								
<ul style="list-style-type: none"> <li>November 15 – March 15, both days inclusive.</li> <li>These restrictions shall not be waived.</li> </ul>																								

\* These are ODF&W in-water guidelines and are both days inclusive.

NOTE: This chart is for informational purposes only. Refer to Section 41 Special Provisions of the timber sale contract for exact date restrictions and specifications. Subject to transient winter snow, elevation ranges from 600 – 3000 feet.





UNITED STATES  
DEPARTMENT OF THE INTERIOR  
BUREAU OF LAND MANAGEMENT

EXHIBIT "A"

Sheet 1 of 4

SALE NAME: BICKMORE CREEK TIMBER SALE CONTRACT NO.: ORE06-TS12-658  
T. 14 S., R. 2 W., SEC. 20 AND SEC. 21, WILL. MER., EUGENE DISTRICT

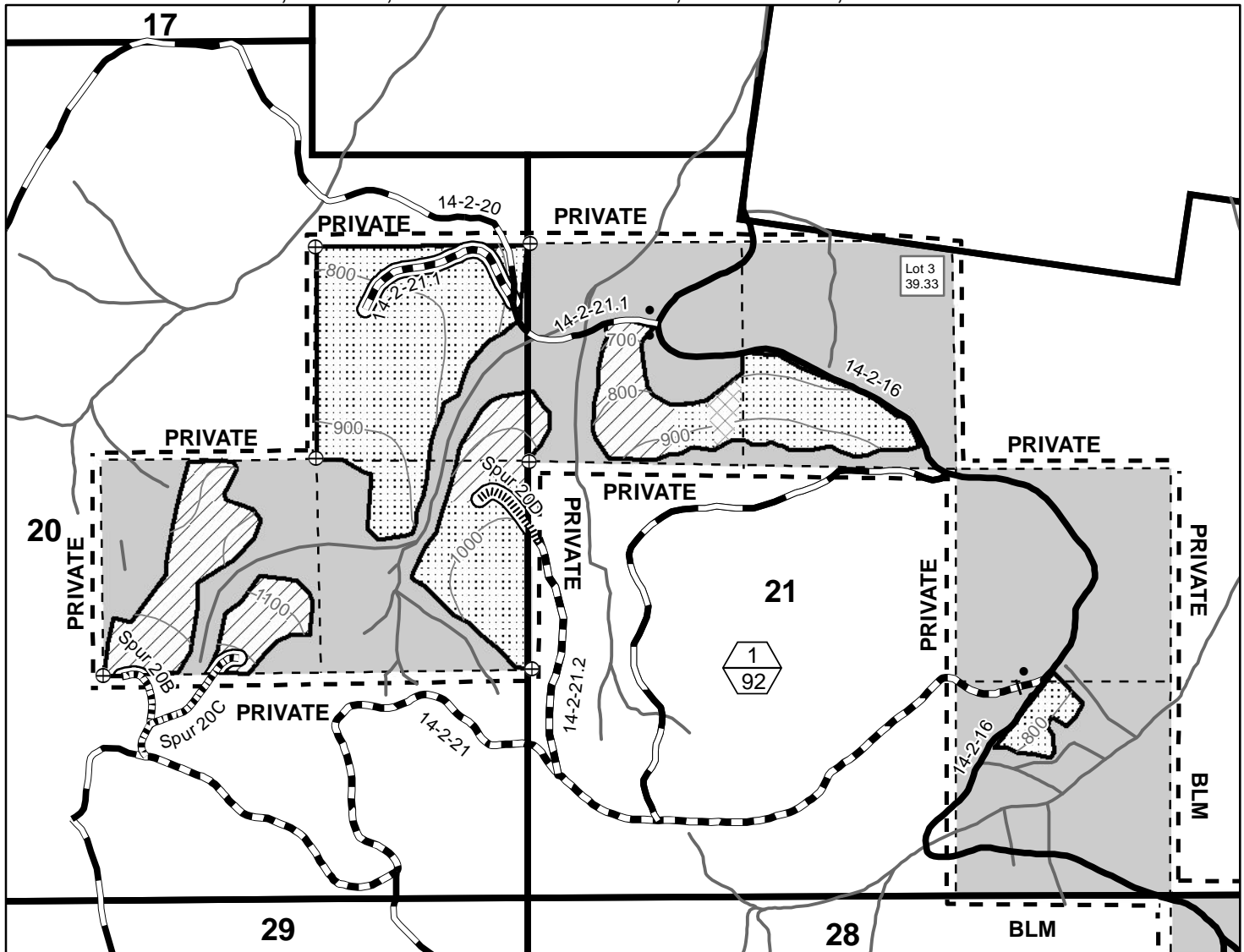

- Partial Harvest Area - Cable
- Partial Harvest Area - Groundbased
- Special Yarding Area
- Partial Harvest Area - Blazed, Posted, Painted
- Contract Area
- Reserve Area
- Section Line
- Corners Found
- Existing Road - Paved Surface
- Existing Road Rock or Natural Surface
- Road Renovation
- New Construction - Rocked
- New Construction - Natural Surface
- Stream
- 100' Contour
- Subdivisional Line
- Right-Of-Way (Clear Cut)
- Gate
- Unit Number (Top)/ Unit Acres (Bottom)

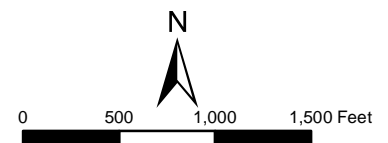

8/9/2012

TOTAL FOR SECTIONS 20 & 21	
PARTIAL HARVEST AREA	92
RIGHT-OF-WAY (CLEARCUT)	1
RESERVE AREA	187.33
CONTRACT AREA	280.33 Acres

GRAND TOTAL FOR SECTIONS 20, 21, 25, 28, 34, 35 & 3	
PARTIAL HARVEST AREA	573
RIGHT-OF-WAY (CLEARCUT)	12
RESERVE AREA	935.42
CONTRACT AREA	1,519.42 Acres

No warranty is made by the Bureau of Land Management as to the accuracy, reliability, or completeness of these data for individual or aggregate use with other data. Original data were compiled from various sources. This information may not meet National Map Accuracy Standards. This product was developed through digital means and may be updated without notification.

United States Department of the Interior  
Bureau of Land Management  
Oregon State Office  
P.O. Box 2965  
Portland, Oregon 97208-2965

**UNITED STATES  
DEPARTMENT OF THE INTERIOR  
BUREAU OF LAND MANAGEMENT**

**EXHIBIT "A"**









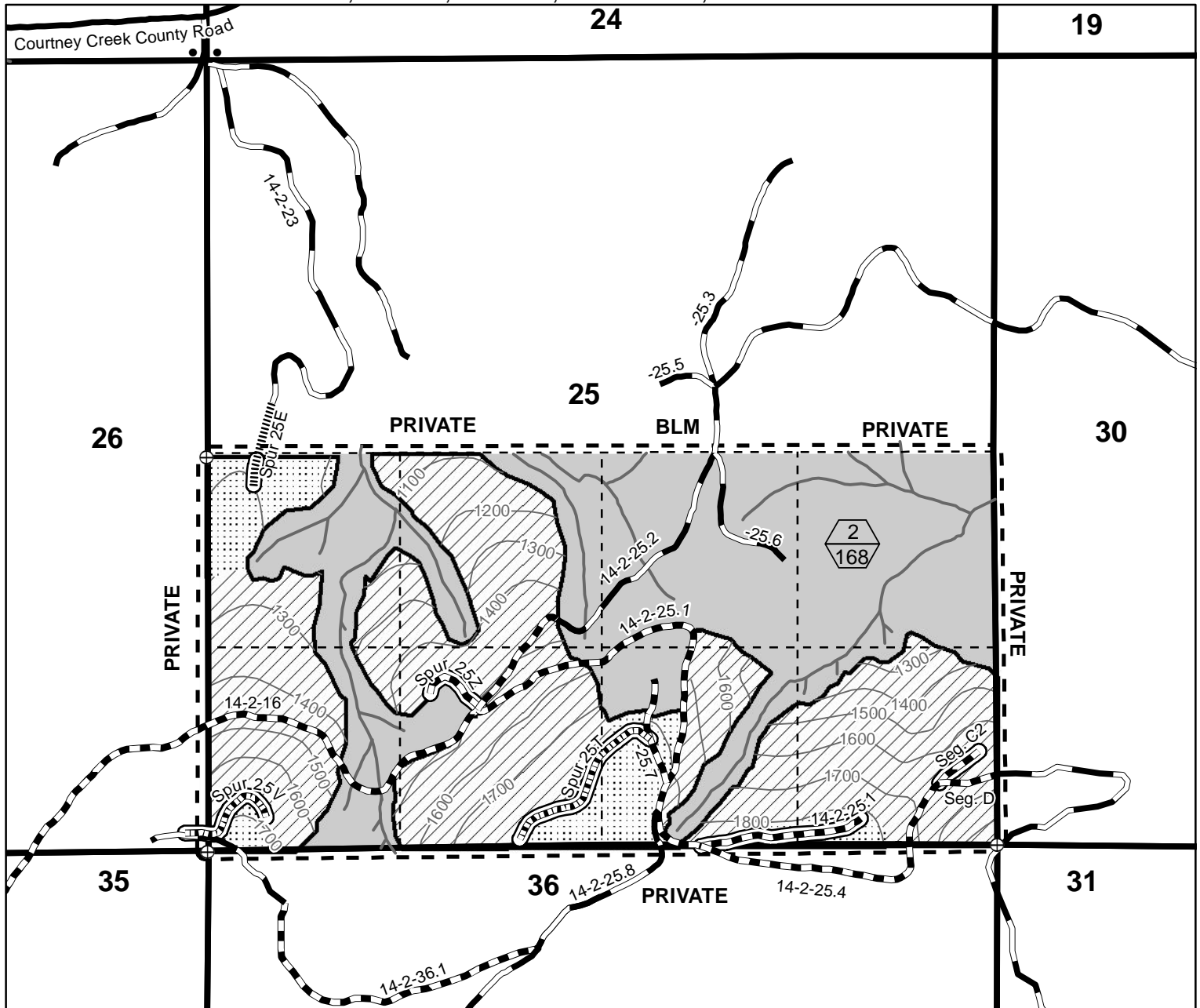









Sheet 2 of 4

23

SALE NAME: BICKMORE CREEK TIMBER SALE CONTRACT NO.: ORE06-TS12-658

T. 14 S., R. 2 W., SEC. 25, WILL. MER., EUGENE DISTRICT



- |  |   |   |   |
|--|---|---|---|
|  | Partial Harvest Area - Groundbase                 |  | New Construction - Rocked                 |
|  | Partial Harvest Area - Cable                      |  | New Construction - Natural Surface        |
|  | Partial Harvest Area -<br>Blazed, Posted, Painted |  | Stream                                    |
|  | Reserve Area                                      |  | 100' Contour                              |
|  | Contract Area                                     |  | Subdivisional Line                        |
|  | Section Line                                      |  | Corner Found                              |
|  | Existing Road - Paved Surface                     |  | Right-Of-Way (Clear Cut)                  |
|  | Existing Road - Rock or Natural Surface           |  | Gate                                      |
|  | Road Renovation                                   |  | Unit Number (Top)/<br>Unit Acres (Bottom) |

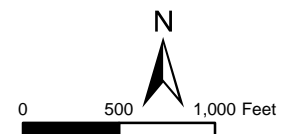

8/8/2012

TOTAL FOR SECTION 25	
PARTIAL HARVEST AREA	168
RIGHT-OF-WAY (CLEARCUT)	2
RESERVE AREA	<u>150</u>
CONTRACT AREA	<u>320</u> Acres

United States Department of the Interior  
Bureau of Land Management  
Oregon State Office  
P.O. Box 2965  
Portland, Oregon 97208-2965

No warranty is made by the Bureau of Land Management as to the accuracy, reliability, or completeness of these data for individual or aggregate use with other data. Original data were compiled from various sources. This information may not meet National Map Accuracy Standards. This product was developed through digital means and may be updated without notification.



UNITED STATES  
DEPARTMENT OF THE INTERIOR  
BUREAU OF LAND MANAGEMENT

EXHIBIT "A"

Sheet 3 of 4

SALE NAME: BICKMORE CREEK TIMBER SALE CONTRACT NO.: ORE06-TS12-658  
T. 14 S., R. 2 W., SEC. 28, WILL. MER., EUGENE DISTRICT

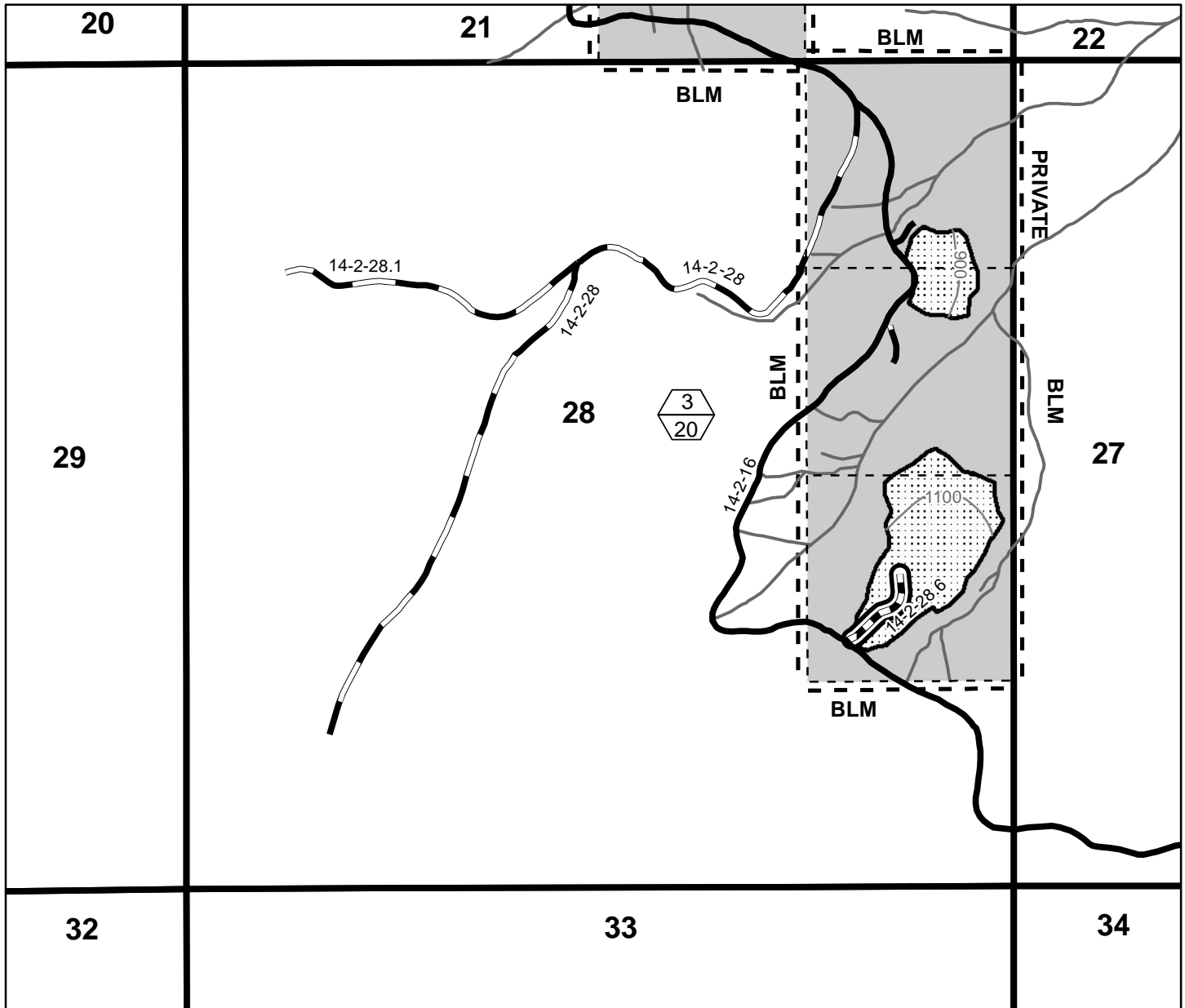

- Partial Harvest Area - Groundbased
- Partial Harvest Area - Blazed, Posted, Painted
- Reserve Area
- Contract Area
- Section Line
- Existing Road - Paved Surface
- Existing Road - Rock or Natural Surface
- Road Renovation
- 100' Contour
- Subdivisional Line
- Stream
- Right-Of-Way (Clear Cut)
- Unit Number (Top)/ Unit Acres (Bottom)



8/9/2012  
0 500 1,000 1,500 Feet

TOTAL FOR SECTION 28	
PARTIAL HARVEST AREA	20
RIGHT-OF-WAY (CLEARCUT)	1
RESERVE AREA	99
CONTRACT AREA	120 Acres

No warranty is made by the Bureau of Land Management as to the accuracy, reliability, or completeness of these data for individual or aggregate use with other data. Original data were compiled from various sources. This information may not meet National Map Accuracy Standards. This product was developed through digital means and may be updated without notification.

United States Department of the Interior  
Bureau of Land Management  
Oregon State Office  
P.O. Box 2965  
Portland, Oregon 97208-2965

United States Department of the Interior  
Bureau of Land Management  
Oregon State Office  
P.O. Box 2965  
Portland, Oregon 97208-2965





UNITED STATES  
DEPARTMENT OF THE INTERIOR  
BUREAU OF LAND MANAGEMENT

EXHIBIT "A1"

Sheet 1 of 3

SALE NAME: BICKMORE CREEK TIMBER SALE CONTRACT NO.: ORE06-TS12-658  
T. 14 S., R. 2 W., SEC. 20 AND SEC. 21, WILL. MER., EUGENE DISTRICT

COARSE WOODY DEBRIS AND SNAG CREATION

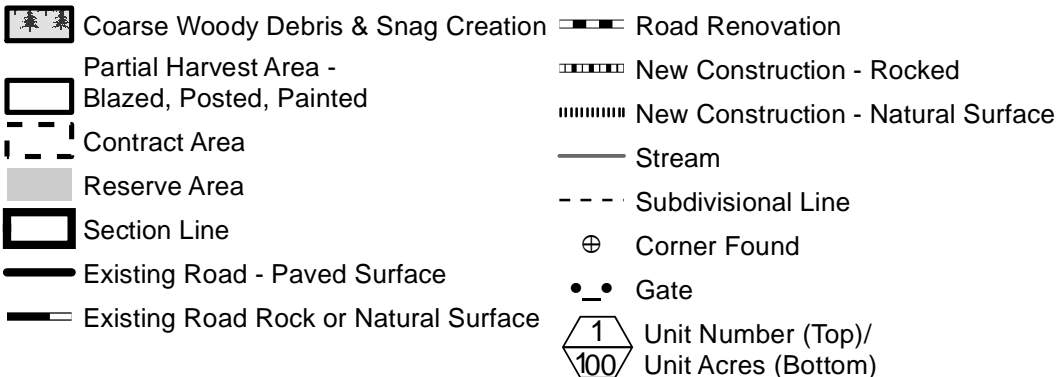
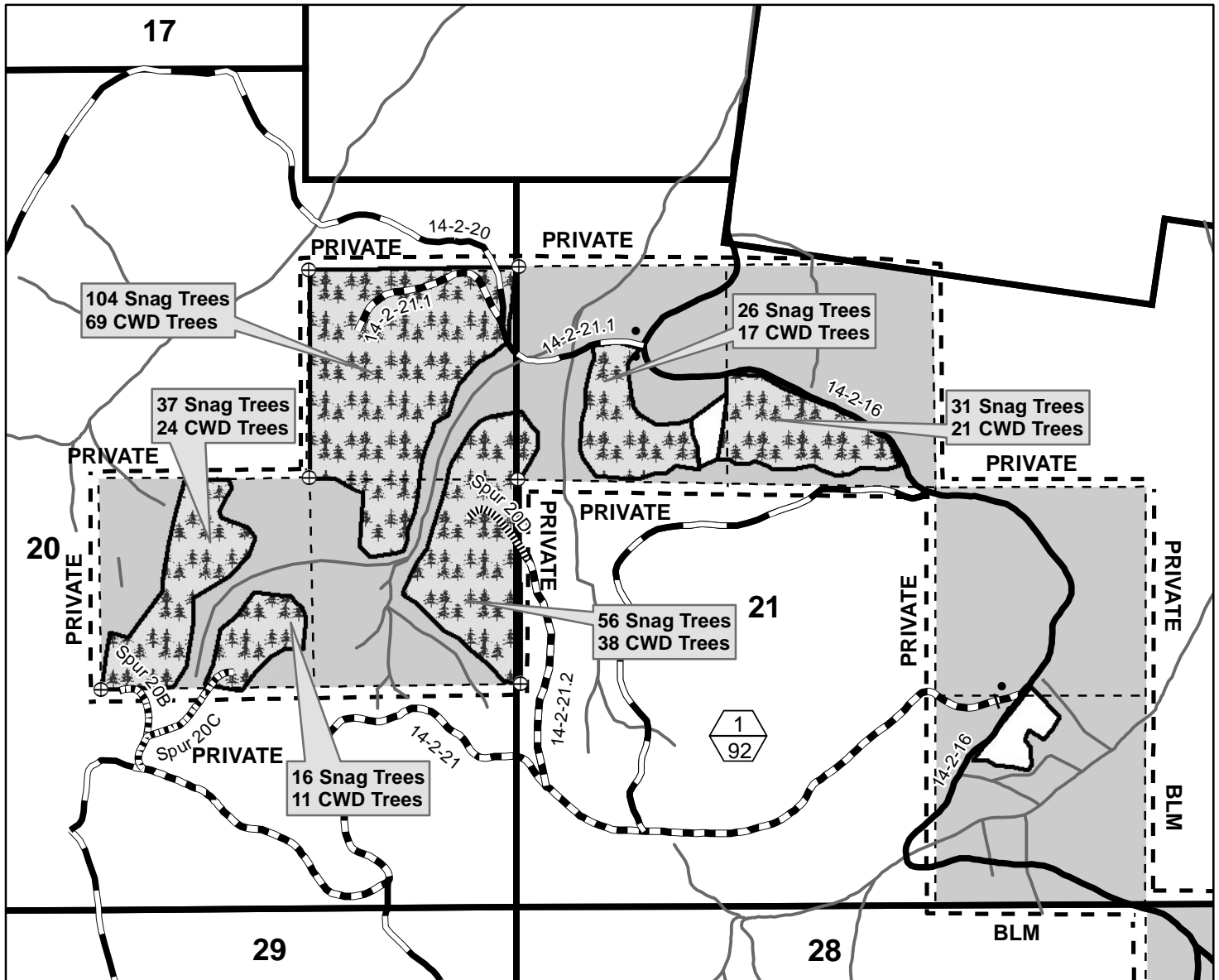

Treatment Acres	90
Total Snags	270
Total CWD	180

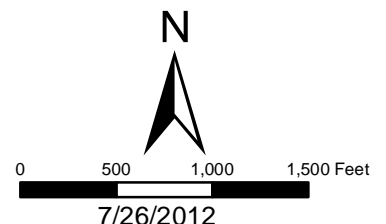

No warranty is made by the Bureau of Land Management as to the accuracy, reliability, or completeness of these data for individual or aggregate use with other data. Original data were compiled from various sources. This information may not meet National Map Accuracy Standards. This product was developed through digital means and may be updated without notification.

United States Department of the Interior  
Bureau of Land Management  
Oregon State Office  
P.O. Box 2965  
Portland, Oregon 97208-2965

**UNITED STATES  
DEPARTMENT OF THE INTERIOR  
BUREAU OF LAND MANAGEMENT**

**EXHIBIT "A1"**









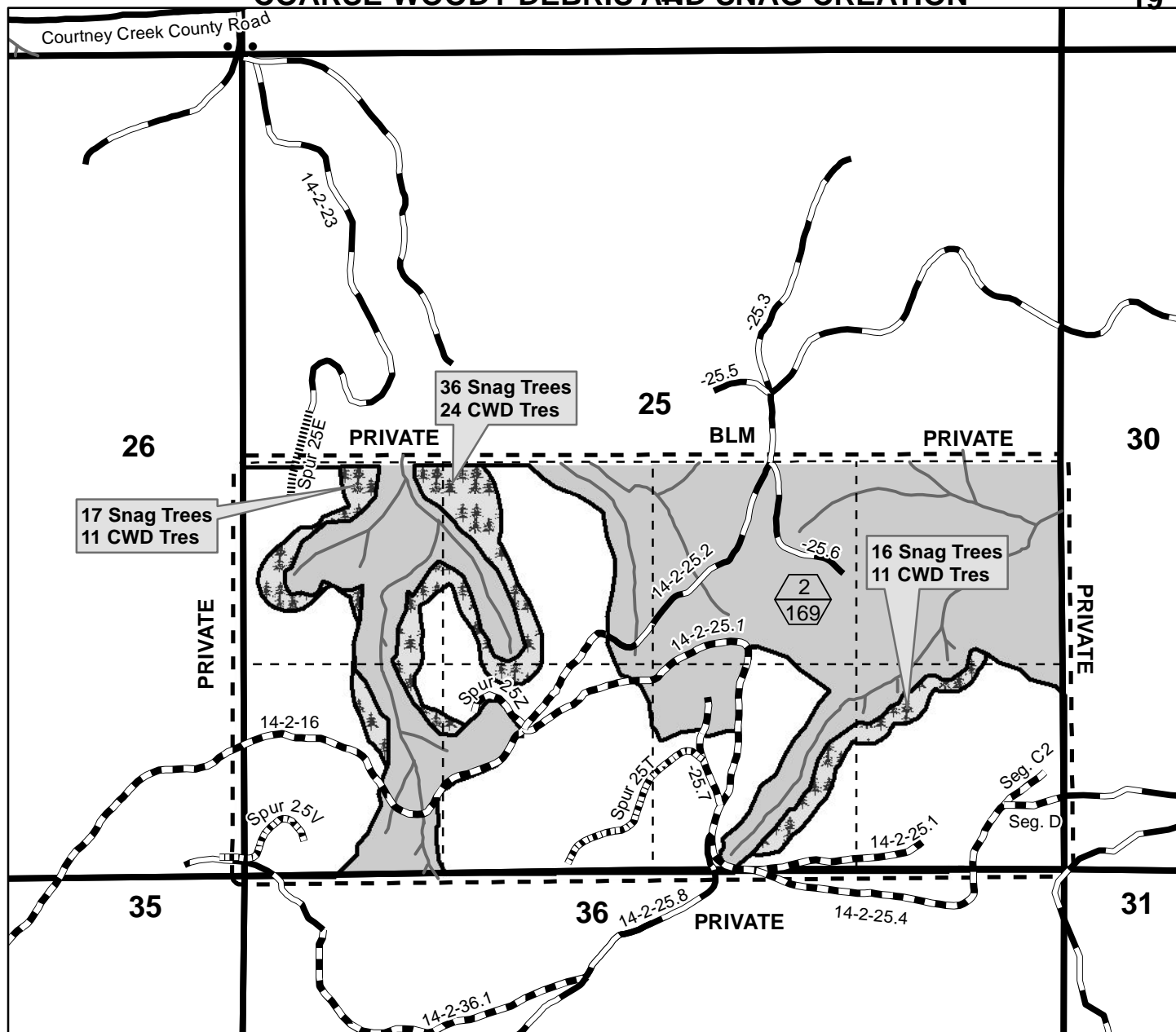





Sheet 2 of 3

SALE NAME: BICKMORE CREEK TIMBER SALE CONTRACT NO.: ORE06-TS12-658  
T. 14 S., R. 2 W., SEC. 25, WILL. MER., EUGENE DISTRICT

## COARSE WOODY DEBRIS AND SNAG CREATION

19



- |  |   |   |   |
|--|---|---|---|
|  | Coarse Woody Debris & Snag Creation Area          |  | Road Renovation                           |
|  | Partial Harvest Area -<br>Blazed, Posted, Painted |  | New Construction -<br>Rocked              |
|  | Contract Area                                     |  | New Construction -<br>Natural Surface     |
|  | Reserve Area                                      |  | Stream                                    |
|  | Section Line                                      |  | Subdivisional Line                        |
|  | Existing Road - Paved Surface                     |  | Gate                                      |
|  | Existing Road - Rock or Natural Surface           |  | Unit Number (Top)/<br>Unit Acres (Bottom) |

Treatment Acres	23
Total Snags	69
Total CWD	46

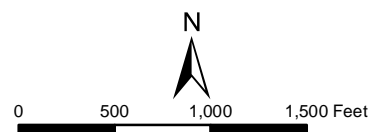

7/26/2012

United States Department of the Interior  
Bureau of Land Management  
Oregon State Office  
P.O. Box 2965  
Portland, Oregon 97208-2965

No warranty is made by the Bureau of Land Management as to the accuracy, reliability, or completeness of these data for individual or aggregate use with other data. Original data were compiled from various sources. This information may not meet National Map Accuracy Standards. This product was developed through digital means and may be updated without notification.



UNITED STATES  
DEPARTMENT OF THE INTERIOR  
BUREAU OF LAND MANAGEMENT

EXHIBIT "A1"  
Sheet 3 of 3

SALE NAME: BICKMORE CREEK TIMBER SALE CONTRACT NO.: ORE06-TS12-658  
T. 14 S., R. 2 W., SEC. 34 & 35, T. 15 S., R. 2 W., SEC. 3, WILL. MER., EUGENE DISTRICT  
**COARSE WOODY DEBRIS & SNAG CREATION**

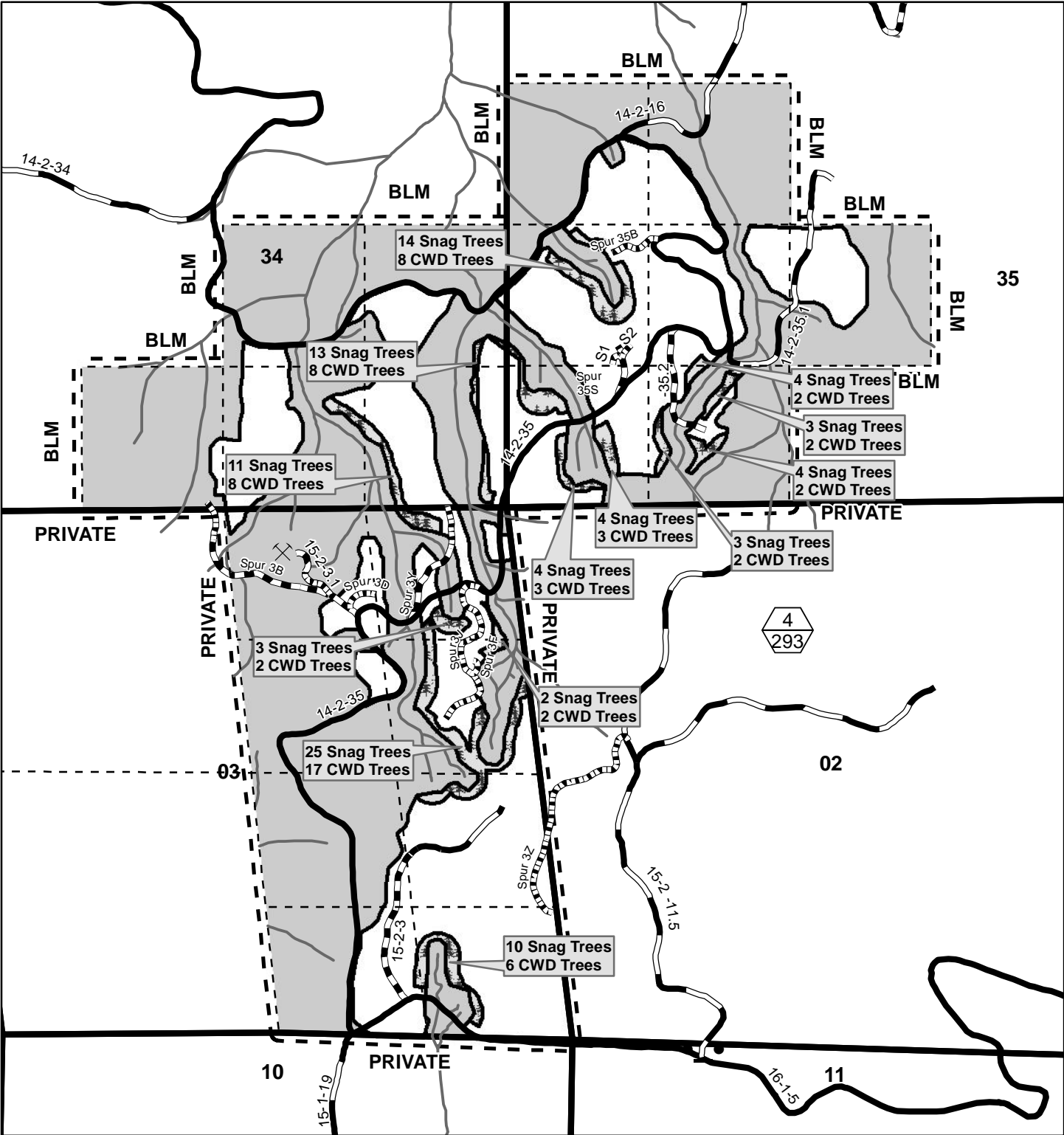

- Coarse Woody Debris & Snag Creation
- Partial Harvest Area -  
Blazed, Posted, Painted
- Reserve Area
- Section Line
- Existing Road - Paved Surface
- Existing Road - Rock or Natural Surface
- Road Renovation
- New Construction - Rocked
- Subdivisional Line
- Stream
- Quarry
- Gate
- Unit Number (Top)/  
Unit Acres (Bottom)

Treatment Acres	33
Total Snags	98
Total CWD	66



0 1,000 2,000 Feet

Scale 1:15,840

8/9/2012

No warranty is made by the Bureau of Land Management as to the accuracy, reliability, or completeness of these data for individual or aggregate use with other data. Original data were compiled from various sources. This information may not meet National Map Accuracy Standards. This product was developed through digital means and may be updated without notification.

EUGENE DISTRICT  
SIUSLAW RESOURCE AREA

PARCEL NO.: 3  
SALE DATE: September 13, 2012

Tract No. E- 12-501 Schaffer Road  
Lane County, Oregon: O&C

Bid Deposit Required: \$31,700.00

All timber designated for cutting on SE1/4NE1/4, NE1/4SW1/4, S1/2SW1/4, SE1/4 Section 27, T. 19 S., R. 5 W.,  
Will. Mer.

Estimated Volume 32' Log (MBF)	Estimated Volume (CCF)	Species	Estimated Volume 16' Log (MBF)	Appraised Price Per MBF	Estimated Volume Times Approx. Price
1,813	3,874	Douglas-fir	2,055	\$ 152.00	\$ 312,360.00
41	93	Western hemlock	49	\$ 88.00	\$ 4,312.00
1,854	3,967	TOTALS	2,104		\$ 316,672.00

APPRAISED PRICES: Are calculated by determining market value through the analytical appraisal method. The minimum bid increment will be \$0.10 per MBF or multiples thereof.

LOG EXPORT RESTRICTIONS: All timber offered for sale hereunder is restricted from export from the United States in the form of unprocessed timber and is prohibited from being used as a substitute for exported private timber.

NOTE: The volume for this timber sale has been calculated using 16 foot eastside Scribner rules, and the 32 foot log volumes and the cubic log volumes are estimates derived from the 16 foot volumes.

CRUISE INFORMATION: All species in the right-of-ways have been cruised using the 3P system to select sample trees and the volume expanded to a total right-of-way volume using the **National Cruise Processing Program**. The sample trees have been cruised and the volume computed using the **National Cruise Processing Program** for estimating volume in 16-foot lengths. A map showing the location and description of these sample trees is available at the Eugene District Office. Volume for all species in the Partial Harvest Area was variable plot cruised. The Partial Harvest Area contains a total of 193 plots and 80 randomly selected sample trees. The tree count was determined with a Relaskop using a 20 BAF. Sample trees were randomly selected and volume expanded to a total Partial Harvest Area volume in 16-foot lengths using the **National Cruise Processing Program**.

With respect to merchantable Douglas-fir (sample) trees: The average tree is 11.9" DBHOB; the average log contains 35 bd. ft.; the total gross merchantable volume is approximately 2,134 MBF; and 96% recovery is expected.

CUTTING AREA: One area totaling approximately 165 acres must be partial harvested and approximately 2 acres of right-of-way must be clear cut.

ACCESS: Access to the sale is provided by:

1. a public road;
2. BLM existing roads;
3. BLM roads to be constructed;
4. Roads covered by a Right-of-Way and Road Use Agreement E-431B between Seneca Jones Timber Company and the United States. In the use of private roads, the Purchaser shall enter into a license agreement with Seneca Jones Timber Company. The license agreement shall be delivered to Seneca Jones Timber Company for execution at least 15 days prior to any use of company roads. See the Prospectus for full terms and conditions of use.

ROAD MAINTENANCE: The Purchaser shall pay a road use fee of \$2,077.80 and rockwear fees estimated at \$27.17 to Seneca Jones Timber Company prior to hauling. The Purchaser shall pay BLM a road maintenance fee of \$1,230.84 and a rockwear fee of \$948.62. See Exhibit D map for specification of road maintenance responsibility. Only the map page of Exhibit D is included in the Prospectus. Refer to the contract file for the full Exhibit D.

ROAD CONSTRUCTION: Required

Suggested Rock Source: Commercial, Lorane/Noti Vicinity

Spurs B-F and Road No. 19-5-34.71

Class: SN-14

Length: 14.67 stations

Surfacing: 1-1/2" minus/3" minus/6" minus

Width: 12'

Compacted Depth: 8"

Estimated Quantity: 42/647/390 cu. yds.(truck measure)

Total estimated excavation: 18 hours of tractor time.

Total estimated construction cost: \$29,936.15, including \$21,114.89 for surfacing.

Special Requirements in Road Construction: Operations limited to periods of dry weather. The Purchaser shall purchase



from Seneca Jones Timber Company right-of-way timber felled for construction of Road No. 19-5-34.71, between stations P0+00 and P6+57, at fair market value. Volume is estimated at 20 MBF (16 foot log Scribner volume).

**ROAD RENOVATION:** Required

Spur A

Class: SN-16

Length: 11.72 stations

Surfacing: N/A

Total estimated excavation: 2 hours of tractor time.

Total estimated renovation cost: \$996.44

Special Requirements in Road Renovation: Operations limited to periods of dry weather.

**DRAINAGE RENOVATION:** Required

Suggested Rock Source: Commercial, Lorane/Noti Vicinity

Road No. 19-5-22.2

Class: SN-18

Length: 3.00 stations

Surfacing: 1-1/2" minus

Width: 19/21/22'

Compacted Depth: 12"

Estimated Quantity: 310 cu. yds. (truck measure)

Culvert Bedding: 3/4" minus, 320 cu. yds. (truck measure)

Slope Protection: Rip-rap, 78 cu. yds. (truck measure)

Total estimated excavation: 1,955 cubic yards.

Total estimated drainage renovation cost: \$32,464.64, including \$16,061.95 for surfacing and \$5,793.12 for culverts.

Special Requirements in Drainage Renovation: Operations limited to periods of dry weather. Site work within the stream channel below the normal high water line shall occur between July 1 and October 14, both days inclusive.

<u>Culverts:</u>		
<u>Diameter:</u>	<u>Length:</u>	<u>Number:</u>
24"	216'	3

**Note: Rock sources in the Lorane vicinity do not meet the requirements for the Federal Highway Administration Region 10 Accelerated Weathering Test. Therefore, the Eugene District does not accept gradations less than 3-inch minus from the Lorane vicinity for surface aggregate. Aggregate used for culvert bedding is exempt from meeting this requirement and is therefore acceptable.**

**Use of crushed rock located at the Stockpile Site shown on Exhibit A shall NOT be permitted.**

**DURATION OF CONTRACT:** Duration of the contract will be 36 months for cutting and removal of timber.

**SPECIAL PROVISIONS:** The contract will contain special provisions regarding road construction, road renovation, drainage renovation, road maintenance, logging methods, prevention of erosion, falling of snags, falling of all trees designated for cutting, logging residue reduction, and submission of a written logging plan specifying spur road locations, landing locations, logging methods, and logging schedule.

Under Section 25 of the timber sale contract, tractor logging will be prohibited during periods of excessive soil moisture. This will normally limit tractor logging to July, August and September.

It is estimated that approximately 95 MBF of additional timber, such as corridor and guyline trees, may be removed under the contract, but is not included in the advertised sale volume, nor is it included in the timber sale appraisal.

**A revised Special Provision has been added to the contract which enables the Contracting Officer to allow the Purchaser to remove material from the Contract Area instead of disposing of slash by piling, covering and burning.**

**OTHER SPECIAL REQUIREMENTS:**

- Eight trees located in one group in the Approximate Location of Special Habitat Trees are reserved.
- In the Partial Harvest Area, all trees designated for cutting shall be felled and cut into log lengths not to exceed 40 feet before being yarded, except in the Whole Tree Yarding Area.

- In the Partial Harvest Area, except in the Whole Tree Yarding Area, non-merchantable tree tops and limbs shall be retained on site where the source tree is felled, where operationally possible.
- In the Special Yarding Area, directionally fell timber away from oak trees.
- No driving or parking off of the rock road surface, felling, yarding, or loading shall be permitted in or through the Botany Reserve Area adjacent to Road No. 19-5-27.1.
- No yarding or hauling shall be conducted on natural surfaced roads during periods of wet weather, as determined by the Authorized Officer.
- In the event that harvest operations in the Partial Harvest Area require tailholds in the Special Tailhold Area, affected trees must be identified on the ground and approved by the Authorized Officer prior to cutting.
- Yarding *shall* be done with a carriage equipped skyline capable of yarding 1,500 feet slope distance in the Partial Harvest Area on slopes greater than 35%.
- In the Partial Harvest Area, where slopes are less than 35%, yarding *may* be done either by a skyline system as described above, or by equipment operated entirely on designated skid trails during periods of low soil moisture. Within 210 feet of streams, skid trails shall be located at least 75 feet from the posted boundary.
- In the Special Yarding Area, locate yarding corridors and skid trails so that they avoid oak trees.
- The Purchaser shall clean yarding, logging, road construction, road renovation, decommissioning, and slash disposal equipment, using a water pressure hose, prior to entry on BLM lands.
- Upon completion of haul, the Purchaser shall decommission skid trails, newly constructed roads and renovated roads. Decommissioning measures will take place during the dry season and include:
  - Decompact skid trails, Road No. 19-5-34.71, and natural surfaced roads with decompaction equipment, such as a track-mounted excavator.
  - Construct drainage dips, waterbars and/or lead-off ditches.
  - Where available, place logging slash on skid trails and road prisms, except where the Clearcut (R/W) Area passes through the Whole Tree Yarding Area, Road No. 19-5-34.71, and the last 300 feet of Spur A.
  - Block by using stumps, slash, and/or cull logs.
- The Exhibit F contains explicit instruction on requirements for equipment and personnel involved in pile burning.

**OPTIONAL CONTRIBUTION:** The Purchaser will have the option of performing pile burning or contributing \$668.25 in lieu thereof. Piling and covering of piles are not included in the Optional Contribution and will remain the responsibility of the Purchaser. The option must be declared prior to contract execution.

**If the Purchaser has made a contribution and later elects to remove all of the slash required to be piled, covered, and burned, the contribution will be refunded.**

**NARRATIVE DESCRIPTION OF HOW TO GET TO THE TIMBER SALE AREA:** Access to a portion of the sale is through a locked gate on private roads. Prospective bidders may obtain a key from the Eugene District Office. Any other persons interested in visiting the timber sale site should first contact Christopher Finn at (541) 683-6421.

From Eugene, travel west on Highway 126 to Crow Road (County Road 4234). Turn south and follow Crow Road to Territorial Highway (County Road 3800). Turn south on Territorial Highway and proceed for approximately 5 miles to Simonsen Road. Turn southwest on Simonsen Road and proceed for approximately 1.5 miles. Turn southwest on BLM Road No. 19-5-22.2 and follow the Timber Sale Area signs to the timber sale.

# **TIMBER SALE LOCATION MAP**

## **Schaffer Road**

### **Township 19 S., Range 5 W., Section 27**

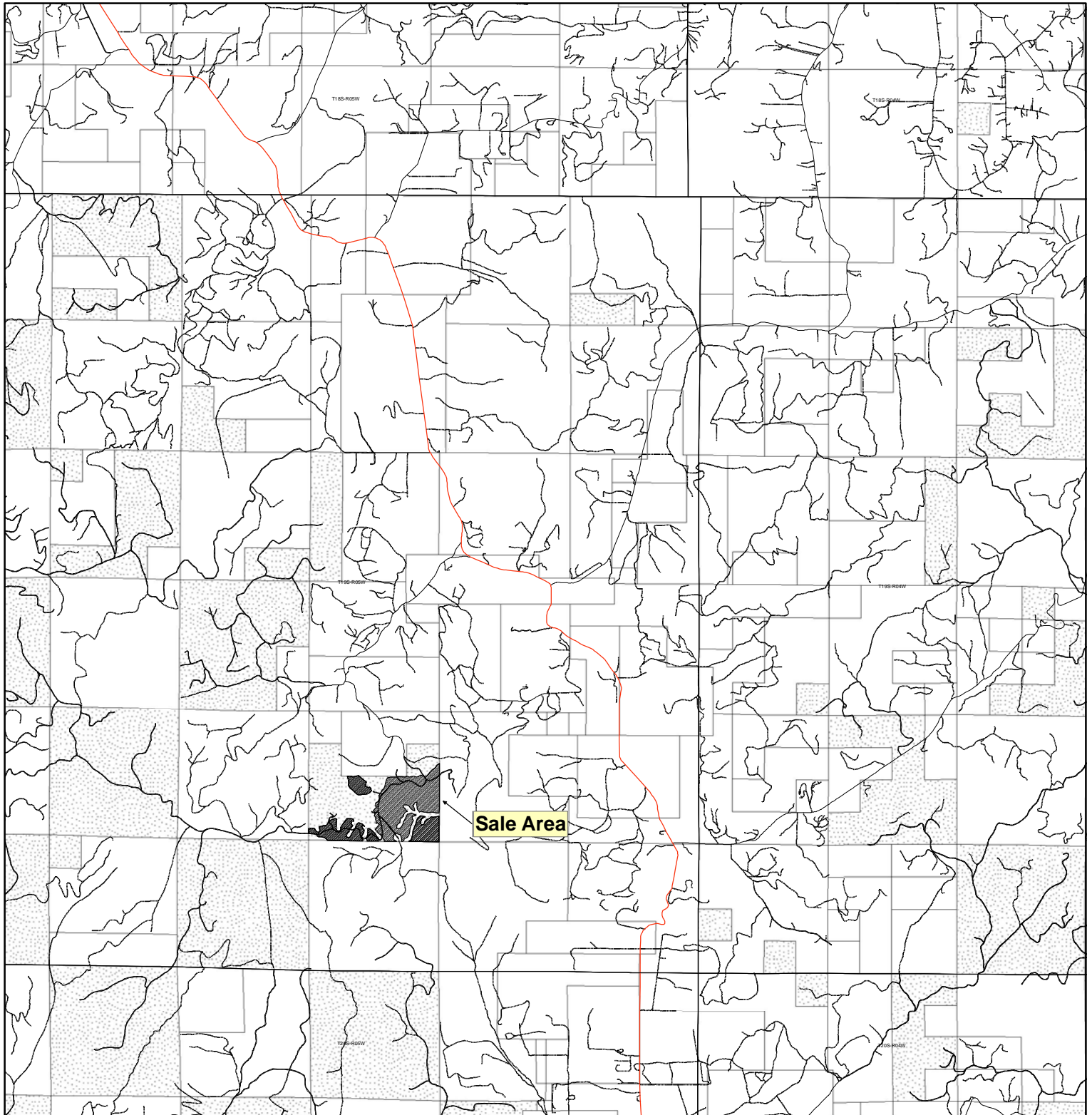

# Seasonal Restriction Matrix

Restricted Times are Shaded and X'd

	Jan		Feb		Mar		Apr		May		June		July		Aug		Sept		Oct		Nov		Dec	
	1	15	1	15	1	15	1	15	1	15	1	15	1	15	1	15	1	15	1	15	1	15	1	15
<b>Felling, yarding or loading</b>																								
<u>Partial Harvest Area</u>																								
<ul style="list-style-type: none"> <li>April 15 – June 15, both days inclusive</li> <li>Sap flow seasonal restriction may be conditionally waived</li> </ul>																								
<b>Ground-based yarding</b>																								
<u>Partial Harvest Area</u>																								
<ul style="list-style-type: none"> <li>Typically October 1 – June 30; may vary due to weather conditions</li> </ul>																								
<b>Right-of-way logging and clearing</b>																								
<u>Right-of-Way Area</u>																								
<ul style="list-style-type: none"> <li>Typically October 1 – May 31; may vary due to weather conditions</li> </ul>																								
<b>Hauling on natural surfaced roads</b>																								
<u>Partial Harvest Area</u>																								
<ul style="list-style-type: none"> <li>Typically October 15 – May 31; may vary due to weather conditions</li> </ul>																								
<b>Drainage renovation instream work</b>																								
<u>Road No. 19-5-22.2</u>																								
Typically October 15 – June 30, both days inclusive to comply with ODFW instream period																								

NOTE: This chart is for informational purposes only. Refer to Section 41 Special Provisions of the timber sale contract for exact date restrictions and stipulations.

## EXHIBIT A

T. 19 S., R. 5 W., SEC. 27, WILL. MER., EUGENE DISTRICT

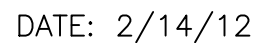

UNITED STATES  
DEPARTMENT OF THE INTERIOR  
BUREAU OF LAND MANAGEMENT

NOTICE OF REQUIREMENT FOR CERTIFICATION  
OF NONSEGREGATED FACILITIES

Bidders and offerors are cautioned as follows: by signing this bid or offer or entering into this contract or lease, as the case may be, the bidder, offeror, or contractor will be deemed to have signed and agreed to the provisions of the Certification of Non-segregated Facilities in this solicitation. The certification provides that the bidder or offeror does not maintain or provide for his employees facilities which are segregated on a basis of race, color, religion, sex, or national origin, whether such facilities are segregated by directive or on a de facto basis. The certification also provides that he will not maintain such segregated facilities. Failure of a bidder or offeror to agree to the Certification of Nonsegregated Facilities will render his bid or offer nonresponsive to the terms of solicitations involving awards of contract exceeding \$10,000 which are not exempt from the provisions of the Equal Opportunity clause.

---

In accordance with 41 CFR 60, as amended May 19, 1967, and Executive Order No. 11246 of September 24, 1965, as amended, this notification will be included in all notices of invitations for bid, lease, offers, and requests for proposal where prospective nonexempt contracts may exceed \$10,000.