



90-DAY TIMBER SALE NOTICE

United States Department of the Interior

BUREAU OF LAND MANAGEMENT
Springfield Interagency Office, Northwest Oregon District
3106 Pierce Parkway Suite E, Springfield, Oregon 97477
<http://www.blm.gov>



August 23, 2018

Parcel No. 2, Contract No. ORN03-TS18-325
Turn and Burn Timber Sale
Siuslaw Field Office

90-DAY TIMBER SALE NOTICE

The timber described in the attached document was offered for sale on August 23, 2018 ; no bids were received; therefore, pursuant to 43 CFR 5443.1, the sale of such timber is kept open for a period not to exceed 90 days from the above mentioned date.

Written bids will be received for not less than the advertised appraised price during the time the sale is open. The required deposit must accompany the bid. Notice of receipt of any bids submitted on a sale will be posted for a period of seven days, during which time other written bids may be submitted. If no other bids are submitted within the seven-day period, the sole bidder shall be deemed the high bidder. If more than one written bid is submitted, an oral auction will be held after notice to the bidders.

For SBA Set-Aside Sales: In the event of a no bid sale, restrictions against large business bids are lifted, and all qualified Purchasers may bid on the sale regardless of company size.

Further information concerning this sale may be obtained from the above address.

See attached TSN

NORTHWEST OREGON DISTRICT
SIUSLAW FIELD OFFICE

**TIMBER SALE NOTICE
LUMP SUM
EUGENE MASTER UNIT
SBA Sale**

PARCEL NO.: 2
SALE DATE: August 23, 2018

Contract No.: ORN03-TS18-325, Turn and Burn
Douglas County, Oregon: O & C: Oral Auction

Bid Deposit Required: \$92,200.00

All timber designated for cutting on: Sec. 9, T. 20 S., R. 7 W., Will. Mer.

Estimated Volume 32' Log (MBF)	Species	Estimated Volume 16' Log (MBF)	Appraised Price Per MBF	Estimated Volume Times Approx. Price
3,071	Douglas-fir	3,431	\$ 268.60	\$ 921,566.60
2	Western hemlock	3	\$ 43.80	131.40
1	Red alder	1	\$ 37.00	37.00
3,074	TOTALS	3,435		\$ 921,735.00

APPRAISED PRICES are calculated by determining market value through the analytical appraisal method. The minimum bid increment will be \$0.10 per MBF or multiples thereof.

LOG EXPORT RESTRICTIONS: All timber offered for sale hereunder is restricted from export from the United States in the form of unprocessed timber and is prohibited from being used as a substitute for exported private timber.

NOTE: The volume for this timber sale has been calculated using 16 foot eastside Scribner rules, and the 32 foot log volumes are estimates derived from the 16 foot volumes.

CRUISE INFORMATION: Volume for all Douglas-fir and western hemlock in the Partial Harvest Area was variable plot cruised. Plot data is then used to calculate v-bar and basal area per acre using the National Cruise Processing Program. The basal area was determined with a Relaskop using a 20 BAF. This sale contains a total of 228 plots. A total of 80 sample trees were randomly selected on these plots to determine v-bar.

All Douglas-fir in the right-of-ways have been cruised using the 3P system to select sample trees. The sample trees have been cruised and the volume computed using the National Cruise Processing Program for estimating volume in 16 foot lengths and the volume expanded to a total right-of-way volume. A map showing the location and description of these sample trees is available at the Northwest Oregon District's Springfield Interagency Office.

Volume for red alder in the right-of-way was based on a 100% cruise using the National Cruise Processing Program for estimating board foot volume of trees in 16 foot logs.

With respect to merchantable Douglas-fir (sample) trees: The average tree is 11.6" DBHOB; the average log contains 34 bd. ft.; the total gross merchantable volume is approximately 3,550 MBF; and 96% recovery is expected.

CUTTING AREA: One area totaling approximately 248 acres must be partial harvested and approximately 6.9 acres of right-of-way must be clear cut.

ACCESS: Access to the sale is provided by:

1. A public road;
2. BLM existing roads;
3. BLM roads to be constructed;
4. Roads covered by a Right-of-Way and Road Use Agreement E-142 between Oxbow Timber 1, LLC (OT1) and the United States. In the construction, renovation, improvement, and use of private roads, the Purchaser shall enter into a license agreement with OT1. The license agreement shall be delivered to for execution at least 15 days prior to any use of company roads. See the Prospectus for full terms and conditions of use.

ROAD MAINTENANCE: The Purchaser shall pay to Oxbow Timber 1, LLC road use fees of \$3,502.00 and road maintenance and rockwear fees estimated at \$2,799.86. The Purchaser shall pay BLM a road maintenance fee of \$20,845.39 and a rockwear fee of \$435.43. In addition to the quantities shown below, 300 cubic yards (truck measure) of maintenance rock and roadside landing rock is required. Additional road reinforcement (rocking) may be required for wet weather haul and will be at the Purchaser's expense. Load tickets are required for maintenance rock accounting. See Exhibit D map for specification of road maintenance responsibility. Only the map page of Exhibit D is included in the Prospectus. Refer to the contract file for the full Exhibit D.

ROAD CONSTRUCTION:

Spurs A, D, and E, and Road No. 20-7-16.9 B

Length: 12.5 Stations

Class: SN-14

Special Requirements in Road Construction: Operations limited to periods of dry weather.

ROAD RENOVATION:

Spurs B and C, and Road Nos. 20-7-8.3 B, 20-7-8.4, 20-7-8.5 A-B, 20-7-9.1, 20-7-9.2, 20-7-9.71, 20-7-9.72, and 20-7-16.9 A.

Length: 95.81 Stations

Class: SN-14 / SN-16

Special Requirements in Road Renovation: Operations may be limited to periods of dry weather.

ROAD IMPROVEMENT:

Road Nos. 20-7-8.8 A, 20-7-8.8 B, 20-7-9, and 20-7-9.73

Length: 85.16 Stations

Class: SN-14

Special Requirements in Road Improvement: Operations limited to periods of dry weather.

Culverts

<u>Diameter:</u>	<u>Length:</u>	<u>Number:</u>
18"	30'	2

Suggested Rock Source: Commercial, Lorane Vicinity

Estimated Rock Quantities Cubic Yards (truck measure)

<u>3/4" minus</u>	<u>3" minus</u>	<u>6" minus</u>	<u>Pit Run</u>
60	532	4,768	40

Total Estimated Exhibit C Road Costs (construction, renovation, and improvement): \$269,640.82**DURATION OF CONTRACT:** Duration of the contract will be 36 months for cutting and removal of timber.**SPECIAL PROVISIONS:** The contract will contain special provisions regarding road construction, road renovation, road improvement, road maintenance, road decommissioning, logging methods, prevention of erosion, falling of snags, falling of all trees designated for cutting, logging residue reduction, and submission of a written logging plan specifying landing locations, spur road location, logging methods and logging schedule

Under Sec. 26 of the timber sale contract, tractor logging will be prohibited during periods of excessive soil moisture. This will normally limit tractor logging to July, August and September.

It is estimated that approximately 515 MBF of additional timber, such as corridor and guyline trees, may be removed under the contract, but it is not included in the advertised sale volume, nor is it included in the timber sale appraisal.

A revised Special Provision has been added to the contract which enables the Contracting Officer to suspend the contract to facilitate protection of certain plant or animal species, and/or to modify or terminate the contract when necessary to: (1) comply with the Endangered Species Act or to prevent incidental take of northern spotted owls in accordance with management direction in the Record of Decision (ROD) and Resource Management Plan (RMP), or; (2) comply with a court order, or; (3) protect species which were identified for protection through survey and manage and/or protection buffer standards and guidelines or management direction established in the ROD and RMP.**OTHER SPECIAL REQUIREMENTS:**

- No yarding or hauling shall be conducted on natural surfaced roads during periods of wet weather, as determined by the Authorized Officer.
- Yarding shall be done with a carriage equipped skyline capable of yarding 1,700 feet slope distance in the Partial Harvest Area.
- Yarding wedges will be required across private land.
- In the Special Yarding Area, logs may be yarded through the Reserve Area.
- Within the Special Yarding Riparian Area, logs shall be fully suspended ABOVE the tree canopy.

- During timber sale operations, the Purchaser shall keep Road Nos. 19-7-25.1 and 20-7-3, shown on Exhibit A where it passes through the contract area, clear of trees, rock, dirt, and other debris so far as is practicable. The road shall not be blocked by such operations for more than 20 minutes.
- Surfacing on paved Road Nos. 19-7-25.1 and 20-7-3, shall be protected during timber sale operations. Damages associated with timber sale operations shall be repaired at the Purchaser's expense and in accordance with Exhibit D.
- The Purchaser shall provide sufficient flag persons and signs to control traffic whenever timber sale operations present a hazard.
- The Purchaser shall rock Spurs D and E, and Road Nos. 20-7-8.3B, 20-7-8.4, 20-7-9, 20-7-9.1, 20-7-9.2, 20-7-9.71, 20-7-9.72, 20-7-9.73, and 20-7-16.9, for wet weather haul. Rocking shall be in accordance with Exhibit C. If the Purchaser exercises the option to not rock any of these roads, the purchase price will be increased by the cost of surfacing as appraised at the time of sale.
- Upon completion of hauling, additional decommissioning shall be completed during the dry season and as directed by the Authorized Officer. Decommissioning measures may include:
 - Decompact skid trails and natural surface roads with decompaction equipment, such as a track mounted excavator.
 - Construct drainage dips, waterbars, and/or lead-off ditches.
 - Place logging slash greater than 6 inches in diameter on surfaces in a discontinuous pattern.
 - Block at entry points using stumps, slash, and/or cull logs as directed by the Authorized Officer.
- Section 42(f) contains explicit instruction on requirements for equipment and personnel involved in pile burning.

OPTIONAL CONTRIBUTION: The Purchaser will not have the option of contributing in lieu of performing the slash disposal requirements of this contract.

NARRATIVE DESCRIPTION OF HOW TO GET TO THE TIMBER SALE AREA: Access to the sale is through locked gates over private roads. Prospective bidders may obtain a key from the Northwest Oregon District's Springfield Interagency Office and proceed to the sale area. Any other persons interested in visiting the timber sale site should first contact Christopher Finn at (541) 683-6421.

From Veneta, proceed south on Territorial Highway for approximately 5.8 miles to junction of Territorial Highway and Wolf Creek Road. Turn west onto Wolf Creek Road and proceed for approximately 6.9 miles, stay to the right on Wolf Creek Road and proceed for approximately 4.7 miles to junction of Wolf Creek Road and Siuslaw River Road. Turn west onto Siuslaw River Road and proceed for approximately 1.7 miles to junction of Siuslaw River Road, and BLM Road No. 19-7-25.1 (East Oxbow). Stay to the left on BLM Road No. 19-7-25.1 (East Oxbow) and proceed for approximately 2.6 miles to junction of BLM Road No. 19-7-25.1 (East Oxbow) and BLM Road No. 20-7-3 (Bear Creek Mainline). Turn south onto BLM Road No. 20-7-3 (Bear Creek Mainline) and follow the timber sale signs to the sale area.



Timber Sale Location Map Turn and Burn

T. 20 S., R. 7 W., Sec. 9

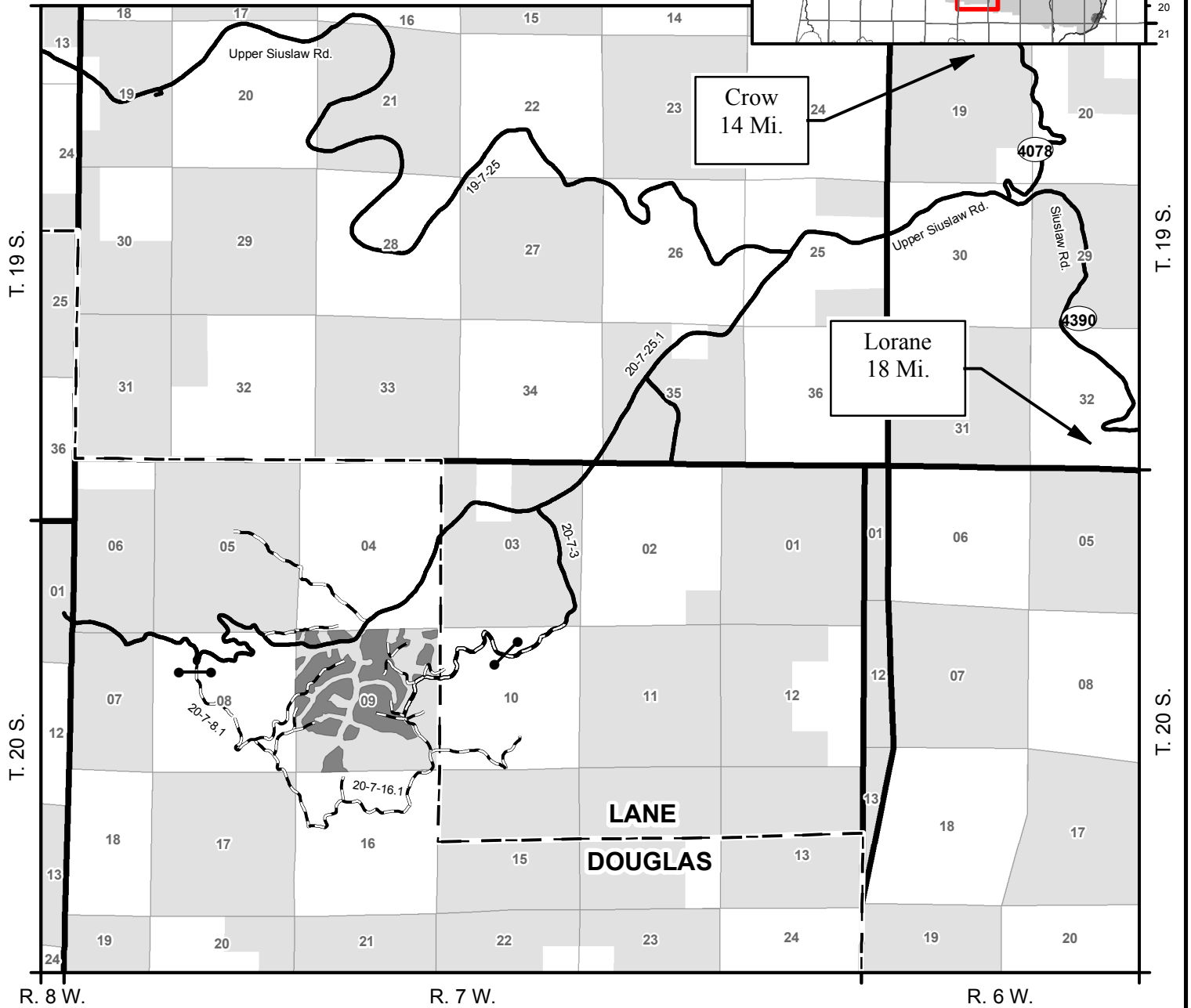
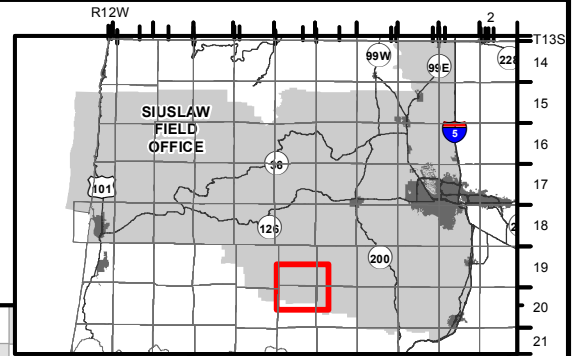

Seasonal Restriction Matrix

Restricted Periods are Shaded and X'd

	Jan		Feb		Mar		Apr		May		June		July		Aug		Sept		Oct		Nov		Dec	
	1	15	1	15	1	15	1	15	1	15	1	15	1	15	1	15	1	15	1	15	1	15	1	15
Felling, yarding, or loading																								
<u>Partial Harvest Area</u>																								
<ul style="list-style-type: none"> April 15 – June 15, both days inclusive. Sap flow seasonal restriction may be conditionally waived. 																								
Ground-based yarding																								
<u>Partial Harvest Area</u>																								
<ul style="list-style-type: none"> Typically October 1 – June 30; may vary due to weather conditions. 																								
Right-of-way logging and clearing																								
<u>Right-of-Way Areas</u>																								
<ul style="list-style-type: none"> Typically October 1 – May 31; may vary due to weather conditions. 																								
Hauling on natural-surfaced roads																								
<u>Partial Harvest Area</u>																								
<ul style="list-style-type: none"> Typically October 15 – May 31; may vary due to weather conditions. 																								

NOTE: This chart is for informational purposes only. Refer to Section 42 Special Provisions of the timber sale contract for exact date restrictions and stipulations.



UNITED STATES
DEPARTMENT OF THE INTERIOR
Bureau of Land Management

Turn and Burn Timber Sale Contract No. ORN03-TS18-325

T. 20 S., R. 7 W., Sec. 9, Northwest Oregon District

Exhibit A

No warranty is made by the Bureau of Land Management as to the accuracy, reliability, or completeness of these data for individual or aggregate use with other data. Original data were compiled from various sources and may be updated without notification.

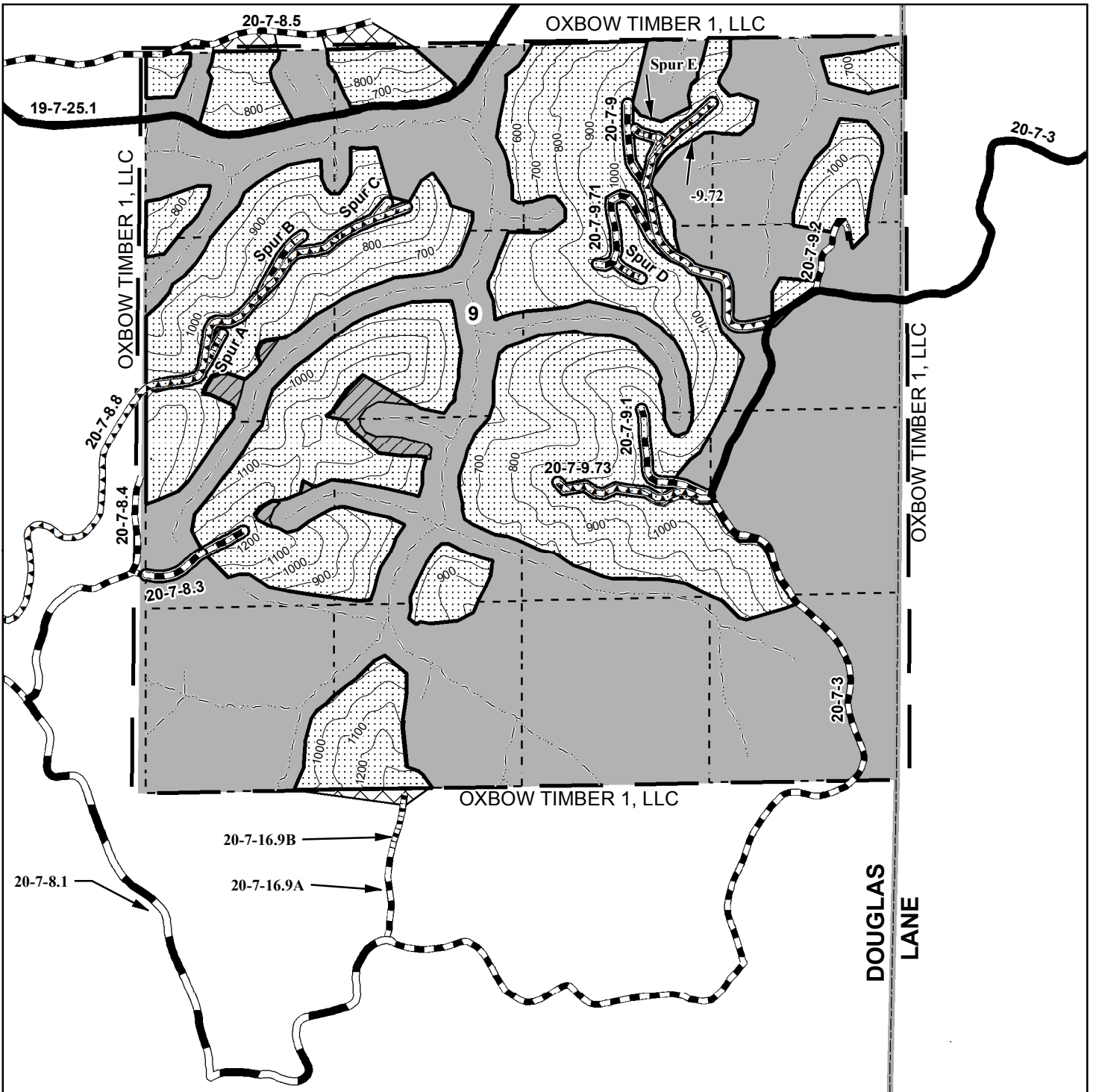

- Boundary - Cutting Area (Blazed, Painted, & Posted)
- Contract Area
- Partial Harvest Area
- Reserve Area
- Special Yarding Area
- Yarding Wedge
- Streams
- Construction
- Renovation
- Improvement
- Paved Road
- Rocked Road
- Right Of Way Area
- County Boundary Line

Total Partial Harvest Area	248.0
Total Right of Way Area	6.9
Total Reserve Area	385.1
Total Contract Area	640.0 A

