



LEGEND



-  WILDERNESS STUDY AREA
-  AREA WITHOUT CHARACTERISTICS

53-4
LITTLE WOOD RIVER

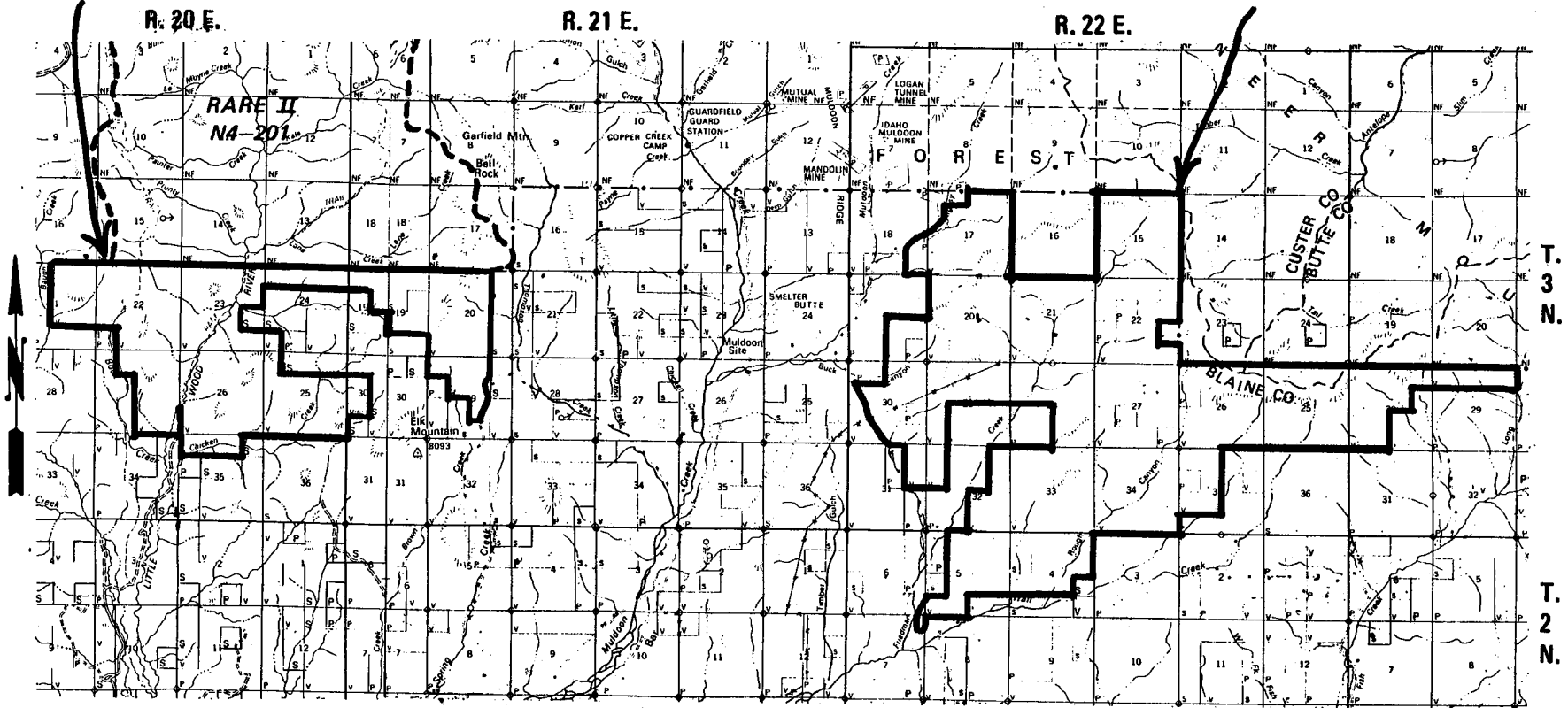
53-5
FRIEDMAN CREEK



LEGEND

-  WILDERNESS STUDY AREA
-  AREA WITHOUT CHARACTERISTICS

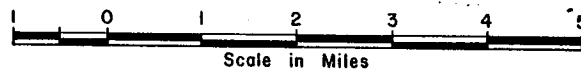

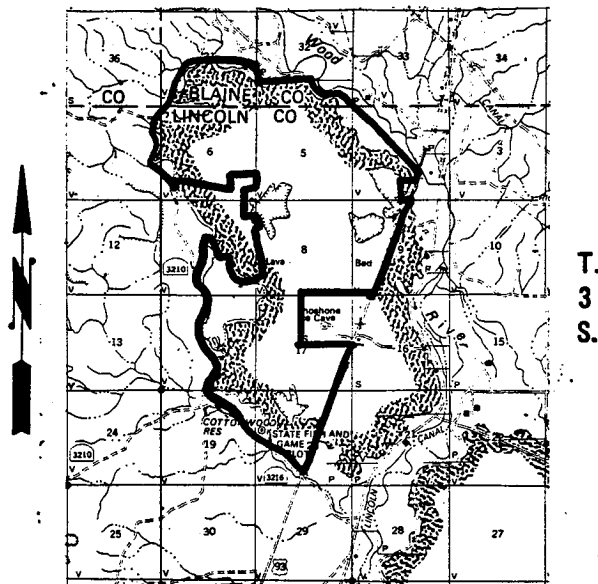

**54-2
BLACK BUTTE**

R. 18 E.



**T.
3
S.**

LEGEND

-  **WILDERNESS STUDY AREA**
-  **AREA WITHOUT CHARACTERISTICS**

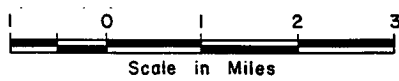

SUMMARY
IDAHO INTENSIVE WILDERNESS INVENTORY

FINAL DECISION

<u>DISTRICT</u>	<u>IDENTIFIED AS WSA</u>		<u>NOT IDENTIFIED AS WSA</u>		<u>TOTAL</u>	
	<u>UNITS</u>	<u>ACRES</u>	<u>UNITS</u>	<u>ACRES</u>	<u>UNITS</u>	<u>ACRES</u>
Boise	8	335,350	23	467,894	31	803,244
Burley	1	11,298	6	59,144	7	70,442
Idaho Falls	6	157,630	18	227,027	24	384,657
Salmon	3	53,002	7	86,499	10	139,501
Shoshone	12	222,458	16	264,501	28	486,959
Coeur d'Alene	6	38,468	4	14,984	10	53,452
		<hr/>		<hr/>		<hr/>
TOTAL	36	818,206	74	1,120,049	110	1,938,255

INTENSIVE INVENTORY FINAL DECISIONS

		<u>Acres Identified as WSA</u>	<u>Acres Not Identified as WSA</u>	<u>Page</u>
<u>Boise District</u>				
11-17	Outcrop		6,420	1-2
14-19	Long Tom Creek		13,226	1-4
14-21	Bennett Creek		11,162	1-7
16-2	Jump Creek		8,301	1-9
16-9	Reynolds Creek Canyon		14,650	1-12
16-49c	Squaw Meadows		10,316	1-16
17-1a	Lookout Butte		20,077	1-18
17-1b	East Fork Bruneau River		10,178	1-21
17-6	Dry Lakes		26,208	1-24
17-7	Clover Crossing		6,314	1-27
17-10	Lower Salmon Falls Creek <u>1/</u>	3,500	18,787	1-68
17-11	Jarbridge River	75,340	35,670	1-71
17-12	Poison Creek		13,532	1-30
18-1	Wildhorse		7,472	1-33
19-1	Cold Springs Creek		21,380	1-36
110-91a	Box Creek	428		1-76
111-5	Poison Gulch		30,742	1-38
111-6	Little Jack's Creek	58,040	16,879	1-78
111-7a	Big Hill		12,924	1-41
111-7b	Duncan Creek		10,005	1-43
111-7c	Big Jack's Creek	54,833	10,301	1-84
111-12	Sheep Trail		19,702	1-46
111-17	Bruneau River	107,020	27,042	1-88
111-18	Pole Creek	24,509	7,247	1-93
111-19a	Camas Creek		19,347	1-49
111-19b	Bull Gulch		33,150	1-52
111-20a	Big Springs		5,342	1-55
111-20b	Upper Battle Creek		17,787	1-58
111-21	Bull Basin		17,625	1-61
111-36a	Sheep Creek West	11,680	3,696	1-96
111-36b	Sheep Creek East		12,412	1-64
	Boise District Total	335,350	467,894	

Burley District

23-1a	Jim Sage		6,901	2-2
23-1c	Jim Sage		7,010	2-5
26-1	Hanzel Mountain		20,615	2-8
26-3	South Samaria		6,615	2-11
27-1	South Deep Creek		9,609	2-14
27-2	Deep Creek Peak		6,646	2-17
28-1	Petticoat Peak	11,298	1,748	2-21
	Burley District Total	11,298	59,144	

Idaho Falls District

31-10	Illinois		11,150	3-2
31-11	Deadman Canyon		23,000	3-4
31-13	Timbered Dome		10,240	3-6
31-14	Appendicitis Hill	24,870	630	3-50
31-15	Dry Hollow		17,800	3-8
31-17	White Knob Mountains	9,950		3-53
32-2	Sands Canyon		8,010	3-11
32-3	Hawley Mountain	15,510	640	3-56

Idaho Falls District (cont'd)		Acres Identified as WSA	Acres Not Identified as WSA	Page
32-4	Taylor Mountain		11,134	3-14
32-9	Black Canyon	5,400		3-59
32-16	Pass Creek		1,220	3-17
33-4	Cedar Butte	35,700	3,120	3-62
33-5	Skull		8,650	3-19
33-6	Rye Grass		8,000	3-22
33-7	Cottontail		9,300	3-25
33-12	Split Top		18,080	3-28
33-13	Bear Point		20,650	3-31
33-14	Mosby Butte		35,720	3-34
33-15	Hell's Half Acre	66,200	2,720	3-65
33-16	Morgan		9,420	3-37
33-22	Cox's Place		12,790	3-40
33-23	Bear Trap		13,860	3-42
33-24	Firth Quad Islands		86	3-45
33-25	Moreland Quad Islands		807	3-47
Idaho Falls District Total		157,630	227,027	

Salmon District

41-3	Geertson Creek		10,720	4-2
42-6	Baldy Basin		10,720	4-4
43-3	Eighteen Mile	24,922		4-17
44-2	King Mountain		12,602	4-6
44-3	Hat Creek		9,707	4-8
44-4	Ellis Creek		28,040	4-10
44-9	Cronks Canyon		7,470	4-12
45-5	Mill Creek		1,330	4-14
45-12	Burnt Creek <u>2/</u>	24,980	5,130	4-20
47-4	Borah Peak	3,100	780	4-23
Salmon District Total		53,002	86,499	

Shoshone District

54-3	Preacher Creek		8,827	5-2
54-4	Rattlesnake Canyon		11,355	5-5
54-5	Little City of Rocks	5,875	95	5-46
54-6	Black Canyon	10,371	10,589	5-49
54-7	Four Mile Bench		7,542	5-8
54-8a	Gooding City of Rocks	14,743) 2,440	5-52
54-8b	Gooding City of Rocks	6,287)
54-9	Clover Creek		8,455	5-10
54-10	Deer Creek	7,487	1,394	5-55
54-11	Indian		16,968	5-12
54-12	Dempsey Creek		23,644	5-14
54-13	Forgotten Hills		9,420	5-16
56-2	Lava	23,680	1,913	5-58
57-2	Shale Butte	15,968	5,930	5-61
57-3	Antelope		12,271	5-18
57-4	Black Ridge Crater		8,138	5-21
57-5	Lone Rock		10,934	5-24
57-6	Wildhorse		21,544	5-27
57-7	Pagari		33,116	5-30
57-8	Sand Butte	20,792	15,953	5-64
57-10	Raven's Eye	67,110	190	5-67
57-11	Little Deer	33,531	9,443	5-70
57-12	Laidlaw Butte		9,868	5-33
57-13	Potter Butte		16,180	5-36
57-14	Bear Den Butte	9,700	4	5-73
57-15	Point		7,398	5-39
57-16	MacRae Lake		7,876	5-42
59-7	Shoshone	6,914	3,014	5-75
Shoshone District Total		222,458	264,501	

		<u>Acres Identified as WSA</u>	<u>Acres Not Identified as WSA</u>	<u>Page</u>
<u>Coeur d'Alene District</u>				
61-1	Selkirk Crest	720	440	6-14
61-6c	Hideaway Island		170	6-2
61-9	Rochat Creek		6,960	6-5
61-10	Crystal Lake	9,027		6-17
61-15a	Grandmother Mountain	10,339		6-20
61-15b	Grandmother Mountain	6,790		6-20
62-1	Snowhole Rapids	5,068	238	6-23
62-2	Confluence		5,110	6-7
62-4	Big Canyon		1,100	6-10
62-10	Marshall Mountain	<u>6,524</u>	<u>966</u>	6-26
	Coeur d'Alene District Total	38,468	14,984	
	STATE TOTAL	818,206	1,120,049	

1/ Portion of unit is in the Burley District.

2/ Portion of unit is in the Idaho Falls District.