

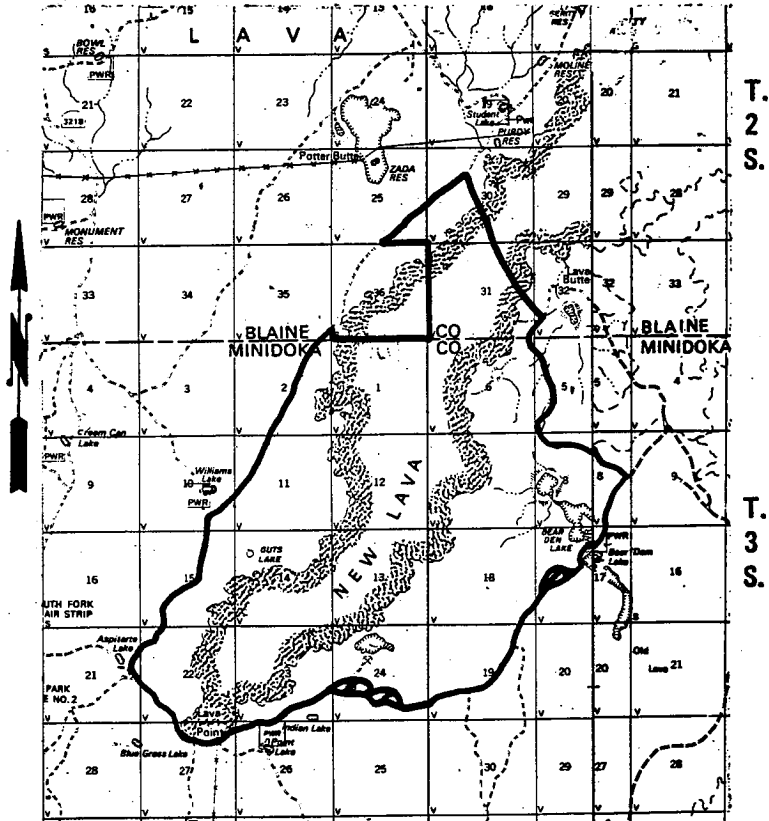

**57-14
BEAR DEN BUTTE**

R. 24 E.

R. 25 E.



LEGEND

-  **WILDERNESS STUDY AREA**
-  **AREA WITHOUT CHARACTERISTICS**



57-14 BEAR DEN BUTTE

The April 1980 proposed decision included the following evaluation of wilderness characteristics.

SIZE AND PHYSICAL CHARACTERISTICS:

The unit contains 9,704 acres of BLM land. The unit is dominated by a finger of new lava which juts into Laidlaw Park from the Craters of the Moon Lava Flow. The unit is surrounded by a fringe of rolling desert grassland except where the road forming the north boundary cuts through the lava. Bear Den Butte and a smaller unnamed volcanic butte are prominent landmarks within the unit, representing older periods of volcanic activity. Vegetation is primarily sagebrush and grasses on the desert fringe with very sparse vegetation occurring in the newer lava.

NATURALNESS:

Two short access routes, which meet the road definition, serve as turnouts along the south boundary road. These roads have caused deletion of two small parcels from the unit. Two other access routes, which are not substantially noticeable imprints on the naturalness of the unit, extend into the unit from the south and west boundaries.

SOLITUDE:

Opportunities for solitude exist throughout most of the unit. Its remote location, the absence of man-made features, and the low probability of meeting others enhance opportunities for solitude. Outstanding opportunities for solitude have been judged to be present within the lava formation which occupies the central portion of the unit. The rugged, broken topography in the lavas provides excellent screening.

PRIMITIVE AND UNCONFINED RECREATION:

Primitive recreation opportunities within the area are considered outstanding and generally focus on the volcanic features and associated biotic community. Activities include hiking, camping, photography, and nature study. The unit offers a challenge and risk with all recreation activities which enhances the primitive experience. The factors of challenge and risk are emphasized by the rugged terrain, lack of reliable water sources, extreme temperatures, and lack of natural shelter.

SUPPLEMENTAL VALUES:

The new lava flow offers excellent opportunities to study primary succession, vegetational species that are indigenous to new lava, and geology of lava formations. Pronghorn antelope, deer, and other species of wildlife are found in the unit. Guts Lake, a series of lake beds along the western side of the unit, may have archaeological value. Bear Den Butte (5,104 feet elevation) and another butte (5,022 feet) offer scenic values.

REHABILITATION:

One access route has revegetated to a condition where it is difficult to distinguish from the surrounding area. Once erosion is stabilized with hand labor, another route should revegetate naturally and become difficult to distinguish from the surrounding area. A fence line could be removed by hand labor or modified to be much less noticeable.

* * *

PUBLIC COMMENT SUMMARY:

All but one of the comments which specifically addressed the unit supported the proposed decision to identify a study area. One comment expressed a concern over the statements on rehabilitation.

COMMENT EVALUATION:

The reference in the proposed decision to rehabilitation was to the portions of the unit that meet the naturalness criteria, not to portions that do not.

* * *



DECISION:

No new information was received through public comments that would warrant a change in the decision. A unit of 9,700 acres is identified as a wilderness study area as it meets the naturalness and the solitude-recreation criteria.

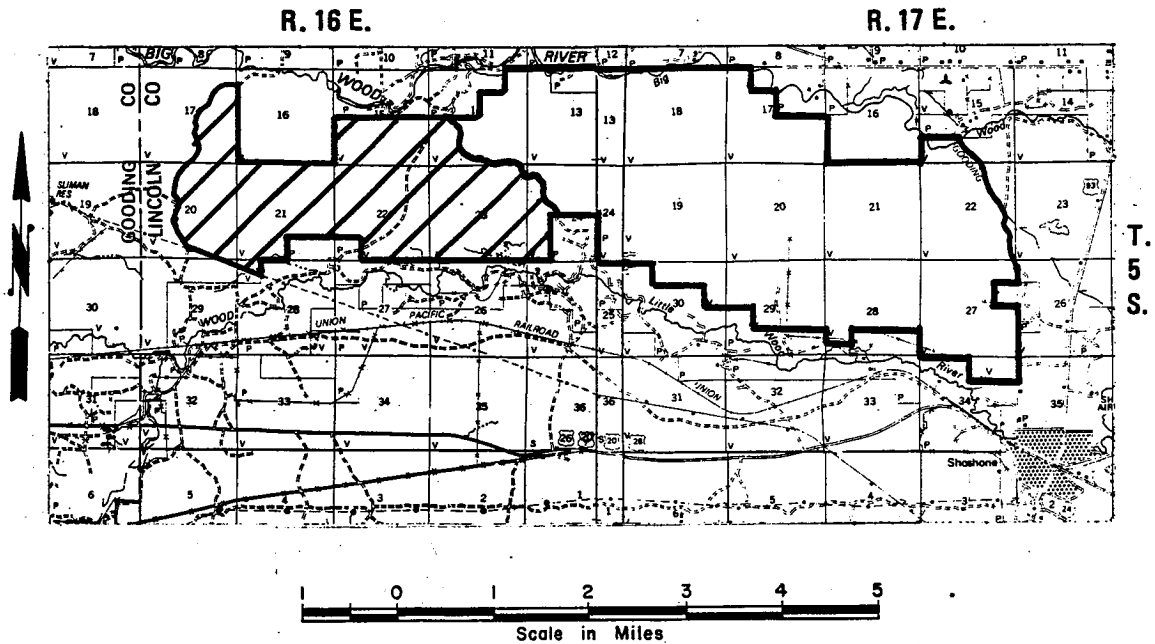
59-7
SHOSHONE



LEGEND

-  WILDERNESS STUDY AREA
-  AREA WITHOUT CHARACTERISTICS

The April 1980 proposed decision included the following evaluation of wilderness characteristics.

SIZE AND PHYSICAL CHARACTERISTICS:

The unit contains 9,928 acres of BLM land. This unit was called Lava in the August, 1979, report. The unit is entirely covered with a relatively recent lava flow which originated from the Black Butte vent. This lava flow is extremely rough, with numerous subsidence craters, pressure ridges, and other volcanic formations found throughout the unit. Vegetation is generally sparse, but in some places sagebrush and grasses have become established.

NATURALNESS:

Two access routes, which meet the road definition have caused part of the unit to be deleted on the western side.

SOLITUDE:

Opportunities for solitude exist throughout most of the unit. Its remote location, the absence of man-made features, and the low probability of meeting other visitors enhance opportunities for solitude. Outstanding opportunities for solitude have been judged to be present within the lava formation which occupies the central portion of the unit. The rugged, broken topography in the lavas provides excellent screening.

PRIMITIVE AND UNCONFINED RECREATION:

Primitive recreation opportunities within the unit are considered outstanding and generally focus on the volcanic features and associated biotic community. Activities include hiking, camping, photography, and nature study. The unit offers a challenge and risk with all recreation activities which enhances the primitive experience. The factors of challenge and risk are emphasized by the rugged terrain, lack of reliable water sources, extreme temperatures, and lack of natural shelter.

SUPPLEMENTAL VALUES:

The unit provides several opportunities to study phenomena related to volcanism.

* * *

PUBLIC COMMENT SUMMARY:

Comments that supported the proposed decision to identify the unit as a study area are summarized as follows:

- The unit clearly meets the criteria for naturalness.
- Outstanding opportunities for solitude and for primitive recreation exist within the unit.
- Various supplemental values are found within the unit.

One comment expressed a concern over the statements on rehabilitation.

COMMENT EVALUATION:

The reference in the proposed decision to rehabilitation was to portions of the unit that meet the naturalness criteria, not to portions that do not.

* * *

DECISION:

No new information was received through public comments that would warrant a change in the decision. A unit of 6,914 acres is identified as a wilderness study area as it meets the naturalness and the solitude-recreation criteria.