

Posted: _____

**U.S. Department of the Interior
Bureau of Land Management
Kremmling Field Office
P.O. Box 68
Kremmling, CO 80459**

CATEGORICAL EXCLUSION

A. Background

BLM Office: __Kremmling_____

Lease/Serial/Case File No.: __COC-74128__

Number: DOI-BLM-CO-120-2010-0003CX

Proposed Action Title/Type: San Toy Communication Site for Emergency Services

Location of Proposed Action: T. 1N., R. 81W., Section 35

Description of Proposed Action: Andrews Radio Service has applied for a communication lease for the San Toy Mountain facilities. Andrews Radio Service has coordinated with Grand County and Kremmling Fire Department to become the facility manager for the San Toy emergency services. There is an existing 60 ft. tower, previously owned by the Forest Service that would be used. Next to the tower is an existing building, also previously owned by the Forest Service that would be used to house the communication equipment. David Andrews has gone in recently and removed all old batteries and cleaned up the building. All equipment would be battery or solar powered. An access road already exists for the communication sites in that area.

San Toy Commsite

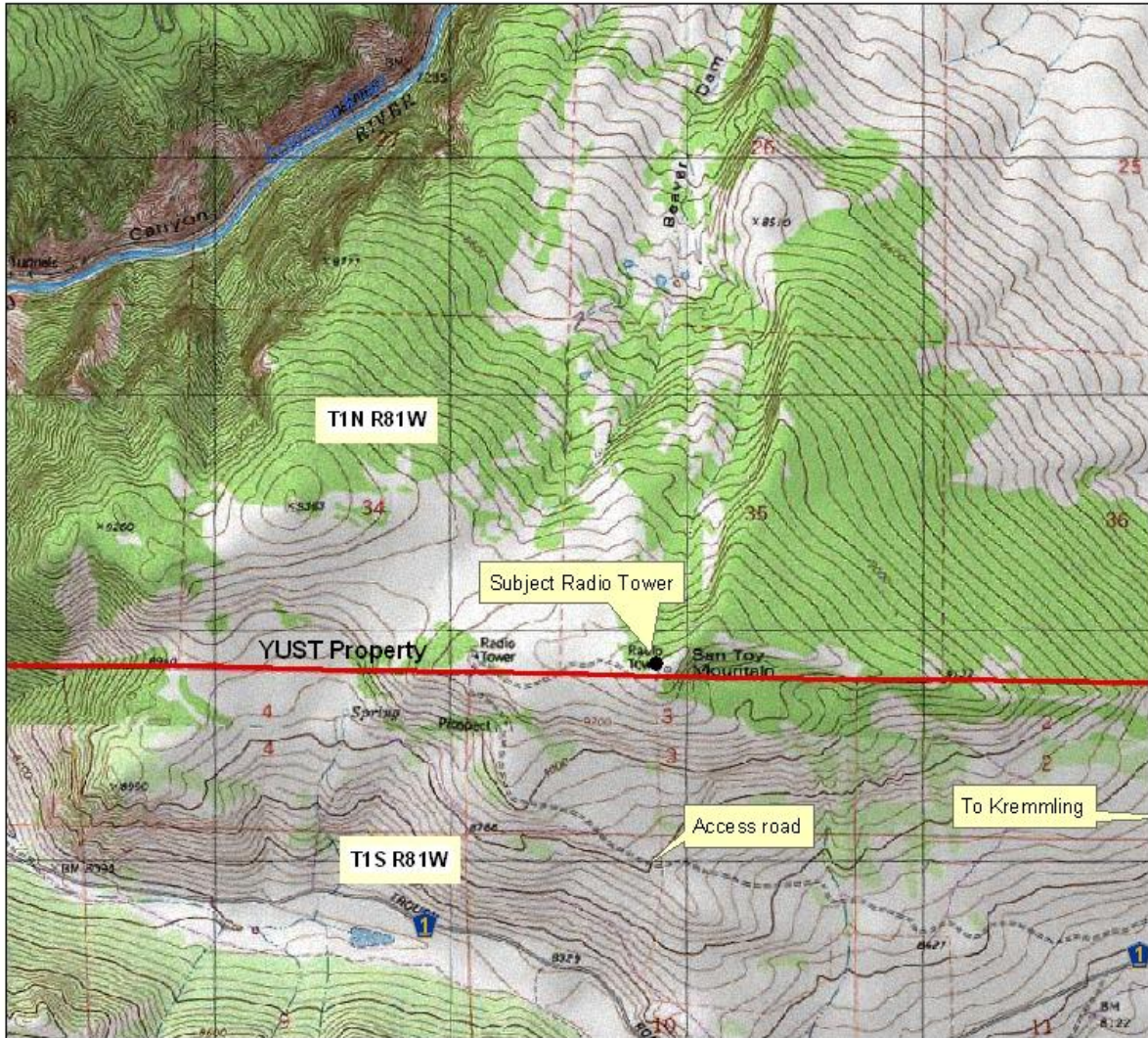

Legend	
County Roads	Land Status
Major Roads	Bureau of Land Mgt
Reservoirs	Division of Wildlife
Major Streams	National Park
Wilderness Study Area	National Rec Area
ACEC	National Wildlife Refuge
	Private
	State
	State Forest
	US Forest Service

0 0.125 0.25 0.5 Miles

1:24,000

No Warranty is made by the Bureau of Land Management as to the Accuracy, Reliability, or Completeness of this Data for Individual Use or Aggregate Use with Other Data.

Maps: Kremmling, Sheephorn Mountain
BLM, Kremmling FO 10/7/09
gisuser/nepa/2009/santoy

B. Land Use Plan Conformance

Land Use Plan Name: _ Kremmling Resource Management Plan (RMP), Record of Decision (ROD)

Date Approved/Amended: _ December 19, 1984; Updated February 1999

The proposed action is in conformance with the applicable LUP because it is specifically provided for in the following LUP decisions(s):

Decision Number/Page: II-B-12 pg. 14

Decision Language: Provide the opportunity to utilize public lands for development of facilities which benefit the public, while considering environmental and agency concerns.

C. Compliance with NEPA:

The Proposed Action is categorically excluded from further documentation under the National Environmental Policy Act (NEPA) in accordance with 516 DM 2, Appendix 1, No. (E) (12)

Grants of right-of-way wholly within the boundaries of other compatibly developed rights-of-way.

This categorical exclusion is appropriate in this situation because there are no extraordinary circumstances potentially having effects that may significantly affect the environment. The proposed action has been reviewed, and none of the extraordinary circumstances described in 516 DM2 apply.

INTERDISCIPLINARY REVIEW:

Name	Title	Area of Responsibility	Date Review Completed
Peter McFadden	Assoc. F.M.	NEPA	
Bill Wyatt	Archaeologist	Cultural	10/14/09
Megan McGuire	Wildlife Biologist	T&E	11/5/2009
Paula Belcher	Hydrologist	SWA	10/29/2009
Richard Johnson	Rangeland Management Specialist	Invasive, Non-native species, Vegetation, Range Management	10/30/09
Frank Rupp	Archaeologist	Paleontology	11/12/2009

D. Signature

Authorizing Official: _____ Date: _____

(Signature)

Name: Peter McFadden
Title: Field Manager

Contact Person

For additional information concerning this CX review, contact:

Susan Cassel, Assistant Field Manager
Kremmling Field Office
P O Box 68
Kremmling, CO 80459
970-724-3002

DECISION RECORD
CX # DOI-BLM-CO-120-2010-0003CX

DECISION: It is my decision to authorize the Proposed Action as described in the attached CX.

This decision is in compliance with the Endangered Species Act, National Historic Preservation Act, and the Clean Water Act. This decision is also in conformance with the LUP and other applicable laws, regulations and policies.

This action is listed in the Department Manual as an action that may be categorically excluded. I have evaluated the action and have determined that it does not represent an extraordinary circumstance and is, therefore, categorically excluded from further environmental analysis.

RATIONALE: My rationale for choosing this decision is based on the following facts: The emergency services in Grand County are in need of a good communications site in the west end of the county; San Toy Mountain fits their needs; there is an existing tower and existing building that Andrews Radio Service has agreed to manage; and no ground disturbance needs to occur.

SIGNATURE OF AUTHORIZED OFFICIAL:

DATE SIGNED: