

Posted: _____

**U.S. Department of the Interior
Bureau of Land Management
Kremmling Field Office
P.O. Box 68
Kremmling, CO 80459**

CATEGORICAL EXCLUSION

NUMBER: DOI-BLM-CO-120-2009-0020-CX

PROJECT NAME: Renewal of Livestock Grazing Permits # 0501700 for the Adams Ranch LLC on Allotment 07001 (Adams IND.), #0507728 for the Harry Dowell Estate on Allotments 07049 (N. Sand Creek) and 07050 (Lower Sandhills), and #0502955 for Donald Culver on allotment 07100 (Indiv. Allot.)

LEGAL DESCRIPTION: The Bureau of Land Management (BLM) administered lands includes all or part of the following:

Allotment 07001 (Adams IND.)
T. 10N., R. 78W., Sec. 6, 7, 17, and 21

Allotment 07049 (N. Sand Creek)
T. 10N., R. 79W., Sec 3, 10, and 12

Allotment 07050 (Lower Sandhills)
T. 10N., R. 78W., Sec 6
T. 10N., R. 79W., Sec 1

Allotment 07100 (Indiv. Allot.)
T. 8N., R. 78W., Sec 18 and 19
T. 8N., R. 79W., Sec 13 and 24

APPLICANT: Donald Culver, Doug Hoffman, and Donald Blandin

DESCRIPTION OF PROPOSED ACTION: The Proposed Action would renew the following livestock grazing permits:

0501700 for the Adams Ranch LLC on allotment 07001 (Adams IND),
#0507728 for the Harry Dowell Estate on Allotments 07049 (N. Sand Creek) and 07050 (Lower Sandhills),
#0502955 for Donald Culver on allotment 07100 (Indiv. Allot.).

All three permittees have applied to have their permits renewed. All of the allotments are category “C” allotments with small percentages of public land. Since all of the allotments are low priority “C” allotments, they have not been assessed for compliance with the Standards for Public Land Health in Colorado. All of these allotments, however, were monitored in 2008 and no issues or concerns were identified. The permits would be renewed with no changes to the number or kind of livestock, season of use, or amount of authorized preference expressed in AUMs*.

*AUM=animal unit months=the amount of forage needed to support one cow and her calf for one month.

The permits would authorize livestock grazing to the following extent:

| Allotment | Livestock Number | Kind | Season of Use | Percent Public Land | AUMs |
|--------------------------|------------------|--------|---------------|---------------------|------|
| 07001 Adams IND) | 200 | Cattle | 5/16-10/31 | 9 | 100 |
| 07100 (Indiv. Allot.) | 241 | Cattle | 6/1-6/30 | 42 | 100 |
| 07049 (N. Sand Creek) | 8 | Cattle | 5/1-11/30 | 49 | 28 |
| 07050 (Lower Sand Hills) | 9 | Cattle | 5/16-11/30 | 100 | 59 |



Allotment 07001

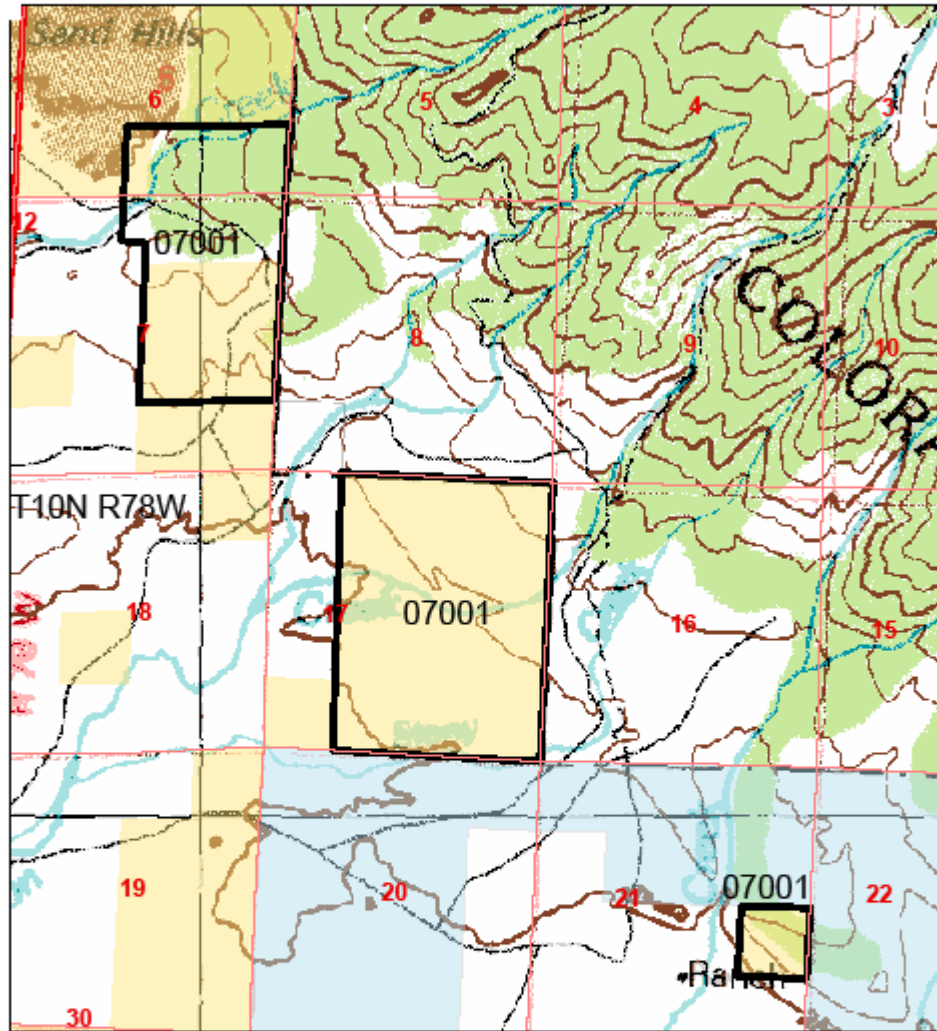

0 0.10.2 0.4 0.6 0.8
Miles



Maps: 24K
BLM, Kremmling FO 12/8/2008
T:\gleuser\NEPA

No Warranty is made by the Bureau of Land Management as to the Accuracy, Reliability, or Completeness of this Data for Individual Use or Aggregate Use with Other Data.

Legend

- County Roads
- Sections
- North_Park_Allotments
- Land Status**
- Bureau of Land Mgt
- Division of Wildlife
- Private
- State
- US Forest Service



Allotment 07100

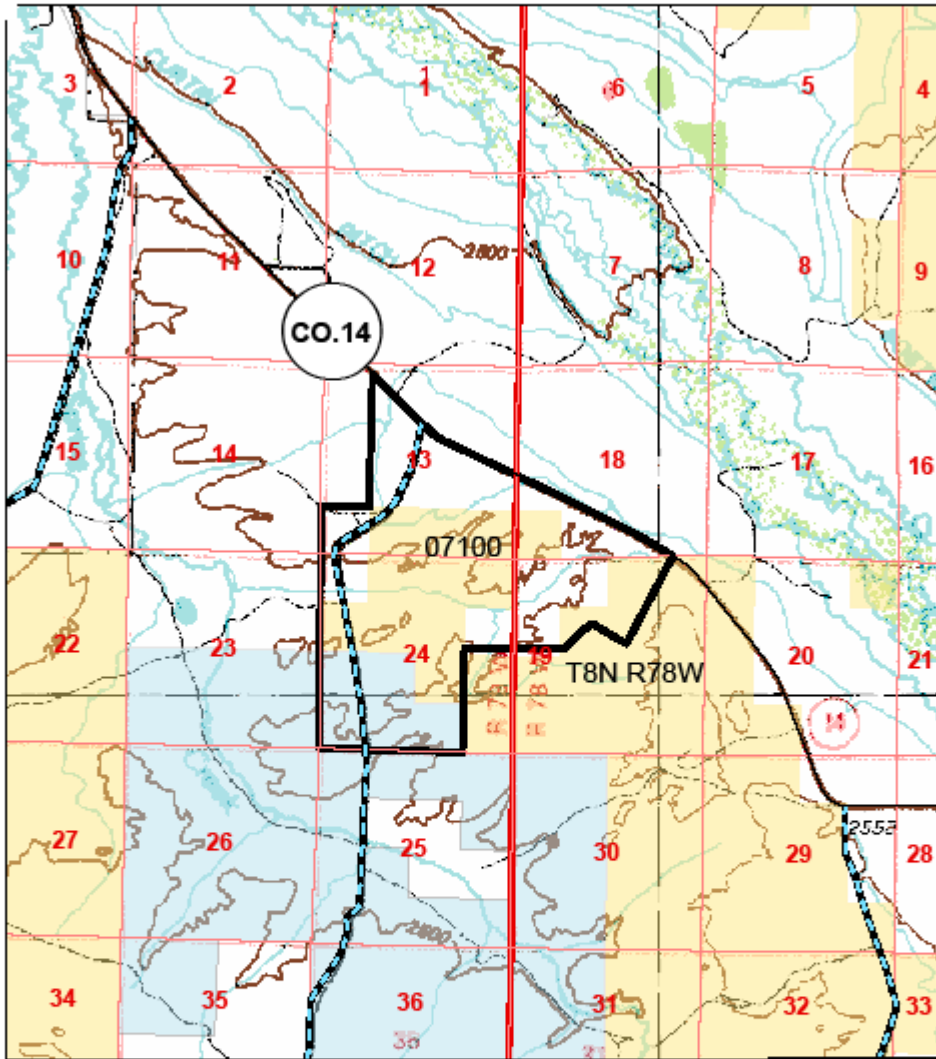

0.125 0.25 0.5 0.75 1 Miles

Maps: 24K
BLM, Kremmling FO 12/8/2008
T:\glouser\NEPA

No Warranty is made by the Bureau of Land Management as to the Accuracy, Reliability, or Completeness of this Data for Individual Use or Aggregate Use with Other Data.

Legend

- County Roads
- Sections
- North_Park_Allotments

Land Status

- Bureau of Land Mgt
- Division of Wildlife
- Private
- State
- US Forest Service



Allotments 07049 and 07050

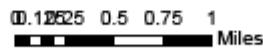
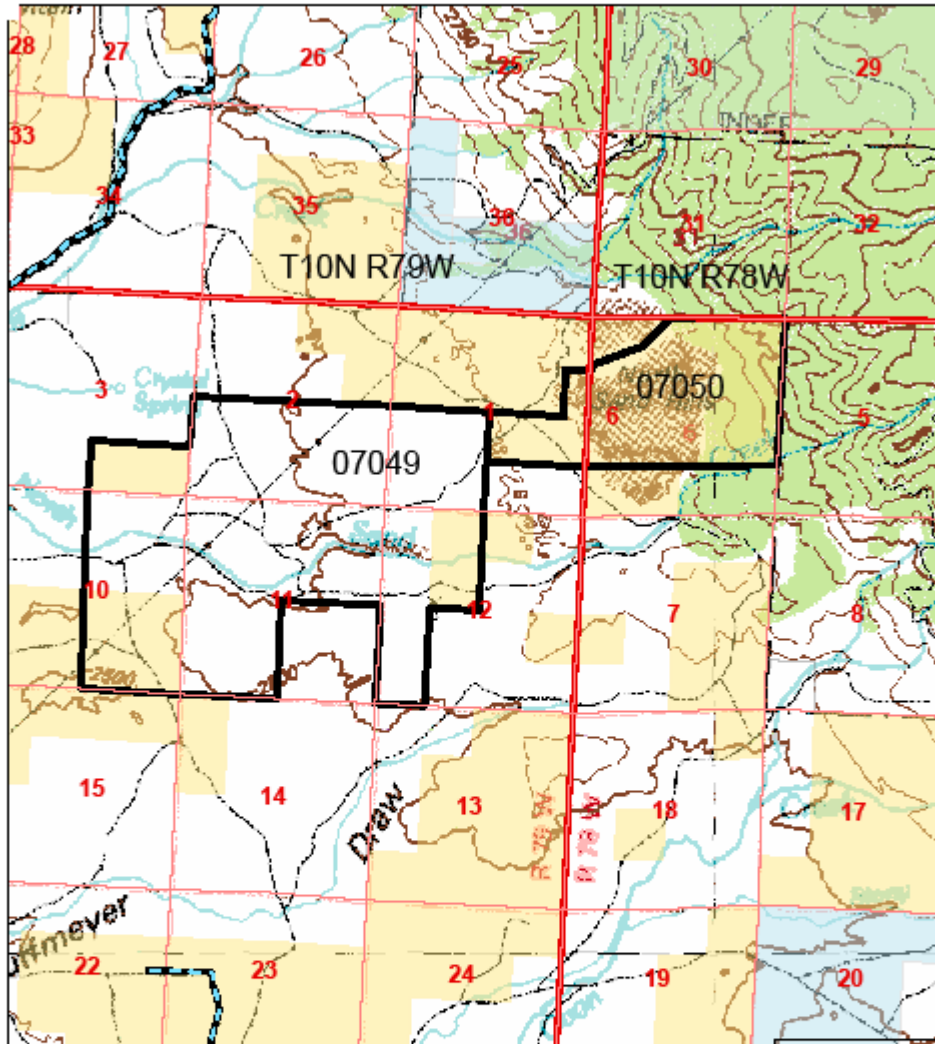

Maps: 24K
BLM, Kremmling FO 12/8/2008
T:\gleuser\NEPA

No Warranty is made by the Bureau of Land Management as to the Accuracy, Reliability, or Completeness of this Data for Individual Use or Aggregate Use with Other Data.

Legend

- County Roads
 - Sections
 - North_Park_Allotments
- Land Status**
- Bureau of Land Mgt
 - Division of Wildlife
 - Private
 - State
 - US Forest Service

PLAN CONFORMANCE REVIEW: The Proposed Action is subject to and has been reviewed for conformance with the following plan (43 CFR 1610.5, BLM 1617.3):

Name of Plan: Kremmling Resource Management Plan (RMP), Record of Decision (ROD)

Date Approved: December 19, 1984; Updated February 1999

Decision Number/Page: Livestock Grazing: pages 6 and 8, as revised

Decision Language: Objectives of the RMP/ROD include allocation of a base level of livestock forage and maintaining forage production and condition in areas where livestock grazing is a priority or is compatible with the land use priority. The RMP designated the project areas with livestock grazing and wildlife priority. The proposed action is compatible with these designations.

CATEGORICAL EXCLUSION REVIEW: The Proposed Action qualifies as a categorical exclusion under 516 DM 11, Number: (D) (11) (a) (1-3), “(1) the same kind of livestock is grazed, (2) the active use previously authorized is not exceeded, and (3) grazing does not occur more than 14 days earlier or later than as specified on the previous permit/lease.” None of the following extraordinary circumstances in 516 DM 2, Appendix 2, apply.

| Extraordinary Circumstances | Yes | No |
|----------------------------------------------------------------------------------------------------------------------------------------------------------------------------------------------------------------------------------------------------------------------------------------------------------------------------------------------------------------------------------------------------------------------------------------------------------------------|------------|-----------|
| 2.1 Have significant impacts on public health or safety | | X |
| 2.2 Have significant impacts on such natural resources and unique geographic characteristics as historic or cultural resources; park, recreation or refuge lands; wilderness areas; wild or scenic rivers; national natural landmarks; sole or principal drinking water aquifers; prime farmlands; wetlands (Executive Order 11990); floodplains (Executive Order 11988); national monuments; migratory birds; and other ecologically significant or critical areas. | | X |
| 2.3 Have highly controversial environmental effects or involve unresolved conflicts concerning alternative uses of available resources [NEPA section 102(2)(E)]. | | X |
| 2.4 Have highly uncertain and potentially significant environmental effects or involve unique or unknown environmental risks. | | X |
| 2.5 Establish a precedent for future action or represent a decision in principle about future actions with potentially significant environmental effects. | | X |
| 2.6 Have a direct relationship to other actions with individually insignificant but cumulatively significant environmental effects. | | X |
| 2.7 Have significant impacts on properties listed, or eligible for listing, on the National Register of historic Places as determined by either the bureau or office. | | X |
| 2.8 Have significant impacts on species listed, or proposed to be | | X |

| | | |
|--------------------------------------------------------------------------------------------------------------------------------------------------------------------------------------------------------------------------------------------------------------------------------------------------------------|--|---|
| listed, on the List of Endangered or Threatened Species, or have significant impacts on designated Critical Habitat for these species. | | |
| 2.9 Violate a Federal Law, or a State, local, or tribal law or requirement imposed for the protection of the environment. | | X |
| 2.10 Have a disproportionately high and adverse effect on low income or minority populations (Executive Order 12898). | | X |
| 2.11 Limit access to and ceremonial use of Indian sacred sites on Federal lands by Indian religious practitioners or significantly adversely affect the physical integrity of such sacred sites (Executive Order 13007). | | X |
| 2.12 Contribute to the introduction, continued existence, or spread of noxious weeds or non-native invasive species known to occur in the area or actions that may promote the introduction, growth, or expansion of the range of such species (Federal Noxious Weed Control Act and Executive Order 13112). | | X |

INTERDISCIPLINARY REVIEW:

| Name | Title | Area of Responsibility | Date Review Completed |
|---------------|---------------------|----------------------------------------|------------------------------|
| Bill Wyatt | Archaeologist | Cultural Resources/Tribal Consultation | 1/20/2009 |
| Paula Belcher | Hydrologist | Soil, Air, Water, and Riparian | 2/25/09 |
| Megan McGuire | Wildlife Biologist | Wildlife, T/E, and Sensitive Species | 1/21/09 |
| Susan Cassel | Asst. Field Manager | NEPA Compliance | 3/3/09 |
| Frank Rupp | Archaeologist | Paleontology | 3/3/09 |

REMARKS:

Cultural Resources: Past actions have resulted in a cultural resource inventory to determine if those actions would cause potential adverse affects to known and unknown cultural resource sites from livestock grazing, motorized travel, and recreational use. When project undertakings are identified a cultural resource, inventory would be conducted to determine if sites are present and their eligibility, project effects, and mitigation requirements if necessary.

Native American Religious Concerns: Consultation was completed for the original allotment renewal. Future undertakings would require tribal consultation to identify traditional cultural properties.

Threatened and Endangered Species: The proposed permit renewal would not impact Endangered, Threatened, or Sensitive Species.

Paleontology: No impacts to fossil resources from renewing permit, or the no action alternative. Proposed ground disturbing projects will be reviewed on a project by project basis to determine the need for paleontological inventory.

COMPLIANCE PLAN: Compliance with the renewed livestock grazing permit and its associated terms and conditions would be accomplished through the Kremmling Field Office Range Management Program. Livestock grazing would be monitored by the range staff and other area personnel, as appropriate, to ensure compliance. The Kremmling Field Office Range Monitoring Plan would be used to schedule periodic utilization checks, collect trend data, and evaluate allotment condition. When activity plans have been developed covering an allotment, monitoring methods and schedules included in them would be applied to the allotment. Changes would be made to the permit, based on monitoring, when changes are determined necessary to protect land health.

NAME OF PREPARER: Mandy Scott

NAME OF ENVIRONMENTAL COORDINATOR: Susan Cassel

DATE: 3/3/09

ATTACHMENTS:

- 1) The following Livestock grazing permits with standard terms and conditions:
 - #0501728 Doug Hoffman
 - #0502955 Donald Culver
 - #0501700 Donald Blandin

DECISION AND RATIONALE: I have reviewed this CER and have decided to implement the proposed action.

This action is listed in the Department Manual as an action that may be categorically excluded. I have evaluated the action relative to the 12 criteria listed above and have determined that it does not represent an extraordinary circumstance and is, therefore, categorically excluded from further environmental analysis.

SIGNATURE OF AUTHORIZED OFFICIAL: /s/ Peter McFadden

DATE SIGNED: 3-3-09